



00283988

RECEIVED

NOV 25 1968

R. 56 W

COLO. OIL & GAS CONS. COMM.

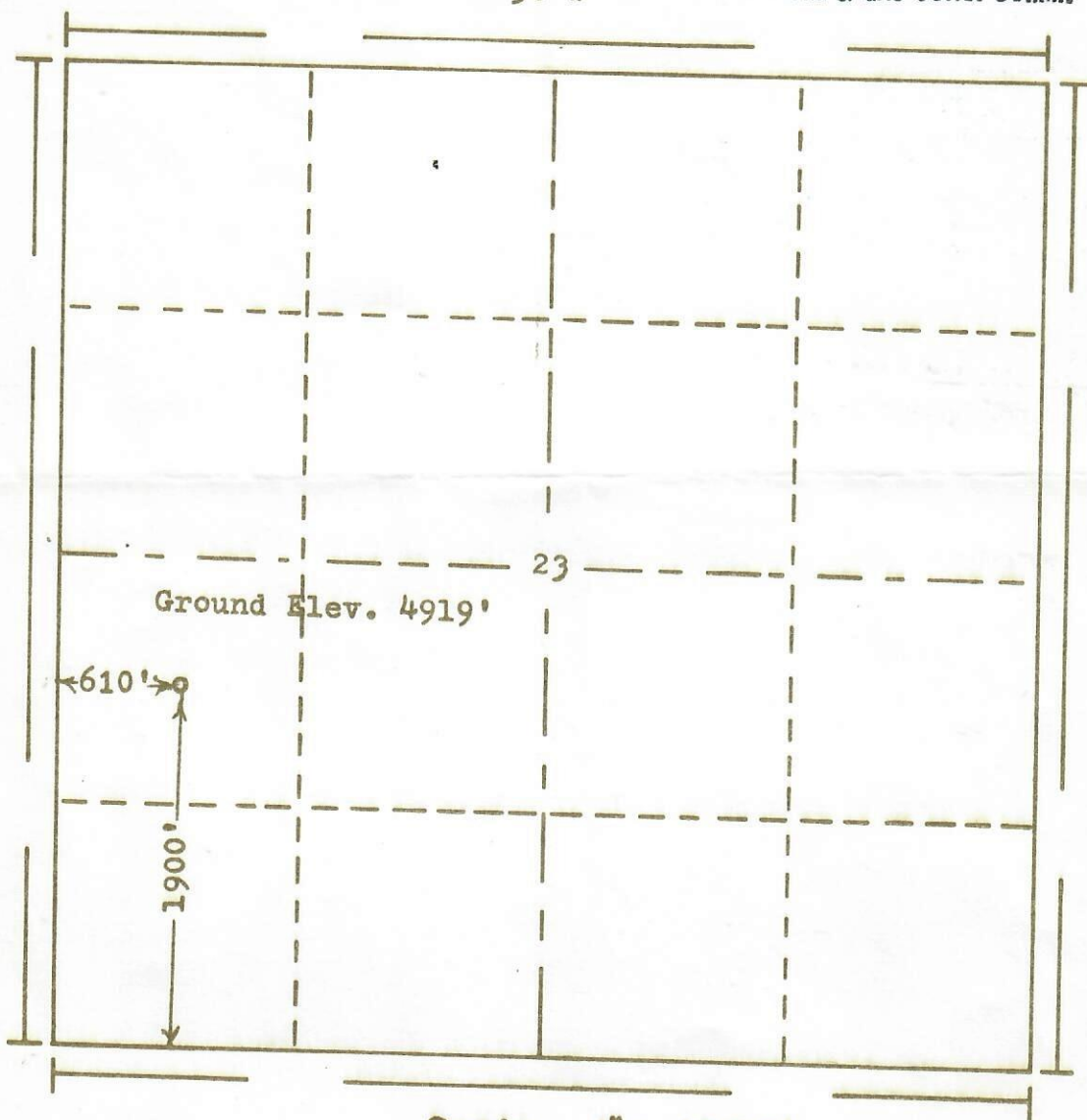
T.
12
N

Scale... 1" = 1000'

Powers Elevation Company, Inc. of Denver, Colorado
has in accordance with a request from Warren Arnold
for Chancellor Exploration & Exeter Drilling
determined the location of No.1-X Duockowskyj
to be 50'W & 80'S of C NW SW Section 23 Township 12 North
Range 56 West of the ~~XXX~~ 6th Principal Meridian
Weld County, Colorado

I hereby certify that this plat is an
accurate representation of a correct
survey showing the location of

Date: 11-19-68

B. G. Hall
Licensed Land Surveyor No. 2853
State of Colorado

05-123-7069

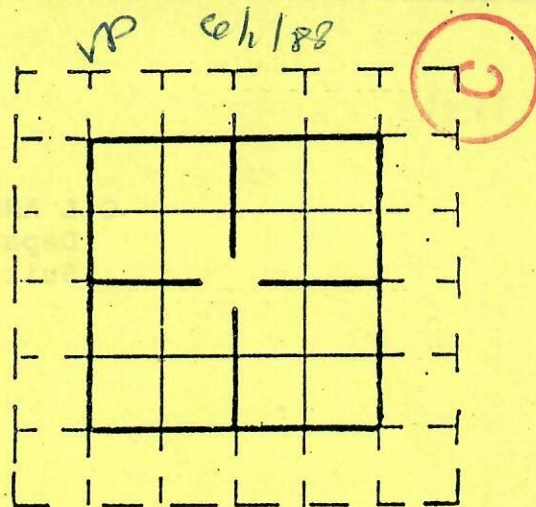

VERBAL REQUEST

NOTICE OF INTENT TO DRILL _____

NOTICE OF INTENT TO ABANDON X EX. PROD.

OTHER _____

COMPANY Don Gregory ADDRESS 115 W. 2ND KIMBAL, NE 69145BY Bob Abramson PHONE NO. _____ EXT. _____WELL NO. 1-X LEASE BUCKROWSKYCOUNTY Weld FIELD SLEEPER DRLG UNIT _____LOCATION NWSW SEC 23 TWP 12N RNGE 56W MERIDIAN 61900 ft. from N or (S) Sec. Line, and 610 ft. from E or (W) Sec. LineESTIMATED DATE OF WORK N/A ESTIMATED TIME _____DETAILS OF PLAN OF WORK: T.D. 6386 FORMATION SKULL CREEKSURFACE CASING 8 5/8 @ 358, 5 1/2 @ 6383 Perts 6318-22CIBP @ 6310 & 6260 Perts 6186-90

① PLACE SAND FROM 6260 - 6075 + 55x CEMENT OR/ SET
CIBP + 25x @ 6075+ OR/ SET 105x CEMENT FROM 6040-6200

② Cut & Pull 5 1/2 @ Freeport ③ PLACE 50 FT PLUG FROM
750 - 800 ④ PLACE 25 5x @ 358 1/2 IN, 1/2 OUT OF CASING
SHOE ⑤ PLACE 5 5x IN TOP OF CASING ⑥ Cut OFF 4' BELOW GROUND

BONDING STATUS: PLUGGING _____ SURFACE _____ OTHER & WELD ON PLATE

Is surface owner also mineral owner? _____

ACREAGE LEASED SURROUNDING DRILLSITE _____

APPROVED BY: Robert L. Vachal DATE JUNE 1, 1988

STATE OF COLORADO
OIL AND GAS CONSERVATION COMMISSION
Department of Natural Resources
Suite 380, Logan Tower Building
1580 Logan Street
Denver, Colorado 80203

Lease
Field
County
Location

Gentlemen:

An inspection was made of the lease(s) shown above. The following conditions were observed to exist at the time of the inspection:

- ☐ Oil accumulation on the water in the retaining pit.
- ☐ Skim pit in need of repairs.
- ☐ Skim pit or tank should be constructed.
- ☐ No. I.D. number on tank.

Remarks: _____

The above condition(s) should be corrected immediately. Any surface accumulation of oil in the retaining pits must be cleaned off within ten (10) days after receipt of this notice (Rule 328), and a report submitted to this office within thirty (30) days after the work was accomplished, advising us of the date and manner in which the correction was made. Any person who fails to comply with this request is in violation of this Commission's Rules and Regulations and is subject to the penalties as provided for under 34-6-121 of the Oil and Gas Conservation Act.

William R. Smith

William R. Smith, Director

NW 5W 23-12N-56W 1-X BUGZKOWSKYJ



BOB ABRAMSON
115 W. Second
2ND

Kinson NE 69145

NW SW 23-12-56W

 BUCZKOWSKYJ
59169 LIN

Weld County

SLEEPER FIELD

Dan Gregory #35750

- Pure CASING

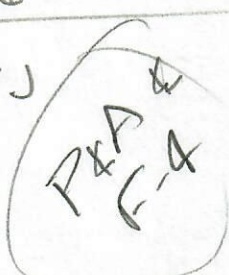
P&A
C-A