



00250984

	QTR	QTR	SEC	TWNS	RANGE	PM	NAME	DEPTH	TPERF	BPERF
A	SW	SE	12	090N	0530W	S	PARKE FRANCIS	276		
B	SE	SW	12	090N	0530W	S	CROISSANT BROS.	300		
C	SE	SW	12	090N	0530W	S	LOUDDER ESTHER CAROL ANN PALME	300		
D	SE	SW	12	090N	0530W	S	VANDEMOER CHRIS			
E	SE	SW	12	090N	0530W	S	LOUDDER E C			
F	NW	NE	13	090N	0530W	S	BUDIN PAUL	200		
G	NW	NE	14	090N	0530W	S	KLOBERDANZ GERALD & SHARON	410		
H	SE	NW	15	090N	0530W	S	HUNT G			
I		C	16	090N	0530W	S	COLO STATE BOARD LAND COMM	400		
J	SE	NW	18	090N	0530W	S	MONTAGUE JOE	430		
K	SW	NW	19	090N	0530W	S	SHELL OIL COMPANY	698		
L	SE	SE	19	090N	0530W	S	SHELL OIL COMPANY	700		
M	NW	SW	19	090N	0530W	S	SHELL OIL COMPANY	700		
N	SE	SW	20	090N	0530W	S	GREEN BROTHERS	380		
O	SW	SW	21	090N	0530W	S	SCHROEDER LESLIE	410		
P	NE	NE	23	090N	0530W	S	BOLLISH DONALD	440		
Q	SE	NW	23	090N	0530W	S	SCHROEDER LESLIE	455	355	455
R	SE	SE	23	090N	0530W	S	SKAER ENTERPRISES			
S	SE	NE	24	090N	0530W	S	MAHONEY CHARLES V & NANCY E	324		
T	SW	NW	24	090N	0530W	S	BOLLISH ROBERT	345		

Letter=Choice | F10=Mark 1 | PgUp/PgDn=±20 | UpAr/DnAr =±1 | Esc=Quit

0 = WATER WELL

## OIL AND GAS WELL/WATER WELL

## BASE PLAT

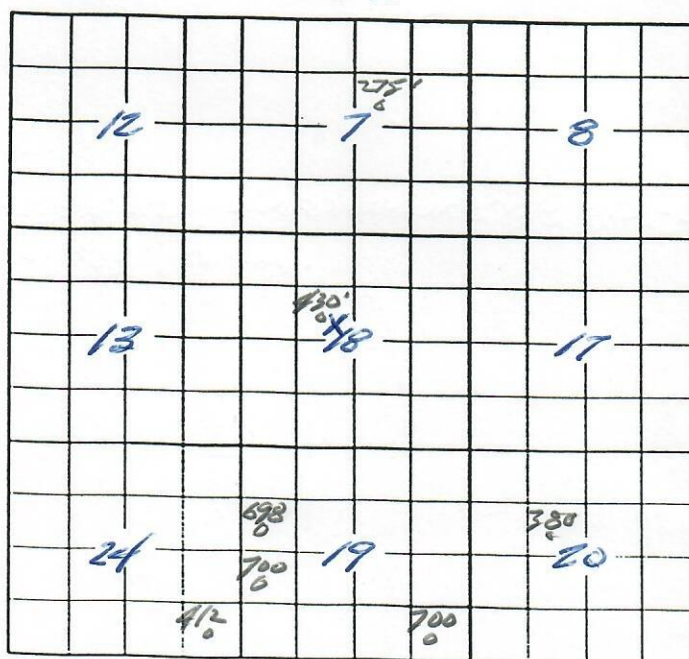



**HOUSTON, TEXAS**



COUNTY LOGAN  
FIELD CEDAR CREEK  
LOCATION SEC. 18-9N-5E  
WELL HENDERSON #5  
COMPANY SKELLY OIL CO

COMPANY	SKELLEY OIL CO.
WELL	HENDERSON #5
FIELD	CEDAR CREEK
LOCATION	SEC. 18-3N-53W
COUNTY	NE SW NW
STATE -	LOGAN
	COLORADO

Locate **Top Well**

Eleventh District  
Rt. 123  
06115-1234  
FILING NO.

Done	ONE	29-58
First feeding	5	140
last feeding	131	
Feet measured	5009	
Cig. setting	131	
Cig. Driller	135	
Depth Reached	5145	
Bottom Driller	5145	
Depth Bottom	K.B.	
Mudlog	CHEM - OIL	
Dipht. Msc.	10	107
Mud Keiss.	3	86 75
Rev. BHT	2	138
Rmf	1	70 138
Run	9	20
Loss	4	1 cc 30 min
Bit Street	7	7/8
Specks - AM	16	"
IN.	27	"
INO.	40	"
Op. Rig Time	1 5	HRS
Truck No.	2514	PM
Recorded by	KLINE	
Witness	HOLBROOK	

CC BY

CC BY

CC BY

REMARKS	C. 105
Panel No.	058
Sonde No.	1130

SPONTANEOUS-POTENTIAL  
millivolts

RESISTIVITY  
ohms. m<sup>2</sup>/m

CONDUCTIVITY  
millimhos/m =  $\frac{1000}{\text{ohms. m/m}}$

16" NORMAL

## INDUCTION

## INDUCTION

AMPLIFIED NORMAL

CSG  
131

0200



0 AMPLIFIED NORMAL 10

CSG  
131

