

CONFLUENCE RESOURCES



Location:	COLORADO	Slot:	SLOT#14 CANAL 22-1-3L (185°FSL & 1346°FWL,SEC.22)
Field:	WELD COUNTY (NAD83, TRUE NORTH)	Well:	CANAL 22-1-3L
Facility:	SEC.22-T01N-R65W	Wellbore:	CANAL 22-1-3L PWB
Plot reference wellpath is CANAL 22-1-3L PWP Rev-A.0		Grid System: NAD83 / Lambert Colorado SP, Northern Zone (501), US feet	
True vertical depths are referenced to Rig (23) (KB)		North Reference: True north	
Reference wellpath measured depths are referenced to Rig (23) (KB)		Scale: True distance	
Rig (23) (KB) to Mean Sea Level: 5118 feet		Coordinates are in feet referenced to Slot	
Mean Sea Level to Mud line (At Slot: SLOT#14 CANAL 22-1-3L (185°FSL & 1346°FWL,SEC.22)): 0 feet		Depths are in feet	
Offset wellpath MDs are referenced to each path's default MD datum		Created by: painsetr on 2021-05-17; Database: WellArcheolDB	

Well Profile Data								
Design Comment	MD (ft)	Inc (°)	Az (°)	TVD (ft)	Local N (ft)	Local E (ft)	DLS (°/100ft)	VS (ft)
Tie On	23.00	0.000	95.378	23.00	0.00	0.00	0.00	0.00
End of Tangent	400.00	0.000	95.378	400.00	0.00	0.00	0.00	0.00
Build (XS)	1850.81	29.016	95.378	1789.58	-33.70	358.00	2.00	86.44
KOP	7560.30	29.016	95.378	6782.44	-293.29	3115.23	0.00	752.20
LANDING	8484.39	90.000	0.407	7305.00	277.09	3408.05	10.00	1387.29
TD	18141.95	90.000	0.407	7305.00	9934.41	3476.71	0.00	10525.21

Location Information				
Facility Name		Grid East (US ft)	Grid North (US ft)	Latitude
SEC.22-T01N-R65W		3236383.461	1254962.137	40°01'48.6120"N
Slot		Local N (ft)	Local E (ft)	Longitude
SLOT#14 CANAL 22-1-3L (185°FSL & 1346°FWL,SEC.22)		0.00	299.64	104°39'21.0600"W
Rig (23) (KB) to Mud line (At Slot: SLOT#14 CANAL 22-1-3L (185°FSL & 1346°FWL,SEC.22))		Grid East (US ft)	Grid North (US ft)	Latitude
Mean Sea Level to Mud line (At Slot: SLOT#14 CANAL 22-1-3L (185°FSL & 1346°FWL,SEC.22))		3236683.079	1254964.991	40°01'48.6120"N
Rig (23) (KB) to Mean Sea Level		5118ft	5118ft	104°39'17.2080"W

Hole and Casing Sections										
Name	Start MD (ft)	End MD (ft)	Interval (ft)	Start TVD (ft)	End TVD (ft)	Start Local N (ft)	Start Local E (ft)	End Local N (ft)	End Local E (ft)	Wellbore
9.625in Casing Surface	23.00	1550.00	1527.00	23.00	1519.36	0.00	0.00	-21.35	226.73	CANAL 22-1-3L PWB

Bottom Hole Location							
MD (ft)	Inc (°)	Az (°)	TVD (ft)	Local N (ft)	Local E (ft)	Grid East (US ft)	Grid North (US ft)
18141.95	90.000	0.407	7305.00	9934.41	3476.71	3240064.81	1264931.71

Targets							
Name	MD (ft)	TVD (ft)	Local N (ft)	Local E (ft)	Grid East (US ft)	Grid North (US ft)	Latitude
SEC.15/22-T01N-R65W (SB 460)	N/A	6.50	0.00	-299.64	3236383.46	1254962.14	40°01'48.6120"N
SEC.15-T01N-R65W	N/A	10.00	0.00	-299.64	3236383.46	1254962.14	40°01'48.6120"N
SEC.22-T01N-R65W	N/A	10.00	0.00	-299.64	3236383.46	1254962.14	40°01'48.6120"N
CANAL 22-1-3L BHL REV-1(470°FNL & 520°FEL,SEC.15)	18141.95	7305.00	9934.41	3476.71	3240064.81	1264931.71	40°03'26.7840"N
CANAL 22-1-3L LP REV-1(470°FNL & 520°FEL,SEC.22)	8484.39	7305.00	277.09	3408.05	3240088.21	1255274.54	40°01'51.3480"N

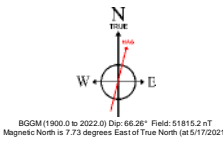
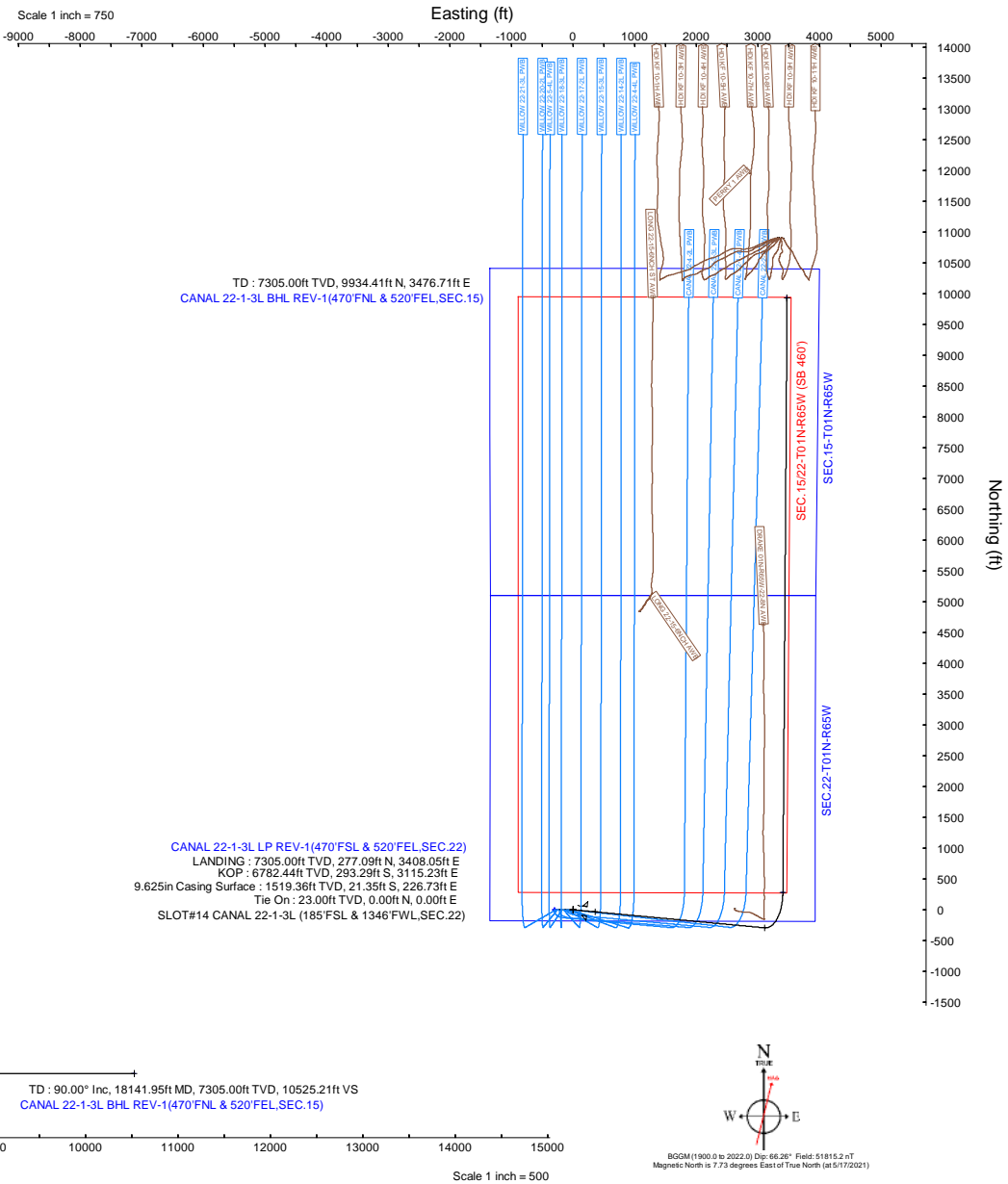
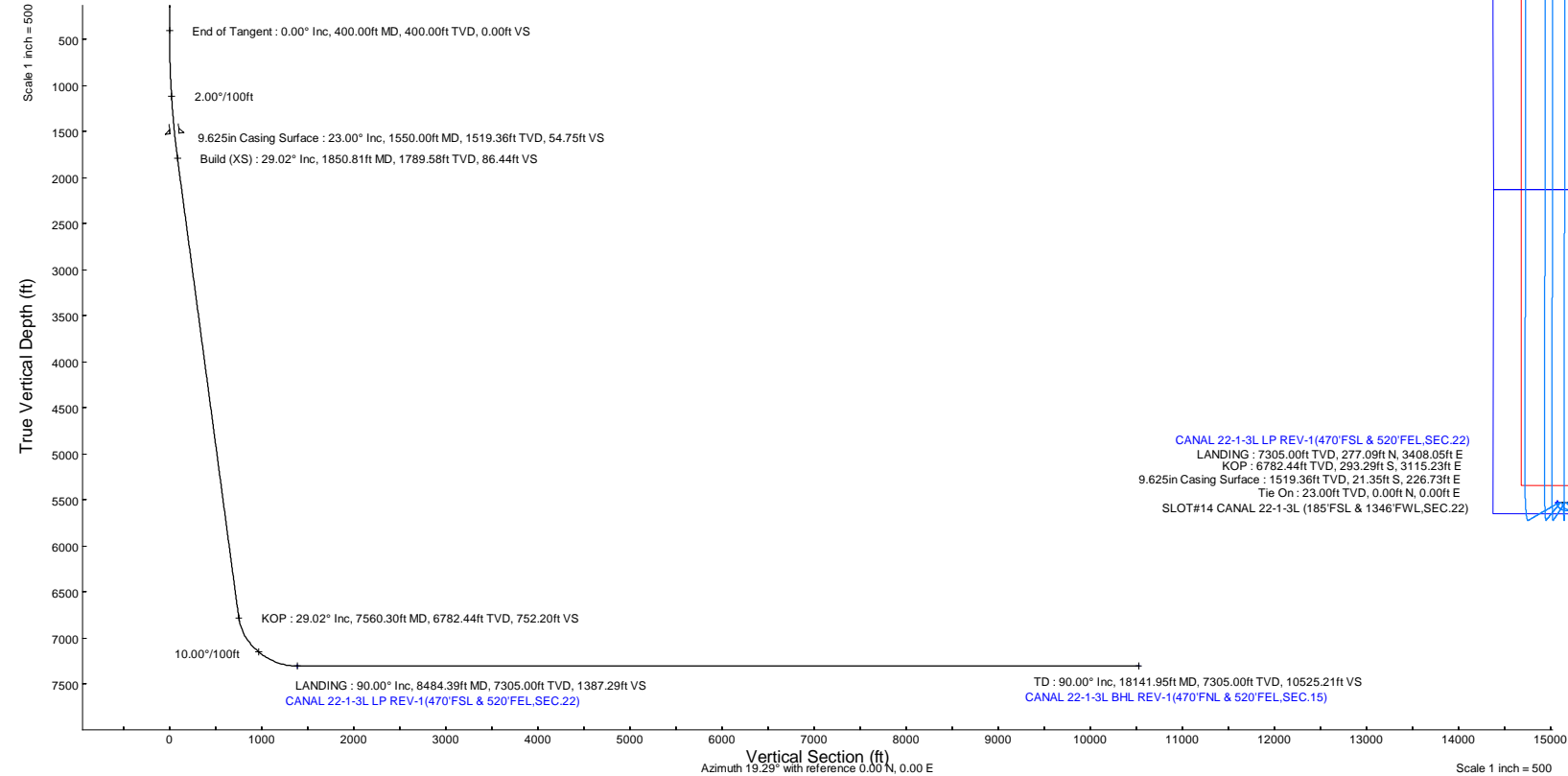

Planned Wellpath Report

CANAL 22-1-3L PWP Rev-A.0

Page 1 of 10

REFERENCE WELLPATH IDENTIFICATION

Operator	CONFLUENCE RESOURCES	Well	CANAL 22-1-3L
Field	WELD COUNTY (NAD83, TRUE NORTH)	API/Legal	
Facility	SEC.22-T01N-R65W	Wellbore	CANAL 22-1-3L PWB
Slot	SLOT#14 CANAL 22-1-3L (185'FSL & 1346'FWL,SEC.22)		

REPORT SETUP INFORMATION

Projection System	NAD83 / Lambert Colorado SP, Northern Zone (501), US feet	Software System	WellArchitect® 6.0
North Reference	True	User	Painsetr
Scale	0.999964	Report Generated	5/17/2021 at 1:29:49 PM
Convergence at slot	0.55° East	Database	WellArchitectDB

WELLPATH LOCATION

	Local coordinates		Grid coordinates		Geographic coordinates	
	North[ft]	East[ft]	Easting[US ft]	Northing[US ft]	Latitude	Longitude
Slot Location	0.00	299.64	3236683.08	1254964.99	40.0301700°	-104.6547800°
Facility Reference Pt			3236383.46	1254962.14	40.0301700°	-104.6558500°
Field Reference Pt			3230456.90	1245096.09	40.0032400°	-104.6773400°

WELLPATH DATUM

Calculation method	Minimum curvature	Rig (23') (KB) to Facility Vertical Datum	5118.00ft
Horizontal Reference Pt	Slot	Rig (23') (KB) to Mean Sea Level	5118.00ft
Vertical Reference Pt	Rig (23') (KB)	Rig (23') (KB) to Mud Line at Slot (SLOT#14 CANAL 22-1-3L (185'FSL & 1346'FWL,SEC.22))	5118.00ft
MD Reference Pt	Rig (23') (KB)	Section Origin	N 0.00, E 0.00 ft
Field Vertical Reference	Mean Sea Level	Section Azimuth	19.29°

Planned Wellpath Report

CANAL 22-1-3L PWP Rev-A.0

Page 2 of 10

REFERENCE WELLPATH IDENTIFICATION

Operator	CONFLUENCE RESOURCES	Well	CANAL 22-1-3L
Field	WELD COUNTY (NAD83, TRUE NORTH)	API/Legal	
Facility	SEC.22-T01N-R65W	Wellbore	CANAL 22-1-3L PWB
Slot	SLOT#14 CANAL 22-1-3L (185'FSL & 1346'FWL,SEC.22)		

WELLPATH DATA (188 stations) † = interpolated, ‡ = extrapolated station

MD [ft]	Inclination [°]	Azimuth [°]	TVD [ft]	Vert Sect [ft]	North [ft]	East [ft]	Grid East [US ft]	Grid North [US ft]	Latitude	Longitude	DLS [°/100ft]	Comments
0.00†	0.000	95.378	0.00	0.00	0.00	0.00	3236683.08	1254964.99	40.0301700	-104.6547800	0.00	
23.00	0.000	95.378	23.00	0.00	0.00	0.00	3236683.08	1254964.99	40.0301700	-104.6547800	0.00	Tie On
123.00†	0.000	95.378	123.00	0.00	0.00	0.00	3236683.08	1254964.99	40.0301700	-104.6547800	0.00	
223.00†	0.000	95.378	223.00	0.00	0.00	0.00	3236683.08	1254964.99	40.0301700	-104.6547800	0.00	
323.00†	0.000	95.378	323.00	0.00	0.00	0.00	3236683.08	1254964.99	40.0301700	-104.6547800	0.00	
400.00	0.000	95.378	400.00	0.00	0.00	0.00	3236683.08	1254964.99	40.0301700	-104.6547800	0.00	End of Tangent
423.00†	0.460	95.378	423.00	0.02	-0.01	0.09	3236683.17	1254964.98	40.0301700	-104.6547797	2.00	
523.00†	2.460	95.378	522.96	0.63	-0.25	2.63	3236685.71	1254964.77	40.0301693	-104.6547706	2.00	
623.00†	4.460	95.378	622.77	2.09	-0.81	8.64	3236691.72	1254964.26	40.0301678	-104.6547492	2.00	
723.00†	6.460	95.378	722.32	4.37	-1.70	18.11	3236701.20	1254963.46	40.0301653	-104.6547153	2.00	
823.00†	8.460	95.378	821.46	7.49	-2.92	31.04	3236714.14	1254962.37	40.0301620	-104.6546692	2.00	
923.00†	10.460	95.378	920.10	11.44	-4.46	47.40	3236730.52	1254960.98	40.0301578	-104.6546107	2.00	
1023.00†	12.460	95.378	1018.10	16.22	-6.32	67.18	3236750.31	1254959.31	40.0301526	-104.6545401	2.00	
1123.00†	14.460	95.378	1115.35	21.82	-8.51	90.35	3236773.50	1254957.35	40.0301466	-104.6544574	2.00	
1223.00†	16.460	95.378	1211.73	28.22	-11.00	116.89	3236800.06	1254955.10	40.0301398	-104.6543626	2.00	
1323.00†	18.460	95.378	1307.11	35.44	-13.82	146.76	3236829.96	1254952.57	40.0301321	-104.6542559	2.00	
1423.00†	20.460	95.378	1401.40	43.44	-16.94	179.93	3236863.15	1254949.77	40.0301235	-104.6541375	2.00	
1523.00†	22.460	95.378	1494.46	52.24	-20.37	216.35	3236899.60	1254946.69	40.0301141	-104.6540074	2.00	
1623.00†	24.460	95.378	1586.19	61.81	-24.10	255.98	3236939.27	1254943.33	40.0301038	-104.6538659	2.00	
1723.00†	26.460	95.378	1676.47	72.14	-28.13	298.78	3236982.10	1254939.71	40.0300928	-104.6537131	2.00	
1823.00†	28.460	95.378	1765.20	83.23	-32.45	344.69	3237028.05	1254935.83	40.0300809	-104.6535492	2.00	
1850.81	29.016	95.378	1789.58	86.44	-33.70	358.00	3237041.37	1254934.70	40.0300775	-104.6535016	2.00	Build (XS)
1923.00†	29.016	95.378	1852.71	94.86	-36.99	392.86	3237076.26	1254931.75	40.0300685	-104.6533771	0.00	
2023.00†	29.016	95.378	1940.16	106.52	-41.53	441.15	3237124.59	1254927.67	40.0300560	-104.6532047	0.00	
2123.00†	29.016	95.378	2027.61	118.18	-46.08	489.44	3237172.92	1254923.58	40.0300435	-104.6530322	0.00	
2223.00†	29.016	95.378	2115.06	129.84	-50.63	537.74	3237221.25	1254919.49	40.0300310	-104.6528598	0.00	
2323.00†	29.016	95.378	2202.51	141.50	-55.17	586.03	3237269.58	1254915.41	40.0300185	-104.6526873	0.00	
2423.00†	29.016	95.378	2289.96	153.16	-59.72	634.32	3237317.92	1254911.32	40.0300060	-104.6525149	0.00	
2523.00†	29.016	95.378	2377.40	164.82	-64.27	682.61	3237366.25	1254907.24	40.0299936	-104.6523425	0.00	
2623.00†	29.016	95.378	2464.85	176.48	-68.81	730.90	3237414.58	1254903.15	40.0299811	-104.6521700	0.00	

Planned Wellpath Report

CANAL 22-1-3L PWP Rev-A.0

Page 3 of 10

REFERENCE WELLPATH IDENTIFICATION

Operator	CONFLUENCE RESOURCES	Well	CANAL 22-1-3L
Field	WELD COUNTY (NAD83, TRUE NORTH)	API/Legal	
Facility	SEC.22-T01N-R65W	Wellbore	CANAL 22-1-3L PWB
Slot	SLOT#14 CANAL 22-1-3L (185'FSL & 1346'FWL,SEC.22)		

WELLPATH DATA (188 stations) † = interpolated, ‡ = extrapolated station

MD [ft]	Inclination [°]	Azimuth [°]	TVD [ft]	Vert Sect [ft]	North [ft]	East [ft]	Grid East [US ft]	Grid North [US ft]	Latitude	Longitude	DLS [°/100ft]	Comments
2723.00†	29.016	95.378	2552.30	188.14	-73.36	779.20	3237462.91	1254899.06	40.0299686	-104.6519976	0.00	
2823.00†	29.016	95.378	2639.75	199.80	-77.91	827.49	3237511.24	1254894.98	40.0299561	-104.6518251	0.00	
2923.00†	29.016	95.378	2727.20	211.47	-82.45	875.78	3237559.57	1254890.89	40.0299436	-104.6516527	0.00	
3023.00†	29.016	95.378	2814.65	223.13	-87.00	924.07	3237607.90	1254886.81	40.0299311	-104.6514802	0.00	
3123.00†	29.016	95.378	2902.09	234.79	-91.55	972.36	3237656.23	1254882.72	40.0299186	-104.6513078	0.00	
3223.00†	29.016	95.378	2989.54	246.45	-96.09	1020.66	3237704.57	1254878.63	40.0299062	-104.6511353	0.00	
3323.00†	29.016	95.378	3076.99	258.11	-100.64	1068.95	3237752.90	1254874.55	40.0298937	-104.6509629	0.00	
3423.00†	29.016	95.378	3164.44	269.77	-105.19	1117.24	3237801.23	1254870.46	40.0298812	-104.6507904	0.00	
3523.00†	29.016	95.378	3251.89	281.43	-109.73	1165.53	3237849.56	1254866.38	40.0298687	-104.6506180	0.00	
3623.00†	29.016	95.378	3339.34	293.09	-114.28	1213.82	3237897.89	1254862.29	40.0298562	-104.6504456	0.00	
3723.00†	29.016	95.378	3426.78	304.75	-118.83	1262.12	3237946.22	1254858.21	40.0298437	-104.6502731	0.00	
3823.00†	29.016	95.378	3514.23	316.41	-123.37	1310.41	3237994.55	1254854.12	40.0298312	-104.6501007	0.00	
3923.00†	29.016	95.378	3601.68	328.07	-127.92	1358.70	3238042.89	1254850.03	40.0298188	-104.6499282	0.00	
4023.00†	29.016	95.378	3689.13	339.73	-132.46	1406.99	3238091.22	1254845.95	40.0298063	-104.6497558	0.00	
4123.00†	29.016	95.378	3776.58	351.39	-137.01	1455.28	3238139.55	1254841.86	40.0297938	-104.6495833	0.00	
4223.00†	29.016	95.378	3864.03	363.05	-141.56	1503.58	3238187.88	1254837.78	40.0297813	-104.6494109	0.00	
4323.00†	29.016	95.378	3951.47	374.71	-146.10	1551.87	3238236.21	1254833.69	40.0297688	-104.6492384	0.00	
4423.00†	29.016	95.378	4038.92	386.37	-150.65	1600.16	3238284.54	1254829.60	40.0297563	-104.6490660	0.00	
4523.00†	29.016	95.378	4126.37	398.03	-155.20	1648.45	3238332.87	1254825.52	40.0297438	-104.6488936	0.00	
4623.00†	29.016	95.378	4213.82	409.69	-159.74	1696.74	3238381.21	1254821.43	40.0297313	-104.6487211	0.00	
4723.00†	29.016	95.378	4301.27	421.36	-164.29	1745.04	3238429.54	1254817.35	40.0297188	-104.6485487	0.00	
4823.00†	29.016	95.378	4388.72	433.02	-168.84	1793.33	3238477.87	1254813.26	40.0297064	-104.6483762	0.00	
4923.00†	29.016	95.378	4476.16	444.68	-173.38	1841.62	3238526.20	1254809.17	40.0296939	-104.6482038	0.00	
5023.00†	29.016	95.378	4563.61	456.34	-177.93	1889.91	3238574.53	1254805.09	40.0296814	-104.6480313	0.00	
5123.00†	29.016	95.378	4651.06	468.00	-182.48	1938.20	3238622.86	1254801.00	40.0296689	-104.6478589	0.00	
5223.00†	29.016	95.378	4738.51	479.66	-187.02	1986.50	3238671.19	1254796.92	40.0296564	-104.6476864	0.00	
5323.00†	29.016	95.378	4825.96	491.32	-191.57	2034.79	3238719.52	1254792.83	40.0296439	-104.6475140	0.00	
5423.00†	29.016	95.378	4913.41	502.98	-196.12	2083.08	3238767.86	1254788.74	40.0296314	-104.6473416	0.00	
5523.00†	29.016	95.378	5000.85	514.64	-200.66	2131.37	3238816.19	1254784.66	40.0296189	-104.6471691	0.00	
5623.00†	29.016	95.378	5088.30	526.30	-205.21	2179.67	3238864.52	1254780.57	40.0296064	-104.6469967	0.00	

REFERENCE WELLPATH IDENTIFICATION

Operator	CONFLUENCE RESOURCES	Well	CANAL 22-1-3L
Field	WELD COUNTY (NAD83, TRUE NORTH)	API/Legal	
Facility	SEC.22-T01N-R65W	Wellbore	CANAL 22-1-3L PWB
Slot	SLOT#14 CANAL 22-1-3L (185'FSL & 1346'FWL,SEC.22)		

WELLPATH DATA (188 stations) † = interpolated, ‡ = extrapolated station

MD [ft]	Inclination [°]	Azimuth [°]	TVD [ft]	Vert Sect [ft]	North [ft]	East [ft]	Grid East [US ft]	Grid North [US ft]	Latitude	Longitude	DLS [°/100ft]	Comments
5723.00†	29.016	95.378	5175.75	537.96	-209.76	2227.96	3238912.85	1254776.49	40.0295939	-104.6468242	0.00	
5823.00†	29.016	95.378	5263.20	549.62	-214.30	2276.25	3238961.18	1254772.40	40.0295814	-104.6466518	0.00	
5923.00†	29.016	95.378	5350.65	561.28	-218.85	2324.54	3239009.51	1254768.31	40.0295689	-104.6464793	0.00	
6023.00†	29.016	95.378	5438.10	572.94	-223.40	2372.83	3239057.84	1254764.23	40.0295564	-104.6463069	0.00	
6123.00†	29.016	95.378	5525.54	584.60	-227.94	2421.13	3239106.18	1254760.14	40.0295440	-104.6461344	0.00	
6223.00†	29.016	95.378	5612.99	596.26	-232.49	2469.42	3239154.51	1254756.06	40.0295315	-104.6459620	0.00	
6323.00†	29.016	95.378	5700.44	607.92	-237.04	2517.71	3239202.84	1254751.97	40.0295190	-104.6457896	0.00	
6423.00†	29.016	95.378	5787.89	619.58	-241.58	2566.00	3239251.17	1254747.89	40.0295065	-104.6456171	0.00	
6523.00†	29.016	95.378	5875.34	631.24	-246.13	2614.29	3239299.50	1254743.80	40.0294940	-104.6454447	0.00	
6623.00†	29.016	95.378	5962.79	642.91	-250.68	2662.59	3239347.83	1254739.71	40.0294815	-104.6452722	0.00	
6723.00†	29.016	95.378	6050.23	654.57	-255.22	2710.88	3239396.16	1254735.63	40.0294690	-104.6450998	0.00	
6823.00†	29.016	95.378	6137.68	666.23	-259.77	2759.17	3239444.49	1254731.54	40.0294565	-104.6449273	0.00	
6923.00†	29.016	95.378	6225.13	677.89	-264.32	2807.46	3239492.83	1254727.46	40.0294440	-104.6447549	0.00	
7023.00†	29.016	95.378	6312.58	689.55	-268.86	2855.75	3239541.16	1254723.37	40.0294315	-104.6445825	0.00	
7123.00†	29.016	95.378	6400.03	701.21	-273.41	2904.05	3239589.49	1254719.28	40.0294190	-104.6444100	0.00	
7223.00†	29.016	95.378	6487.48	712.87	-277.96	2952.34	3239637.82	1254715.20	40.0294065	-104.6442376	0.00	
7323.00†	29.016	95.378	6574.92	724.53	-282.50	3000.63	3239686.15	1254711.11	40.0293940	-104.6440651	0.00	
7423.00†	29.016	95.378	6662.37	736.19	-287.05	3048.92	3239734.48	1254707.03	40.0293815	-104.6438927	0.00	
7523.00†	29.016	95.378	6749.82	747.85	-291.60	3097.21	3239782.81	1254702.94	40.0293690	-104.6437202	0.00	
7560.30	29.016	95.378	6782.44	752.20	-293.29	3115.23	3239800.84	1254701.42	40.0293644	-104.6436559	0.00	KOP
7623.00†	29.159	82.463	6837.29	762.76	-292.71	3145.54	3239831.15	1254702.28	40.0293659	-104.6435477	10.00	
7723.00†	31.814	63.377	6923.66	792.76	-277.67	3193.38	3239878.84	1254717.78	40.0294072	-104.6433769	10.00	
7823.00†	36.827	47.963	7006.38	838.10	-245.71	3239.31	3239924.47	1254750.18	40.0294949	-104.6432128	10.00	
7923.00†	43.381	36.192	7082.93	897.41	-197.80	3281.96	3239966.65	1254798.49	40.0296264	-104.6430605	10.00	
8023.00†	50.870	27.122	7151.00	968.87	-135.41	3320.02	3240004.11	1254861.24	40.0297977	-104.6429246	10.00	
8123.00†	58.924	19.860	7208.51	1050.32	-60.42	3352.33	3240035.71	1254936.53	40.0300035	-104.6428091	10.00	
8223.00†	67.320	13.759	7253.71	1139.29	24.89	3377.92	3240060.48	1255022.07	40.0302377	-104.6427177	10.00	
8323.00†	75.919	8.374	7285.24	1233.07	117.91	3396.00	3240077.67	1255115.26	40.0304930	-104.6426531	10.00	
8423.00†	84.629	3.385	7302.12	1328.81	215.84	3406.03	3240086.77	1255213.27	40.0307618	-104.6426173	10.00	
8484.39	90.000	0.407	7305.00†	1387.29	277.09	3408.05	3240088.21	1255274.54	40.0309300	-104.6426100	10.00	LANDING

Planned Wellpath Report

CANAL 22-1-3L PWP Rev-A.0

Page 5 of 10

REFERENCE WELLPATH IDENTIFICATION

Operator	CONFLUENCE RESOURCES	Well	CANAL 22-1-3L
Field	WELD COUNTY (NAD83, TRUE NORTH)	API/Legal	
Facility	SEC.22-T01N-R65W	Wellbore	CANAL 22-1-3L PWB
Slot	SLOT#14 CANAL 22-1-3L (185'FSL & 1346'FWL,SEC.22)		

WELLPATH DATA (188 stations) † = interpolated, ‡ = extrapolated station

MD [ft]	Inclination [°]	Azimuth [°]	TVD [ft]	Vert Sect [ft]	North [ft]	East [ft]	Grid East [US ft]	Grid North [US ft]	Latitude	Longitude	DLS [°/100ft]	Comments
8523.00†	90.000	0.407	7305.00	1423.83	315.71	3408.33	3240088.11	1255313.16	40.0310360	-104.6426090	0.00	
8623.00†	90.000	0.407	7305.00	1518.45	415.70	3409.04	3240087.87	1255413.15	40.0313105	-104.6426064	0.00	
8723.00†	90.000	0.407	7305.00	1613.07	515.70	3409.75	3240087.63	1255513.15	40.0315850	-104.6426038	0.00	
8823.00†	90.000	0.407	7305.00	1707.69	615.70	3410.46	3240087.39	1255613.14	40.0318595	-104.6426012	0.00	
8923.00†	90.000	0.407	7305.00	1802.31	715.69	3411.17	3240087.14	1255713.14	40.0321340	-104.6425987	0.00	
9023.00†	90.000	0.407	7305.00	1896.93	815.69	3411.88	3240086.90	1255813.13	40.0324085	-104.6425961	0.00	
9123.00†	90.000	0.407	7305.00	1991.54	915.69	3412.59	3240086.66	1255913.13	40.0326830	-104.6425935	0.00	
9223.00†	90.000	0.407	7305.00	2086.16	1015.69	3413.30	3240086.42	1256013.13	40.0329575	-104.6425909	0.00	
9323.00†	90.000	0.407	7305.00	2180.78	1115.68	3414.01	3240086.17	1256113.12	40.0332320	-104.6425883	0.00	
9423.00†	90.000	0.407	7305.00	2275.40	1215.68	3414.72	3240085.93	1256213.12	40.0335065	-104.6425857	0.00	
9523.00†	90.000	0.407	7305.00	2370.02	1315.68	3415.44	3240085.69	1256313.11	40.0337810	-104.6425831	0.00	
9623.00†	90.000	0.407	7305.00	2464.64	1415.68	3416.15	3240085.45	1256413.11	40.0340555	-104.6425805	0.00	
9723.00†	90.000	0.407	7305.00	2559.26	1515.67	3416.86	3240085.21	1256513.11	40.0343300	-104.6425779	0.00	
9823.00†	90.000	0.407	7305.00	2653.88	1615.67	3417.57	3240084.96	1256613.10	40.0346045	-104.6425754	0.00	
9923.00†	90.000	0.407	7305.00	2748.50	1715.67	3418.28	3240084.72	1256713.10	40.0348790	-104.6425728	0.00	
10023.00†	90.000	0.407	7305.00	2843.12	1815.67	3418.99	3240084.48	1256813.09	40.0351535	-104.6425702	0.00	
10123.00†	90.000	0.407	7305.00	2937.74	1915.66	3419.70	3240084.24	1256913.09	40.0354280	-104.6425676	0.00	
10223.00†	90.000	0.407	7305.00	3032.36	2015.66	3420.41	3240083.99	1257013.09	40.0357025	-104.6425650	0.00	
10323.00†	90.000	0.407	7305.00	3126.98	2115.66	3421.12	3240083.75	1257113.08	40.0359770	-104.6425624	0.00	
10423.00†	90.000	0.407	7305.00	3221.60	2215.66	3421.83	3240083.51	1257213.08	40.0362515	-104.6425598	0.00	
10523.00†	90.000	0.407	7305.00	3316.21	2315.65	3422.54	3240083.27	1257313.07	40.0365260	-104.6425572	0.00	
10623.00†	90.000	0.407	7305.00	3410.83	2415.65	3423.26	3240083.03	1257413.07	40.0368005	-104.6425547	0.00	
10723.00†	90.000	0.407	7305.00	3505.45	2515.65	3423.97	3240082.78	1257513.07	40.0370750	-104.6425521	0.00	
10823.00†	90.000	0.407	7305.00	3600.07	2615.65	3424.68	3240082.54	1257613.06	40.0373495	-104.6425495	0.00	
10923.00†	90.000	0.407	7305.00	3694.69	2715.64	3425.39	3240082.30	1257713.06	40.0376240	-104.6425469	0.00	
11023.00†	90.000	0.407	7305.00	3789.31	2815.64	3426.10	3240082.06	1257813.05	40.0378985	-104.6425443	0.00	
11123.00†	90.000	0.407	7305.00	3883.93	2915.64	3426.81	3240081.81	1257913.05	40.0381730	-104.6425417	0.00	
11223.00†	90.000	0.407	7305.00	3978.55	3015.64	3427.52	3240081.57	1258013.05	40.0384475	-104.6425391	0.00	
11323.00†	90.000	0.407	7305.00	4073.17	3115.63	3428.23	3240081.33	1258113.04	40.0387220	-104.6425365	0.00	
11423.00†	90.000	0.407	7305.00	4167.79	3215.63	3428.94	3240081.09	1258213.04	40.0389965	-104.6425340	0.00	

Planned Wellpath Report

CANAL 22-1-3L PWP Rev-A.0

Page 6 of 10

REFERENCE WELLPATH IDENTIFICATION

Operator	CONFLUENCE RESOURCES	Well	CANAL 22-1-3L
Field	WELD COUNTY (NAD83, TRUE NORTH)	API/Legal	
Facility	SEC.22-T01N-R65W	Wellbore	CANAL 22-1-3L PWB
Slot	SLOT#14 CANAL 22-1-3L (185'FSL & 1346'FWL,SEC.22)		

WELLPATH DATA (188 stations) † = interpolated, ‡ = extrapolated station

MD [ft]	Inclination [°]	Azimuth [°]	TVD [ft]	Vert Sect [ft]	North [ft]	East [ft]	Grid East [US ft]	Grid North [US ft]	Latitude	Longitude	DLS [°/100ft]	Comments
11523.00†	90.000	0.407	7305.00	4262.41	3315.63	3429.65	3240080.85	1258313.03	40.0392710	-104.6425314	0.00	
11623.00†	90.000	0.407	7305.00	4357.03	3415.63	3430.36	3240080.60	1258413.03	40.0395455	-104.6425288	0.00	
11723.00†	90.000	0.407	7305.00	4451.65	3515.62	3431.08	3240080.36	1258513.02	40.0398200	-104.6425262	0.00	
11823.00†	90.000	0.407	7305.00	4546.27	3615.62	3431.79	3240080.12	1258613.02	40.0400945	-104.6425236	0.00	
11923.00†	90.000	0.407	7305.00	4640.88	3715.62	3432.50	3240079.88	1258713.02	40.0403690	-104.6425210	0.00	
12023.00†	90.000	0.407	7305.00	4735.50	3815.62	3433.21	3240079.63	1258813.01	40.0406435	-104.6425184	0.00	
12123.00†	90.000	0.407	7305.00	4830.12	3915.61	3433.92	3240079.39	1258913.01	40.0409180	-104.6425158	0.00	
12223.00†	90.000	0.407	7305.00	4924.74	4015.61	3434.63	3240079.15	1259013.00	40.0411925	-104.6425132	0.00	
12323.00†	90.000	0.407	7305.00	5019.36	4115.61	3435.34	3240078.91	1259113.00	40.0414670	-104.6425107	0.00	
12423.00†	90.000	0.407	7305.00	5113.98	4215.61	3436.05	3240078.67	1259213.00	40.0417415	-104.6425081	0.00	
12523.00†	90.000	0.407	7305.00	5208.60	4315.60	3436.76	3240078.42	1259312.99	40.0420160	-104.6425055	0.00	
12623.00†	90.000	0.407	7305.00	5303.22	4415.60	3437.47	3240078.18	1259412.99	40.0422905	-104.6425029	0.00	
12723.00†	90.000	0.407	7305.00	5397.84	4515.60	3438.18	3240077.94	1259512.98	40.0425650	-104.6425003	0.00	
12823.00†	90.000	0.407	7305.00	5492.46	4615.60	3438.90	3240077.70	1259612.98	40.0428395	-104.6424977	0.00	
12923.00†	90.000	0.407	7305.00	5587.08	4715.59	3439.61	3240077.45	1259712.98	40.0431140	-104.6424951	0.00	
13023.00†	90.000	0.407	7305.00	5681.70	4815.59	3440.32	3240077.21	1259812.97	40.0433885	-104.6424925	0.00	
13123.00†	90.000	0.407	7305.00	5776.32	4915.59	3441.03	3240076.97	1259912.97	40.0436630	-104.6424899	0.00	
13223.00†	90.000	0.407	7305.00	5870.93	5015.59	3441.74	3240076.73	1260012.96	40.0439375	-104.6424874	0.00	
13323.00†	90.000	0.407	7305.00	5965.55	5115.58	3442.45	3240076.49	1260112.96	40.0442120	-104.6424848	0.00	
13423.00†	90.000	0.407	7305.00	6060.17	5215.58	3443.16	3240076.24	1260212.96	40.0444865	-104.6424822	0.00	
13523.00†	90.000	0.407	7305.00	6154.79	5315.58	3443.87	3240076.00	1260312.95	40.0447610	-104.6424796	0.00	
13623.00†	90.000	0.407	7305.00	6249.41	5415.58	3444.58	3240075.76	1260412.95	40.0450355	-104.6424770	0.00	
13723.00†	90.000	0.407	7305.00	6344.03	5515.57	3445.29	3240075.52	1260512.94	40.0453100	-104.6424744	0.00	
13823.00†	90.000	0.407	7305.00	6438.65	5615.57	3446.00	3240075.27	1260612.94	40.0455845	-104.6424718	0.00	
13923.00†	90.000	0.407	7305.00	6533.27	5715.57	3446.72	3240075.03	1260712.94	40.0458590	-104.6424692	0.00	
14023.00†	90.000	0.407	7305.00	6627.89	5815.57	3447.43	3240074.79	1260812.93	40.0461335	-104.6424666	0.00	
14123.00†	90.000	0.407	7305.00	6722.51	5915.56	3448.14	3240074.55	1260912.93	40.0464080	-104.6424641	0.00	
14223.00†	90.000	0.407	7305.00	6817.13	6015.56	3448.85	3240074.30	1261012.92	40.0466825	-104.6424615	0.00	
14323.00†	90.000	0.407	7305.00	6911.75	6115.56	3449.56	3240074.06	1261112.92	40.0469570	-104.6424589	0.00	
14423.00†	90.000	0.407	7305.00	7006.37	6215.56	3450.27	3240073.82	1261212.91	40.0472315	-104.6424563	0.00	

Planned Wellpath Report

CANAL 22-1-3L PWP Rev-A.0

Page 7 of 10

REFERENCE WELLPATH IDENTIFICATION

Operator	CONFLUENCE RESOURCES	Well	CANAL 22-1-3L
Field	WELD COUNTY (NAD83, TRUE NORTH)	API/Legal	
Facility	SEC.22-T01N-R65W	Wellbore	CANAL 22-1-3L PWB
Slot	SLOT#14 CANAL 22-1-3L (185'FSL & 1346'FWL,SEC.22)		

WELLPATH DATA (188 stations) † = interpolated, ‡ = extrapolated station

MD [ft]	Inclination [°]	Azimuth [°]	TVD [ft]	Vert Sect [ft]	North [ft]	East [ft]	Grid East [US ft]	Grid North [US ft]	Latitude	Longitude	DLS [°/100ft]	Comments
14523.00†	90.000	0.407	7305.00	7100.99	6315.55	3450.98	3240073.58	1261312.91	40.0475060	-104.6424537	0.00	
14623.00†	90.000	0.407	7305.00	7195.60	6415.55	3451.69	3240073.34	1261412.91	40.0477805	-104.6424511	0.00	
14723.00†	90.000	0.407	7305.00	7290.22	6515.55	3452.40	3240073.09	1261512.90	40.0480550	-104.6424485	0.00	
14823.00†	90.000	0.407	7305.00	7384.84	6615.55	3453.11	3240072.85	1261612.90	40.0483295	-104.6424459	0.00	
14923.00†	90.000	0.407	7305.00	7479.46	6715.54	3453.82	3240072.61	1261712.89	40.0486040	-104.6424433	0.00	
15023.00†	90.000	0.407	7305.00	7574.08	6815.54	3454.54	3240072.37	1261812.89	40.0488785	-104.6424408	0.00	
15123.00†	90.000	0.407	7305.00	7668.70	6915.54	3455.25	3240072.12	1261912.89	40.0491530	-104.6424382	0.00	
15223.00†	90.000	0.407	7305.00	7763.32	7015.54	3455.96	3240071.88	1262012.88	40.0494275	-104.6424356	0.00	
15323.00†	90.000	0.407	7305.00	7857.94	7115.53	3456.67	3240071.64	1262112.88	40.0497020	-104.6424330	0.00	
15423.00†	90.000	0.407	7305.00	7952.56	7215.53	3457.38	3240071.40	1262212.87	40.0499765	-104.6424304	0.00	
15523.00†	90.000	0.407	7305.00	8047.18	7315.53	3458.09	3240071.16	1262312.87	40.0502510	-104.6424278	0.00	
15623.00†	90.000	0.407	7305.00	8141.80	7415.53	3458.80	3240070.91	1262412.87	40.0505255	-104.6424252	0.00	
15723.00†	90.000	0.407	7305.00	8236.42	7515.52	3459.51	3240070.67	1262512.86	40.0508000	-104.6424226	0.00	
15823.00†	90.000	0.407	7305.00	8331.04	7615.52	3460.22	3240070.43	1262612.86	40.0510745	-104.6424200	0.00	
15923.00†	90.000	0.407	7305.00	8425.66	7715.52	3460.93	3240070.19	1262712.85	40.0513490	-104.6424175	0.00	
16023.00†	90.000	0.407	7305.00	8520.27	7815.52	3461.64	3240069.94	1262812.85	40.0516235	-104.6424149	0.00	
16123.00†	90.000	0.407	7305.00	8614.89	7915.51	3462.36	3240069.70	1262912.85	40.0518980	-104.6424123	0.00	
16223.00†	90.000	0.407	7305.00	8709.51	8015.51	3463.07	3240069.46	1263012.84	40.0521725	-104.6424097	0.00	
16323.00†	90.000	0.407	7305.00	8804.13	8115.51	3463.78	3240069.22	1263112.84	40.0524470	-104.6424071	0.00	
16423.00†	90.000	0.407	7305.00	8898.75	8215.51	3464.49	3240068.98	1263212.83	40.0527215	-104.6424045	0.00	
16523.00†	90.000	0.407	7305.00	8993.37	8315.50	3465.20	3240068.73	1263312.83	40.0529960	-104.6424019	0.00	
16623.00†	90.000	0.407	7305.00	9087.99	8415.50	3465.91	3240068.49	1263412.83	40.0532705	-104.6423993	0.00	
16723.00†	90.000	0.407	7305.00	9182.61	8515.50	3466.62	3240068.25	1263512.82	40.0535450	-104.6423967	0.00	
16823.00†	90.000	0.407	7305.00	9277.23	8615.50	3467.33	3240068.01	1263612.82	40.0538195	-104.6423942	0.00	
16923.00†	90.000	0.407	7305.00	9371.85	8715.49	3468.04	3240067.76	1263712.81	40.0540940	-104.6423916	0.00	
17023.00†	90.000	0.407	7305.00	9466.47	8815.49	3468.75	3240067.52	1263812.81	40.0543685	-104.6423890	0.00	
17123.00†	90.000	0.407	7305.00	9561.09	8915.49	3469.46	3240067.28	1263912.80	40.0546430	-104.6423864	0.00	
17223.00†	90.000	0.407	7305.00	9655.71	9015.49	3470.18	3240067.04	1264012.80	40.0549175	-104.6423838	0.00	
17323.00†	90.000	0.407	7305.00	9750.33	9115.48	3470.89	3240066.80	1264112.80	40.0551920	-104.6423812	0.00	
17423.00†	90.000	0.407	7305.00	9844.94	9215.48	3471.60	3240066.55	1264212.79	40.0554665	-104.6423786	0.00	

REFERENCE WELLPATH IDENTIFICATION

Operator	CONFLUENCE RESOURCES	Well	CANAL 22-1-3L
Field	WELD COUNTY (NAD83, TRUE NORTH)	API/Legal	
Facility	SEC.22-T01N-R65W	Wellbore	CANAL 22-1-3L PWB
Slot	SLOT#14 CANAL 22-1-3L (185'FSL & 1346'FWL,SEC.22)		

WELLPATH DATA (188 stations) † = interpolated, ‡ = extrapolated station

MD [ft]	Inclination [°]	Azimuth [°]	TVD [ft]	Vert Sect [ft]	North [ft]	East [ft]	Grid East [US ft]	Grid North [US ft]	Latitude	Longitude	DLS [°/100ft]	Comments
17523.00†	90.000	0.407	7305.00	9939.56	9315.48	3472.31	3240066.31	1264312.79	40.0557410	-104.6423760	0.00	
17623.00†	90.000	0.407	7305.00	10034.18	9415.48	3473.02	3240066.07	1264412.78	40.0560155	-104.6423734	0.00	
17723.00†	90.000	0.407	7305.00	10128.80	9515.47	3473.73	3240065.83	1264512.78	40.0562900	-104.6423708	0.00	
17823.00†	90.000	0.407	7305.00	10223.42	9615.47	3474.44	3240065.58	1264612.78	40.0565645	-104.6423683	0.00	
17923.00†	90.000	0.407	7305.00	10318.04	9715.47	3475.15	3240065.34	1264712.77	40.0568390	-104.6423657	0.00	
18023.00†	90.000	0.407	7305.00	10412.66	9815.46	3475.86	3240065.10	1264812.77	40.0571135	-104.6423631	0.00	
18123.00†	90.000	0.407	7305.00	10507.28	9915.46	3476.57	3240064.86	1264912.76	40.0573880	-104.6423605	0.00	
18141.95	90.000	0.407	7305.00 [‡]	10525.21	9934.41	3476.71	3240064.81	1264931.71	40.0574400	-104.6423600	0.00	TD

HOLE & CASING SECTIONS - Ref Wellbore: CANAL 22-1-3L PWB Ref Wellpath: CANAL 22-1-3L PWP Rev-A.0

String/Diameter	Start MD [ft]	End MD [ft]	Interval [ft]	Start TVD [ft]	End TVD [ft]	Start N/S [ft]	Start E/W [ft]	End N/S [ft]	End E/W [ft]
9.625in Casing Surface	23.00	1550.00	1527.00	23.00	1519.36	0.00	0.00	-21.35	226.73

REFERENCE WELLPATH IDENTIFICATION

Operator	CONFLUENCE RESOURCES	Well	CANAL 22-1-3L
Field	WELD COUNTY (NAD83, TRUE NORTH)	API/Legal	
Facility	SEC.22-T01N-R65W	Wellbore	CANAL 22-1-3L PWB
Slot	SLOT#14 CANAL 22-1-3L (185'FSL & 1346'FWL,SEC.22)		

TARGETS

Name	MD [ft]	TVD [ft]	North [ft]	East [ft]	Grid East [US ft]	Grid North [US ft]	Latitude	Longitude	Shape
SEC.15/22-T01N-R65W (SB 460')	N/A	6.50	0.00	-299.64	3236383.46	1254962.14	40.0301700	-104.6558500	polygon
	2D Polygon: dimensions not calculated								
SEC.15-T01N-R65W	N/A	10.00	0.00	-299.64	3236383.46	1254962.14	40.0301700	-104.6558500	polygon
	2D Polygon: dimensions not calculated								
SEC.22-T01N-R65W	N/A	10.00	0.00	-299.64	3236383.46	1254962.14	40.0301700	-104.6558500	polygon
	2D Polygon: dimensions not calculated								
2) CANAL 22-1-3L BHL REV-1 (470'FNL & 520'FEL,SEC.15)	18141.95	7305.00	9934.41	3476.71	3240064.81	1264931.71	40.0574400	-104.6423600	point
1) CANAL 22-1-3L LP REV-1 (470'FSL & 520'FEL,SEC.22)	8484.39	7305.00	277.09	3408.05	3240088.21	1255274.54	40.0309300	-104.6426100	point

SURVEY PROGRAM - Ref Wellbore: CANAL 22-1-3L PWB Ref Wellpath: CANAL 22-1-3L PWP Rev-A.0

Start MD [ft]	End MD [ft]	Positional Uncertainty Model	Log Name/Comment	Wellbore
23.00	1550.00	BH NaviTrak (2019) (Axial)		CANAL 22-1-3L PWB
1550.00	18141.96	BH AutoTrak Curve/eXpress (2019) (Short spacing)		CANAL 22-1-3L PWB

Planned Wellpath Report

CANAL 22-1-3L PWP Rev-A.0

Page 10 of 10

REFERENCE WELLPATH IDENTIFICATION

Operator	CONFLUENCE RESOURCES	Well	CANAL 22-1-3L
Field	WELD COUNTY (NAD83, TRUE NORTH)	API/Legal	
Facility	SEC.22-T01N-R65W	Wellbore	CANAL 22-1-3L PWB
Slot	SLOT#14 CANAL 22-1-3L (185'FSL & 1346'FWL,SEC.22)		

DESIGN COMMENTS

MD [ft]	Inclination [°]	Azimuth [°]	TVD [ft]	Comment
23.00	0.000	95.378	23.00	Tie On
400.00	0.000	95.378	400.00	End of Tangent
1850.81	29.016	95.378	1789.58	Build (XS)
7560.30	29.016	95.378	6782.44	KOP
8484.39	90.000	0.407	7305.00	LANDING
18141.95	90.000	0.407	7305.00	TD