

Well Name:	Project Name:	Pad Name:
BLEHM-6X-HNB-10-07-67	Sec. 9-T7N-R67W	BLEHM Pad

ANNOTATIONS									
MD	Inc	Azi	TVD	+N/-S	+E/-W	VSect	Departure	Annotation	
1500.00	0.00	0.00	1500.00	0.00	0.00	0.00	0.00	Surf Csg	
1600.00	0.00	0.00	1600.00	0.00	0.00	0.00	0.00	Start Build 2.00	
4657.12	61.14	238.39	4109.05	-776.92	-1262.20	-679.35	1482.15	Hold 61.14 Inc, 238.39 Az	
8808.63	61.14	238.39	6112.70	-2682.83	-4358.63	-2345.93	5118.13	KOP 10°/100	
10186.05	89.14	89.80	6850.50	-3358.34	-3982.00	-1674.48	6238.42	LP 89.14 Inc, 89.80 Az	
19679.07	89.14	89.80	6992.84	-3325.32	5508.90	6434.73	15729.38	TD at 19679.07	

Geodetic Datum:	Elevation:
North American Datum 1983 US State Plane 1983, Colorado Northern Zone	Ground Elevation: 5088.00 KB Elevation: KB @ 5115.00usft

DESIGN TARGET DETAILS									
Name	TVD	+N/-S	+E/-W	Northing	Easting	Latitude	Longitude	Shape	
SHL 6X-HNB 542 FNL 712 FEL	0.00	0.00	0.00	1459986.826	3169070.770	40.594469	-104.891195	Point	
LPL 6X-HNB 1383 FSL 460 FWL	6849.00	-3358.34	-4091.89	1456628.487	3164978.879	40.585327	-104.906010	Point	plan misses target center by 10.30usft at 10077.49usft MD (6841.35 TVD, -3351.75 N, -4089.81 E)
BHL 6X-HNB 1383 FSL 460 FEL	6993.00	-3324.94	5509.90	1456661.888	3174580.665	40.585237	-104.871440	Point	

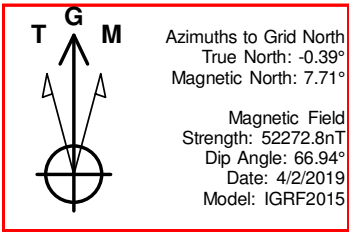
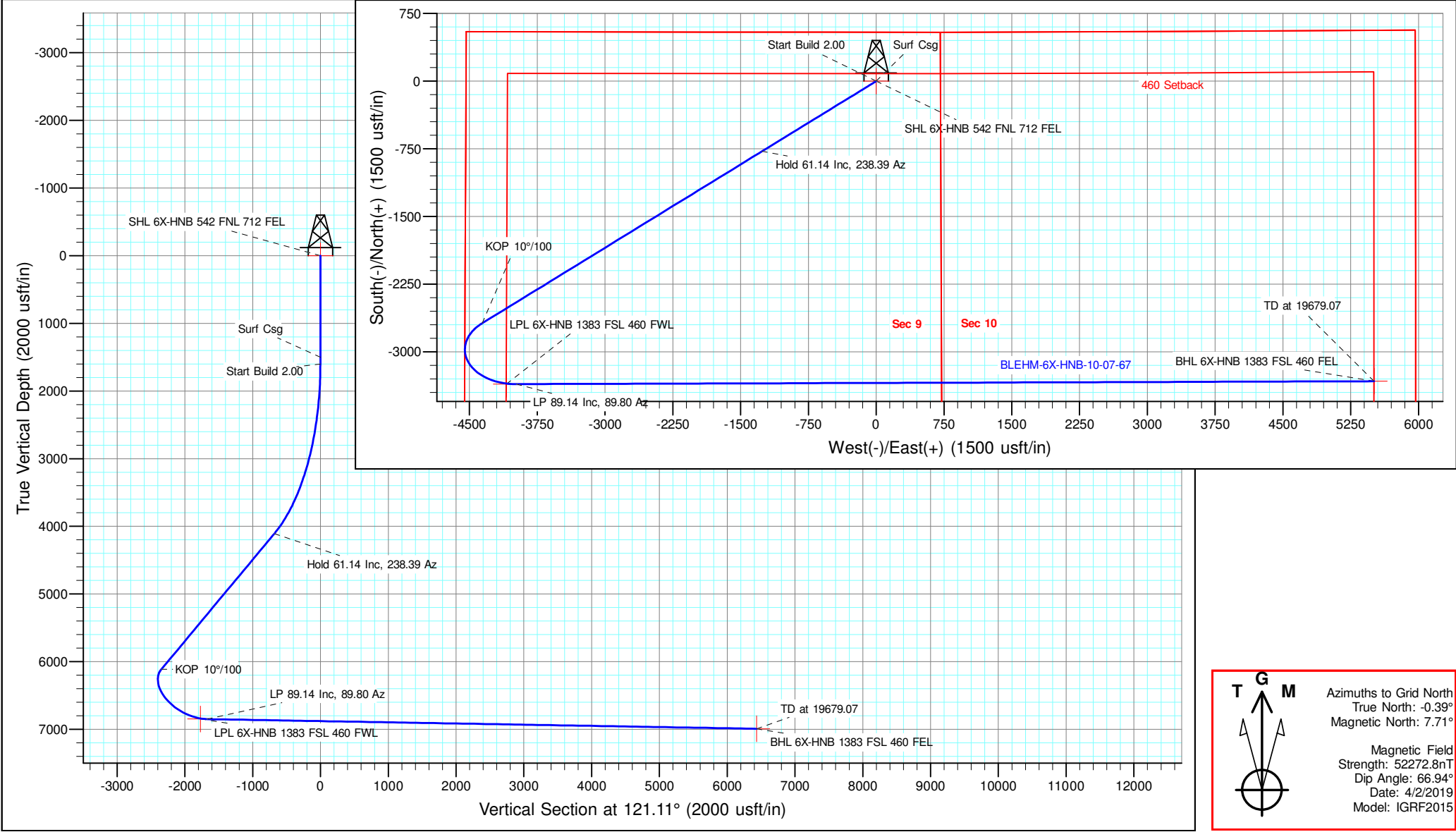

# NICKEL ROAD

O P E R A T I N G

## **Nickel Road Operating**

**Sec. 9-T7N-R67W**

**BLEHM Pad**

**BLEHM-6X-HNB-10-07-67**

**Wellbore #1**

**Plan: Plan #2**

## **Standard Planning Report - Geographic**

**20 July, 2020**

<b>Database:</b>	EDM 5000.15 Single User Db	<b>Local Co-ordinate Reference:</b>	Well BLEHM-6X-HNB-10-07-67
<b>Company:</b>	Nickel Road Operating	<b>TVD Reference:</b>	KB @ 5115.00usft
<b>Project:</b>	Sec. 9-T7N-R67W	<b>MD Reference:</b>	KB @ 5115.00usft
<b>Site:</b>	BLEHM Pad	<b>North Reference:</b>	Grid
<b>Well:</b>	BLEHM-6X-HNB-10-07-67	<b>Survey Calculation Method:</b>	Minimum Curvature
<b>Wellbore:</b>	Wellbore #1		
<b>Design:</b>	Plan #2		

<b>Project</b>	Sec. 9-T7N-R67W, Weld County, CO		
<b>Map System:</b>	US State Plane 1983	<b>System Datum:</b>	Mean Sea Level
<b>Geo Datum:</b>	North American Datum 1983		
<b>Map Zone:</b>	Colorado Northern Zone		

Site	BLEHM Pad				
Site Position:		Northing:	1,458,460.000 usft	Latitude:	40.590318
From:	Lat/Long	Easting:	3,166,936.305 usft	Longitude:	-104.898918
Position Uncertainty:	0.00 usft	Slot Radius:	13-3/16 "	Grid Convergence:	0.39 °

Well	BLEHM-6X-HNB-10-07-67					
Well Position	+N/-S	0.00 usft	Northing:	1,459,986.825 usft	Latitude:	40.594469
	+E/-W	0.00 usft	Easting:	3,169,070.770 usft	Longitude:	-104.891195
Position Uncertainty		0.00 usft	Wellhead Elevation:		Ground Level:	5,088.00 usft

<b>Wellbore</b>	Wellbore #1				
<b>Magnetics</b>	<b>Model Name</b>	<b>Sample Date</b>	<b>Declination (°)</b>	<b>Dip Angle (°)</b>	<b>Field Strength (nT)</b>
	IGRF2015	4/2/2019	8.10	66.94	52,272.80972961

<b>Design</b>	Plan #2			
<b>Audit Notes:</b>				
<b>Version:</b>	<b>Phase:</b>	PLAN	<b>Tie On Depth:</b>	0.00
<b>Vertical Section:</b>	<b>Depth From (TVD) (usft)</b>	<b>+N/-S (usft)</b>	<b>+E/-W (usft)</b>	<b>Direction (°)</b>
	0.00	0.00	0.00	121.11

<b>Plan Survey Tool Program</b>	<b>Date</b>	7/20/2020		
<b>Depth From (usft)</b>	<b>Depth To (usft)</b>	<b>Survey (Wellbore)</b>	<b>Tool Name</b>	<b>Remarks</b>
1	0.00	19,678.84 Plan #2 (Wellbore #1)	MWD	
			OWSG MWD - Standard	

<b>Plan Sections</b>										
<b>Measured Depth (usft)</b>	<b>Inclination (°)</b>	<b>Azimuth (°)</b>	<b>Vertical Depth (usft)</b>	<b>+N/-S (usft)</b>	<b>+E/-W (usft)</b>	<b>Dogleg Rate (°/100usft)</b>	<b>Build Rate (°/100usft)</b>	<b>Turn Rate (°/100usft)</b>	<b>TFO (°)</b>	<b>Target</b>
0.00	0.00	0.00	0.00	0.00	0.00	0.00	0.00	0.00	0.00	
1,600.00	0.00	0.00	1,600.00	0.00	0.00	0.00	0.00	0.00	0.00	
4,657.12	61.14	238.39	4,109.05	-776.92	-1,262.20	2.00	2.00	0.00	238.39	
8,808.63	61.14	238.39	6,112.70	-2,682.83	-4,358.63	0.00	0.00	0.00	0.00	
10,186.05	89.14	89.80	6,850.50	-3,358.34	-3,982.00	10.00	2.03	-10.79	-129.20	
19,679.07	89.14	89.80	6,993.00	-3,324.94	5,509.90	0.00	0.00	0.00	0.00	BHL 6X-HNB 1383 F5

<b>Database:</b>	EDM 5000.15 Single User Db	<b>Local Co-ordinate Reference:</b>	Well BLEHM-6X-HNB-10-07-67
<b>Company:</b>	Nickel Road Operating	<b>TVD Reference:</b>	KB @ 5115.00usft
<b>Project:</b>	Sec. 9-T7N-R67W	<b>MD Reference:</b>	KB @ 5115.00usft
<b>Site:</b>	BLEHM Pad	<b>North Reference:</b>	Grid
<b>Well:</b>	BLEHM-6X-HNB-10-07-67	<b>Survey Calculation Method:</b>	Minimum Curvature
<b>Wellbore:</b>	Wellbore #1		
<b>Design:</b>	Plan #2		

Planned Survey									
Measured Depth (usft)	Inclination (°)	Azimuth (°)	Vertical Depth (usft)	+N/-S (usft)	+E/-W (usft)	Map Northing (usft)	Map Easting (usft)	Latitude	Longitude
0.00	0.00	0.00	0.00	0.00	0.00	1,459,986.825	3,169,070.770	40.594469	-104.891195
<b>SHL 6X-HNB 542 FNL 712 FEL</b>									
100.00	0.00	0.00	100.00	0.00	0.00	1,459,986.825	3,169,070.770	40.594469	-104.891195
200.00	0.00	0.00	200.00	0.00	0.00	1,459,986.825	3,169,070.770	40.594469	-104.891195
300.00	0.00	0.00	300.00	0.00	0.00	1,459,986.825	3,169,070.770	40.594469	-104.891195
400.00	0.00	0.00	400.00	0.00	0.00	1,459,986.825	3,169,070.770	40.594469	-104.891195
500.00	0.00	0.00	500.00	0.00	0.00	1,459,986.825	3,169,070.770	40.594469	-104.891195
600.00	0.00	0.00	600.00	0.00	0.00	1,459,986.825	3,169,070.770	40.594469	-104.891195
700.00	0.00	0.00	700.00	0.00	0.00	1,459,986.825	3,169,070.770	40.594469	-104.891195
800.00	0.00	0.00	800.00	0.00	0.00	1,459,986.825	3,169,070.770	40.594469	-104.891195
900.00	0.00	0.00	900.00	0.00	0.00	1,459,986.825	3,169,070.770	40.594469	-104.891195
1,000.00	0.00	0.00	1,000.00	0.00	0.00	1,459,986.825	3,169,070.770	40.594469	-104.891195
1,100.00	0.00	0.00	1,100.00	0.00	0.00	1,459,986.825	3,169,070.770	40.594469	-104.891195
1,200.00	0.00	0.00	1,200.00	0.00	0.00	1,459,986.825	3,169,070.770	40.594469	-104.891195
1,300.00	0.00	0.00	1,300.00	0.00	0.00	1,459,986.825	3,169,070.770	40.594469	-104.891195
1,400.00	0.00	0.00	1,400.00	0.00	0.00	1,459,986.825	3,169,070.770	40.594469	-104.891195
1,500.00	0.00	0.00	1,500.00	0.00	0.00	1,459,986.825	3,169,070.770	40.594469	-104.891195
<b>Surf Csg</b>									
1,600.00	0.00	0.00	1,600.00	0.00	0.00	1,459,986.825	3,169,070.770	40.594469	-104.891195
<b>Start Build 2.00</b>									
1,700.00	2.00	238.39	1,699.98	-0.91	-1.49	1,459,985.911	3,169,069.284	40.594466	-104.891201
1,800.00	4.00	238.39	1,799.84	-3.66	-5.94	1,459,983.167	3,169,064.827	40.594459	-104.891217
1,900.00	6.00	238.39	1,899.45	-8.23	-13.36	1,459,978.599	3,169,057.405	40.594447	-104.891244
2,000.00	8.00	238.39	1,998.70	-14.61	-23.74	1,459,972.211	3,169,047.028	40.594429	-104.891281
2,100.00	10.00	238.39	2,097.47	-22.81	-37.06	1,459,964.012	3,169,033.706	40.594407	-104.891329
2,200.00	12.00	238.39	2,195.62	-32.82	-53.31	1,459,954.010	3,169,017.458	40.594380	-104.891388
2,300.00	14.00	238.39	2,293.06	-44.61	-72.47	1,459,942.219	3,168,998.302	40.594348	-104.891457
2,400.00	16.00	238.39	2,389.64	-58.17	-94.51	1,459,928.653	3,168,976.262	40.594311	-104.891537
2,500.00	18.00	238.39	2,485.27	-73.50	-119.41	1,459,913.328	3,168,951.364	40.594269	-104.891627
2,600.00	20.00	238.39	2,579.82	-90.56	-147.13	1,459,896.263	3,168,923.640	40.594223	-104.891727
2,700.00	22.00	238.39	2,673.17	-109.35	-177.65	1,459,877.479	3,168,893.123	40.594172	-104.891838
2,800.00	24.00	238.39	2,765.21	-129.83	-210.92	1,459,856.999	3,168,859.850	40.594117	-104.891958
2,900.00	26.00	238.39	2,855.84	-151.98	-246.91	1,459,834.847	3,168,823.861	40.594056	-104.892088
3,000.00	28.00	238.39	2,944.94	-175.77	-285.57	1,459,811.051	3,168,785.201	40.593992	-104.892228
3,100.00	30.00	238.39	3,032.39	-201.19	-326.85	1,459,785.639	3,168,743.916	40.593923	-104.892377
3,200.00	32.00	238.39	3,118.11	-228.18	-370.71	1,459,758.643	3,168,700.058	40.593850	-104.892536
3,300.00	34.00	238.39	3,201.97	-256.73	-417.09	1,459,730.096	3,168,653.678	40.593772	-104.892703
3,400.00	36.00	238.39	3,283.88	-286.79	-465.94	1,459,700.031	3,168,604.835	40.593691	-104.892880
3,500.00	38.00	238.39	3,363.74	-318.34	-517.18	1,459,668.487	3,168,553.585	40.593605	-104.893065
3,600.00	40.00	238.39	3,441.45	-351.32	-570.77	1,459,635.501	3,168,499.995	40.593515	-104.893259
3,700.00	42.00	238.39	3,516.92	-385.71	-626.64	1,459,601.113	3,168,444.127	40.593422	-104.893461
3,800.00	44.00	238.39	3,590.05	-421.46	-684.72	1,459,565.365	3,168,386.051	40.593325	-104.893671
3,900.00	46.00	238.39	3,660.76	-458.52	-744.93	1,459,528.302	3,168,325.836	40.593224	-104.893889
4,000.00	48.00	238.39	3,728.95	-496.86	-807.21	1,459,489.968	3,168,263.557	40.593120	-104.894114
4,100.00	50.00	238.39	3,794.56	-536.42	-871.48	1,459,450.409	3,168,199.289	40.593013	-104.894346
4,200.00	52.00	238.39	3,857.48	-577.15	-937.66	1,459,409.675	3,168,133.110	40.592902	-104.894586
4,300.00	54.00	238.39	3,917.66	-619.01	-1,005.67	1,459,367.814	3,168,065.101	40.592789	-104.894832
4,400.00	56.00	238.39	3,975.02	-661.95	-1,075.42	1,459,324.877	3,167,995.345	40.592672	-104.895084
4,500.00	58.00	238.39	4,029.48	-705.91	-1,146.84	1,459,280.918	3,167,923.927	40.592553	-104.895342
4,600.00	60.00	238.39	4,080.98	-750.84	-1,219.84	1,459,235.989	3,167,850.934	40.592431	-104.895606
4,657.12	61.14	238.39	4,109.05	-776.92	-1,262.20	1,459,209.910	3,167,808.565	40.592360	-104.895759
<b>Hold 61.14 Inc, 238.39 Az</b>									
4,700.00	61.14	238.39	4,129.74	-796.60	-1,294.18	1,459,190.225	3,167,776.585	40.592307	-104.895875
4,800.00	61.14	238.39	4,178.00	-842.51	-1,368.77	1,459,144.316	3,167,702.000	40.592182	-104.896145

<b>Database:</b>	EDM 5000.15 Single User Db	<b>Local Co-ordinate Reference:</b>	Well BLEHM-6X-HNB-10-07-67
<b>Company:</b>	Nickel Road Operating	<b>TVD Reference:</b>	KB @ 5115.00usft
<b>Project:</b>	Sec. 9-T7N-R67W	<b>MD Reference:</b>	KB @ 5115.00usft
<b>Site:</b>	BLEHM Pad	<b>North Reference:</b>	Grid
<b>Well:</b>	BLEHM-6X-HNB-10-07-67	<b>Survey Calculation Method:</b>	Minimum Curvature
<b>Wellbore:</b>	Wellbore #1		
<b>Design:</b>	Plan #2		

Planned Survey									
Measured Depth (usft)	Inclination (°)	Azimuth (°)	Vertical Depth (usft)	+N/-S (usft)	+E/-W (usft)	Map Northing (usft)	Map Easting (usft)	Latitude	Longitude
4,900.00	61.14	238.39	4,226.27	-888.42	-1,443.36	1,459,098.407	3,167,627.414	40.592057	-104.896414
5,000.00	61.14	238.39	4,274.53	-934.33	-1,517.94	1,459,052.498	3,167,552.829	40.591933	-104.896684
5,100.00	61.14	238.39	4,322.79	-980.24	-1,592.53	1,459,006.589	3,167,478.243	40.591808	-104.896954
5,200.00	61.14	238.39	4,371.06	-1,026.15	-1,667.11	1,458,960.680	3,167,403.658	40.591684	-104.897223
5,300.00	61.14	238.39	4,419.32	-1,072.05	-1,741.70	1,458,914.771	3,167,329.072	40.591559	-104.897493
5,400.00	61.14	238.39	4,467.58	-1,117.96	-1,816.28	1,458,868.862	3,167,254.487	40.591434	-104.897763
5,500.00	61.14	238.39	4,515.85	-1,163.87	-1,890.87	1,458,822.953	3,167,179.901	40.591310	-104.898032
5,600.00	61.14	238.39	4,564.11	-1,209.78	-1,965.45	1,458,777.043	3,167,105.316	40.591185	-104.898302
5,700.00	61.14	238.39	4,612.37	-1,255.69	-2,040.04	1,458,731.134	3,167,030.730	40.591061	-104.898572
5,800.00	61.14	238.39	4,660.64	-1,301.60	-2,114.62	1,458,685.225	3,166,956.145	40.590936	-104.898841
5,900.00	61.14	238.39	4,708.90	-1,347.51	-2,189.21	1,458,639.316	3,166,881.559	40.590811	-104.899111
6,000.00	61.14	238.39	4,757.16	-1,393.42	-2,263.80	1,458,593.407	3,166,806.973	40.590687	-104.899381
6,100.00	61.14	238.39	4,805.43	-1,439.33	-2,338.38	1,458,547.498	3,166,732.388	40.590562	-104.899650
6,200.00	61.14	238.39	4,853.69	-1,485.24	-2,412.97	1,458,501.589	3,166,657.802	40.590437	-104.899920
6,300.00	61.14	238.39	4,901.95	-1,531.15	-2,487.55	1,458,455.680	3,166,583.217	40.590313	-104.900190
6,400.00	61.14	238.39	4,950.22	-1,577.06	-2,562.14	1,458,409.770	3,166,508.631	40.590188	-104.900459
6,500.00	61.14	238.39	4,998.48	-1,622.96	-2,636.72	1,458,363.861	3,166,434.046	40.590063	-104.900729
6,600.00	61.14	238.39	5,046.74	-1,668.87	-2,711.31	1,458,317.952	3,166,359.460	40.589939	-104.900999
6,700.00	61.14	238.39	5,095.01	-1,714.78	-2,785.89	1,458,272.043	3,166,284.875	40.589814	-104.901268
6,800.00	61.14	238.39	5,143.27	-1,760.69	-2,860.48	1,458,226.134	3,166,210.289	40.589690	-104.901538
6,900.00	61.14	238.39	5,191.53	-1,806.60	-2,935.07	1,458,180.225	3,166,135.704	40.589565	-104.901808
7,000.00	61.14	238.39	5,239.80	-1,852.51	-3,009.65	1,458,134.316	3,166,061.118	40.589440	-104.902077
7,100.00	61.14	238.39	5,288.06	-1,898.42	-3,084.24	1,458,088.407	3,165,986.533	40.589316	-104.902347
7,200.00	61.14	238.39	5,336.32	-1,944.33	-3,158.82	1,458,042.498	3,165,911.947	40.589191	-104.902617
7,300.00	61.14	238.39	5,384.59	-1,990.24	-3,233.41	1,457,996.588	3,165,837.362	40.589066	-104.902886
7,400.00	61.14	238.39	5,432.85	-2,036.15	-3,307.99	1,457,950.679	3,165,762.776	40.588942	-104.903156
7,500.00	61.14	238.39	5,481.11	-2,082.06	-3,382.58	1,457,904.770	3,165,688.190	40.588817	-104.903426
7,600.00	61.14	238.39	5,529.38	-2,127.96	-3,457.16	1,457,858.861	3,165,613.605	40.588693	-104.903695
7,700.00	61.14	238.39	5,577.64	-2,173.87	-3,531.75	1,457,812.952	3,165,539.019	40.588568	-104.903965
7,800.00	61.14	238.39	5,625.90	-2,219.78	-3,606.34	1,457,767.043	3,165,464.434	40.588443	-104.904235
7,900.00	61.14	238.39	5,674.17	-2,265.69	-3,680.92	1,457,721.134	3,165,389.848	40.588319	-104.904504
8,000.00	61.14	238.39	5,722.43	-2,311.60	-3,755.51	1,457,675.225	3,165,315.263	40.588194	-104.904774
8,100.00	61.14	238.39	5,770.69	-2,357.51	-3,830.09	1,457,629.316	3,165,240.677	40.588069	-104.905044
8,200.00	61.14	238.39	5,818.96	-2,403.42	-3,904.68	1,457,583.406	3,165,166.092	40.587945	-104.905313
8,300.00	61.14	238.39	5,867.22	-2,449.33	-3,979.26	1,457,537.497	3,165,091.506	40.587820	-104.905583
8,400.00	61.14	238.39	5,915.48	-2,495.24	-4,053.85	1,457,491.588	3,165,016.921	40.587695	-104.905852
8,500.00	61.14	238.39	5,963.75	-2,541.15	-4,128.43	1,457,445.679	3,164,942.335	40.587571	-104.906122
8,600.00	61.14	238.39	6,012.01	-2,587.06	-4,203.02	1,457,399.770	3,164,867.750	40.587446	-104.906392
8,700.00	61.14	238.39	6,060.27	-2,632.96	-4,277.61	1,457,353.861	3,164,793.164	40.587322	-104.906661
8,800.00	61.14	238.39	6,108.54	-2,678.87	-4,352.19	1,457,307.952	3,164,718.579	40.587197	-104.906931
8,808.63	61.14	238.39	6,112.70	-2,682.83	-4,358.63	1,457,303.991	3,164,712.143	40.587186	-104.906954
KOP 10°/100									
8,900.00	55.64	229.81	6,160.64	-2,728.24	-4,421.65	1,457,258.584	3,164,649.123	40.587063	-104.907182
9,000.00	50.40	219.13	6,220.88	-2,784.90	-4,477.64	1,457,201.923	3,164,593.134	40.586908	-104.907385
9,100.00	46.29	206.92	6,287.47	-2,847.17	-4,518.41	1,457,139.656	3,164,552.355	40.586738	-104.907534
9,200.00	43.64	193.25	6,358.39	-2,913.15	-4,542.74	1,457,073.676	3,164,528.026	40.586557	-104.907623
9,300.00	42.75	178.68	6,431.48	-2,980.84	-4,549.88	1,457,005.988	3,164,520.885	40.586372	-104.907650
9,400.00	43.72	164.12	6,504.52	-3,048.18	-4,539.62	1,456,938.647	3,164,531.149	40.586187	-104.907615
9,500.00	46.44	150.51	6,575.29	-3,113.12	-4,512.26	1,456,873.702	3,164,558.507	40.586008	-104.907518
9,600.00	50.61	138.37	6,641.64	-3,173.70	-4,468.64	1,456,813.124	3,164,602.127	40.585841	-104.907362
9,700.00	55.90	127.75	6,701.55	-3,228.07	-4,410.09	1,456,758.754	3,164,660.684	40.585690	-104.907153
9,800.00	61.98	118.47	6,753.21	-3,274.58	-4,338.37	1,456,712.245	3,164,732.399	40.585561	-104.906896
9,900.00	68.61	110.23	6,795.04	-3,311.82	-4,255.68	1,456,675.009	3,164,815.093	40.585458	-104.906599
10,000.00	75.61	102.72	6,825.78	-3,338.65	-4,164.52	1,456,648.178	3,164,906.253	40.585382	-104.906271

<b>Database:</b>	EDM 5000.15 Single User Db	<b>Local Co-ordinate Reference:</b>	Well BLEHM-6X-HNB-10-07-67
<b>Company:</b>	Nickel Road Operating	<b>TVD Reference:</b>	KB @ 5115.00usft
<b>Project:</b>	Sec. 9-T7N-R67W	<b>MD Reference:</b>	KB @ 5115.00usft
<b>Site:</b>	BLEHM Pad	<b>North Reference:</b>	Grid
<b>Well:</b>	BLEHM-6X-HNB-10-07-67	<b>Survey Calculation Method:</b>	Minimum Curvature
<b>Wellbore:</b>	Wellbore #1		
<b>Design:</b>	Plan #2		

Planned Survey										
Measured Depth (usft)	Inclination (°)	Azimuth (°)	Vertical Depth (usft)	+N/-S (usft)	+E/-W (usft)	Map Northing (usft)	Map Easting (usft)	Latitude	Longitude	
10,077.96	81.23	97.20	6,841.43	-3,351.81	-4,089.35	1,456,635.014	3,164,981.419	40.585345	-104.906001	
LPL 6X-HNB 1383 FSL 460 FWL										
10,100.00	82.84	95.68	6,844.48	-3,354.26	-4,067.66	1,456,632.567	3,165,003.109	40.585338	-104.905923	
10,186.05	89.14	89.80	6,850.50	-3,358.34	-3,982.00	1,456,628.487	3,165,088.769	40.585325	-104.905615	
LP 89.14 Inc, 89.80 Az										
10,200.00	89.14	89.80	6,850.71	-3,358.29	-3,968.05	1,456,628.535	3,165,102.718	40.585325	-104.905564	
10,300.00	89.14	89.80	6,852.21	-3,357.94	-3,868.06	1,456,628.883	3,165,202.706	40.585324	-104.905204	
10,400.00	89.14	89.80	6,853.71	-3,357.59	-3,768.08	1,456,629.231	3,165,302.694	40.585323	-104.904844	
10,500.00	89.14	89.80	6,855.21	-3,357.25	-3,668.09	1,456,629.579	3,165,402.682	40.585322	-104.904484	
10,600.00	89.14	89.80	6,856.71	-3,356.90	-3,568.10	1,456,629.926	3,165,502.671	40.585321	-104.904124	
10,700.00	89.14	89.80	6,858.21	-3,356.55	-3,468.11	1,456,630.274	3,165,602.659	40.585320	-104.903764	
10,800.00	89.14	89.80	6,859.71	-3,356.20	-3,368.12	1,456,630.622	3,165,702.647	40.585320	-104.903404	
10,900.00	89.14	89.80	6,861.21	-3,355.86	-3,268.13	1,456,630.970	3,165,802.635	40.585319	-104.903044	
11,000.00	89.14	89.80	6,862.71	-3,355.51	-3,168.15	1,456,631.318	3,165,902.623	40.585318	-104.902684	
11,100.00	89.14	89.80	6,864.21	-3,355.16	-3,068.16	1,456,631.665	3,166,002.611	40.585317	-104.902324	
11,200.00	89.14	89.80	6,865.70	-3,354.81	-2,968.17	1,456,632.013	3,166,102.600	40.585316	-104.901964	
11,300.00	89.14	89.80	6,867.20	-3,354.46	-2,868.18	1,456,632.361	3,166,202.588	40.585315	-104.901604	
11,400.00	89.14	89.80	6,868.70	-3,354.12	-2,768.19	1,456,632.709	3,166,302.576	40.585314	-104.901244	
11,500.00	89.14	89.80	6,870.20	-3,353.77	-2,668.21	1,456,633.057	3,166,402.564	40.585313	-104.900884	
11,600.00	89.14	89.80	6,871.70	-3,353.42	-2,568.22	1,456,633.405	3,166,502.552	40.585312	-104.900524	
11,700.00	89.14	89.80	6,873.20	-3,353.07	-2,468.23	1,456,633.752	3,166,602.540	40.585312	-104.900164	
11,800.00	89.14	89.80	6,874.70	-3,352.73	-2,368.24	1,456,634.100	3,166,702.528	40.585311	-104.899804	
11,900.00	89.14	89.80	6,876.20	-3,352.38	-2,268.25	1,456,634.448	3,166,802.517	40.585310	-104.899444	
12,000.00	89.14	89.80	6,877.70	-3,352.03	-2,168.26	1,456,634.796	3,166,902.505	40.585309	-104.899084	
12,100.00	89.14	89.80	6,879.20	-3,351.68	-2,068.28	1,456,635.144	3,167,002.493	40.585308	-104.898725	
12,200.00	89.14	89.80	6,880.70	-3,351.33	-1,968.29	1,456,635.492	3,167,102.481	40.585307	-104.898365	
12,300.00	89.14	89.80	6,882.20	-3,350.99	-1,868.30	1,456,635.839	3,167,202.469	40.585306	-104.898005	
12,400.00	89.14	89.80	6,883.70	-3,350.64	-1,768.31	1,456,636.187	3,167,302.457	40.585305	-104.897645	
12,500.00	89.14	89.80	6,885.20	-3,350.29	-1,668.32	1,456,636.535	3,167,402.445	40.585304	-104.897285	
12,600.00	89.14	89.80	6,886.70	-3,349.94	-1,568.34	1,456,636.883	3,167,502.434	40.585303	-104.896925	
12,700.00	89.14	89.80	6,888.20	-3,349.59	-1,468.35	1,456,637.231	3,167,602.422	40.585302	-104.896565	
12,800.00	89.14	89.80	6,889.70	-3,349.25	-1,368.36	1,456,637.579	3,167,702.410	40.585302	-104.896205	
12,900.00	89.14	89.80	6,891.20	-3,348.90	-1,268.37	1,456,637.926	3,167,802.398	40.585301	-104.895845	
13,000.00	89.14	89.80	6,892.70	-3,348.55	-1,168.38	1,456,638.274	3,167,902.386	40.585300	-104.895485	
13,100.00	89.14	89.80	6,894.20	-3,348.20	-1,068.40	1,456,638.622	3,168,002.374	40.585299	-104.895125	
13,200.00	89.14	89.80	6,895.70	-3,347.86	-968.41	1,456,638.970	3,168,102.362	40.585298	-104.894765	
13,300.00	89.14	89.80	6,897.20	-3,347.51	-868.42	1,456,639.318	3,168,202.351	40.585297	-104.894405	
13,400.00	89.14	89.80	6,898.69	-3,347.16	-768.43	1,456,639.665	3,168,302.339	40.585296	-104.894045	
13,500.00	89.14	89.80	6,900.19	-3,346.81	-668.44	1,456,640.013	3,168,402.327	40.585295	-104.893685	
13,600.00	89.14	89.80	6,901.69	-3,346.46	-568.45	1,456,640.361	3,168,502.315	40.585294	-104.893325	
13,700.00	89.14	89.80	6,903.19	-3,346.12	-468.47	1,456,640.709	3,168,602.304	40.585293	-104.892965	
13,800.00	89.14	89.80	6,904.69	-3,345.77	-368.48	1,456,641.057	3,168,702.292	40.585292	-104.892605	
13,900.00	89.14	89.80	6,906.19	-3,345.42	-268.49	1,456,641.405	3,168,802.280	40.585291	-104.892245	
14,000.00	89.14	89.80	6,907.69	-3,345.07	-168.50	1,456,641.752	3,168,902.269	40.585290	-104.891885	
14,100.00	89.14	89.80	6,909.19	-3,344.73	-68.51	1,456,642.100	3,169,002.257	40.585290	-104.891525	
14,200.00	89.14	89.80	6,910.69	-3,344.38	31.47	1,456,642.448	3,169,102.245	40.585289	-104.891165	
14,300.00	89.14	89.80	6,912.19	-3,344.03	131.46	1,456,642.796	3,169,202.233	40.585288	-104.890805	
14,400.00	89.14	89.80	6,913.69	-3,343.68	231.45	1,456,643.144	3,169,302.221	40.585287	-104.890445	
14,500.00	89.14	89.80	6,915.19	-3,343.33	331.44	1,456,643.492	3,169,402.209	40.585286	-104.890085	
14,600.00	89.14	89.80	6,916.69	-3,342.99	431.43	1,456,643.839	3,169,502.197	40.585285	-104.889725	
14,700.00	89.14	89.80	6,918.19	-3,342.64	531.42	1,456,644.187	3,169,602.186	40.585284	-104.889365	
14,800.00	89.14	89.80	6,919.69	-3,342.29	631.40	1,456,644.535	3,169,702.174	40.585283	-104.889005	
14,900.00	89.14	89.80	6,921.19	-3,341.94	731.39	1,456,644.883	3,169,802.162	40.585282	-104.888645	
15,000.00	89.14	89.80	6,922.69	-3,341.60	831.38	1,456,645.231	3,169,902.150	40.585281	-104.888285	

<b>Database:</b>	EDM 5000.15 Single User Db	<b>Local Co-ordinate Reference:</b>	Well BLEHM-6X-HNB-10-07-67
<b>Company:</b>	Nickel Road Operating	<b>TVD Reference:</b>	KB @ 5115.00usft
<b>Project:</b>	Sec. 9-T7N-R67W	<b>MD Reference:</b>	KB @ 5115.00usft
<b>Site:</b>	BLEHM Pad	<b>North Reference:</b>	Grid
<b>Well:</b>	BLEHM-6X-HNB-10-07-67	<b>Survey Calculation Method:</b>	Minimum Curvature
<b>Wellbore:</b>	Wellbore #1		
<b>Design:</b>	Plan #2		

Planned Survey									
Measured Depth (usft)	Inclination (°)	Azimuth (°)	Vertical Depth (usft)	+N/-S (usft)	+E/-W (usft)	Map Northing (usft)	Map Easting (usft)	Latitude	Longitude
15,100.00	89.14	89.80	6,924.19	-3,341.25	931.37	1,456,645.579	3,170,002.138	40.585280	-104.887925
15,200.00	89.14	89.80	6,925.69	-3,340.90	1,031.36	1,456,645.926	3,170,102.126	40.585279	-104.887565
15,300.00	89.14	89.80	6,927.19	-3,340.55	1,131.34	1,456,646.274	3,170,202.115	40.585278	-104.887205
15,400.00	89.14	89.80	6,928.69	-3,340.20	1,231.33	1,456,646.622	3,170,302.103	40.585277	-104.886845
15,500.00	89.14	89.80	6,930.19	-3,339.86	1,331.32	1,456,646.970	3,170,402.091	40.585276	-104.886485
15,600.00	89.14	89.80	6,931.68	-3,339.51	1,431.31	1,456,647.318	3,170,502.079	40.585276	-104.886125
15,700.00	89.14	89.80	6,933.18	-3,339.16	1,531.30	1,456,647.665	3,170,602.067	40.585275	-104.885765
15,800.00	89.14	89.80	6,934.68	-3,338.81	1,631.29	1,456,648.013	3,170,702.055	40.585274	-104.885405
15,900.00	89.14	89.80	6,936.18	-3,338.46	1,731.27	1,456,648.361	3,170,802.043	40.585273	-104.885045
16,000.00	89.14	89.80	6,937.68	-3,338.12	1,831.26	1,456,648.709	3,170,902.032	40.585272	-104.884685
16,100.00	89.14	89.80	6,939.18	-3,337.77	1,931.25	1,456,649.057	3,171,002.020	40.585271	-104.884325
16,200.00	89.14	89.80	6,940.68	-3,337.42	2,031.24	1,456,649.405	3,171,102.008	40.585270	-104.883965
16,300.00	89.14	89.80	6,942.18	-3,337.07	2,131.23	1,456,649.752	3,171,201.996	40.585269	-104.883605
16,400.00	89.14	89.80	6,943.68	-3,336.73	2,231.21	1,456,650.100	3,171,301.984	40.585268	-104.883245
16,500.00	89.14	89.80	6,945.18	-3,336.38	2,331.20	1,456,650.448	3,171,401.972	40.585267	-104.882885
16,600.00	89.14	89.80	6,946.68	-3,336.03	2,431.19	1,456,650.796	3,171,501.960	40.585266	-104.882525
16,700.00	89.14	89.80	6,948.18	-3,335.68	2,531.18	1,456,651.144	3,171,601.949	40.585265	-104.882165
16,800.00	89.14	89.80	6,949.68	-3,335.33	2,631.17	1,456,651.492	3,171,701.937	40.585264	-104.881805
16,900.00	89.14	89.80	6,951.18	-3,334.99	2,731.15	1,456,651.839	3,171,801.925	40.585263	-104.881445
17,000.00	89.14	89.80	6,952.68	-3,334.64	2,831.14	1,456,652.187	3,171,901.913	40.585262	-104.881085
17,100.00	89.14	89.80	6,954.18	-3,334.29	2,931.13	1,456,652.535	3,172,001.901	40.585261	-104.880725
17,200.00	89.14	89.80	6,955.68	-3,333.94	3,031.12	1,456,652.883	3,172,101.889	40.585260	-104.880365
17,300.00	89.14	89.80	6,957.18	-3,333.60	3,131.11	1,456,653.231	3,172,201.877	40.585259	-104.880005
17,400.00	89.14	89.80	6,958.68	-3,333.25	3,231.10	1,456,653.578	3,172,301.866	40.585258	-104.879645
17,500.00	89.14	89.80	6,960.18	-3,332.90	3,331.08	1,456,653.926	3,172,401.854	40.585257	-104.879285
17,600.00	89.14	89.80	6,961.68	-3,332.55	3,431.07	1,456,654.274	3,172,501.842	40.585256	-104.878925
17,700.00	89.14	89.80	6,963.18	-3,332.20	3,531.06	1,456,654.622	3,172,601.830	40.585255	-104.878565
17,800.00	89.14	89.80	6,964.67	-3,331.86	3,631.05	1,456,654.970	3,172,701.818	40.585254	-104.878205
17,900.00	89.14	89.80	6,966.17	-3,331.51	3,731.04	1,456,655.318	3,172,801.806	40.585253	-104.877845
18,000.00	89.14	89.80	6,967.67	-3,331.16	3,831.02	1,456,655.665	3,172,901.794	40.585252	-104.877485
18,100.00	89.14	89.80	6,969.17	-3,330.81	3,931.01	1,456,656.013	3,173,001.783	40.585252	-104.877125
18,200.00	89.14	89.80	6,970.67	-3,330.46	4,031.00	1,456,656.361	3,173,101.771	40.585251	-104.876765
18,300.00	89.14	89.80	6,972.17	-3,330.12	4,130.99	1,456,656.709	3,173,201.759	40.585250	-104.876405
18,400.00	89.14	89.80	6,973.67	-3,329.77	4,230.98	1,456,657.057	3,173,301.747	40.585249	-104.876045
18,500.00	89.14	89.80	6,975.17	-3,329.42	4,330.97	1,456,657.405	3,173,401.735	40.585248	-104.875685
18,600.00	89.14	89.80	6,976.67	-3,329.07	4,430.95	1,456,657.752	3,173,501.723	40.585247	-104.875325
18,700.00	89.14	89.80	6,978.17	-3,328.73	4,530.94	1,456,658.100	3,173,601.711	40.585246	-104.874965
18,800.00	89.14	89.80	6,979.67	-3,328.38	4,630.93	1,456,658.448	3,173,701.700	40.585245	-104.874605
18,900.00	89.14	89.80	6,981.17	-3,328.03	4,730.92	1,456,658.796	3,173,801.688	40.585244	-104.874245
19,000.00	89.14	89.80	6,982.67	-3,327.68	4,830.91	1,456,659.144	3,173,901.676	40.585243	-104.873885
19,100.00	89.14	89.80	6,984.17	-3,327.33	4,930.89	1,456,659.492	3,174,001.664	40.585242	-104.873525
19,200.00	89.14	89.80	6,985.67	-3,326.99	5,030.88	1,456,659.839	3,174,101.652	40.585241	-104.873165
19,300.00	89.14	89.80	6,987.17	-3,326.64	5,130.87	1,456,660.187	3,174,201.640	40.585240	-104.872805
19,400.00	89.14	89.80	6,988.67	-3,326.29	5,230.86	1,456,660.535	3,174,301.629	40.585239	-104.872445
19,500.00	89.14	89.80	6,990.17	-3,325.94	5,330.85	1,456,660.883	3,174,401.617	40.585238	-104.872085
19,600.00	89.14	89.80	6,991.67	-3,325.60	5,430.83	1,456,661.231	3,174,501.605	40.585237	-104.871725
19,679.07	89.14	89.80	6,993.00	-3,324.94	5,509.90	1,456,661.888	3,174,580.666	40.585237	-104.871440
TD at 19679.07 - BHL 6X-HNB 1383 FSL 460 FEL									

<b>Database:</b>	EDM 5000.15 Single User Db	<b>Local Co-ordinate Reference:</b>	Well BLEHM-6X-HNB-10-07-67
<b>Company:</b>	Nickel Road Operating	<b>TVD Reference:</b>	KB @ 5115.00usft
<b>Project:</b>	Sec. 9-T7N-R67W	<b>MD Reference:</b>	KB @ 5115.00usft
<b>Site:</b>	BLEHM Pad	<b>North Reference:</b>	Grid
<b>Well:</b>	BLEHM-6X-HNB-10-07-67	<b>Survey Calculation Method:</b>	Minimum Curvature
<b>Wellbore:</b>	Wellbore #1		
<b>Design:</b>	Plan #2		

Design Targets									
Target Name	Dip Angle	Dip Dir.	TVD	+N/-S	+E/-W	Northing	Easting	Latitude	Longitude
- hit/miss target	(°)	(°)	(usft)	(usft)	(usft)	(usft)	(usft)		
- Shape									
SHL 6X-HNB 542 FNL 7	0.00	0.00	0.00	0.00	0.00	1,459,986.825	3,169,070.770	40.594469	-104.891195
- plan hits target center									
- Point									
LPL 6X-HNB 1383 FSL 4	0.00	0.00	6,849.00	-3,358.34	-4,091.89	1,456,628.487	3,164,978.879	40.585327	-104.906010
- plan misses target center by 10.32usft at 10077.96usft MD (6841.42 TVD, -3351.81 N, -4089.35 E)									
- Point									
BHL 6X-HNB 1383 FSL	0.00	0.00	6,993.00	-3,324.94	5,509.90	1,456,661.888	3,174,580.666	40.585237	-104.871440
- plan hits target center									
- Point									

Plan Annotations				
Measured Depth	Vertical Depth	Local Coordinates		Comment
(usft)	(usft)	+N/-S (usft)	+E/-W (usft)	
1,500.00	1,500.00	0.00	0.00	Surf Csg
1,600.00	1,600.00	0.00	0.00	Start Build 2.00
4,657.12	4,109.05	-776.92	-1,262.20	Hold 61.14 Inc, 238.39 Az
8,808.63	6,112.70	-2,682.83	-4,358.63	KOP 10°/100
10,186.05	6,850.50	-3,358.34	-3,982.00	LP 89.14 Inc, 89.80 Az
19,679.07	6,993.00	-3,324.94	5,509.90	TD at 19679.07