

PETROLEUM FIELD SERVICES, LLC7535 HILLTOP CIRCLEDENVER, CO 80221

LOCATION DRAWING

LD15-09 PAD

SECTION: 15  
TOWNSHIP: 9N  
RANGE: 58W

IMPROVEMENTS:

(MEASURED FROM THE PROPOSED TATANKA FEDERAL LD13-645 WELL LOCATION)

- EL

NO BUILDING UNITS WITHIN 500' IMPROVEMENT BUFFER
- B

NO BUILDINGS WITHIN 500' IMPROVEMENT BUFFER
- 1

FENCE 652' N, 304' E, 487' S, 574' SW
- 2

OVERHEAD UTILITY 309' E
- 3

INTERMITTENT STREAMS (DRY AT TIME OF SURVEY) 441' NE, 673' NW
- 4

IGO CREEK (DRY AT TIME OF SURVEY) 850' S

CULTURAL ITEMS: MEASURED FROM THE NEAREST PROPOSED WELLHEAD	
BUILDING:	1876' S
BUILDING UNIT:	2255' S
HIGH OCUPANCY BUILDING UNIT:	5280'+
DESIGNATED OUTSIDE ACTIVITY AREA:	5280'+
PUBLIC ROAD:	2339' S (WCR 104)
ABOVE GROUND UTILITY:	307' E
RAILROAD:	5280'+
PROPERTY LINE:	335' E

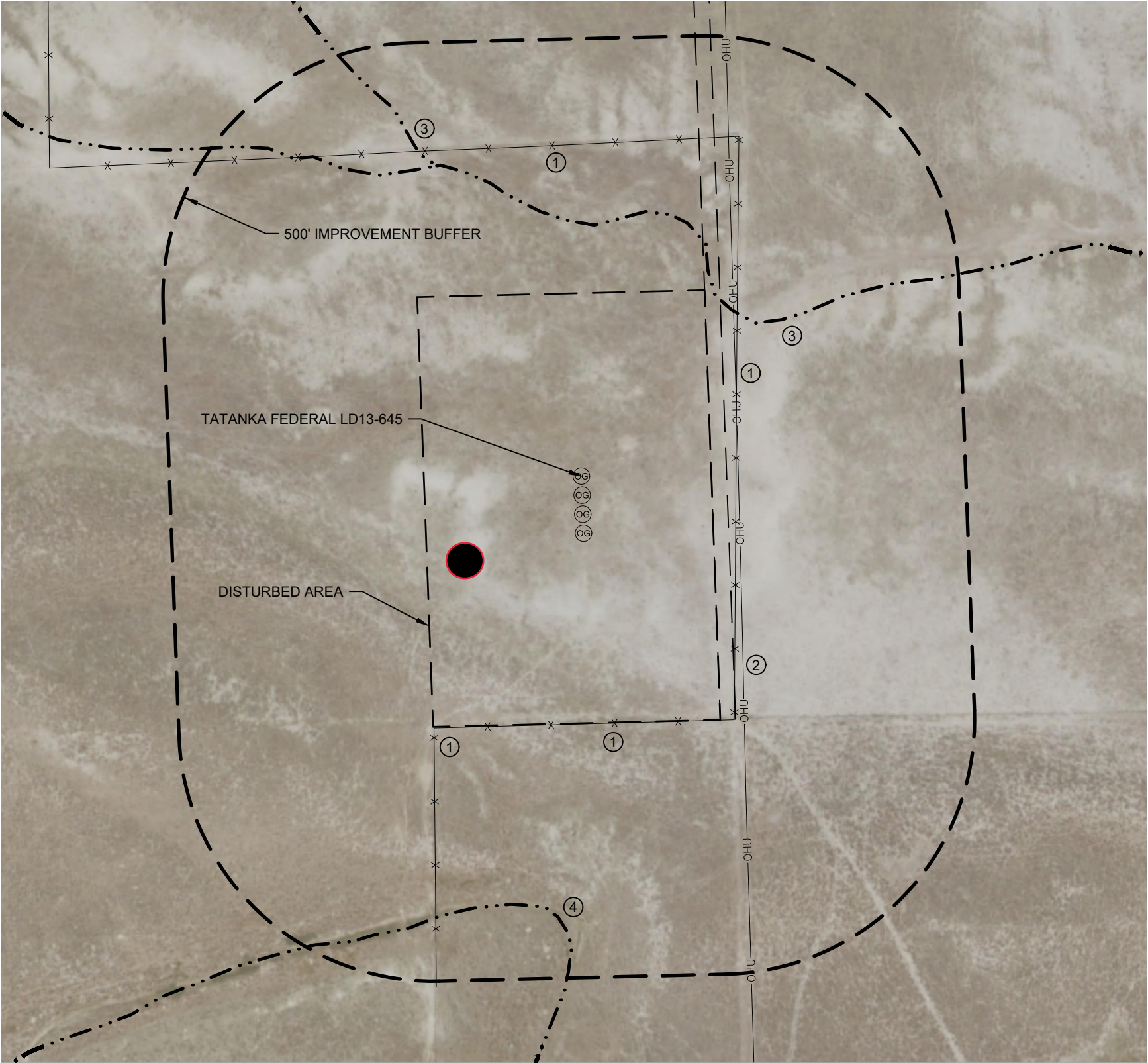

FIELD DATE: 10-20-16
DRAWING DATE: 06-28-18
DRAWN BY: CSG
CHECKED BY: KAD

DISCLAIMER:  
THIS PLOT DOES NOT REPRESENT A MONUMENTED LAND SURVEY AND SHOULD NOT BE RELIED UPON TO DETERMINE BOUNDARY LINES, PROPERTY OWNERSHIP OR OTHER PROPERTY INTERESTS. PARCEL LINES, IF DEPICTED HAVE NOT BEEN FIELD VERIFIED AND MAY BE BASED UPON PUBLICLY AVAILABLE DATA THAT ALSO HAS NOT BEEN INDEPENDENTLY VERIFIED.

DATA SOURCE:  
  
AERIAL IMAGERY: NAIP 2017  
NHD: USGS  
  
PUBLICLY AVAILABLE DATA SOURCES HAVE NOT BEEN INDEPENDENTLY VERIFIED BY PFS.

