

CANVASBACK PAD REFERENCE AREA MAP

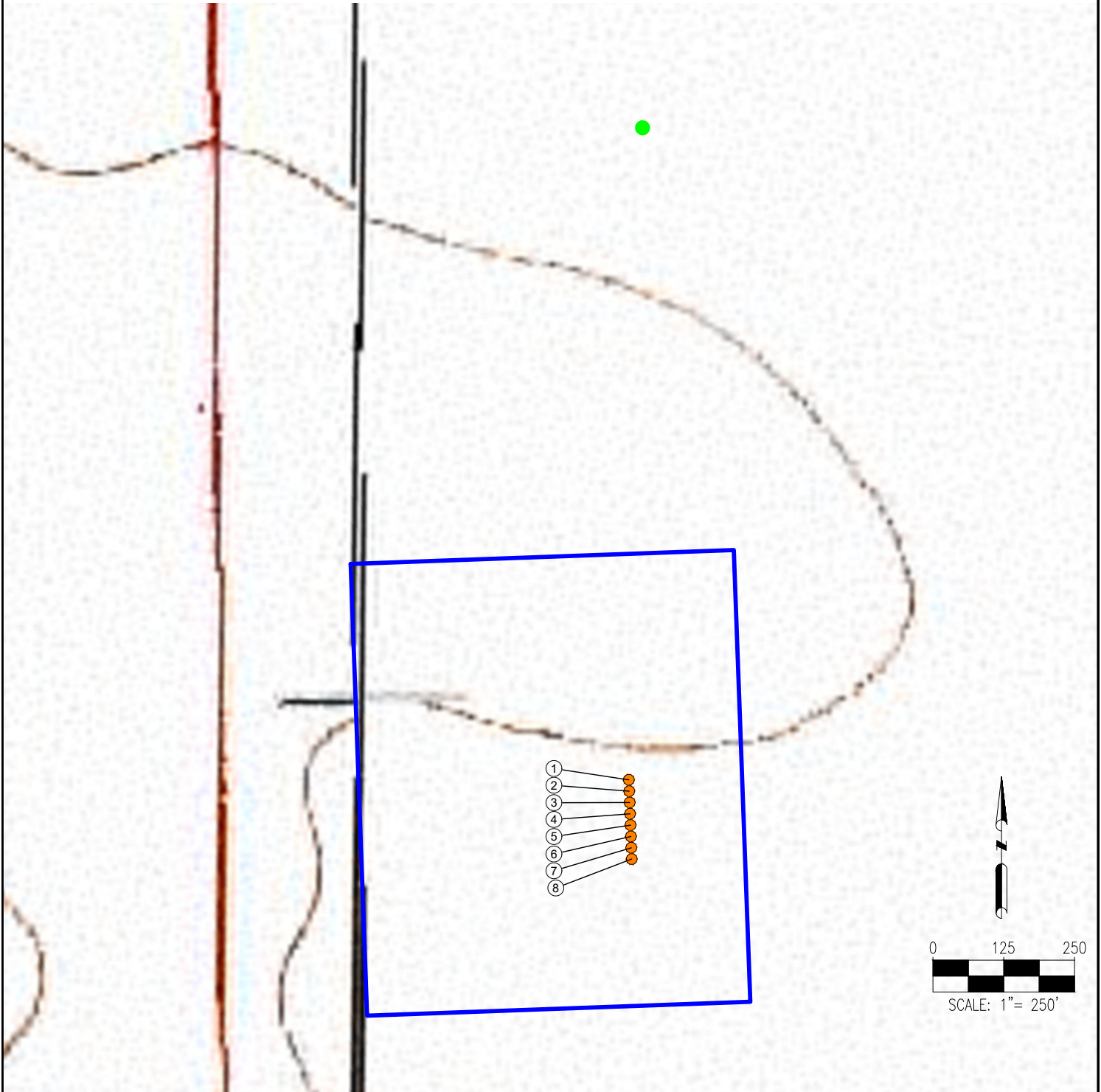

1. CANVASBACK FED 32-33-1HC
2. CANVASBACK FED 32-33-2HN
3. CANVASBACK FED 32-33-3HN
4. CANVASBACK FED 32-33-4HN
5. CANVASBACK 32-33-5HN
6. CANVASBACK 32-33-6HC
7. CANVASBACK 32-33-7HN
8. CANVASBACK 32-33-8HN

REFERENCE LOCATION

****REFERENCE PHOTO POINT****

LAT: 40.711098° N
LONG: 104.123706° W
ELEVATION: 4943'

DISCLAIMER:
THIS PLOT DOES NOT REPRESENT A MONUMENTED LAND SURVEY AND SHOULD NOT BE RELIED UPON TO DETERMINE BOUNDARY LINES. PROPERTY OWNERSHIP OR OTHER PROPERTY INTERESTS. PARCEL LINES, IF DEPICTED HAVE NOT BEEN FIELD VERIFIED AND MAY BE BASED UPON PUBLICLY AVAILABLE DATA THAT ALSO HAS NOT BEEN INDEPENDENTLY VERIFIED.

DATA SOURCE:
TOPO MAP: USGS

PUBLICLY AVAILABLE DATA SOURCES HAVE NOT BEEN INDEPENDENTLY VERIFIED BY ASCENT.

LEGEND:



= PROPOSED WELL



= REFERENCE PHOTO POINT



= PROPOSED DISTURBANCE AREA



8620 Wolff Court
Westminster, CO 80031
(303) 928-7128
www.ascentgeomatics.com

FIELD DATE:
04-26-18

DRAWING DATE:
10-16-20

BY:
JW

CHECKED:
IJM

SITE NAME:
CANVASBACK PAD

SURFACE LOCATION:
**SW 1/4 NW 1/4 SEC. 32, T9N, R60W, 6TH P.M.
WELD COUNTY, COLORADO**

PREPARED FOR:

