



FORM F-106



RECEIVED

SEP -2 1971

COLO. OIL & GAS CONS. COMM.

R. 88 W.

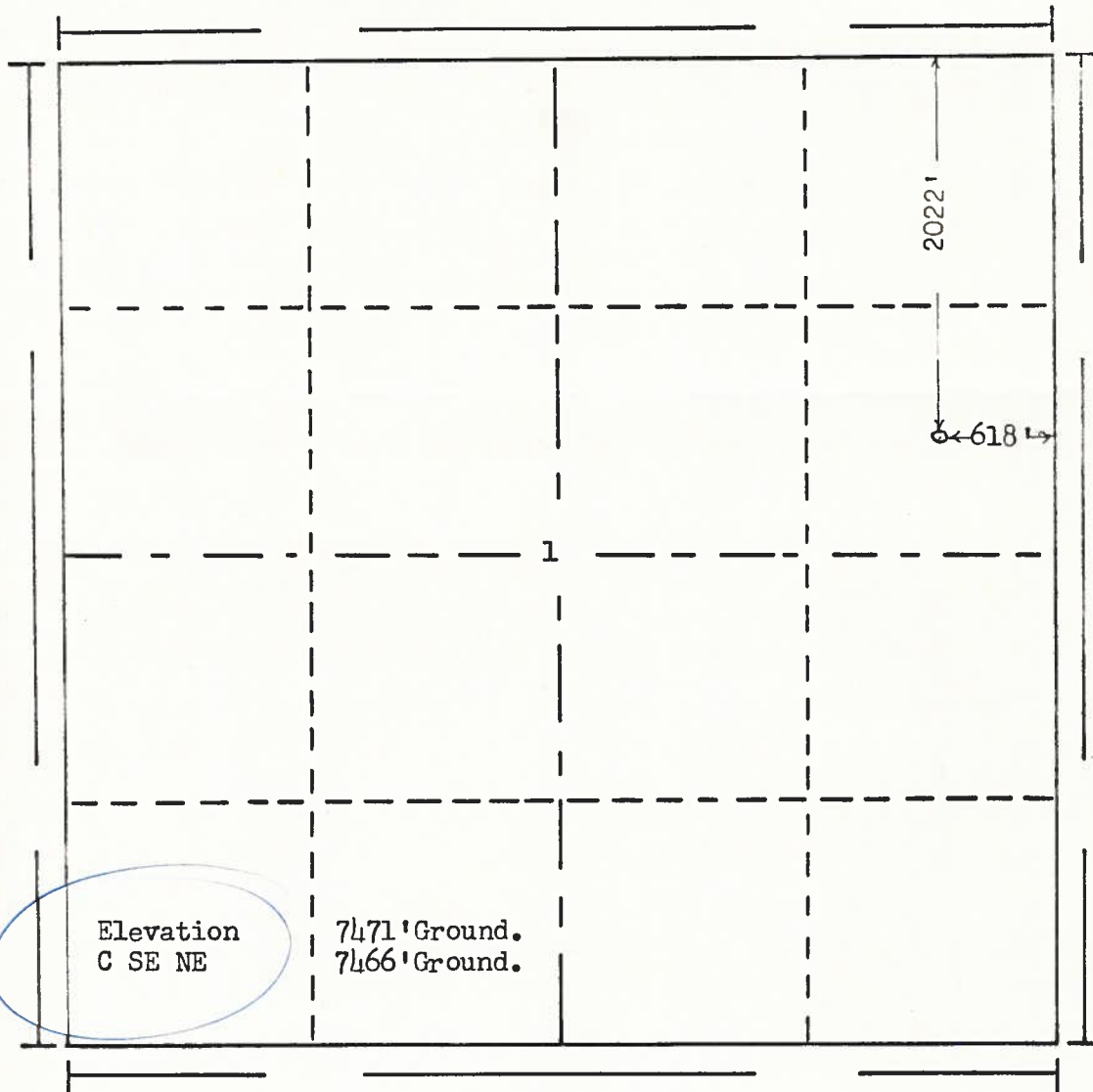
T.
11
N.

Scale... 1" = 1000'

Powers Elevation Company, Inc. of Denver, Colorado
has in accordance with a request from James Lichlyter
for W.D.A. Corporation
determined the location of #1 Grynberg-Federal
to be 2022' FN & 618' FE Section 1 Township 11 N.
Range 88 W. of the 6th Principal Meridian
Route County, Colorado

71 662

I hereby certify that this plat is an
accurate representation of a correct
survey showing the location of

#1 Grynberg-Federal

Date: 8-5-71

Danell T. White
Licensed Land Surveyor No. 1671
State of Colorado