

BONANZA CREEK ENERGY

Location: COLORADO Slot: SLOT#11 MULE DEER 34-32-29XRLNB (291'FNL & 2131'FEL,SEC.05)
Field: WELD COUNTY (NAD83/TRUE) Well: MULE DEER 34-32-29XRLNB
Facility: SEC.05-T06N-R61W Wellbore: MULE DEER 34-32-29XRLNB PWB

Plot reference wellpath is MULE DEER 34-32-29XRLNB (REV-B.0) PWP	Grid System: NAD83 / Lambert Colorado SP, Northern Zone (501), US feet
True vertical depths are referenced to RIG (17) (RXB)	North Reference: True north
Reference wellpath measured depths are referenced to RIG (17) (RXB)	Scale: True distance
RIG (17) (RXB) to Mean Sea Level: 4676 feet	Coordinates are in feet referenced to Slot
Mean Sea Level to Ground level (At Slot: SLOT#11 MULE DEER 34-32-29XRLNB (291'FNL & 2131'FEL,SEC.05)): 0 feet	Depths are in feet
Other wellpath MDs are referenced to each path's default MD datum	Created by: robie01 on 2020-03-12; Database: WellArchitectDB2

Location Information

Facility Name				Grid East (US ft)	Grid North (US ft)	Latitude	Longitude
SEC.05-T06N-R61W				3352971.931	1404526.872	40°26'12.8400"N	104°13'54.8760"W
Slot	Local N (ft)	Local E (ft)	Grid East (US ft)	Grid North (US ft)	Latitude	Longitude	
SLOT#11 MULE DEER 34-32-29XRLNB (291'FNL & 2131'FEL,SEC.05)	-92.17	160.34	3353133.568	1404437.007	40°26'11.9292"N	104°13'52.8024"W	
RIG (17) (RXB) to Ground level (At Slot: SLOT#11 MULE DEER 34-32-29XRLNB (291'FNL & 2131'FEL,SEC.05))						4676ft	
Mean Sea Level to Ground level (At Slot: SLOT#11 MULE DEER 34-32-29XRLNB (291'FNL & 2131'FEL,SEC.05))						0ft	
RIG (17) (RXB) to Mean Sea Level						4676ft	

Survey Program

Start MD (ft)	End MD (ft)	Tool	Model	Log Name/Comment	Wellbore
17.00	1500.00	BH NavitTrak (superseded model)	BH NavitTrak (Rotating+Axial Corr)		MULE DEER 34-32-29XRLNB PWB
1500.00	16075.52	BH AutoTrak Curve (superseded model)	BH AutoTrak Curve (Short)		MULE DEER 34-32-29XRLNB PWB

Targets

Name	MD (ft)	TVD (ft)	Local N (ft)	Local E (ft)	Grid East (US ft)	Grid North (US ft)	Latitude	Longitude
SEC.29-T06N-R61W	N/A	-2.00	856.15	-607.84	3352513.47	1405284.33	40°26'20.3892"N	104°14'05.6648"W
SEC.32-T06N-R61W	N/A	-2.00	856.15	-607.84	3352513.47	1405284.33	40°26'20.3892"N	104°14'05.6648"W
SEC.05-T06N-R61W	N/A	0.00	-9840.86	-1941.14	3351333.48	1394569.78	40°24'34.6850"N	104°14'17.8960"W
MULE DEER 34-32-29XRLNB (MLT 2146'FEL)	11268.36	6126.00	5566.01	-13.92	3353040.03	1410002.02	40°27'6.9300"N	104°13'52.9824"W
MULE DEER 34-32-29XRLNB BHL REV-2 (470'FNL & 2138'FEL,SEC.29)	16075.52	6126.00	10373.16	-9.17	3352976.00	1414808.56	40°27'54.4320"N	104°13'52.9210"W
MULE DEER 34-32-29XRLNB LP REV-2 (470'FSL & 2154'FEL,SEC.32)	6462.63	6126.00	760.28	-22.86	3353099.84	1405196.86	40°26'19.4420"N	104°13'53.0980"W

Hole and Casing Sections

Name	Start MD (ft)	End MD (ft)	Interval (ft)	Start TVD (ft)	End TVD (ft)	Start Local N (ft)	Start Local E (ft)	End Local N (ft)	End Local E (ft)	Wellbore
13.5in Open Hole	17.00	1500.00	1483.00	17.00	1495.39	0.00	0.00	90.24	-11.52	MULE DEER 34-32-29XRLNB PWB
9.625in Casing Surface	17.00	1500.00	1483.00	17.00	1495.39	0.00	0.00	90.24	-11.52	MULE DEER 34-32-29XRLNB PWB
8.5in Open Hole	1500.00	16075.52	14575.52	1495.39	N/A	90.24	-11.52	N/A	N/A	MULE DEER 34-32-29XRLNB PWB

Well Profile Data

Design Comment	MD (ft)	Inc (°)	Az (°)	TVD (ft)	Local N (ft)	Local E (ft)	DLS (°/100ft)	VS (ft)
Tie On	17.00	0.000	352.722	17.00	0.00	0.00	0.00	0.00
End of Tangent	500.00	0.000	352.722	500.00	0.00	0.00	0.00	0.00
End of Build	808.75	6.175	352.722	808.15	16.49	-2.11	2.00	16.49
End of Tangent	2255.38	6.175	352.722	2246.39	170.84	-21.82	0.00	170.86
End of Drop	2564.13	0.000	0.107	2554.54	187.33	-23.92	2.00	187.35
End of Tangent	5562.63	0.000	0.107	5553.04	187.33	-23.92	0.00	187.35
End of Build	6462.63	90.000	0.107	6126.00	760.28	-22.86	10.00	760.30
End of Tangent	11268.36	90.000	0.107	6126.00	5566.01	-13.92	0.00	5566.02
End of 3D Arc	11270.86	90.000	0.057	6126.00	5568.51	-13.91	2.00	5568.52
End of Tangent	16075.52	90.000	0.057	6126.00	10373.16	-9.17	0.00	10373.16

Bottom Hole Location

MD (ft)	Inc (°)	Az (°)	TVD (ft)	Local N (ft)	Local E (ft)	Grid East (US ft)	Grid North (US ft)	Latitude	Longitude
16075.52	90.000	0.057	6126.00	10373.16	-9.17	3352976.00	1414808.56	40°27'54.4320"N	104°13'52.9210"W

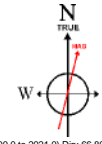
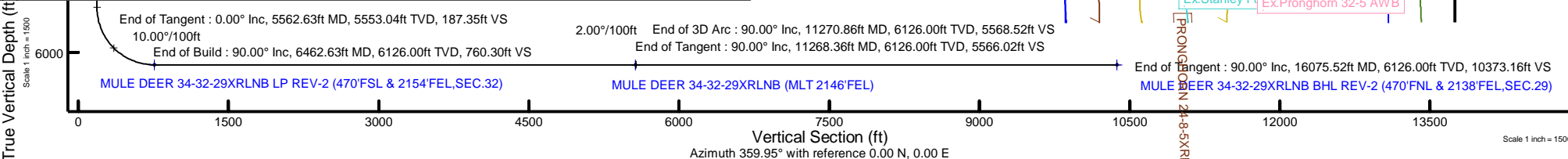

BGGM (1900.0 to 2021.0) Dip: 66.89° Field: 51965 nT
Magnetic North is 7.89 degrees East of True North (at 3/12/2020)

To correct azimuth from Magnetic to True add 7.89 degrees

Scale 1 inch = 2500

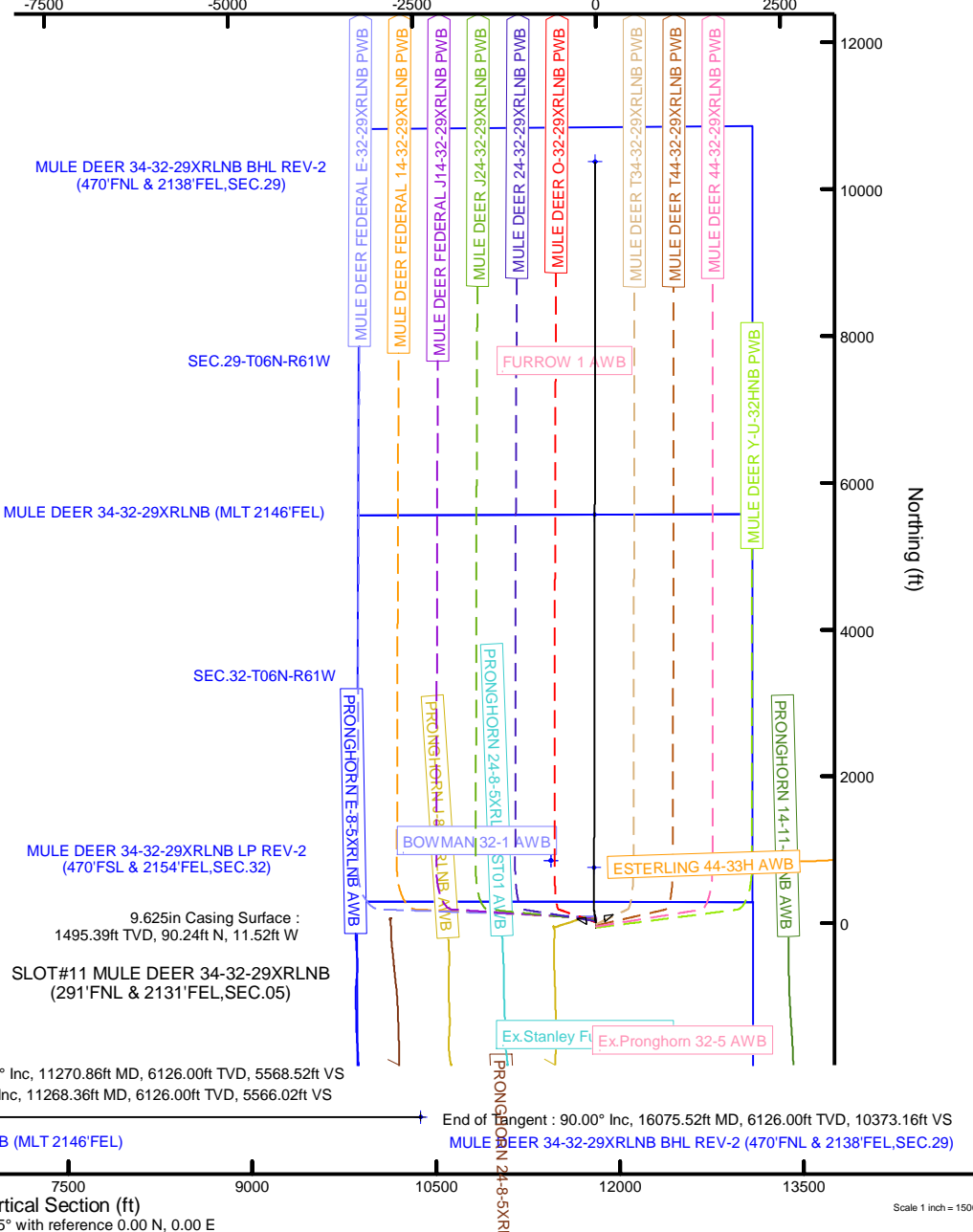



Planned Wellpath Report

MULE DEER 34-32-29XRLNB (REV-B.0) PWP

Page 1 of 10



REFERENCE WELLPATH IDENTIFICATION			
Operator	BONANZA CREEK ENERGY	Well	MULE DEER 34-32-29XRLNB
Field	WELD COUNTY (NAD83/TRUE)	API/Legal	
Facility	SEC.05-T05N-R61W	Wellbore	MULE DEER 34-32-29XRLNB PWB
Slot	SLOT#11 MULE DEER 34-32-29XRLNB (291'FNL & 2131'FEL,SEC.05)		

REPORT SETUP INFORMATION			
Projection System	NAD83 / Lambert Colorado SP, Northern Zone (501), US feet	Software System	WellArchitect® 6.0
North Reference	True	User	Robiale01
Scale	0.999962	Report Generated	3/12/2020 at 11:34:13 AM
Convergence at slot	0.82° East	Database	WellArchitectDB2

WELLPATH LOCATION						
	Local coordinates		Grid coordinates		Geographic coordinates	
	North[ft]	East[ft]	Easting[US ft]	Northing[US ft]	Latitude	Longitude
Slot Location	-92.17	160.34	3353133.57	1404437.01	40°26'11.9292"N	104°13'52.8024"W
Facility Reference Pt			3352971.93	1404526.87	40°26'12.8400"N	104°13'54.8760"W
Field Reference Pt			3224525.77	1254425.87	40°01'44.4000"N	104°41'53.5560"W

WELLPATH DATUM			
Calculation method	Minimum curvature	RIG (17") (RKB) to Facility Vertical Datum	4676.00ft
Horizontal Reference Pt	Slot	RIG (17") (RKB) to Mean Sea Level	4676.00ft
Vertical Reference Pt	RIG (17") (RKB)	RIG (17") (RKB) to Ground Level at Slot (SLOT#11 MULE DEER 34-32-29XRLNB (291'FNL & 2131'FEL,SEC.05))	4676.00ft
MD Reference Pt	RIG (17") (RKB)	Section Origin	N 0.00, E 0.00 ft
Field Vertical Reference	Mean Sea Level	Section Azimuth	359.95°



Planned Wellpath Report
MULE DEER 34-32-29XRLNB (REV-B.0) PWP
Page 2 of 10



REFERENCE WELLPATH IDENTIFICATION			
Operator	BONANZA CREEK ENERGY	Well	MULE DEER 34-32-29XRLNB
Field	WELD COUNTY (NAD83/TRUE)	API/Legal	
Facility	SEC.05-T05N-R61W	Wellbore	MULE DEER 34-32-29XRLNB PWB
Slot	SLOT#11 MULE DEER 34-32-29XRLNB (291'FNL & 2131'FEL,SEC.05)		

WELLPATH DATA (171 stations) † = interpolated, ‡ = extrapolated station										
MD [ft]	Inclination [°]	Azimuth [°]	TVD [ft]	Vert Sect [ft]	North [ft]	East [ft]	Latitude	Longitude	DLS [°/100ft]	Comments
0.00†	0.000	352.722	0.00	0.00	0.00	0.00	40°26'11.9292"N	104°13'52.8024"W	0.00	
17.00	0.000	352.722	17.00	0.00	0.00	0.00	40°26'11.9292"N	104°13'52.8024"W	0.00	Tie On
117.00†	0.000	352.722	117.00	0.00	0.00	0.00	40°26'11.9292"N	104°13'52.8024"W	0.00	
217.00†	0.000	352.722	217.00	0.00	0.00	0.00	40°26'11.9292"N	104°13'52.8024"W	0.00	
317.00†	0.000	352.722	317.00	0.00	0.00	0.00	40°26'11.9292"N	104°13'52.8024"W	0.00	
417.00†	0.000	352.722	417.00	0.00	0.00	0.00	40°26'11.9292"N	104°13'52.8024"W	0.00	
500.00	0.000	352.722	500.00	0.00	0.00	0.00	40°26'11.9292"N	104°13'52.8024"W	0.00	End of Tangent
517.00†	0.340	352.722	517.00	0.05	0.05	-0.01	40°26'11.9297"N	104°13'52.8025"W	2.00	
617.00†	2.340	352.722	616.97	2.37	2.37	-0.30	40°26'11.9526"N	104°13'52.8063"W	2.00	
717.00†	4.340	352.722	716.79	8.15	8.15	-1.04	40°26'12.0097"N	104°13'52.8159"W	2.00	
808.75	6.175	352.722	808.15	16.49	16.49	-2.11	40°26'12.0921"N	104°13'52.8296"W	2.00	End of Build
817.00†	6.175	352.722	816.35	17.37	17.37	-2.22	40°26'12.1008"N	104°13'52.8311"W	0.00	
917.00†	6.175	352.722	915.77	28.04	28.04	-3.58	40°26'12.2063"N	104°13'52.8487"W	0.00	
1017.00†	6.175	352.722	1015.19	38.71	38.71	-4.94	40°26'12.3117"N	104°13'52.8663"W	0.00	
1117.00†	6.175	352.722	1114.61	49.38	49.38	-6.31	40°26'12.4171"N	104°13'52.8839"W	0.00	
1217.00†	6.175	352.722	1214.03	60.05	60.05	-7.67	40°26'12.5226"N	104°13'52.9016"W	0.00	
1317.00†	6.175	352.722	1313.45	70.72	70.72	-9.03	40°26'12.6280"N	104°13'52.9192"W	0.00	
1417.00†	6.175	352.722	1412.87	81.40	81.39	-10.39	40°26'12.7334"N	104°13'52.9368"W	0.00	
1517.00†	6.175	352.722	1512.29	92.07	92.06	-11.76	40°26'12.8389"N	104°13'52.9544"W	0.00	
1617.00†	6.175	352.722	1611.71	102.74	102.73	-13.12	40°26'12.9443"N	104°13'52.9721"W	0.00	
1717.00†	6.175	352.722	1711.13	113.41	113.40	-14.48	40°26'13.0497"N	104°13'52.9897"W	0.00	
1817.00†	6.175	352.722	1810.55	124.08	124.07	-15.84	40°26'13.1552"N	104°13'53.0073"W	0.00	
1917.00†	6.175	352.722	1909.97	134.75	134.74	-17.21	40°26'13.2606"N	104°13'53.0249"W	0.00	
2017.00†	6.175	352.722	2009.39	145.42	145.40	-18.57	40°26'13.3660"N	104°13'53.0425"W	0.00	
2117.00†	6.175	352.722	2108.81	156.09	156.07	-19.93	40°26'13.4715"N	104°13'53.0602"W	0.00	
2217.00†	6.175	352.722	2208.23	166.76	166.74	-21.29	40°26'13.5769"N	104°13'53.0778"W	0.00	
2255.38	6.175	352.722	2246.39	170.86	170.84	-21.82	40°26'13.6174"N	104°13'53.0845"W	0.00	End of Tangent
2317.00†	4.943	352.722	2307.72	176.78	176.76	-22.57	40°26'13.6759"N	104°13'53.0943"W	2.00	
2417.00†	2.943	352.722	2407.48	183.60	183.58	-23.44	40°26'13.7433"N	104°13'53.1056"W	2.00	
2517.00†	0.943	352.722	2507.41	186.96	186.94	-23.87	40°26'13.7765"N	104°13'53.1111"W	2.00	



Planned Wellpath Report
MULE DEER 34-32-29XRLNB (REV-B.0) PWP
Page 3 of 10



REFERENCE WELLPATH IDENTIFICATION			
Operator	BONANZA CREEK ENERGY	Well	MULE DEER 34-32-29XRLNB
Field	WELD COUNTY (NAD83/TRUE)	API/Legal	
Facility	SEC.05-T05N-R61W	Wellbore	MULE DEER 34-32-29XRLNB PWB
Slot	SLOT#11 MULE DEER 34-32-29XRLNB (291'FNL & 2131'FEL,SEC.05)		

WELLPATH DATA (171 stations) † = interpolated, ‡ = extrapolated station										
MD [ft]	Inclination [°]	Azimuth [°]	TVD [ft]	Vert Sect [ft]	North [ft]	East [ft]	Latitude	Longitude	DLS [°/100ft]	Comments
2564.13	0.000	0.107	2554.54	187.35	187.33	-23.92	40°26'13.7803"N	104°13'53.1118"W	2.00	End of Drop
2617.00†	0.000	0.107	2607.41	187.35	187.33	-23.92	40°26'13.7803"N	104°13'53.1118"W	0.00	
2717.00†	0.000	0.107	2707.41	187.35	187.33	-23.92	40°26'13.7803"N	104°13'53.1118"W	0.00	
2817.00†	0.000	0.107	2807.41	187.35	187.33	-23.92	40°26'13.7803"N	104°13'53.1118"W	0.00	
2917.00†	0.000	0.107	2907.41	187.35	187.33	-23.92	40°26'13.7803"N	104°13'53.1118"W	0.00	
3017.00†	0.000	0.107	3007.41	187.35	187.33	-23.92	40°26'13.7803"N	104°13'53.1118"W	0.00	
3117.00†	0.000	0.107	3107.41	187.35	187.33	-23.92	40°26'13.7803"N	104°13'53.1118"W	0.00	
3217.00†	0.000	0.107	3207.41	187.35	187.33	-23.92	40°26'13.7803"N	104°13'53.1118"W	0.00	
3317.00†	0.000	0.107	3307.41	187.35	187.33	-23.92	40°26'13.7803"N	104°13'53.1118"W	0.00	
3417.00†	0.000	0.107	3407.41	187.35	187.33	-23.92	40°26'13.7803"N	104°13'53.1118"W	0.00	
3517.00†	0.000	0.107	3507.41	187.35	187.33	-23.92	40°26'13.7803"N	104°13'53.1118"W	0.00	
3617.00†	0.000	0.107	3607.41	187.35	187.33	-23.92	40°26'13.7803"N	104°13'53.1118"W	0.00	
3717.00†	0.000	0.107	3707.41	187.35	187.33	-23.92	40°26'13.7803"N	104°13'53.1118"W	0.00	
3817.00†	0.000	0.107	3807.41	187.35	187.33	-23.92	40°26'13.7803"N	104°13'53.1118"W	0.00	
3917.00†	0.000	0.107	3907.41	187.35	187.33	-23.92	40°26'13.7803"N	104°13'53.1118"W	0.00	
4017.00†	0.000	0.107	4007.41	187.35	187.33	-23.92	40°26'13.7803"N	104°13'53.1118"W	0.00	
4117.00†	0.000	0.107	4107.41	187.35	187.33	-23.92	40°26'13.7803"N	104°13'53.1118"W	0.00	
4217.00†	0.000	0.107	4207.41	187.35	187.33	-23.92	40°26'13.7803"N	104°13'53.1118"W	0.00	
4317.00†	0.000	0.107	4307.41	187.35	187.33	-23.92	40°26'13.7803"N	104°13'53.1118"W	0.00	
4417.00†	0.000	0.107	4407.41	187.35	187.33	-23.92	40°26'13.7803"N	104°13'53.1118"W	0.00	
4517.00†	0.000	0.107	4507.41	187.35	187.33	-23.92	40°26'13.7803"N	104°13'53.1118"W	0.00	
4617.00†	0.000	0.107	4607.41	187.35	187.33	-23.92	40°26'13.7803"N	104°13'53.1118"W	0.00	
4717.00†	0.000	0.107	4707.41	187.35	187.33	-23.92	40°26'13.7803"N	104°13'53.1118"W	0.00	
4817.00†	0.000	0.107	4807.41	187.35	187.33	-23.92	40°26'13.7803"N	104°13'53.1118"W	0.00	
4917.00†	0.000	0.107	4907.41	187.35	187.33	-23.92	40°26'13.7803"N	104°13'53.1118"W	0.00	
5017.00†	0.000	0.107	5007.41	187.35	187.33	-23.92	40°26'13.7803"N	104°13'53.1118"W	0.00	
5117.00†	0.000	0.107	5107.41	187.35	187.33	-23.92	40°26'13.7803"N	104°13'53.1118"W	0.00	
5217.00†	0.000	0.107	5207.41	187.35	187.33	-23.92	40°26'13.7803"N	104°13'53.1118"W	0.00	
5317.00†	0.000	0.107	5307.41	187.35	187.33	-23.92	40°26'13.7803"N	104°13'53.1118"W	0.00	
5417.00†	0.000	0.107	5407.41	187.35	187.33	-23.92	40°26'13.7803"N	104°13'53.1118"W	0.00	



Planned Wellpath Report
MULE DEER 34-32-29XRLNB (REV-B.0) PWP
Page 4 of 10



REFERENCE WELLPATH IDENTIFICATION			
Operator	BONANZA CREEK ENERGY	Well	MULE DEER 34-32-29XRLNB
Field	WELD COUNTY (NAD83/TRUE)	API/Legal	
Facility	SEC.05-T05N-R61W	Wellbore	MULE DEER 34-32-29XRLNB PWB
Slot	SLOT#11 MULE DEER 34-32-29XRLNB (291'FNL & 2131'FEL,SEC.05)		

WELLPATH DATA (171 stations) † = interpolated, ‡ = extrapolated station										
MD [ft]	Inclination [°]	Azimuth [°]	TVD [ft]	Vert Sect [ft]	North [ft]	East [ft]	Latitude	Longitude	DLS [°/100ft]	Comments
5517.00†	0.000	0.107	5507.41	187.35	187.33	-23.92	40°26'13.7803"N	104°13'53.1118"W	0.00	
5562.63	0.000	0.107	5553.04	187.35	187.33	-23.92	40°26'13.7803"N	104°13'53.1118"W	0.00	End of Tangent
5617.00†	5.437	0.107	5607.33	189.93	189.90	-23.92	40°26'13.8058"N	104°13'53.1117"W	10.00	
5717.00†	15.437	0.107	5705.55	208.02	208.00	-23.88	40°26'13.9845"N	104°13'53.1113"W	10.00	
5817.00†	25.437	0.107	5799.14	242.89	242.87	-23.82	40°26'14.3291"N	104°13'53.1104"W	10.00	
5917.00†	35.437	0.107	5885.25	293.49	293.47	-23.73	40°26'14.8291"N	104°13'53.1092"W	10.00	
6017.00†	45.437	0.107	5961.26	358.26	358.24	-23.60	40°26'15.4692"N	104°13'53.1077"W	10.00	
6117.00†	55.437	0.107	6024.87	435.26	435.24	-23.46	40°26'16.2300"N	104°13'53.1058"W	10.00	
6217.00†	65.437	0.107	6074.15	522.13	522.11	-23.30	40°26'17.0885"N	104°13'53.1037"W	10.00	
6317.00†	75.437	0.107	6107.59	616.24	616.22	-23.12	40°26'18.0184"N	104°13'53.1015"W	10.00	
6417.00†	85.437	0.107	6124.18	714.72	714.70	-22.94	40°26'18.9916"N	104°13'53.0991"W	10.00	
6462.63	90.000	0.107	6126.00†	760.30	760.28	-22.86	40°26'19.4420"N	104°13'53.0980"W	10.00	End of Build
6517.00†	90.000	0.107	6126.00	814.67	814.65	-22.76	40°26'19.9793"N	104°13'53.0967"W	0.00	
6617.00†	90.000	0.107	6126.00	914.67	914.65	-22.57	40°26'20.9674"N	104°13'53.0943"W	0.00	
6717.00†	90.000	0.107	6126.00	1014.67	1014.65	-22.38	40°26'21.9556"N	104°13'53.0919"W	0.00	
6817.00†	90.000	0.107	6126.00	1114.67	1114.65	-22.20	40°26'22.9437"N	104°13'53.0895"W	0.00	
6917.00†	90.000	0.107	6126.00	1214.67	1214.65	-22.01	40°26'23.9319"N	104°13'53.0871"W	0.00	
7017.00†	90.000	0.107	6126.00	1314.67	1314.65	-21.83	40°26'24.9200"N	104°13'53.0847"W	0.00	
7117.00†	90.000	0.107	6126.00	1414.67	1414.65	-21.64	40°26'25.9082"N	104°13'53.0823"W	0.00	
7217.00†	90.000	0.107	6126.00	1514.67	1514.65	-21.45	40°26'26.8963"N	104°13'53.0799"W	0.00	
7317.00†	90.000	0.107	6126.00	1614.67	1614.65	-21.27	40°26'27.8845"N	104°13'53.0775"W	0.00	
7417.00†	90.000	0.107	6126.00	1714.67	1714.65	-21.08	40°26'28.8727"N	104°13'53.0750"W	0.00	
7517.00†	90.000	0.107	6126.00	1814.67	1814.65	-20.89	40°26'29.8608"N	104°13'53.0726"W	0.00	
7617.00†	90.000	0.107	6126.00	1914.67	1914.65	-20.71	40°26'30.8490"N	104°13'53.0702"W	0.00	
7717.00†	90.000	0.107	6126.00	2014.67	2014.65	-20.52	40°26'31.8371"N	104°13'53.0678"W	0.00	
7817.00†	90.000	0.107	6126.00	2114.67	2114.65	-20.34	40°26'32.8253"N	104°13'53.0654"W	0.00	
7917.00†	90.000	0.107	6126.00	2214.67	2214.65	-20.15	40°26'33.8134"N	104°13'53.0630"W	0.00	
8017.00†	90.000	0.107	6126.00	2314.67	2314.65	-19.96	40°26'34.8016"N	104°13'53.0606"W	0.00	
8117.00†	90.000	0.107	6126.00	2414.67	2414.65	-19.78	40°26'35.7897"N	104°13'53.0582"W	0.00	
8217.00†	90.000	0.107	6126.00	2514.67	2514.65	-19.59	40°26'36.7779"N	104°13'53.0558"W	0.00	



Planned Wellpath Report
MULE DEER 34-32-29XRLNB (REV-B.0) PWP
Page 5 of 10



REFERENCE WELLPATH IDENTIFICATION			
Operator	BONANZA CREEK ENERGY	Well	MULE DEER 34-32-29XRLNB
Field	WELD COUNTY (NAD83/TRUE)	API/Legal	
Facility	SEC.05-T05N-R61W	Wellbore	MULE DEER 34-32-29XRLNB PWB
Slot	SLOT#11 MULE DEER 34-32-29XRLNB (291'FNL & 2131'FEL,SEC.05)		

WELLPATH DATA (171 stations) † = interpolated, ‡ = extrapolated station										
MD [ft]	Inclination [°]	Azimuth [°]	TVD [ft]	Vert Sect [ft]	North [ft]	East [ft]	Latitude	Longitude	DLS [°/100ft]	Comments
8317.00†	90.000	0.107	6126.00	2614.67	2614.65	-19.41	40°26'37.7660"N	104°13'53.0534"W	0.00	
8417.00†	90.000	0.107	6126.00	2714.67	2714.65	-19.22	40°26'38.7542"N	104°13'53.0510"W	0.00	
8517.00†	90.000	0.107	6126.00	2814.67	2814.65	-19.03	40°26'39.7424"N	104°13'53.0486"W	0.00	
8617.00†	90.000	0.107	6126.00	2914.67	2914.65	-18.85	40°26'40.7305"N	104°13'53.0462"W	0.00	
8717.00†	90.000	0.107	6126.00	3014.67	3014.65	-18.66	40°26'41.7187"N	104°13'53.0438"W	0.00	
8817.00†	90.000	0.107	6126.00	3114.66	3114.65	-18.48	40°26'42.7068"N	104°13'53.0414"W	0.00	
8917.00†	90.000	0.107	6126.00	3214.66	3214.65	-18.29	40°26'43.6950"N	104°13'53.0390"W	0.00	
9017.00†	90.000	0.107	6126.00	3314.66	3314.65	-18.10	40°26'44.6831"N	104°13'53.0366"W	0.00	
9117.00†	90.000	0.107	6126.00	3414.66	3414.65	-17.92	40°26'45.6713"N	104°13'53.0342"W	0.00	
9217.00†	90.000	0.107	6126.00	3514.66	3514.65	-17.73	40°26'46.6594"N	104°13'53.0318"W	0.00	
9317.00†	90.000	0.107	6126.00	3614.66	3614.65	-17.55	40°26'47.6476"N	104°13'53.0293"W	0.00	
9417.00†	90.000	0.107	6126.00	3714.66	3714.65	-17.36	40°26'48.6357"N	104°13'53.0269"W	0.00	
9517.00†	90.000	0.107	6126.00	3814.66	3814.65	-17.17	40°26'49.6239"N	104°13'53.0245"W	0.00	
9617.00†	90.000	0.107	6126.00	3914.66	3914.65	-16.99	40°26'50.6120"N	104°13'53.0221"W	0.00	
9717.00†	90.000	0.107	6126.00	4014.66	4014.65	-16.80	40°26'51.6002"N	104°13'53.0197"W	0.00	
9817.00†	90.000	0.107	6126.00	4114.66	4114.65	-16.62	40°26'52.5883"N	104°13'53.0173"W	0.00	
9917.00†	90.000	0.107	6126.00	4214.66	4214.65	-16.43	40°26'53.5765"N	104°13'53.0149"W	0.00	
10017.00†	90.000	0.107	6126.00	4314.66	4314.65	-16.24	40°26'54.5647"N	104°13'53.0125"W	0.00	
10117.00†	90.000	0.107	6126.00	4414.66	4414.65	-16.06	40°26'55.5528"N	104°13'53.0101"W	0.00	
10217.00†	90.000	0.107	6126.00	4514.66	4514.65	-15.87	40°26'56.5410"N	104°13'53.0077"W	0.00	
10317.00†	90.000	0.107	6126.00	4614.66	4614.65	-15.69	40°26'57.5291"N	104°13'53.0053"W	0.00	
10417.00†	90.000	0.107	6126.00	4714.66	4714.65	-15.50	40°26'58.5173"N	104°13'53.0029"W	0.00	
10517.00†	90.000	0.107	6126.00	4814.66	4814.65	-15.31	40°26'59.5054"N	104°13'53.0005"W	0.00	
10617.00†	90.000	0.107	6126.00	4914.66	4914.65	-15.13	40°27'0.4936"N	104°13'52.9981"W	0.00	
10717.00†	90.000	0.107	6126.00	5014.66	5014.65	-14.94	40°27'1.4817"N	104°13'52.9957"W	0.00	
10817.00†	90.000	0.107	6126.00	5114.66	5114.65	-14.76	40°27'2.4699"N	104°13'52.9933"W	0.00	
10917.00†	90.000	0.107	6126.00	5214.66	5214.65	-14.57	40°27'3.4580"N	104°13'52.9909"W	0.00	
11017.00†	90.000	0.107	6126.00	5314.66	5314.65	-14.38	40°27'4.4462"N	104°13'52.9884"W	0.00	
11117.00†	90.000	0.107	6126.00	5414.66	5414.65	-14.20	40°27'5.4343"N	104°13'52.9860"W	0.00	
11217.00†	90.000	0.107	6126.00	5514.66	5514.65	-14.01	40°27'6.4225"N	104°13'52.9836"W	0.00	



Planned Wellpath Report
MULE DEER 34-32-29XRLNB (REV-B.0) PWP
Page 6 of 10



REFERENCE WELLPATH IDENTIFICATION			
Operator	BONANZA CREEK ENERGY	Well	MULE DEER 34-32-29XRLNB
Field	WELD COUNTY (NAD83/TRUE)	API/Legal	
Facility	SEC.05-T05N-R61W	Wellbore	MULE DEER 34-32-29XRLNB PWB
Slot	SLOT#11 MULE DEER 34-32-29XRLNB (291'FNL & 2131'FEL,SEC.05)		

WELLPATH DATA (171 stations) † = interpolated, ‡ = extrapolated station										
MD [ft]	Inclination [°]	Azimuth [°]	TVD [ft]	Vert Sect [ft]	North [ft]	East [ft]	Latitude	Longitude	DLS [°/100ft]	Comments
11268.36	90.000	0.107	6126.00 [‡]	5566.02	5566.01	-13.92	40°27'6.9300"N	104°13'52.9824"W	0.00	End of Tangent
11270.86	90.000	0.057	6126.00	5568.52	5568.51	-13.91	40°27'6.9547"N	104°13'52.9824"W	2.00	End of 3D Arc
11317.00†	90.000	0.057	6126.00	5614.66	5614.65	-13.87	40°27'7.4106"N	104°13'52.9818"W	0.00	
11417.00†	90.000	0.057	6126.00	5714.66	5714.65	-13.77	40°27'8.3988"N	104°13'52.9805"W	0.00	
11517.00†	90.000	0.057	6126.00	5814.66	5814.65	-13.67	40°27'9.3869"N	104°13'52.9792"W	0.00	
11617.00†	90.000	0.057	6126.00	5914.66	5914.65	-13.57	40°27'10.3751"N	104°13'52.9779"W	0.00	
11717.00†	90.000	0.057	6126.00	6014.65	6014.65	-13.47	40°27'11.3633"N	104°13'52.9767"W	0.00	
11817.00†	90.000	0.057	6126.00	6114.65	6114.65	-13.37	40°27'12.3514"N	104°13'52.9754"W	0.00	
11917.00†	90.000	0.057	6126.00	6214.65	6214.65	-13.27	40°27'13.3396"N	104°13'52.9741"W	0.00	
12017.00†	90.000	0.057	6126.00	6314.65	6314.65	-13.17	40°27'14.3277"N	104°13'52.9728"W	0.00	
12117.00†	90.000	0.057	6126.00	6414.65	6414.65	-13.08	40°27'15.3159"N	104°13'52.9716"W	0.00	
12217.00†	90.000	0.057	6126.00	6514.65	6514.65	-12.98	40°27'16.3040"N	104°13'52.9703"W	0.00	
12317.00†	90.000	0.057	6126.00	6614.65	6614.65	-12.88	40°27'17.2922"N	104°13'52.9690"W	0.00	
12417.00†	90.000	0.057	6126.00	6714.65	6714.64	-12.78	40°27'18.2803"N	104°13'52.9677"W	0.00	
12517.00†	90.000	0.057	6126.00	6814.65	6814.64	-12.68	40°27'19.2685"N	104°13'52.9664"W	0.00	
12617.00†	90.000	0.057	6126.00	6914.65	6914.64	-12.58	40°27'20.2566"N	104°13'52.9652"W	0.00	
12717.00†	90.000	0.057	6126.00	7014.65	7014.64	-12.48	40°27'21.2448"N	104°13'52.9639"W	0.00	
12817.00†	90.000	0.057	6126.00	7114.65	7114.64	-12.38	40°27'22.2329"N	104°13'52.9626"W	0.00	
12917.00†	90.000	0.057	6126.00	7214.65	7214.64	-12.29	40°27'23.2211"N	104°13'52.9613"W	0.00	
13017.00†	90.000	0.057	6126.00	7314.65	7314.64	-12.19	40°27'24.2092"N	104°13'52.9601"W	0.00	
13117.00†	90.000	0.057	6126.00	7414.65	7414.64	-12.09	40°27'25.1974"N	104°13'52.9588"W	0.00	
13217.00†	90.000	0.057	6126.00	7514.65	7514.64	-11.99	40°27'26.1855"N	104°13'52.9575"W	0.00	
13317.00†	90.000	0.057	6126.00	7614.65	7614.64	-11.89	40°27'27.1737"N	104°13'52.9562"W	0.00	
13417.00†	90.000	0.057	6126.00	7714.65	7714.64	-11.79	40°27'28.1618"N	104°13'52.9550"W	0.00	
13517.00†	90.000	0.057	6126.00	7814.65	7814.64	-11.69	40°27'29.1500"N	104°13'52.9537"W	0.00	
13617.00†	90.000	0.057	6126.00	7914.65	7914.64	-11.59	40°27'30.1381"N	104°13'52.9524"W	0.00	
13717.00†	90.000	0.057	6126.00	8014.65	8014.64	-11.50	40°27'31.1263"N	104°13'52.9511"W	0.00	
13817.00†	90.000	0.057	6126.00	8114.65	8114.64	-11.40	40°27'32.1145"N	104°13'52.9498"W	0.00	
13917.00†	90.000	0.057	6126.00	8214.65	8214.64	-11.30	40°27'33.1026"N	104°13'52.9486"W	0.00	
14017.00†	90.000	0.057	6126.00	8314.65	8314.64	-11.20	40°27'34.0908"N	104°13'52.9473"W	0.00	



Planned Wellpath Report
MULE DEER 34-32-29XRLNB (REV-B.0) PWP
Page 7 of 10



REFERENCE WELLPATH IDENTIFICATION			
Operator	BONANZA CREEK ENERGY	Well	MULE DEER 34-32-29XRLNB
Field	WELD COUNTY (NAD83/TRUE)	API/Legal	
Facility	SEC.05-T05N-R61W	Wellbore	MULE DEER 34-32-29XRLNB PWB
Slot	SLOT#11 MULE DEER 34-32-29XRLNB (291'FNL & 2131'FEL,SEC.05)		

WELLPATH DATA (171 stations) † = interpolated, ‡ = extrapolated station										
MD [ft]	Inclination [°]	Azimuth [°]	TVD [ft]	Vert Sect [ft]	North [ft]	East [ft]	Latitude	Longitude	DLS [°/100ft]	Comments
14117.00†	90.000	0.057	6126.00	8414.65	8414.64	-11.10	40°27'35.0789"N	104°13'52.9460"W	0.00	
14217.00†	90.000	0.057	6126.00	8514.65	8514.64	-11.00	40°27'36.0671"N	104°13'52.9447"W	0.00	
14317.00†	90.000	0.057	6126.00	8614.65	8614.64	-10.90	40°27'37.0552"N	104°13'52.9435"W	0.00	
14417.00†	90.000	0.057	6126.00	8714.65	8714.64	-10.80	40°27'38.0434"N	104°13'52.9422"W	0.00	
14517.00†	90.000	0.057	6126.00	8814.65	8814.64	-10.71	40°27'39.0315"N	104°13'52.9409"W	0.00	
14617.00†	90.000	0.057	6126.00	8914.65	8914.64	-10.61	40°27'40.0197"N	104°13'52.9396"W	0.00	
14717.00†	90.000	0.057	6126.00	9014.65	9014.64	-10.51	40°27'41.0078"N	104°13'52.9384"W	0.00	
14817.00†	90.000	0.057	6126.00	9114.65	9114.64	-10.41	40°27'41.9960"N	104°13'52.9371"W	0.00	
14917.00†	90.000	0.057	6126.00	9214.65	9214.64	-10.31	40°27'42.9841"N	104°13'52.9358"W	0.00	
15017.00†	90.000	0.057	6126.00	9314.65	9314.64	-10.21	40°27'43.9723"N	104°13'52.9345"W	0.00	
15117.00†	90.000	0.057	6126.00	9414.65	9414.64	-10.11	40°27'44.9604"N	104°13'52.9332"W	0.00	
15217.00†	90.000	0.057	6126.00	9514.65	9514.64	-10.01	40°27'45.9486"N	104°13'52.9320"W	0.00	
15317.00†	90.000	0.057	6126.00	9614.65	9614.64	-9.92	40°27'46.9367"N	104°13'52.9307"W	0.00	
15417.00†	90.000	0.057	6126.00	9714.65	9714.64	-9.82	40°27'47.9249"N	104°13'52.9294"W	0.00	
15517.00†	90.000	0.057	6126.00	9814.65	9814.64	-9.72	40°27'48.9130"N	104°13'52.9281"W	0.00	
15617.00†	90.000	0.057	6126.00	9914.65	9914.64	-9.62	40°27'49.9012"N	104°13'52.9269"W	0.00	
15717.00†	90.000	0.057	6126.00	10014.65	10014.64	-9.52	40°27'50.8893"N	104°13'52.9256"W	0.00	
15817.00†	90.000	0.057	6126.00	10114.65	10114.64	-9.42	40°27'51.8775"N	104°13'52.9243"W	0.00	
15917.00†	90.000	0.057	6126.00	10214.65	10214.64	-9.32	40°27'52.8656"N	104°13'52.9230"W	0.00	
16017.00†	90.000	0.057	6126.00	10314.65	10314.64	-9.22	40°27'53.8538"N	104°13'52.9217"W	0.00	
16075.52	90.000	0.057	6126.00 ³	10373.16	10373.16	-9.17	40°27'54.4320"N	104°13'52.9210"W	0.00	End of Tangent

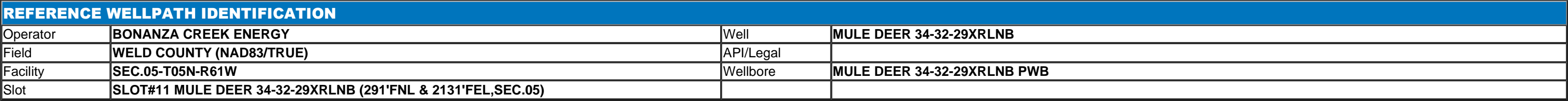
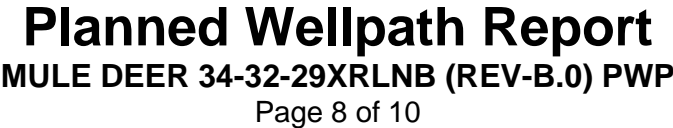

HOLE & CASING SECTIONS - Ref Wellbore: MULE DEER 34-32-29XRLNB PWB Ref Wellpath: MULE DEER 34-32-29XRLNB (REV-B.0) PWP									
String/Diameter	Start MD [ft]	End MD [ft]	Interval [ft]	Start TVD [ft]	End TVD [ft]	Start N/S [ft]	Start E/W [ft]	End N/S [ft]	End E/W [ft]
13.5in Open Hole	17.00	1500.00	1483.00	17.00	1495.39	0.00	0.00	90.24	-11.52
9.625in Casing Surface	17.00	1500.00	1483.00	17.00	1495.39	0.00	0.00	90.24	-11.52
8.5in Open Hole	1500.00	16075.52	14575.52	1495.39	N/A	90.24	-11.52	N/A	N/A

TARGETS									
Name	MD [ft]	TVD [ft]	North [ft]	East [ft]	Grid East [US ft]	Grid North [US ft]	Latitude	Longitude	Shape
SEC.29-T06N-R61W	N/A	-2.00	856.15	-607.94	3352513.47	1405284.33	40°26'20.3892"N	104°14'0.6648"W	polygon
	2D Polygon: dimensions not calculated								
SEC.32-T06N-R61W	N/A	-2.00	856.15	-607.94	3352513.47	1405284.33	40°26'20.3892"N	104°14'0.6648"W	polygon
	2D Polygon: dimensions not calculated								
SEC.05-T05N-R61W	N/A	0.00	-9840.86	-1941.14	3351333.48	1394569.78	40°24'34.6850"N	104°14'17.8960"W	polygon
	2D Polygon: dimensions not calculated								
2) MULE DEER 34-32-29XRLNB (MLT 2146'FEL)	11268.36	6126.00	5566.01	-13.92	3353040.03	1410002.02	40°27'6.9300"N	104°13'52.9824"W	point
3) MULE DEER 34-32-29XRLNB BHL REV-2 (470'FNL & 2138'FEL,SEC.29)	16075.52	6126.00	10373.16	-9.17	3352976.00	1414808.56	40°27'54.4320"N	104°13'52.9210"W	point
1) MULE DEER 34-32-29XRLNB LP REV-2 (470'FSL & 2154'FEL,SEC.32)	6462.63	6126.00	760.28	-22.86	3353099.84	1405196.86	40°26'19.4420"N	104°13'53.0980"W	point



Planned Wellpath Report

MULE DEER 34-32-29XRLNB (REV-B.0) PWP

Page 9 of 10



REFERENCE WELLPATH IDENTIFICATION			
Operator	BONANZA CREEK ENERGY	Well	MULE DEER 34-32-29XRLNB
Field	WELD COUNTY (NAD83/TRUE)	API/Legal	
Facility	SEC.05-T05N-R61W	Wellbore	MULE DEER 34-32-29XRLNB PWB
Slot	SLOT#11 MULE DEER 34-32-29XRLNB (291'FNL & 2131'FEL,SEC.05)		

SURVEY PROGRAM - Ref Wellbore: MULE DEER 34-32-29XRLNB PWB Ref Wellpath: MULE DEER 34-32-29XRLNB (REV-B.0) PWP				
Start MD [ft]	End MD [ft]	Positional Uncertainty Model	Log Name/Comment	Wellbore
17.00	1500.00	BHI NaviTrak (Rotating+Axial Corr)		MULE DEER 34-32-29XRLNB PWB
1500.00	16075.52	BH AutoTrak Curve (Short)		MULE DEER 34-32-29XRLNB PWB



Planned Wellpath Report
MULE DEER 34-32-29XRLNB (REV-B.0) PWP
Page 10 of 10



REFERENCE WELLPATH IDENTIFICATION			
Operator	BONANZA CREEK ENERGY	Well	MULE DEER 34-32-29XRLNB
Field	WELD COUNTY (NAD83/TRUE)	API/Legal	
Facility	SEC.05-T05N-R61W	Wellbore	MULE DEER 34-32-29XRLNB PWB
Slot	SLOT#11 MULE DEER 34-32-29XRLNB (291'FNL & 2131'FEL,SEC.05)		

DESIGN COMMENTS				
MD [ft]	Inclination [°]	Azimuth [°]	TVD [ft]	Comment
17.00	0.000	352.722	17.00	Tie On
500.00	0.000	352.722	500.00	End of Tangent
808.75	6.175	352.722	808.15	End of Build
2255.38	6.175	352.722	2246.39	End of Tangent
2564.13	0.000	0.107	2554.54	End of Drop
5562.63	0.000	0.107	5553.04	End of Tangent
6462.63	90.000	0.107	6126.00	End of Build
11268.36	90.000	0.107	6126.00	End of Tangent
11270.86	90.000	0.057	6126.00	End of 3D Arc
16075.52	90.000	0.057	6126.00	End of Tangent