

Great Western Operating Company, LLC

Created by mmount	
Date plotted 22-Mar-2020	
Plot reference is Tollway LC 24-362HC - Surface Hole.	
Ref wellpath is Tollway LC 24-362HC (AWP#1).	
Coordinates are in Feet reference N03 - Tollway LC 24-362HC.	
True Vertical Depths are reference Rig Datum.	
Measured Depths are reference Rig Datum.	
Rig Datum: Actual Datum #1	
Rig Datum to Mean Sea Level: 5164.00 ft.	
Plot North is aligned to TRUE North.	

Location	Colorado	Slot	N03 - Tollway LC 24-362HC
Field	Wattenburg	Well	Tollway LC 24-362HC
Installation	Tollway	Wellbore	Tollway LC 24-362HC - Surface Hole

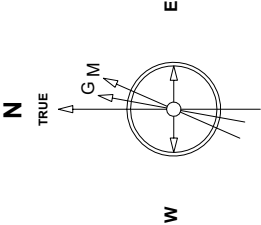

May-6-2019
EMA-2015 Dir: 66.20 deg Field: 51928.4 nT
Lat: N39 58.40.3032 Long: W104 56 19.7304 Elev: 5155.00 ft
Magnetic North is 8.14 deg East of TRUE North
To correct azimuth from Magnetic to TRUE add 8.14 deg

Scale 1 cm = 2 ft

East (Feet) ->

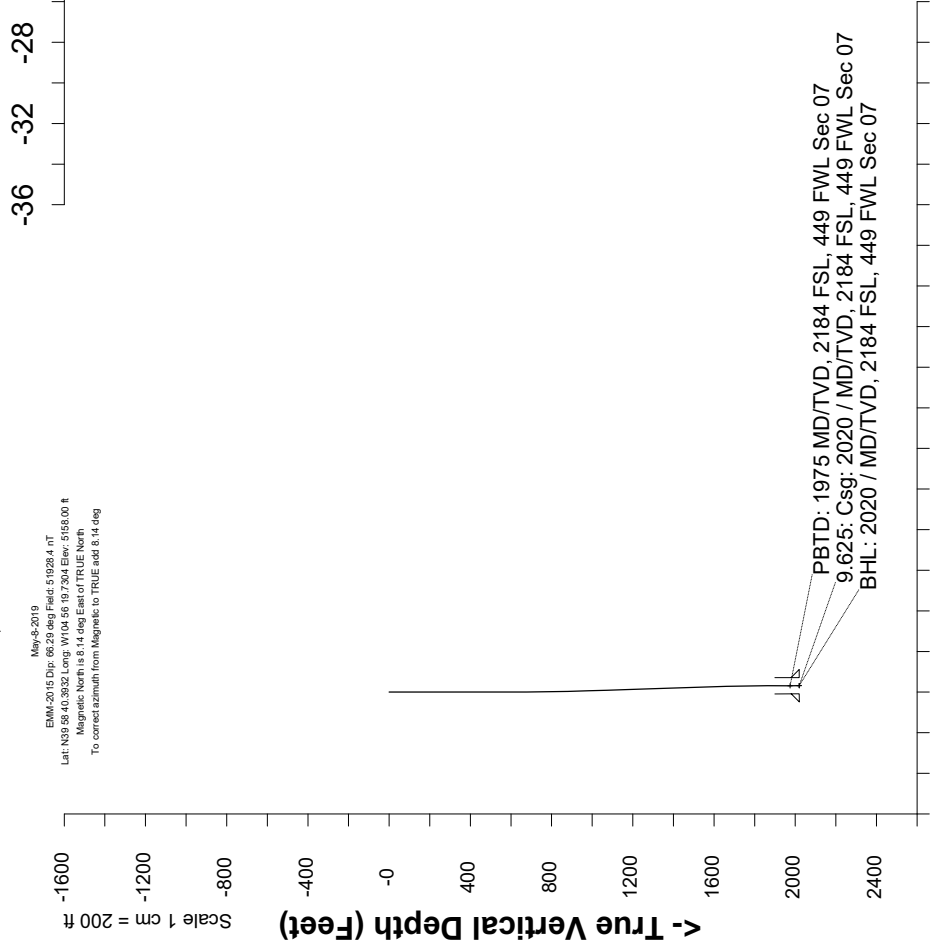

Scale 1 cm = 200 ft
Vertical Section (Feet) ->
Azimuth 20.39 with reference 0.00 N, 0.00 E from N03 - Tollway LC 24-362HC

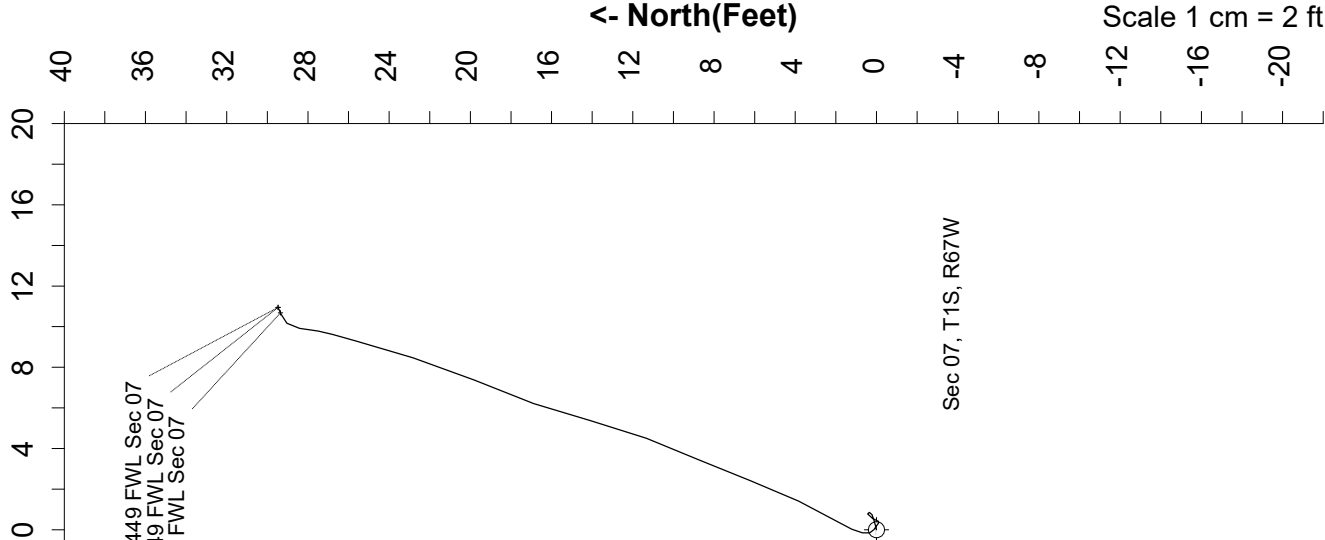

Sec 07, T1S, R67W

Header Information		measured depth (ft)	inclination (°)	azimuth (°)	true vertical depth (ft)	northing +N/-S (ft)	easting +E/-W (ft)
Operator Name		0	0.00	0.00	0	0.00	0.00
Great Western Oil & Gas Company LLC		84	0.59	75.55	84	0.11	0.42
Operator Number		170	0.18	3.92	170	0.35	0.86
10110		260	0.14	237.68	260	0.44	0.77
Well Name and Number		353	0.29	214.05	353	0.18	0.55
Tollway LC 24-362HC		442	0.11	185.77	442	-0.09	0.41
API Number (if available)		532	0.15	318.07	532	-0.09	0.32
05-001-10431		622	0.35	298.60	622	0.13	0.00
Location: QQ SEC TWP RGE		712	0.56	11.39	712	0.69	-0.15
NWSW Sec 7 1S 67W		802	1.20	29.90	802	1.94	0.41
Citing Type: Planned or Actual		892	1.53	26.33	892	3.83	1.41
Actual		982	1.74	19.92	982	6.20	2.41
Deviation Indicator		1072	1.71	24.13	1072	8.71	3.42
Horizontal ▼		1162	1.91	20.86	1162	11.33	4.50
North Reference		1252	1.77	13.77	1252	14.08	5.37
True ▼		1342	1.96	19.60	1342	16.88	6.22
Grid Type		1432	2.05	23.41	1432	19.81	7.37
		1522	2.04	16.51	1522	22.82	8.47
		1611	1.77	16.34	1611	25.66	9.30
		1701	0.64	10.42	1701	27.49	9.79
		1791	0.55	5.58	1791	28.41	9.92
		1881	0.36	46.51	1881	29.04	10.17
		1964	0.38	67.44	1964	29.32	10.61
		2020	0.38	67.44	2020	29.47	10.95