

| | | | |
|---|------------------------------|--|---|
| Location: | COLORADO | Slot: | SLOT#07 DAMORE 18-7HZ (2236'FNL & 710'FWL,SEC.18) |
| Field: | WELD COUNTY (UTM/TRUE NORTH) | Well: | DAMORE 18-7HZ |
| Facility: | SEC.18-T5N-R67W | Wellbore: | DAMORE 18-7HZ PWB |
| Plot reference wellpath is DAMORE 18-7HZ PWP Rev-C-0 | | Grid System: NAD83 / UTM Zone 13 North, US feet | |
| True vertical depths are referenced to PD564 (26') (RT) | | North Reference: True north | |
| Reference wellpath measured depths are referenced to PD564 (26') (RT) | | Scale: True distance | |
| PD564 (26') (RT) to Mean Sea Level: 4948 feet | | Coordinates are in feet referenced to Slot | |
| Mean Sea Level to Mud line (At Slot: SLOT#07 DAMORE 18-7HZ (2236'FNL & 710'FWL,SEC.18)): 0 feet | | Depths are in feet | |
| Offset wellpath MDs are referenced to each path's default MD datum | | Created by: ragbyos on 2020-04-17; Database: WellArchitectDB | |

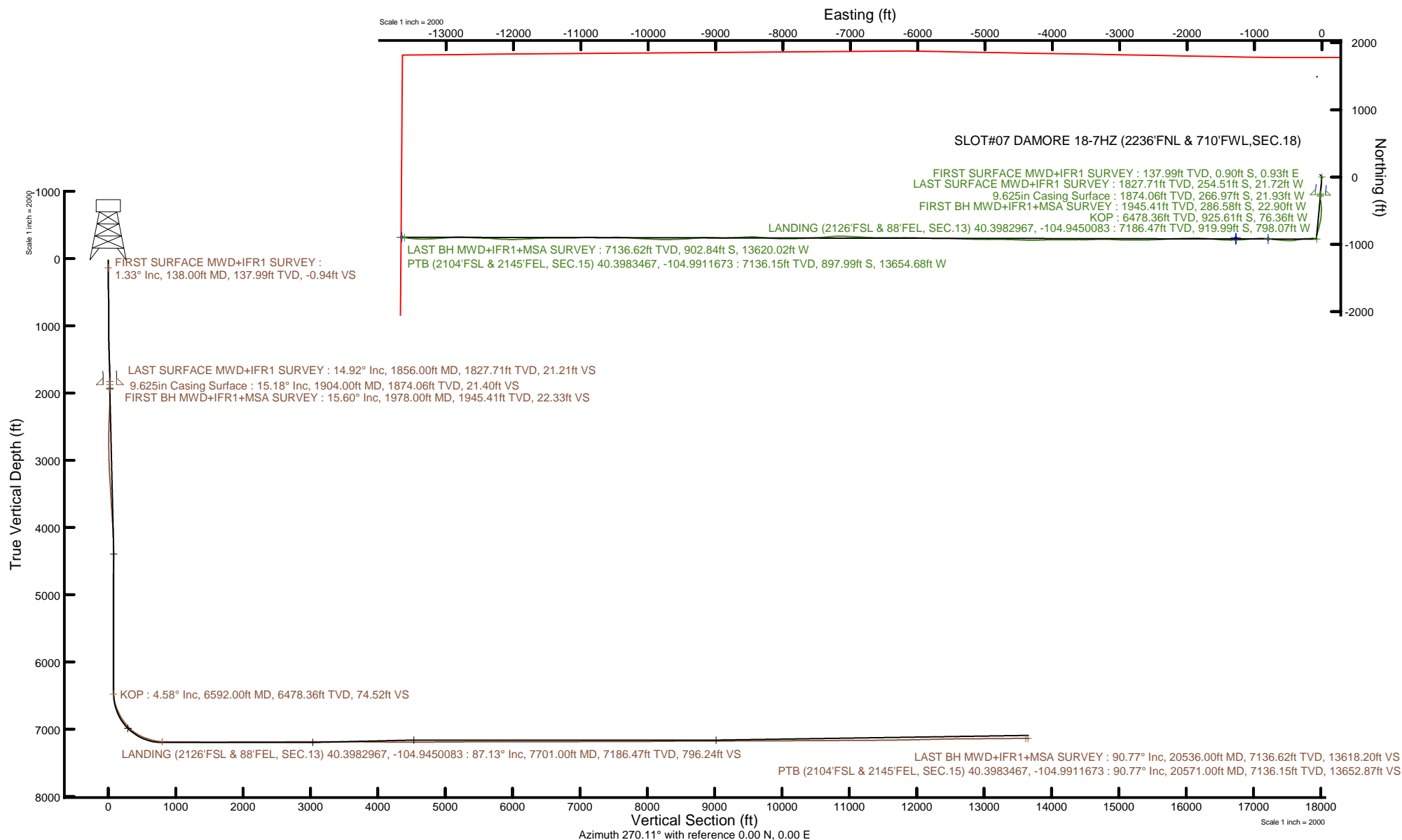

Actual Wellpath Report

DAMORE 18-7HZ AWP

Page 1 of 9

REFERENCE WELLPATH IDENTIFICATION

| | | | |
|----------|---|-----------|-------------------|
| Operator | KERR-MCGEE OIL & GAS ONSHORE LP (WA) | Well | DAMORE 18-7HZ |
| Field | WELD COUNTY (UTM/TRUE NORTH) | API/Legal | |
| Facility | SEC.18-T5N-R67W | Wellbore | DAMORE 18-7HZ AWB |
| Slot | SLOT#07 DAMORE 18-7HZ (2236'FNL & 710'FWL,SEC.18) | | |

REPORT SETUP INFORMATION

| | | | |
|---------------------|------------------------------------|------------------|-------------------------|
| Projection System | NAD83 / UTM Zone 13 North, US feet | Software System | WellArchitect® 6.0 |
| North Reference | True | User | Ragbyos |
| Scale | 0.999600 | Report Generated | 4/17/2020 at 4:40:14 PM |
| Convergence at slot | 0.04° East | Database | WellArchitectDB |

WELLPATH LOCATION

| | Local coordinates | | Grid coordinates | | Geographic coordinates | |
|-----------------------|-------------------|----------|------------------|-----------------|------------------------|---------------|
| | North[ft] | East[ft] | Easting[US ft] | Northing[US ft] | Latitude | Longitude |
| Slot Location | -69.40 | 57.34 | 1656524.44 | 14672699.30 | 40.4008220° | -104.9421430° |
| Facility Reference Pt | | | 1656467.07 | 14672768.64 | 40.4010125° | -104.9423489° |
| Field Reference Pt | | | 1698235.31 | 14552047.82 | 40.0693333° | -104.7933333° |

WELLPATH DATUM

| | | | |
|--------------------------|-------------------|--|-------------------|
| Calculation method | Minimum curvature | PD564 (26') (RT) to Facility Vertical Datum | 4948.00ft |
| Horizontal Reference Pt | Slot | PD564 (26') (RT) to Mean Sea Level | 4948.00ft |
| Vertical Reference Pt | PD564 (26') (RT) | PD564 (26') (RT) to Mud Line at Slot (SLOT#07 DAMORE 18-7HZ (2236'FNL & 710'FWL,SEC.18)) | 4948.00ft |
| MD Reference Pt | PD564 (26') (RT) | Section Origin | N 0.00, E 0.00 ft |
| Field Vertical Reference | Mean Sea Level | Section Azimuth | 270.11° |

REFERENCE WELLPATH IDENTIFICATION

| | | | |
|----------|---|-----------|-------------------|
| Operator | KERR-MCGEE OIL & GAS ONSHORE LP (WA) | Well | DAMORE 18-7HZ |
| Field | WELD COUNTY (UTM/TRUE NORTH) | API/Legal | |
| Facility | SEC.18-T5N-R67W | Wellbore | DAMORE 18-7HZ AWB |
| Slot | SLOT#07 DAMORE 18-7HZ (2236'FNL & 710'FWL,SEC.18) | | |

WELLPATH DATA (230 stations) † = interpolated, ‡ = extrapolated station

| MD [ft] | Inclination [°] | Azimuth [°] | TVD [ft] | Vert Sect [ft] | North [ft] | East [ft] | Grid East [US ft] | Grid North [US ft] | Latitude | Longitude | DLS ["/100ft] | Comments |
|---------|-----------------|-------------|----------|----------------|------------|-----------|-------------------|--------------------|------------|--------------|---------------|-------------------------------|
| 0.00† | 0.000 | 134.080 | 0.00 | 0.00 | 0.00 | 0.00 | 1656524.44 | 14672699.30 | 40.4008220 | -104.9421430 | 0.00 | |
| 26.00 | 0.000 | 134.080 | 26.00 | 0.00 | 0.00 | 0.00 | 1656524.44 | 14672699.30 | 40.4008220 | -104.9421430 | 0.00 | |
| 138.00 | 1.330 | 134.080 | 137.99 | -0.94 | -0.90 | 0.93 | 1656525.37 | 14672698.40 | 40.4008195 | -104.9421396 | 1.19 | FIRST SURFACE MWD+IFR1 SURVEY |
| 233.00 | 0.480 | 109.920 | 232.98 | -2.10 | -1.81 | 2.10 | 1656526.54 | 14672697.50 | 40.4008170 | -104.9421355 | 0.96 | |
| 328.00 | 1.050 | 332.370 | 327.97 | -2.07 | -1.17 | 2.07 | 1656526.51 | 14672698.13 | 40.4008188 | -104.9421356 | 1.52 | |
| 423.00 | 1.420 | 279.670 | 422.95 | -0.51 | -0.20 | 0.51 | 1656524.95 | 14672699.10 | 40.4008214 | -104.9421412 | 1.21 | |
| 518.00 | 2.060 | 235.840 | 517.91 | 2.07 | -0.96 | -2.07 | 1656522.37 | 14672698.34 | 40.4008194 | -104.9421504 | 1.50 | |
| 613.00 | 3.030 | 186.880 | 612.83 | 3.77 | -4.42 | -3.78 | 1656520.66 | 14672694.88 | 40.4008099 | -104.9421566 | 2.41 | |
| 708.00 | 6.430 | 184.200 | 707.49 | 4.45 | -12.22 | -4.47 | 1656519.98 | 14672687.09 | 40.4007885 | -104.9421591 | 3.59 | |
| 803.00 | 8.110 | 180.360 | 801.72 | 4.86 | -24.22 | -4.90 | 1656519.55 | 14672675.08 | 40.4007555 | -104.9421606 | 1.84 | |
| 899.00 | 8.630 | 178.750 | 896.70 | 4.71 | -38.19 | -4.79 | 1656519.68 | 14672661.12 | 40.4007172 | -104.9421602 | 0.59 | |
| 993.00 | 9.530 | 181.060 | 989.52 | 4.67 | -53.03 | -4.78 | 1656519.70 | 14672646.29 | 40.4006764 | -104.9421602 | 1.03 | |
| 1089.00 | 9.470 | 185.560 | 1084.21 | 5.55 | -68.83 | -5.69 | 1656518.80 | 14672630.49 | 40.4006331 | -104.9421634 | 0.78 | |
| 1184.00 | 10.680 | 181.770 | 1177.74 | 6.55 | -85.41 | -6.72 | 1656517.78 | 14672613.92 | 40.4005876 | -104.9421671 | 1.45 | |
| 1279.00 | 12.880 | 185.640 | 1270.74 | 7.82 | -104.75 | -8.03 | 1656516.48 | 14672594.59 | 40.4005345 | -104.9421718 | 2.46 | |
| 1373.00 | 14.650 | 186.020 | 1362.03 | 10.06 | -127.00 | -10.31 | 1656514.22 | 14672572.35 | 40.4004734 | -104.9421800 | 1.89 | |
| 1468.00 | 15.780 | 184.940 | 1453.70 | 12.38 | -151.82 | -12.68 | 1656511.86 | 14672547.54 | 40.4004053 | -104.9421885 | 1.23 | |
| 1562.00 | 15.070 | 190.790 | 1544.32 | 15.72 | -176.55 | -16.07 | 1656508.49 | 14672522.81 | 40.4003374 | -104.9422007 | 1.82 | |
| 1658.00 | 15.950 | 184.970 | 1636.83 | 19.15 | -201.96 | -19.55 | 1656505.03 | 14672497.41 | 40.4002676 | -104.9422132 | 1.86 | |
| 1753.00 | 15.410 | 182.150 | 1728.30 | 20.70 | -227.57 | -21.15 | 1656503.44 | 14672471.80 | 40.4001973 | -104.9422190 | 0.98 | |
| 1856.00 | 14.920 | 180.210 | 1827.71 | 21.21 | -254.51 | -21.72 | 1656502.90 | 14672444.88 | 40.4001234 | -104.9422210 | 0.68 | LAST SURFACE MWD+IFR1 SURVEY |
| 1978.00 | 15.600 | 183.930 | 1945.41 | 22.33 | -286.58 | -22.90 | 1656501.74 | 14672412.82 | 40.4000354 | -104.9422252 | 0.98 | FIRST BH MWD+IFR1+MSA SURVEY |
| 2068.00 | 14.270 | 181.620 | 2032.37 | 23.42 | -309.74 | -24.04 | 1656500.61 | 14672389.66 | 40.3999718 | -104.9422293 | 1.62 | |
| 2157.00 | 13.280 | 174.870 | 2118.81 | 22.78 | -330.89 | -23.44 | 1656501.23 | 14672368.53 | 40.3999137 | -104.9422271 | 2.12 | |
| 2247.00 | 12.680 | 168.770 | 2206.52 | 19.89 | -350.88 | -20.59 | 1656504.09 | 14672348.55 | 40.3998589 | -104.9422169 | 1.66 | |
| 2336.00 | 13.480 | 167.540 | 2293.21 | 15.71 | -370.59 | -16.45 | 1656508.24 | 14672328.85 | 40.3998048 | -104.9422021 | 0.95 | |
| 2426.00 | 15.320 | 172.490 | 2380.38 | 11.85 | -392.62 | -12.63 | 1656512.07 | 14672306.83 | 40.3997443 | -104.9421883 | 2.46 | |
| 2515.00 | 16.090 | 174.410 | 2466.06 | 9.06 | -416.55 | -9.89 | 1656514.82 | 14672282.91 | 40.3996786 | -104.9421785 | 1.04 | |
| 2604.00 | 16.340 | 176.650 | 2551.52 | 7.08 | -441.32 | -7.96 | 1656516.77 | 14672258.15 | 40.3996106 | -104.9421716 | 0.76 | |
| 2693.00 | 16.120 | 179.190 | 2636.97 | 6.13 | -466.18 | -7.05 | 1656517.69 | 14672233.31 | 40.3995424 | -104.9421683 | 0.84 | |
| 2783.00 | 16.210 | 180.860 | 2723.41 | 6.09 | -491.23 | -7.07 | 1656517.70 | 14672208.26 | 40.3994736 | -104.9421684 | 0.53 | |
| 2873.00 | 16.440 | 182.100 | 2809.79 | 6.69 | -516.52 | -7.72 | 1656517.06 | 14672182.98 | 40.3994042 | -104.9421707 | 0.46 | |
| 2962.00 | 16.710 | 182.830 | 2895.09 | 7.74 | -541.88 | -8.81 | 1656515.98 | 14672157.63 | 40.3993346 | -104.9421746 | 0.38 | |
| 3051.00 | 17.350 | 184.440 | 2980.19 | 9.34 | -567.89 | -10.47 | 1656514.34 | 14672131.63 | 40.3992632 | -104.9421806 | 0.89 | |
| 3141.00 | 17.840 | 185.250 | 3065.98 | 11.59 | -595.00 | -12.77 | 1656512.06 | 14672104.53 | 40.3991888 | -104.9421889 | 0.61 | |
| 3230.00 | 17.450 | 188.570 | 3150.79 | 14.77 | -621.77 | -16.01 | 1656508.84 | 14672077.77 | 40.3991153 | -104.9422005 | 1.21 | |
| 3320.00 | 17.090 | 190.390 | 3236.73 | 19.12 | -648.12 | -20.41 | 1656504.47 | 14672051.42 | 40.3990430 | -104.9422163 | 0.72 | |
| 3409.00 | 17.090 | 193.890 | 3321.81 | 24.56 | -673.68 | -25.90 | 1656498.99 | 14672025.87 | 40.3989728 | -104.9422360 | 1.16 | |
| 3499.00 | 15.050 | 193.960 | 3408.28 | 30.51 | -697.86 | -31.90 | 1656493.01 | 14672001.70 | 40.3989064 | -104.9422575 | 2.27 | |
| 3588.00 | 13.410 | 193.820 | 3494.55 | 35.72 | -719.10 | -37.15 | 1656487.77 | 14671980.47 | 40.3988481 | -104.9422764 | 1.84 | |
| 3678.00 | 13.560 | 191.650 | 3582.07 | 40.30 | -739.57 | -41.77 | 1656483.17 | 14671960.00 | 40.3987920 | -104.9422930 | 0.59 | |
| 3767.00 | 13.700 | 194.760 | 3668.56 | 45.05 | -759.98 | -46.57 | 1656478.39 | 14671939.60 | 40.3987359 | -104.9423102 | 0.84 | |
| 3857.00 | 13.580 | 195.320 | 3756.03 | 50.52 | -780.47 | -52.07 | 1656472.90 | 14671919.10 | 40.3986797 | -104.9423300 | 0.20 | |
| 3946.00 | 13.320 | 197.510 | 3842.59 | 56.33 | -800.33 | -57.92 | 1656467.07 | 14671899.25 | 40.3986252 | -104.9423509 | 0.64 | |
| 4036.00 | 12.120 | 196.660 | 3930.38 | 62.12 | -819.27 | -63.75 | 1656461.26 | 14671880.32 | 40.3985732 | -104.9423719 | 1.35 | |

REFERENCE WELLPATH IDENTIFICATION

| | | | |
|----------|---|-----------|-------------------|
| Operator | KERR-MCGEE OIL & GAS ONSHORE LP (WA) | Well | DAMORE 18-7HZ |
| Field | WELD COUNTY (UTM/TRUE NORTH) | API/Legal | |
| Facility | SEC.18-T5N-R67W | Wellbore | DAMORE 18-7HZ AWB |
| Slot | SLOT#07 DAMORE 18-7HZ (2236'FNL & 710'FWL,SEC.18) | | |

WELLPATH DATA (230 stations) † = interpolated, ‡ = extrapolated station

| MD [ft] | Inclination [°] | Azimuth [°] | TVD [ft] | Vert Sect [ft] | North [ft] | East [ft] | Grid East [US ft] | Grid North [US ft] | Latitude | Longitude | DLS [°/100ft] | Comments |
|------------|--------------------|----------------|-------------|-------------------|---------------|--------------|----------------------|-----------------------|------------|--------------|------------------|--|
| 4125.00 | 10.790 | 197.540 | 4017.60 | 67.27 | -836.16 | -68.94 | 1656456.08 | 14671863.43 | 40.3985268 | -104.9423905 | 1.51 | |
| 4214.00 | 10.920 | 194.190 | 4105.01 | 71.82 | -852.28 | -73.51 | 1656451.51 | 14671847.31 | 40.3984826 | -104.9424069 | 0.72 | |
| 4304.00 | 9.560 | 190.470 | 4193.57 | 75.23 | -867.90 | -76.96 | 1656448.08 | 14671831.70 | 40.3984397 | -104.9424193 | 1.68 | |
| 4394.00 | 8.930 | 185.920 | 4282.41 | 77.28 | -882.19 | -79.04 | 1656446.01 | 14671817.41 | 40.3984005 | -104.9424268 | 1.07 | |
| 4483.00 | 5.940 | 181.320 | 4370.65 | 78.08 | -893.67 | -79.86 | 1656445.20 | 14671805.94 | 40.3983690 | -104.9424297 | 3.42 | |
| 4571.00 | 5.130 | 170.430 | 4458.24 | 77.51 | -902.10 | -79.31 | 1656445.75 | 14671797.51 | 40.3983458 | -104.9424277 | 1.50 | |
| 4661.00 | 5.010 | 168.750 | 4547.89 | 76.06 | -909.92 | -77.87 | 1656447.19 | 14671789.69 | 40.3983243 | -104.9424226 | 0.21 | |
| 4750.00 | 4.070 | 163.820 | 4636.61 | 74.41 | -916.77 | -76.24 | 1656448.83 | 14671782.85 | 40.3983056 | -104.9424167 | 1.14 | |
| 4840.00 | 2.070 | 149.240 | 4726.48 | 72.68 | -921.23 | -74.51 | 1656450.56 | 14671778.39 | 40.3982933 | -104.9424105 | 2.37 | |
| 4929.00 | 1.420 | 156.600 | 4815.43 | 71.42 | -923.63 | -73.25 | 1656451.82 | 14671776.00 | 40.3982867 | -104.9424060 | 0.77 | |
| 5108.00 | 0.210 | 352.750 | 4994.42 | 70.57 | -925.34 | -72.41 | 1656452.66 | 14671774.29 | 40.3982820 | -104.9424030 | 0.91 | |
| 5197.00 | 0.060 | 153.210 | 5083.42 | 70.57 | -925.22 | -72.41 | 1656452.66 | 14671774.41 | 40.3982824 | -104.9424030 | 0.30 | |
| 5287.00 | 0.230 | 313.950 | 5173.42 | 70.68 | -925.13 | -72.52 | 1656452.55 | 14671774.49 | 40.3982826 | -104.9424034 | 0.32 | |
| 5376.00 | 0.070 | 191.770 | 5262.42 | 70.82 | -925.06 | -72.66 | 1656452.41 | 14671774.56 | 40.3982828 | -104.9424039 | 0.31 | |
| 5466.00 | 0.280 | 263.030 | 5352.42 | 71.05 | -925.14 | -72.89 | 1656452.18 | 14671774.48 | 40.3982826 | -104.9424047 | 0.30 | |
| 5555.00 | 0.620 | 255.520 | 5441.41 | 71.73 | -925.29 | -73.57 | 1656451.50 | 14671774.33 | 40.3982822 | -104.9424072 | 0.39 | |
| 5644.00 | 0.150 | 152.770 | 5530.41 | 72.15 | -925.51 | -73.99 | 1656451.09 | 14671774.11 | 40.3982816 | -104.9424086 | 0.75 | |
| 5734.00 | 0.130 | 194.490 | 5620.41 | 72.12 | -925.72 | -73.96 | 1656451.12 | 14671773.91 | 40.3982810 | -104.9424085 | 0.11 | |
| 5823.00 | 0.180 | 286.620 | 5709.41 | 72.28 | -925.78 | -74.12 | 1656450.96 | 14671773.85 | 40.3982808 | -104.9424091 | 0.25 | |
| 5912.00 | 0.160 | 200.750 | 5798.41 | 72.45 | -925.85 | -74.30 | 1656450.78 | 14671773.77 | 40.3982806 | -104.9424097 | 0.26 | |
| 6002.00 | 0.040 | 212.450 | 5888.41 | 72.51 | -926.00 | -74.36 | 1656450.72 | 14671773.63 | 40.3982802 | -104.9424100 | 0.13 | |
| 6091.00 | 0.070 | 182.580 | 5977.41 | 72.53 | -926.08 | -74.38 | 1656450.70 | 14671773.55 | 40.3982800 | -104.9424100 | 0.05 | |
| 6181.00 | 0.170 | 275.700 | 6067.41 | 72.67 | -926.12 | -74.51 | 1656450.56 | 14671773.50 | 40.3982799 | -104.9424105 | 0.21 | |
| 6270.00 | 0.180 | 342.060 | 6156.41 | 72.84 | -925.97 | -74.69 | 1656450.39 | 14671773.65 | 40.3982803 | -104.9424111 | 0.22 | |
| 6359.00 | 0.100 | 299.580 | 6245.41 | 72.95 | -925.80 | -74.80 | 1656450.28 | 14671773.82 | 40.3982808 | -104.9424115 | 0.14 | |
| 6449.00 | 0.110 | 135.890 | 6335.41 | 72.96 | -925.82 | -74.80 | 1656450.27 | 14671773.80 | 40.3982807 | -104.9424116 | 0.23 | |
| 6538.00 | 0.500 | 138.510 | 6424.41 | 72.65 | -926.18 | -74.49 | 1656450.59 | 14671773.45 | 40.3982797 | -104.9424104 | 0.44 | |
| 6592.00† | 4.581 | 290.131 | 6478.36 | 74.52 | -925.61 | -76.36 | 1656448.72 | 14671774.01 | 40.3982813 | -104.9424171 | 9.31 | KOP |
| 6628.00 | 7.930 | 291.280 | 6514.14 | 78.18 | -924.21 | -80.02 | 1656445.05 | 14671775.41 | 40.3982851 | -104.9424303 | 9.31 | |
| 6717.00 | 15.660 | 291.200 | 6601.19 | 95.14 | -917.63 | -96.97 | 1656428.11 | 14671781.97 | 40.3983032 | -104.9424911 | 8.69 | |
| 6806.00 | 20.880 | 273.650 | 6685.74 | 122.22 | -912.27 | -124.03 | 1656401.05 | 14671787.31 | 40.3983179 | -104.9425883 | 8.46 | |
| 6896.00 | 26.930 | 262.340 | 6768.02 | 158.47 | -913.97 | -160.29 | 1656364.81 | 14671785.59 | 40.3983132 | -104.9427185 | 8.41 | |
| 6985.00 | 32.610 | 269.090 | 6845.27 | 202.47 | -917.04 | -204.29 | 1656320.83 | 14671782.50 | 40.3983048 | -104.9428765 | 7.40 | |
| 7074.00 | 38.240 | 267.880 | 6917.76 | 254.01 | -918.44 | -255.84 | 1656269.30 | 14671781.06 | 40.3983010 | -104.9430615 | 6.37 | |
| 7164.00 | 44.980 | 258.170 | 6985.09 | 313.09 | -926.01 | -314.94 | 1656210.24 | 14671773.46 | 40.3982802 | -104.9432737 | 10.35 | |
| 7254.00 | 54.730 | 259.670 | 7043.04 | 380.51 | -939.15 | -382.38 | 1656142.83 | 14671760.28 | 40.3982441 | -104.9435158 | 10.91 | |
| 7343.00 | 60.750 | 268.280 | 7090.59 | 455.21 | -946.85 | -457.10 | 1656068.14 | 14671752.53 | 40.3982230 | -104.9437841 | 10.61 | |
| 7432.00 | 70.520 | 273.600 | 7127.29 | 536.14 | -945.37 | -538.02 | 1655987.25 | 14671753.95 | 40.3982270 | -104.9440747 | 12.25 | |
| 7522.00 | 73.010 | 275.880 | 7155.45 | 621.33 | -938.30 | -623.20 | 1655902.11 | 14671760.97 | 40.3982464 | -104.9443805 | 3.67 | |
| 7611.00 | 79.880 | 276.260 | 7176.30 | 707.33 | -929.15 | -709.18 | 1655816.15 | 14671770.06 | 40.3982715 | -104.9446892 | 7.73 | |
| 7701.00 | 87.130 | 275.510 | 7186.47 | 796.24 | -919.99 | -798.07 | 1655727.29 | 14671779.15 | 40.3982967 | -104.9450083 | 8.10 | LANDING (2126'FSL & 88'FEL, SEC.13) 40.3982967, -104.9450083 |
| 7790.00 | 89.970 | 271.260 | 7188.72 | 885.04 | -914.74 | -886.86 | 1655638.54 | 14671784.34 | 40.3983111 | -104.9453271 | 5.74 | |
| 7879.00 | 89.910 | 265.760 | 7188.82 | 973.97 | -917.06 | -975.79 | 1655549.64 | 14671781.97 | 40.3983047 | -104.9456464 | 6.18 | |
| 7969.00 | 89.600 | 266.090 | 7189.20 | 1063.73 | -923.45 | -1065.56 | 1655459.91 | 14671775.52 | 40.3982872 | -104.9459687 | 0.50 | |
| 8058.00 | 89.660 | 264.890 | 7189.78 | 1152.43 | -930.45 | -1154.29 | 1655371.23 | 14671768.47 | 40.3982679 | -104.9462872 | 1.35 | |

Actual Wellpath Report

DAMORE 18-7HZ AWP

Page 4 of 9

REFERENCE WELLPATH IDENTIFICATION

| | | | |
|----------|---|-----------|-------------------|
| Operator | KERR-MCGEE OIL & GAS ONSHORE LP (WA) | Well | DAMORE 18-7HZ |
| Field | WELD COUNTY (UTM/TRUE NORTH) | API/Legal | |
| Facility | SEC.18-T5N-R67W | Wellbore | DAMORE 18-7HZ AWB |
| Slot | SLOT#07 DAMORE 18-7HZ (2236'FNL & 710'FWL,SEC.18) | | |

WELLPATH DATA (230 stations)

| MD [ft] | Inclination [°] | Azimuth [°] | TVD [ft] | Vert Sect [ft] | North [ft] | East [ft] | Grid East [US ft] | Grid North [US ft] | Latitude | Longitude | DLS [°/100ft] | Comments |
|------------|--------------------|----------------|-------------|-------------------|---------------|--------------|----------------------|-----------------------|------------|--------------|------------------|----------|
| 8147.00 | 89.320 | 267.200 | 7190.57 | 1241.20 | -936.59 | -1243.06 | 1655282.49 | 14671762.27 | 40.3982511 | -104.9466060 | 2.62 | |
| 8237.00 | 89.140 | 269.520 | 7191.78 | 1331.14 | -939.16 | -1333.01 | 1655192.58 | 14671759.64 | 40.3982440 | -104.9469289 | 2.59 | |
| 8326.00 | 89.110 | 271.820 | 7193.14 | 1420.12 | -938.12 | -1421.99 | 1655103.63 | 14671760.62 | 40.3982468 | -104.9472484 | 2.58 | |
| 8416.00 | 90.220 | 274.830 | 7193.66 | 1509.97 | -932.90 | -1511.83 | 1655013.83 | 14671765.78 | 40.3982611 | -104.9475709 | 3.56 | |
| 8505.00 | 90.370 | 274.710 | 7193.20 | 1598.67 | -925.50 | -1600.52 | 1654925.17 | 14671773.12 | 40.3982814 | -104.9478893 | 0.22 | |
| 8594.00 | 90.400 | 273.930 | 7192.61 | 1687.43 | -918.80 | -1689.26 | 1654836.46 | 14671779.76 | 40.3982998 | -104.9482079 | 0.88 | |
| 8684.00 | 90.490 | 272.800 | 7191.91 | 1777.28 | -913.52 | -1779.10 | 1654746.65 | 14671784.99 | 40.3983143 | -104.9485305 | 1.26 | |
| 8773.00 | 90.340 | 269.880 | 7191.26 | 1866.25 | -911.44 | -1868.06 | 1654657.72 | 14671787.01 | 40.3983200 | -104.9488499 | 3.29 | |
| 8863.00 | 90.220 | 268.720 | 7190.82 | 1956.24 | -912.54 | -1958.06 | 1654567.77 | 14671785.85 | 40.3983170 | -104.9491730 | 1.30 | |
| 8952.00 | 90.280 | 268.530 | 7190.43 | 2045.21 | -914.67 | -2047.03 | 1654478.83 | 14671783.66 | 40.3983111 | -104.9494924 | 0.22 | |
| 9042.00 | 90.250 | 268.640 | 7190.02 | 2135.17 | -916.89 | -2137.00 | 1654388.90 | 14671781.38 | 40.3983050 | -104.9498155 | 0.13 | |
| 9131.00 | 90.220 | 266.840 | 7189.65 | 2224.09 | -920.40 | -2225.93 | 1654300.01 | 14671777.81 | 40.3982953 | -104.9501347 | 2.02 | |
| 9220.00 | 90.090 | 267.020 | 7189.41 | 2312.95 | -925.17 | -2314.80 | 1654211.18 | 14671772.99 | 40.3982822 | -104.9504538 | 0.25 | |
| 9310.00 | 90.180 | 267.310 | 7189.20 | 2402.83 | -929.62 | -2404.69 | 1654121.33 | 14671768.48 | 40.3982700 | -104.9507765 | 0.34 | |
| 9399.00 | 90.220 | 267.260 | 7188.89 | 2491.72 | -933.84 | -2493.59 | 1654032.47 | 14671764.21 | 40.3982584 | -104.9510957 | 0.07 | |
| 9489.00 | 90.090 | 269.080 | 7188.65 | 2581.67 | -936.71 | -2583.54 | 1653942.55 | 14671761.28 | 40.3982505 | -104.9514186 | 2.03 | |
| 9578.00 | 90.120 | 269.860 | 7188.48 | 2670.66 | -937.53 | -2672.53 | 1653853.59 | 14671760.39 | 40.3982482 | -104.9517382 | 0.88 | |
| 9668.00 | 90.150 | 269.400 | 7188.27 | 2760.66 | -938.12 | -2762.53 | 1653763.63 | 14671759.75 | 40.3982465 | -104.9520613 | 0.51 | |
| 9757.00 | 90.030 | 270.330 | 7188.13 | 2849.66 | -938.33 | -2851.53 | 1653674.67 | 14671759.49 | 40.3982459 | -104.9523808 | 1.05 | |
| 9847.00 | 90.030 | 270.990 | 7188.08 | 2939.65 | -937.29 | -2941.52 | 1653584.71 | 14671760.46 | 40.3982488 | -104.9527039 | 0.73 | |
| 9936.00 | 90.030 | 272.700 | 7188.04 | 3028.61 | -934.42 | -3030.47 | 1653495.80 | 14671763.27 | 40.3982566 | -104.9530233 | 1.92 | |
| 10026.00 | 90.250 | 272.960 | 7187.82 | 3118.51 | -929.98 | -3120.36 | 1653405.94 | 14671767.65 | 40.3982688 | -104.9533460 | 0.38 | |
| 10115.00 | 90.310 | 270.900 | 7187.38 | 3207.46 | -926.98 | -3209.31 | 1653317.03 | 14671770.59 | 40.3982770 | -104.9536653 | 2.32 | |
| 10204.00 | 90.430 | 268.990 | 7186.81 | 3296.45 | -927.07 | -3298.30 | 1653228.07 | 14671770.45 | 40.3982767 | -104.9539849 | 2.15 | |
| 10293.00 | 89.750 | 267.270 | 7186.67 | 3385.39 | -929.97 | -3387.25 | 1653139.16 | 14671767.49 | 40.3982687 | -104.9543042 | 2.08 | |
| 10383.00 | 89.780 | 269.210 | 7187.04 | 3475.34 | -932.74 | -3477.20 | 1653049.25 | 14671764.66 | 40.3982611 | -104.9546272 | 2.16 | |
| 10472.00 | 89.630 | 270.840 | 7187.50 | 3564.34 | -932.70 | -3566.20 | 1652960.29 | 14671764.64 | 40.3982611 | -104.9549467 | 1.84 | |
| 10562.00 | 89.820 | 268.600 | 7187.93 | 3654.33 | -933.14 | -3656.19 | 1652870.33 | 14671764.15 | 40.3982599 | -104.9552698 | 2.50 | |
| 10651.00 | 89.660 | 269.260 | 7188.33 | 3743.31 | -934.80 | -3745.17 | 1652781.38 | 14671762.43 | 40.3982553 | -104.9555893 | 0.76 | |
| 10740.00 | 89.720 | 270.120 | 7188.81 | 3832.30 | -935.28 | -3834.17 | 1652692.42 | 14671761.89 | 40.3982539 | -104.9559088 | 0.97 | |
| 10830.00 | 90.060 | 270.130 | 7188.99 | 3922.30 | -935.08 | -3924.17 | 1652602.46 | 14671762.02 | 40.3982544 | -104.9562319 | 0.38 | |
| 10919.00 | 88.920 | 270.560 | 7189.78 | 4011.29 | -934.55 | -4013.16 | 1652513.50 | 14671762.50 | 40.3982559 | -104.9565514 | 1.37 | |
| 11008.00 | 88.740 | 268.240 | 7191.60 | 4100.26 | -935.48 | -4102.13 | 1652424.57 | 14671761.51 | 40.3982533 | -104.9568708 | 2.61 | |
| 11098.00 | 89.570 | 267.070 | 7192.92 | 4190.17 | -939.16 | -4192.05 | 1652334.69 | 14671757.77 | 40.3982431 | -104.9571936 | 1.59 | |
| 11187.00 | 89.660 | 269.600 | 7193.52 | 4279.12 | -941.75 | -4281.00 | 1652245.78 | 14671755.13 | 40.3982360 | -104.9575130 | 2.84 | |
| 11277.00 | 89.660 | 271.780 | 7194.06 | 4369.10 | -940.66 | -4370.98 | 1652155.83 | 14671756.15 | 40.3982389 | -104.9578361 | 2.42 | |
| 11366.00 | 89.850 | 272.520 | 7194.44 | 4458.05 | -937.33 | -4459.92 | 1652066.92 | 14671759.43 | 40.3982480 | -104.9581554 | 0.86 | |
| 11456.00 | 90.580 | 272.580 | 7194.10 | 4547.96 | -933.32 | -4549.83 | 1651977.05 | 14671763.38 | 40.3982590 | -104.9584782 | 0.81 | |
| 11546.00 | 90.460 | 271.500 | 7193.28 | 4637.91 | -930.12 | -4639.77 | 1651887.14 | 14671766.52 | 40.3982677 | -104.9588011 | 1.21 | |
| 11635.00 | 90.280 | 270.460 | 7192.71 | 4726.90 | -928.60 | -4728.75 | 1651798.20 | 14671767.98 | 40.3982719 | -104.9591206 | 1.19 | |
| 11724.00 | 90.460 | 269.790 | 7192.13 | 4815.89 | -928.40 | -4817.75 | 1651709.23 | 14671768.12 | 40.3982723 | -104.9594401 | 0.78 | |
| 11814.00 | 90.520 | 269.530 | 7191.36 | 4905.89 | -928.94 | -4907.74 | 1651619.28 | 14671767.53 | 40.3982708 | -104.9597632 | 0.30 | |
| 11903.00 | 90.370 | 270.270 | 7190.67 | 4994.88 | -929.09 | -4996.74 | 1651530.31 | 14671767.31 | 40.3982703 | -104.9600827 | 0.85 | |
| 11993.00 | 90.490 | 271.030 | 7190.00 | 5084.88 | -928.07 | -5086.73 | 1651440.36 | 14671768.28 | 40.3982731 | -104.9604058 | 0.85 | |
| 12082.00 | 90.370 | 271.150 | 7189.33 | 5173.86 | -926.38 | -5175.71 | 1651351.41 | 14671769.91 | 40.3982777 | -104.9607253 | 0.19 | |

REFERENCE WELLPATH IDENTIFICATION

| | | | |
|----------|---|-----------|-------------------|
| Operator | KERR-MCGEE OIL & GAS ONSHORE LP (WA) | Well | DAMORE 18-7HZ |
| Field | WELD COUNTY (UTM/TRUE NORTH) | API/Legal | |
| Facility | SEC.18-T5N-R67W | Wellbore | DAMORE 18-7HZ AWB |
| Slot | SLOT#07 DAMORE 18-7HZ (2236'FNL & 710'FWL,SEC.18) | | |

WELLPATH DATA (230 stations)

| MD [ft] | Inclination [°] | Azimuth [°] | TVD [ft] | Vert Sect [ft] | North [ft] | East [ft] | Grid East [US ft] | Grid North [US ft] | Latitude | Longitude | DLS [°/100ft] | Comments |
|------------|--------------------|----------------|-------------|-------------------|---------------|--------------|----------------------|-----------------------|------------|--------------|------------------|----------|
| 12172.00 | 90.430 | 272.620 | 7188.70 | 5263.81 | -923.42 | -5265.66 | 1651261.50 | 14671772.81 | 40.3982858 | -104.9610482 | 1.63 | |
| 12261.00 | 90.090 | 272.940 | 7188.30 | 5352.71 | -919.10 | -5354.55 | 1651172.64 | 14671777.07 | 40.3982976 | -104.9613674 | 0.52 | |
| 12351.00 | 90.280 | 272.660 | 7188.00 | 5442.62 | -914.70 | -5444.45 | 1651082.78 | 14671781.40 | 40.3983096 | -104.9616901 | 0.38 | |
| 12440.00 | 90.220 | 271.430 | 7187.62 | 5531.56 | -911.53 | -5533.39 | 1650993.87 | 14671784.52 | 40.3983182 | -104.9620095 | 1.38 | |
| 12530.00 | 90.220 | 270.560 | 7187.27 | 5621.55 | -909.96 | -5623.37 | 1650903.92 | 14671786.02 | 40.3983225 | -104.9623325 | 0.97 | |
| 12620.00 | 90.150 | 269.480 | 7186.98 | 5711.55 | -909.93 | -5713.37 | 1650813.96 | 14671785.99 | 40.3983225 | -104.9626557 | 1.20 | |
| 12709.00 | 90.030 | 270.460 | 7186.84 | 5800.55 | -909.98 | -5802.37 | 1650725.00 | 14671785.89 | 40.3983223 | -104.9629752 | 1.11 | |
| 12799.00 | 89.970 | 271.500 | 7186.84 | 5890.54 | -908.44 | -5892.35 | 1650635.05 | 14671787.37 | 40.3983265 | -104.9632983 | 1.16 | |
| 12888.00 | 90.030 | 271.140 | 7186.84 | 5979.52 | -906.39 | -5981.33 | 1650546.11 | 14671789.36 | 40.3983321 | -104.9636177 | 0.41 | |
| 12977.00 | 89.600 | 271.670 | 7187.13 | 6068.49 | -904.21 | -6070.30 | 1650457.17 | 14671791.48 | 40.3983380 | -104.9639372 | 0.77 | |
| 13067.00 | 89.970 | 270.390 | 7187.47 | 6158.48 | -902.59 | -6160.29 | 1650367.22 | 14671793.04 | 40.3983424 | -104.9642602 | 1.48 | |
| 13156.00 | 89.880 | 269.400 | 7187.58 | 6247.48 | -902.75 | -6249.28 | 1650278.26 | 14671792.82 | 40.3983419 | -104.9645798 | 1.12 | |
| 13246.00 | 90.150 | 268.750 | 7187.56 | 6337.46 | -904.21 | -6339.27 | 1650188.31 | 14671791.31 | 40.3983378 | -104.9649028 | 0.78 | |
| 13335.00 | 90.340 | 269.930 | 7187.18 | 6426.45 | -905.23 | -6428.26 | 1650099.35 | 14671790.23 | 40.3983349 | -104.9652223 | 1.34 | |
| 13425.00 | 90.090 | 269.980 | 7186.84 | 6516.45 | -905.30 | -6518.26 | 1650009.39 | 14671790.10 | 40.3983347 | -104.9655455 | 0.28 | |
| 13514.00 | 90.180 | 271.290 | 7186.63 | 6605.44 | -904.32 | -6607.26 | 1649920.43 | 14671791.02 | 40.3983373 | -104.9658650 | 1.48 | |
| 13604.00 | 90.150 | 272.400 | 7186.37 | 6695.40 | -901.42 | -6697.21 | 1649830.51 | 14671793.86 | 40.3983452 | -104.9661879 | 1.23 | |
| 13693.00 | 90.180 | 273.320 | 7186.11 | 6784.30 | -896.98 | -6786.09 | 1649741.66 | 14671798.24 | 40.3983573 | -104.9665071 | 1.03 | |
| 13783.00 | 90.250 | 273.000 | 7185.78 | 6874.17 | -892.02 | -6875.96 | 1649651.83 | 14671803.14 | 40.3983709 | -104.9668297 | 0.36 | |
| 13872.00 | 90.250 | 272.690 | 7185.39 | 6963.07 | -887.60 | -6964.85 | 1649562.97 | 14671807.50 | 40.3983829 | -104.9671489 | 0.35 | |
| 13962.00 | 90.250 | 273.140 | 7185.00 | 7052.96 | -883.02 | -7054.73 | 1649473.12 | 14671812.02 | 40.3983954 | -104.9674716 | 0.50 | |
| 14051.00 | 90.370 | 270.430 | 7184.51 | 7141.91 | -880.25 | -7143.68 | 1649384.21 | 14671814.73 | 40.3984030 | -104.9677909 | 3.05 | |
| 14141.00 | 90.120 | 266.070 | 7184.13 | 7231.84 | -883.00 | -7233.61 | 1649294.31 | 14671811.92 | 40.3983953 | -104.9681138 | 4.85 | |
| 14230.00 | 90.060 | 264.500 | 7183.99 | 7320.52 | -890.31 | -7322.31 | 1649205.66 | 14671804.55 | 40.3983752 | -104.9684322 | 1.77 | |
| 14320.00 | 90.090 | 265.820 | 7183.87 | 7410.18 | -897.91 | -7411.98 | 1649116.02 | 14671796.90 | 40.3983543 | -104.9687542 | 1.47 | |
| 14409.00 | 90.150 | 266.130 | 7183.69 | 7498.95 | -904.15 | -7500.76 | 1649027.28 | 14671790.60 | 40.3983371 | -104.9690729 | 0.35 | |
| 14499.00 | 90.150 | 267.990 | 7183.45 | 7588.82 | -908.77 | -7590.64 | 1648937.44 | 14671785.93 | 40.3983243 | -104.9693956 | 2.07 | |
| 14588.00 | 90.000 | 267.130 | 7183.33 | 7677.73 | -912.56 | -7679.56 | 1648848.56 | 14671782.08 | 40.3983138 | -104.9697149 | 0.98 | |
| 14678.00 | 90.120 | 268.980 | 7183.24 | 7767.67 | -915.61 | -7769.50 | 1648758.66 | 14671778.97 | 40.3983054 | -104.9700378 | 2.06 | |
| 14767.00 | 89.780 | 268.850 | 7183.32 | 7856.65 | -917.30 | -7858.49 | 1648669.71 | 14671777.23 | 40.3983007 | -104.9703573 | 0.41 | |
| 14856.00 | 90.520 | 269.360 | 7183.08 | 7945.63 | -918.69 | -7947.48 | 1648580.76 | 14671775.78 | 40.3982968 | -104.9706768 | 1.01 | |
| 14946.00 | 90.550 | 271.880 | 7182.24 | 8035.62 | -917.72 | -8037.46 | 1648490.81 | 14671776.70 | 40.3982994 | -104.9709998 | 2.80 | |
| 15036.00 | 90.550 | 272.660 | 7181.38 | 8125.55 | -914.15 | -8127.38 | 1648400.92 | 14671780.20 | 40.3983091 | -104.9713227 | 0.87 | |
| 15125.00 | 90.460 | 274.890 | 7180.59 | 8214.36 | -908.29 | -8216.18 | 1648312.15 | 14671786.00 | 40.3983251 | -104.9716415 | 2.51 | |
| 15215.00 | 90.680 | 275.440 | 7179.70 | 8304.00 | -900.19 | -8305.81 | 1648222.56 | 14671794.04 | 40.3983472 | -104.9719633 | 0.66 | |
| 15304.00 | 90.520 | 273.540 | 7178.77 | 8392.74 | -893.22 | -8394.53 | 1648133.87 | 14671800.94 | 40.3983663 | -104.9722818 | 2.14 | |
| 15393.00 | 90.550 | 268.500 | 7177.94 | 8481.69 | -891.64 | -8483.48 | 1648044.95 | 14671802.47 | 40.3983705 | -104.9726012 | 5.66 | |
| 15483.00 | 90.060 | 266.580 | 7177.46 | 8571.60 | -895.50 | -8573.39 | 1647955.08 | 14671798.55 | 40.3983598 | -104.9729240 | 2.20 | |
| 15572.00 | 89.970 | 267.840 | 7177.43 | 8660.48 | -899.83 | -8662.29 | 1647866.22 | 14671794.16 | 40.3983479 | -104.9732432 | 1.42 | |
| 15662.00 | 89.630 | 267.760 | 7177.75 | 8750.41 | -903.29 | -8752.22 | 1647776.33 | 14671790.65 | 40.3983383 | -104.9735660 | 0.39 | |
| 15751.00 | 89.970 | 267.950 | 7178.06 | 8839.34 | -906.62 | -8841.16 | 1647687.43 | 14671787.26 | 40.3983291 | -104.9738853 | 0.44 | |
| 15841.00 | 89.940 | 272.890 | 7178.13 | 8929.31 | -905.96 | -8931.13 | 1647597.50 | 14671787.86 | 40.3983308 | -104.9742084 | 5.49 | |
| 15930.00 | 90.490 | 272.490 | 7177.79 | 9018.22 | -901.78 | -9020.03 | 1647508.63 | 14671791.98 | 40.3983422 | -104.9745275 | 0.76 | |
| 16019.00 | 90.980 | 268.830 | 7176.65 | 9107.19 | -900.76 | -9109.00 | 1647419.69 | 14671792.94 | 40.3983449 | -104.9748470 | 4.15 | |
| 16109.00 | 90.220 | 266.840 | 7175.71 | 9197.11 | -904.16 | -9198.92 | 1647329.80 | 14671789.49 | 40.3983355 | -104.9751698 | 2.37 | |

REFERENCE WELLPATH IDENTIFICATION

| | | | |
|----------|---|-----------|-------------------|
| Operator | KERR-MCGEE OIL & GAS ONSHORE LP (WA) | Well | DAMORE 18-7HZ |
| Field | WELD COUNTY (UTM/TRUE NORTH) | API/Legal | |
| Facility | SEC.18-T5N-R67W | Wellbore | DAMORE 18-7HZ AWB |
| Slot | SLOT#07 DAMORE 18-7HZ (2236'FNL & 710'FWL,SEC.18) | | |

WELLPATH DATA (230 stations)

| MD [ft] | Inclination [°] | Azimuth [°] | TVD [ft] | Vert Sect [ft] | North [ft] | East [ft] | Grid East [US ft] | Grid North [US ft] | Latitude | Longitude | DLS [°/100ft] | Comments |
|------------|--------------------|----------------|-------------|-------------------|---------------|--------------|----------------------|-----------------------|------------|--------------|------------------|----------|
| 16198.00 | 90.370 | 265.610 | 7175.25 | 9285.90 | -910.02 | -9287.73 | 1647241.04 | 14671783.57 | 40.3983193 | -104.9754887 | 1.39 | |
| 16287.00 | 90.280 | 265.840 | 7174.75 | 9374.64 | -916.65 | -9376.48 | 1647152.33 | 14671776.88 | 40.3983010 | -104.9758073 | 0.28 | |
| 16376.00 | 90.220 | 266.930 | 7174.36 | 9463.45 | -922.26 | -9465.30 | 1647063.55 | 14671771.21 | 40.3982855 | -104.9761262 | 1.23 | |
| 16466.00 | 90.250 | 268.080 | 7173.99 | 9553.35 | -926.18 | -9555.21 | 1646973.67 | 14671767.24 | 40.3982746 | -104.9764490 | 1.28 | |
| 16555.00 | 90.220 | 268.270 | 7173.62 | 9642.30 | -929.02 | -9644.17 | 1646884.76 | 14671764.35 | 40.3982668 | -104.9767683 | 0.22 | |
| 16645.00 | 90.250 | 269.990 | 7173.26 | 9732.28 | -930.38 | -9734.15 | 1646794.81 | 14671762.92 | 40.3982629 | -104.9770914 | 1.91 | |
| 16734.00 | 90.150 | 271.030 | 7172.94 | 9821.28 | -929.59 | -9823.15 | 1646705.85 | 14671763.66 | 40.3982650 | -104.9774109 | 1.17 | |
| 16824.00 | 90.060 | 273.010 | 7172.78 | 9911.22 | -926.42 | -9913.09 | 1646615.94 | 14671766.77 | 40.3982736 | -104.9777339 | 2.20 | |
| 16913.00 | 90.220 | 272.980 | 7172.56 | 10000.11 | -921.77 | -10001.96 | 1646527.10 | 14671771.36 | 40.3982863 | -104.9780530 | 0.18 | |
| 17003.00 | 90.250 | 272.030 | 7172.19 | 10090.03 | -917.83 | -10091.88 | 1646437.22 | 14671775.23 | 40.3982970 | -104.9783758 | 1.06 | |
| 17092.00 | 90.280 | 274.910 | 7171.78 | 10178.87 | -912.45 | -10180.70 | 1646348.43 | 14671780.56 | 40.3983116 | -104.9786947 | 3.24 | |
| 17182.00 | 90.490 | 274.240 | 7171.18 | 10268.59 | -905.27 | -10270.41 | 1646258.75 | 14671787.68 | 40.3983312 | -104.9790168 | 0.78 | |
| 17271.00 | 90.220 | 271.900 | 7170.63 | 10357.47 | -900.50 | -10359.28 | 1646169.91 | 14671792.38 | 40.3983442 | -104.9793358 | 2.65 | |
| 17361.00 | 90.090 | 270.720 | 7170.38 | 10447.44 | -898.45 | -10449.25 | 1646079.97 | 14671794.38 | 40.3983498 | -104.9796589 | 1.32 | |
| 17451.00 | 90.120 | 268.560 | 7170.22 | 10537.44 | -899.01 | -10539.25 | 1645990.02 | 14671793.75 | 40.3983481 | -104.9799820 | 2.40 | |
| 17540.00 | 90.250 | 268.730 | 7169.93 | 10626.41 | -901.12 | -10628.22 | 1645901.08 | 14671791.59 | 40.3983422 | -104.9803014 | 0.24 | |
| 17630.00 | 90.310 | 272.240 | 7169.49 | 10716.39 | -900.35 | -10718.20 | 1645811.14 | 14671792.30 | 40.3983442 | -104.9806245 | 3.90 | |
| 17719.00 | 90.490 | 272.110 | 7168.87 | 10805.33 | -896.98 | -10807.14 | 1645722.24 | 14671795.61 | 40.3983534 | -104.9809438 | 0.25 | |
| 17809.00 | 90.490 | 268.740 | 7168.10 | 10895.31 | -896.31 | -10897.12 | 1645632.29 | 14671796.22 | 40.3983551 | -104.9812669 | 3.74 | |
| 17898.00 | 90.120 | 265.690 | 7167.62 | 10984.19 | -900.63 | -10986.00 | 1645543.45 | 14671791.84 | 40.3983431 | -104.9815860 | 3.45 | |
| 17988.00 | 90.370 | 267.350 | 7167.24 | 11074.00 | -906.10 | -11075.83 | 1645453.65 | 14671786.32 | 40.3983280 | -104.9819085 | 1.87 | |
| 18077.00 | 90.280 | 269.200 | 7166.73 | 11162.95 | -908.77 | -11164.78 | 1645364.74 | 14671783.59 | 40.3983206 | -104.9822278 | 2.08 | |
| 18167.00 | 90.430 | 270.810 | 7166.18 | 11252.95 | -908.77 | -11254.78 | 1645274.78 | 14671783.54 | 40.3983205 | -104.9825509 | 1.80 | |
| 18256.00 | 90.370 | 271.400 | 7165.56 | 11341.93 | -907.05 | -11343.76 | 1645185.83 | 14671785.19 | 40.3983251 | -104.9828704 | 0.67 | |
| 18435.00 | 90.310 | 267.650 | 7164.49 | 11520.89 | -908.53 | -11522.72 | 1645006.95 | 14671783.59 | 40.3983208 | -104.9835129 | 2.10 | |
| 18524.00 | 90.980 | 268.260 | 7163.49 | 11609.82 | -911.71 | -11611.66 | 1644918.05 | 14671780.36 | 40.3983119 | -104.9838322 | 1.02 | |
| 18614.00 | 90.830 | 266.490 | 7162.07 | 11699.70 | -915.83 | -11701.55 | 1644828.20 | 14671776.18 | 40.3983005 | -104.9841550 | 1.97 | |
| 18703.00 | 90.770 | 265.840 | 7160.83 | 11788.48 | -921.78 | -11790.34 | 1644739.44 | 14671770.17 | 40.3982840 | -104.9844737 | 0.73 | |
| 18792.00 | 91.230 | 267.790 | 7159.27 | 11877.31 | -926.73 | -11879.18 | 1644650.64 | 14671765.17 | 40.3982704 | -104.9847927 | 2.25 | |
| 18882.00 | 91.350 | 268.660 | 7157.25 | 11967.24 | -929.51 | -11969.12 | 1644560.74 | 14671762.33 | 40.3982626 | -104.9851156 | 0.98 | |
| 18971.00 | 91.320 | 271.040 | 7155.17 | 12056.21 | -929.75 | -12058.08 | 1644471.81 | 14671762.04 | 40.3982618 | -104.9854350 | 2.67 | |
| 19060.00 | 91.290 | 271.670 | 7153.15 | 12145.17 | -927.64 | -12147.04 | 1644382.89 | 14671764.08 | 40.3982675 | -104.9857544 | 0.71 | |
| 19150.00 | 91.200 | 275.050 | 7151.19 | 12234.99 | -922.37 | -12236.85 | 1644293.11 | 14671769.29 | 40.3982818 | -104.9860768 | 3.76 | |
| 19240.00 | 91.110 | 274.140 | 7149.38 | 12324.69 | -915.16 | -12326.54 | 1644203.45 | 14671776.44 | 40.3983015 | -104.9863989 | 1.02 | |
| 19329.00 | 91.080 | 271.860 | 7147.68 | 12413.56 | -910.50 | -12415.39 | 1644114.63 | 14671781.04 | 40.3983142 | -104.9867179 | 2.56 | |
| 19419.00 | 90.980 | 271.790 | 7146.06 | 12503.50 | -907.64 | -12505.33 | 1644024.73 | 14671783.84 | 40.3983219 | -104.9870408 | 0.14 | |
| 19508.00 | 90.430 | 272.820 | 7144.96 | 12592.43 | -904.06 | -12594.25 | 1643935.84 | 14671787.36 | 40.3983316 | -104.9873601 | 1.31 | |
| 19597.00 | 90.490 | 273.580 | 7144.25 | 12681.30 | -899.09 | -12683.11 | 1643847.01 | 14671792.27 | 40.3983451 | -104.9876791 | 0.86 | |
| 19687.00 | 90.520 | 272.000 | 7143.45 | 12771.19 | -894.71 | -12773.00 | 1643757.16 | 14671796.59 | 40.3983570 | -104.9880018 | 1.76 | |
| 19776.00 | 90.370 | 267.190 | 7142.76 | 12860.16 | -895.34 | -12861.97 | 1643668.23 | 14671795.90 | 40.3983552 | -104.9883212 | 5.41 | |
| 19866.00 | 90.490 | 265.100 | 7142.09 | 12949.94 | -901.39 | -12951.76 | 1643578.48 | 14671789.80 | 40.3983384 | -104.9886436 | 2.33 | |
| 19955.00 | 90.490 | 265.850 | 7141.33 | 13038.64 | -908.41 | -13040.48 | 1643489.80 | 14671782.72 | 40.3983190 | -104.9889621 | 0.84 | |
| 20044.00 | 90.400 | 265.790 | 7140.64 | 13127.39 | -914.90 | -13129.24 | 1643401.08 | 14671776.18 | 40.3983011 | -104.9892808 | 0.12 | |
| 20134.00 | 90.460 | 267.310 | 7139.96 | 13217.21 | -920.31 | -13219.07 | 1643311.29 | 14671770.71 | 40.3982861 | -104.9896033 | 1.69 | |
| 20223.00 | 90.400 | 269.140 | 7139.29 | 13306.16 | -923.07 | -13308.02 | 1643222.37 | 14671767.89 | 40.3982784 | -104.9899226 | 2.06 | |

| REFERENCE WELLPATH IDENTIFICATION | | | |
|-----------------------------------|---|-----------|-------------------|
| Operator | KERR-MCGEE OIL & GAS ONSHORE LP (WA) | Well | DAMORE 18-7HZ |
| Field | WELD COUNTY (UTM/TRUE NORTH) | API/Legal | |
| Facility | SEC.18-T5N-R67W | Wellbore | DAMORE 18-7HZ AWB |
| Slot | SLOT#07 DAMORE 18-7HZ (2236'FNL & 710'FWL,SEC.18) | | |

| WELLPATH DATA (230 stations) † = interpolated, ‡ = extrapolated station | | | | | | | | | | | | |
|---|--------------------|----------------|-------------|-------------------|---------------|--------------|----------------------|-----------------------|------------|--------------|------------------|--|
| MD [ft] | Inclination [°] | Azimuth [°] | TVD [ft] | Vert Sect [ft] | North [ft] | East [ft] | Grid East [US ft] | Grid North [US ft] | Latitude | Longitude | DLS [°/100ft] | Comments |
| 20313.00 | 90.430 | 271.650† | 7138.64 | 13396.15 | -922.45 | -13398.01 | 1643132.42 | 14671768.45 | 40.3982800 | -104.9902457 | 2.79 | |
| 20402.00 | 90.520 | 274.600† | 7137.90 | 13485.01 | -917.60 | -13486.86 | 1643043.60 | 14671773.25 | 40.3982931 | -104.9905648 | 3.32 | |
| 20492.00 | 90.490 | 276.940† | 7137.11 | 13574.56 | -908.55 | -13576.40 | 1642954.09 | 14671782.23 | 40.3983178 | -104.9908862 | 2.60 | |
| 20536.00 | 90.770 | 277.970† | 7136.62 | 13618.20 | -902.84 | -13620.02 | 1642910.48 | 14671787.91 | 40.3983334 | -104.9910429 | 2.43 | LAST BH MWD+IFR1+MSA SURVEY |
| 20571.00‡ | 90.770 | 277.970† | 7136.15 | 13652.87 | -897.99 | -13654.68 | 1642875.84 | 14671792.74 | 40.3983467 | -104.9911673 | 0.00 | PTB (2104'FSL & 2145'FEL, SEC.15) 40.3983467, -104.9911673 |

| HOLE & CASING SECTIONS - Ref Wellbore: DAMORE 18-7HZ AWB Ref Wellpath: DAMORE 18-7HZ AWP | | | | | | | | | |
|--|---------------|-------------|---------------|----------------|--------------|----------------|----------------|--------------|--------------|
| String/Diameter | Start MD [ft] | End MD [ft] | Interval [ft] | Start TVD [ft] | End TVD [ft] | Start N/S [ft] | Start E/W [ft] | End N/S [ft] | End E/W [ft] |
| 9.625in Casing Surface | 26.00 | 1904.00 | 1878.00 | 26.00 | 1874.06 | 0.00 | 0.00 | -266.97 | -21.93 |

| TARGETS | | | | | | | | |
|--|---------------------------------------|------------|-----------|-------------------|--------------------|------------|--------------|---------|
| Name | TVD [ft] | North [ft] | East [ft] | Grid East [US ft] | Grid North [US ft] | Latitude | Longitude | Shape |
| DAMORE DSU | 16.00 | 69.22 | -57.37 | 1656467.04 | 14672768.45 | 40.4010120 | -104.9423490 | polygon |
| | 2D Polygon: dimensions not calculated | | | | | | | |
| SEC.13-T5N-R67W | 16.00 | -922.71 | -1277.69 | 1655247.87 | 14671776.13 | 40.3982892 | -104.9467303 | polygon |
| | 2D Polygon: dimensions not calculated | | | | | | | |
| SEC.14-T5N-R67W | 16.00 | -922.71 | -1277.69 | 1655247.87 | 14671776.13 | 40.3982892 | -104.9467303 | polygon |
| | 2D Polygon: dimensions not calculated | | | | | | | |
| SEC.15-T5N-R67W | 16.00 | -928.71 | -1277.69 | 1655247.87 | 14671770.13 | 40.3982727 | -104.9467303 | polygon |
| | 2D Polygon: dimensions not calculated | | | | | | | |
| SEC.17-T5N-R67W | 16.00 | -908.71 | -1277.69 | 1655247.86 | 14671790.12 | 40.3983276 | -104.9467303 | polygon |
| | 2D Polygon: dimensions not calculated | | | | | | | |
| SEC.18-T5N-R67W | 16.00 | -908.71 | -1277.69 | 1655247.86 | 14671790.12 | 40.3983276 | -104.9467303 | polygon |
| | 2D Polygon: dimensions not calculated | | | | | | | |
| DAMORE 18-7HZ BHL REV-2 (2105'FSL & 2147'FEL,SEC.15) | 7093.00 | -896.79 | -13657.40 | 1642873.12 | 14671793.94 | 40.3983500 | -104.9911771 | point |
| DAMORE 18-7HZ HEEL REV-1 (2124'FSL & 75'FEL,SEC.13) | 7198.00 | -922.43 | -797.71 | 1655727.66 | 14671776.72 | 40.3982900 | -104.9450070 | point |

REFERENCE WELLPATH IDENTIFICATION

| | | | |
|----------|---|-----------|-------------------|
| Operator | KERR-MCGEE OIL & GAS ONSHORE LP (WA) | Well | DAMORE 18-7HZ |
| Field | WELD COUNTY (UTM/TRUE NORTH) | API/Legal | |
| Facility | SEC.18-T5N-R67W | Wellbore | DAMORE 18-7HZ AWB |
| Slot | SLOT#07 DAMORE 18-7HZ (2236'FNL & 710'FWL,SEC.18) | | |

WELLPATH COMPOSITION - Ref Wellbore: DAMORE 18-7HZ AWB Ref Wellpath: DAMORE 18-7HZ AWP

| Start MD [ft] | End MD [ft] | Positional Uncertainty Model | Log Name/Comment | Wellbore | Survey Date |
|------------------|----------------|--|---|-------------------|-------------|
| 26.00 | 1856.00 | Custom APC_ISCWSA REV 2 MWD+IFR1 (approximation) | Custom APC ISCWSA Rev-2 MWD+IFR1 <120 - 1838 > | DAMORE 18-7HZ AWB | 2/27/2020 |
| 1856.00 | 20571.00 | Custom APC_ISCWSA REV 2 MWD+IFR1+MSA (approximation) | BH Custom APC ISCWSA Rev-2 MWD+IFR1+MSA <1978 - 20536 > | DAMORE 18-7HZ AWB | 4/11/2020 |

| REFERENCE WELLPATH IDENTIFICATION | | | |
|-----------------------------------|---|-----------|-------------------|
| Operator | KERR-MCGEE OIL & GAS ONSHORE LP (WA) | Well | DAMORE 18-7HZ |
| Field | WELD COUNTY (UTM/TRUE NORTH) | API/Legal | |
| Facility | SEC.18-T5N-R67W | Wellbore | DAMORE 18-7HZ AWB |
| Slot | SLOT#07 DAMORE 18-7HZ (2236'FNL & 710'FWL,SEC.18) | | |

| WELLPATH COMMENTS | | | | |
|-------------------|--------------------|----------------|-------------|--|
| MD [ft] | Inclination [°] | Azimuth [°] | TVD [ft] | Comment |
| 138.00 | 1.330 | 134.080 | 137.99 | FIRST SURFACE MWD+IFR1 SURVEY |
| 1856.00 | 14.920 | 180.210 | 1827.71 | LAST SURFACE MWD+IFR1 SURVEY |
| 1978.00 | 15.600 | 183.930 | 1945.41 | FIRST BH MWD+IFR1+MSA SURVEY |
| 6592.00 | 4.581 | 290.131 | 6478.36 | KOP |
| 7701.00 | 87.130 | 275.510 | 7186.47 | LANDING (2126'FSL & 88'FEL, SEC.13) 40.3982967, -104.9450083 |
| 20536.00 | 90.770 | 277.970 | 7136.62 | LAST BH MWD+IFR1+MSA SURVEY |
| 20571.00 | 90.770 | 277.970 | 7136.15 | PTB (2104'FSL & 2145'FEL, SEC.15) 40.3983467, -104.9911673 |