



39.91793, -108.73621, 5894.3ft, 90°  
05/27/2020 04:46:10 PM



**COLORADO**  
Oil & Gas Conservation  
Commission  
Department of Natural Resources

**Photo 1. Location.**

**Philadelphia Creek 39      API: 05-103-08457**  
**Inspection: 700401698**



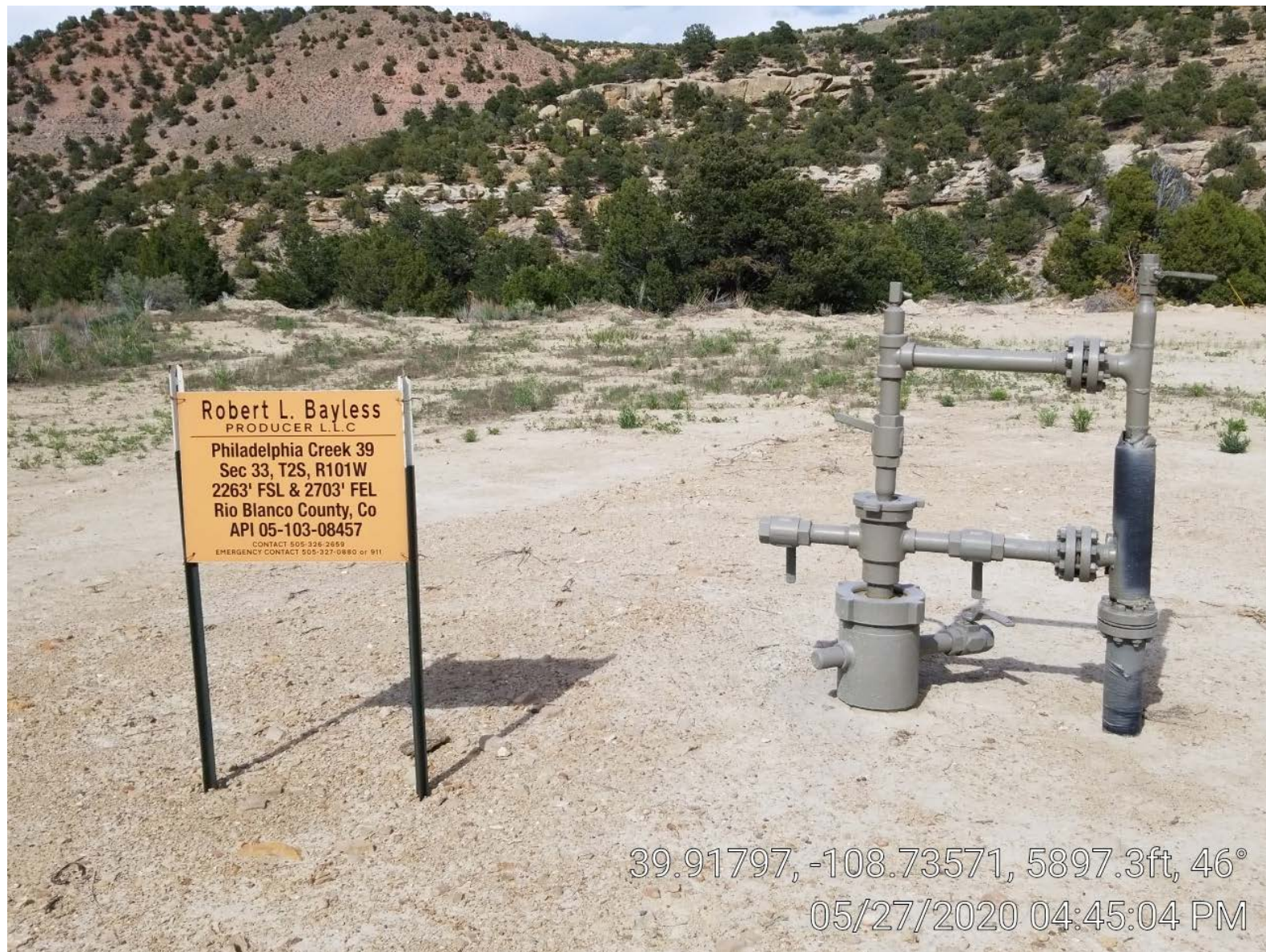

**COLORADO**  
Oil & Gas Conservation  
Commission  
Department of Natural Resources

**Photo 2. Well head.**

**Philadelphia Creek 39      API: 05-103-08457**  
**Inspection: 700401698**





**COLORADO**  
Oil & Gas Conservation  
Commission  
Department of Natural Resources

**Photo 3. Meter building.**

**Philadelphia Creek 39**      **API: 05-103-08457**  
**Inspection: 700401698**





39.91794, -108.73611, 5887.7ft, 105°  
05/27/2020 04:46:26 PM



**COLORADO**  
Oil & Gas Conservation  
Commission  
Department of Natural Resources

**Photo 4. Pit & separator.**

**Philadelphia Creek 39      API: 05-103-08457**  
**Inspection: 700401698**



