

REV: 2 02-19-20 C.IVIE (ACCESS ROUTE CHANGE)

LEGEND:

 PROPOSED LOCATION



UELS, LLC
Corporate Office * 85 South 200 East
Vernal, UT 84078 * (435) 789-1017



**BONANZA CREEK ENERGY
OPERATING COMPANY, LLC**

CROW VALLEY 44-32 WELL PAD
SE 1/4 SE 1/4, SECTION 32, T7N, R62W, 6th P.M.
WELD COUNTY, COLORADO

SURVEYED BY	J.C.	11-21-19	SCALE
DRAWN BY	J.L.G.	11-26-19	1 : 100,000
ACCESS ROAD MAP			TOPO A

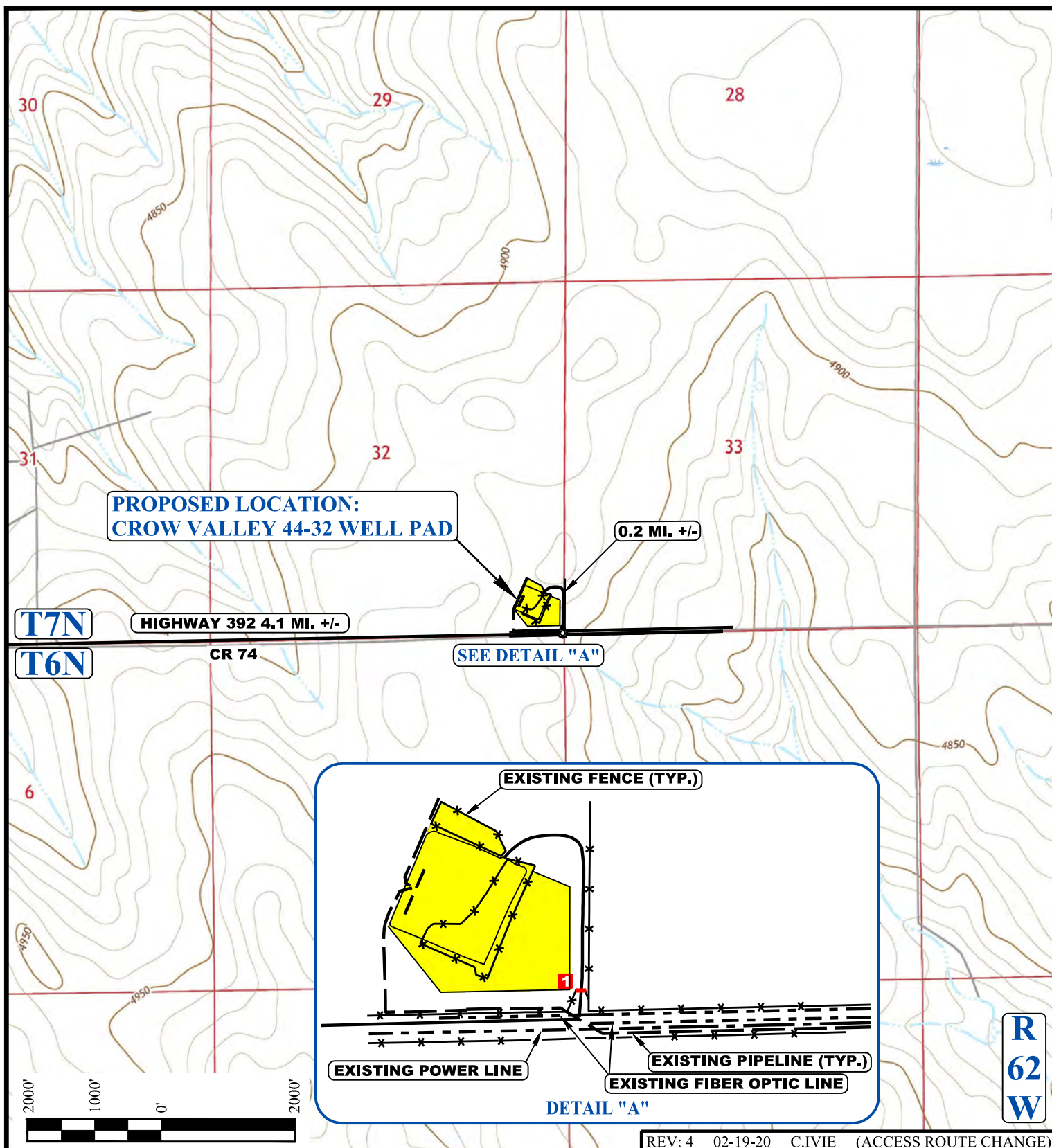

REV: 4 02-19-20 C.IVIE (ACCESS ROUTE CHANGE)

NOTE: PARCEL DATA SHOWN HAS BEEN OBTAINED FROM VARIOUS SOURCES AND SHOULD BE USED FOR MAPPING, GRAPHIC AND PLANNING PURPOSES ONLY. NO WARRANTY IS MADE BY UTAH ENGINEERING AND LAND SURVEYING (UELS) FOR ACCURACY OF THE PARCEL DATA.

LEGEND:

- EXISTING ROAD
- * * EXISTING FENCE
- - - EXISTING PIPELINE
- - - EXISTING POWER LINE/FIBER OPTIC LINE
- EXISTING CATTLE GUARD
- AREA OF MAX. DISTURBANCE



UELS, LLC
Corporate Office * 85 South 200 East
Vernal, UT 84078 * (435) 789-1017



BONANZA CREEK ENERGY OPERATING COMPANY, LLC

CROW VALLEY 44-32 WELL PAD
SE 1/4 SE 1/4, SECTION 32, T7N, R62W, 6th P.M.
WELD COUNTY, COLORADO

SURVEYED BY	J.C.	11-21-19	SCALE
DRAWN BY	J.L.G.	11-26-19	1 : 24,000
ACCESS ROAD MAP			TOPO B