

T4S

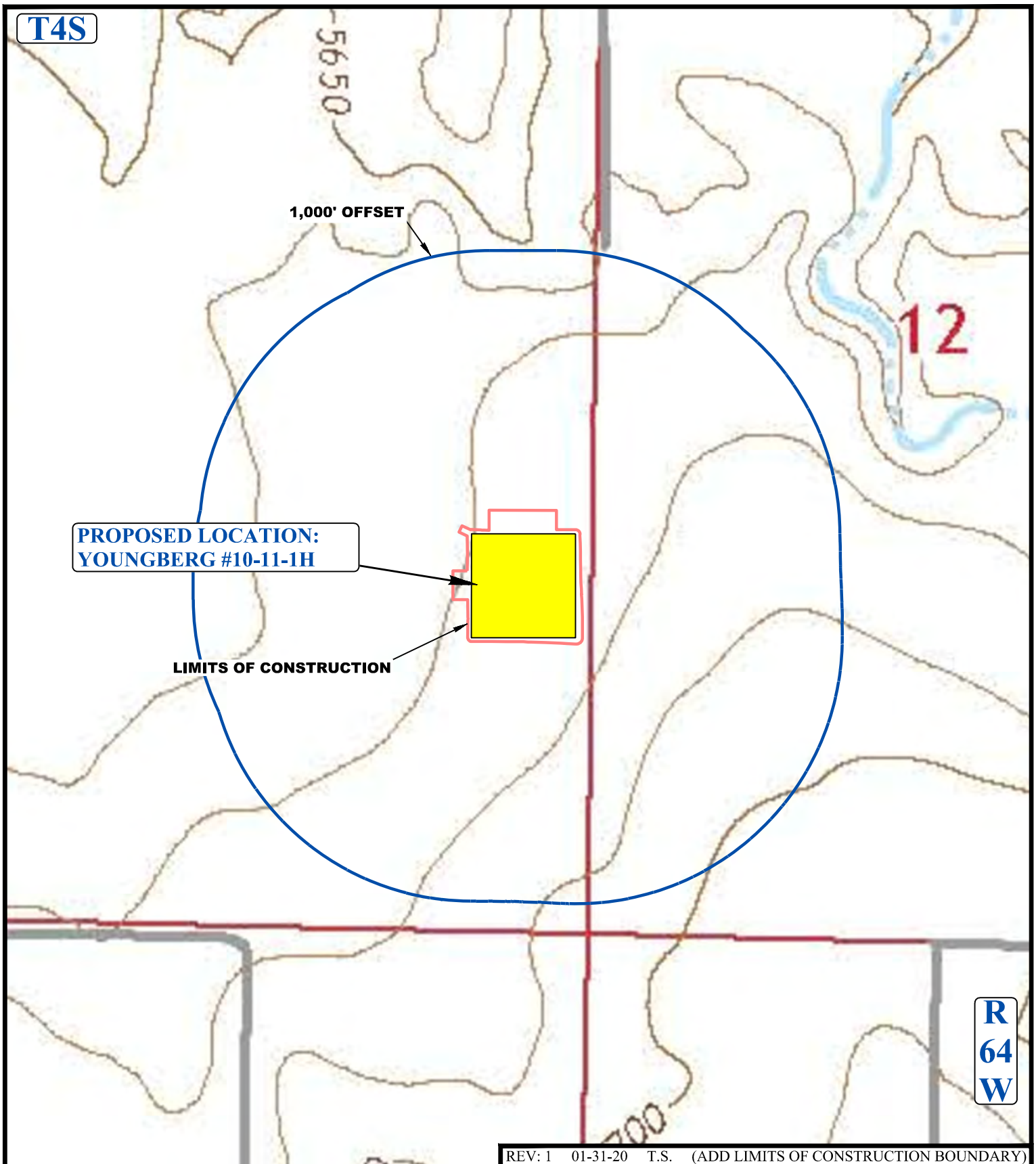

R  
64  
W

REV: 1 01-31-20 T.S. (ADD LIMITS OF CONSTRUCTION BOUNDARY)

**LEGEND:**

- EXISTING DRAINAGE
- 1000' OFFSET BOUNDARY
- LIMITS OF CONSTRUCTION
- FLOOD PLAINS



**UELS, LLC**  
Corporate Office \* 85 South 200 East  
Vernal, UT 84078 \* (435) 789-1017



**ConocoPhillips Company**

**YOUNGBERG #10-11-1H**  
**LOCATION ID: 433581**  
**1320' FNL 255' FEL**  
**NE 1/4 SE 1/4, SECTION 11, T4S, R64W, 6th P.M.**  
**ARAPAHOE COUNTY, COLORADO**

SURVEYED BY	J. BAYLIFF	06-30-18	SCALE
DRAWN BY	H.K.W.	10-12-12	1 : 6,000
<b>HYDROLOGY MAP</b>			<b>TOPO W</b>