

RECEIVED

JUL 13 1970

COLO. OIL & GAS CONS. COMM.

R. 42W

Webb Resource
RECEIVED



JUL 10 1970

☐ S.G. ☐ J.H.C. ☐ O.L.T.
☐ R.T.B. ☐ C.K.L. ☐ Lse. Rec.
☐ M.J.D. ☐ J.S.H.
☐ W.R.S. ☐ Acct.

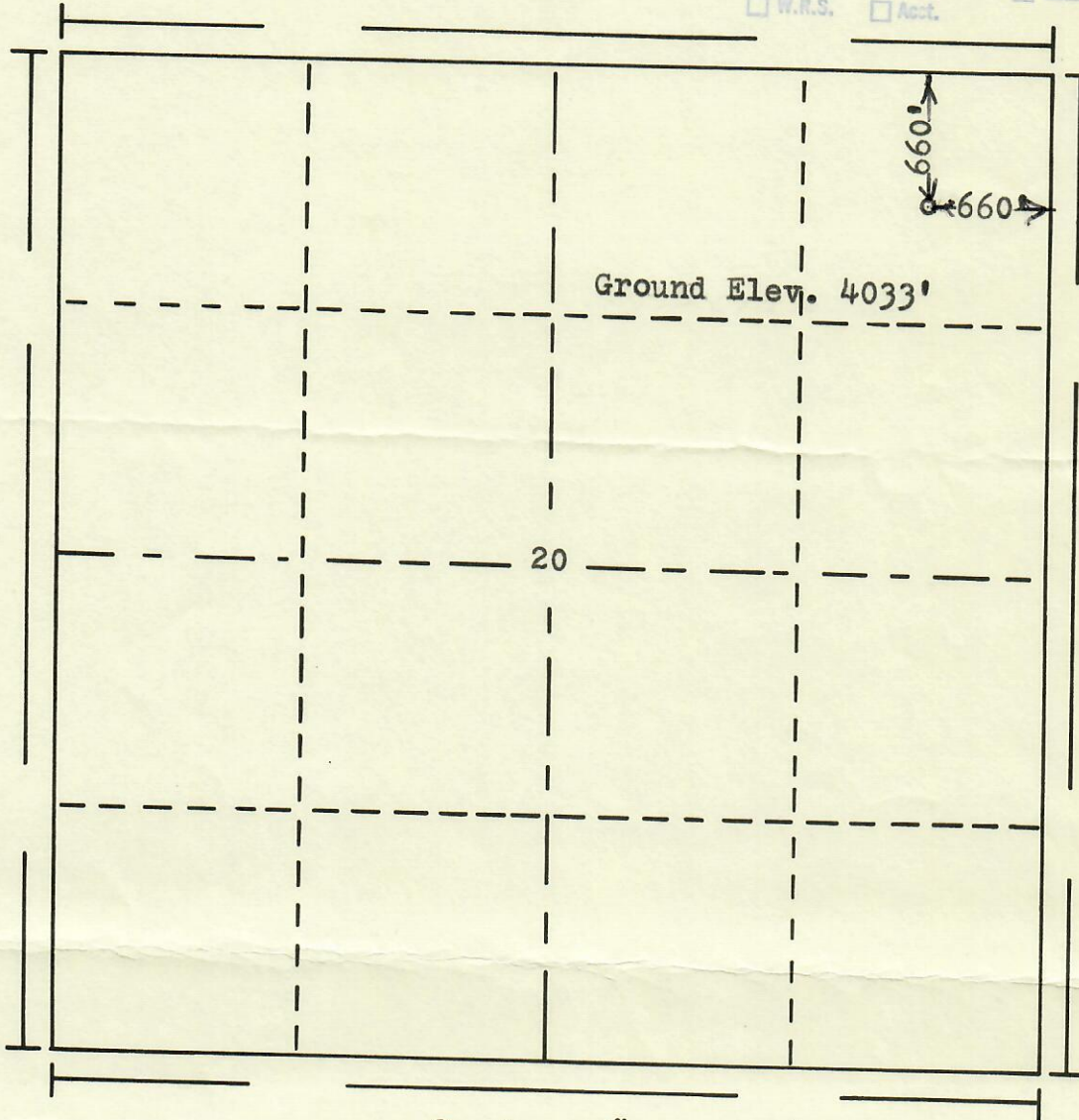

T.
15
S

Scale... 1" = 1000'

Powers Elevation Company, Inc. of Denver, Colorado
has in accordance with a request from Betty
for Webb Resources Co.

determined the location of No. 20-1 Bernal Wallace
to be CNE NE Section 20 Township 15S
Range 42W of the 6th Principal Meridian
Cheyenne County, Colorado

I hereby certify that this plat is an
accurate representation of a correct
survey showing the location of

Date: 7-7-70

Billy B. Holliday
Licensed Land Surveyor No. 2853
State of Colorado

