

# Location Drawing

10

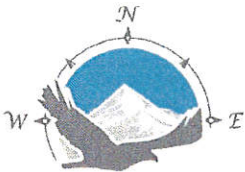

## FRANE SURVEYING INC.

Physical Address: 34834 Annie Cir.  
Mail to: Box 2372, Elizabeth, CO 80107  
Ph. 303-243-0037  
www.franesurveying.com

Job # 19-059-ALC-1748 #1-33

Frane Surveying, in accordance with a request from **McCoy Petroleum Corporation** has determined the location of **ALC 1748 #1-33** to be **1980 Feet FSL**, and **660 Feet FEL**, (90° off Section lines) of Section **33**, Township **17s**, Range **48w** of the 6th Principal Meridian, **Kiowa County, Colorado**.

Date: Staked on 04/18/19 drawn on 04/24/19.

Re:

Staked by Elijah Frane

Drawn:

Drawn by Elijah Frane

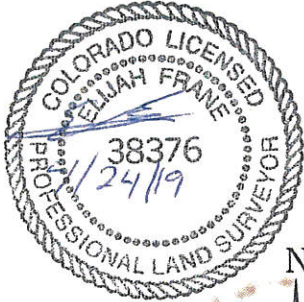

## Location Drawing

The West R.O.W. of Hwy <sup>287</sup>40 falls approx. 351' East and the East R.O.W. falls approx. 451' East of the proposed well pad.



SCALE: 1" = 400'

6 McCoy Petroleum Corp.  
ALC 1748 #1-33  
SE 1/4 SEC. 33-17S-48W  
Kiowa, CO, Colorado

