

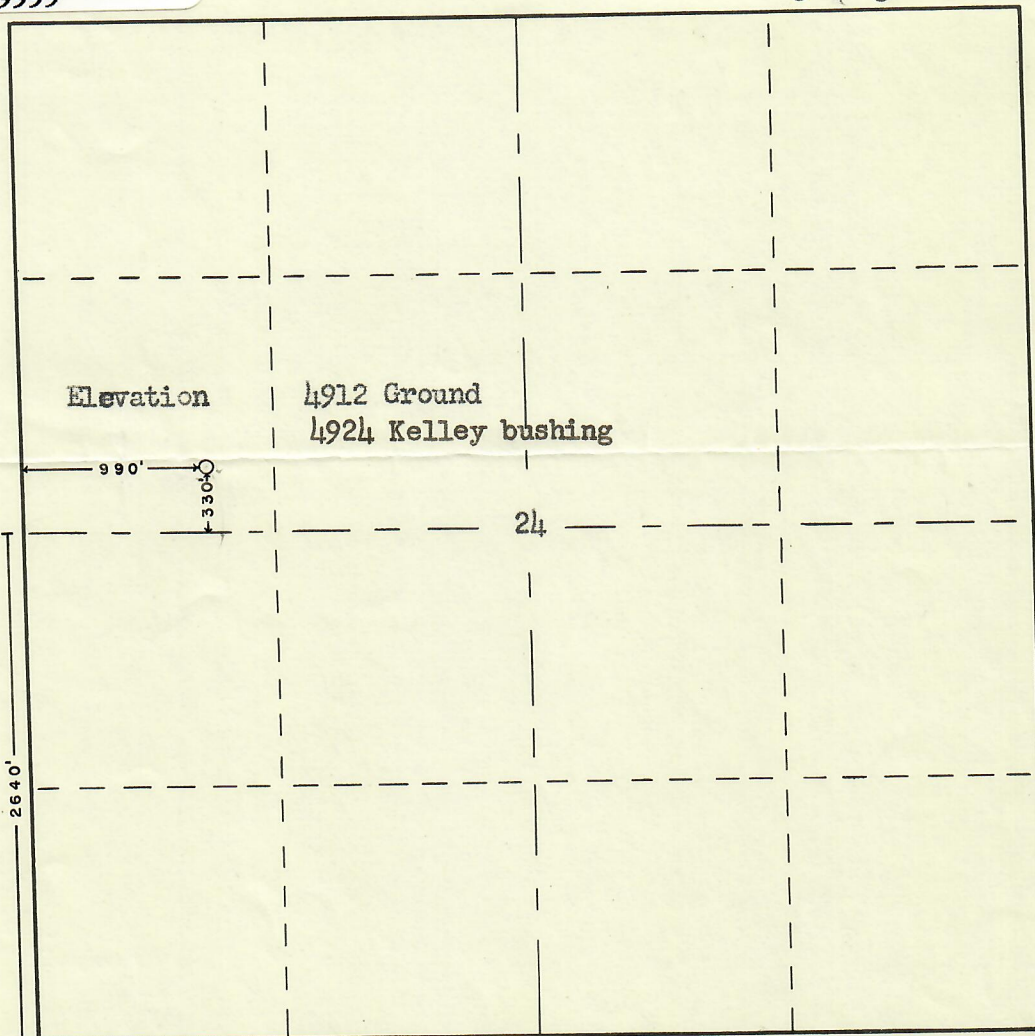

99999999

R. 56 W.

12306022



T.

12

N.

Scale ... 1" = 1000'

Powers Elevation Company of Casper, Wyoming
has in accordance with a request from Mr. Leo Hantz
for J. M. Huber Corporation determined the
Location of #1 Ella Long
to be SE SW NW Section 24 Township 12 North
Range 56 West 6th Principal Meridian
Weld County, Colorado

The above Plat shows the location of the well site
in said section.



00790077

Powers Elevation Company

by:

Burr Leibert

Burr Leibert

Registered Land Surveyor

Date: 3/2/53