



HighPoint Resources
Project: Weld County, CO (NAD83)
Site: Sec 34-T12N-R63W
Well: Fox Creek 34-0263B
Wellbore: Wellbore #1
Design: Wellbore #1 (Fox Creek 34-0263B/Wellbore #1)
Savanna 802

PROJECT DETAILS: Weld County, CO (NAD83)
Geodetic System: US State Plane 1983
Datum: North American Datum 1983
Ellipsoid: GRS 1980
Zone: Colorado Northern Zone
System Datum: Mean Sea Level
Local North: True

WELL DETAILS: Fox Creek 34-0263B

Ground Elevation:: 5450.80
RKB Elevation: KB @ 5470.80usft (Savanna 802)
Rig Name: Savanna 802

Northing	Easting	Latitude	Longitude
1597996.24	3296894.36	40.969919	-104.424927

ANNOTATIONS

MD	Inc	Azi	TVD	+N/-S	+E/-W	VSect	Departure	Annotation
1493.00	6.12	6.36	1489.83	77.62	24.65	-77.47	81.71	Tie into Surface Surveys
1579.00	6.54	12.31	1575.30	86.96	26.20	-86.80	91.19	First MWD Survey @ 1579' MD
7476.25	30.00	184.45	7226.73	1472.58	233.79	-1471.13	1654.53	30° Inclination @ 7476.25' MD
7894.89	66.69	178.98	7505.88	1169.00	231.22	-1167.56	1958.02	Cross @ 7894.89' MD
7920.10	70.00	179.15	7515.18	1145.58	231.60	-1144.14	1980.65	70° Inclination @ 7920.1' MD
13166.72	89.43	176.19	7532.66	-4096.00	293.04	4097.72	7224.23	Cross @ 13166.72' MD
18320.00	93.15	177.37	7525.78	-9246.49	330.72	9248.34	12376.80	Last MWD Survey @ 18320' MD
18387.00	93.15	177.37	7522.10	-9313.32	333.79	9315.18	12443.70	Projection to TD @ 18387' MD 90.5' FSL/ 1312.5' FWL

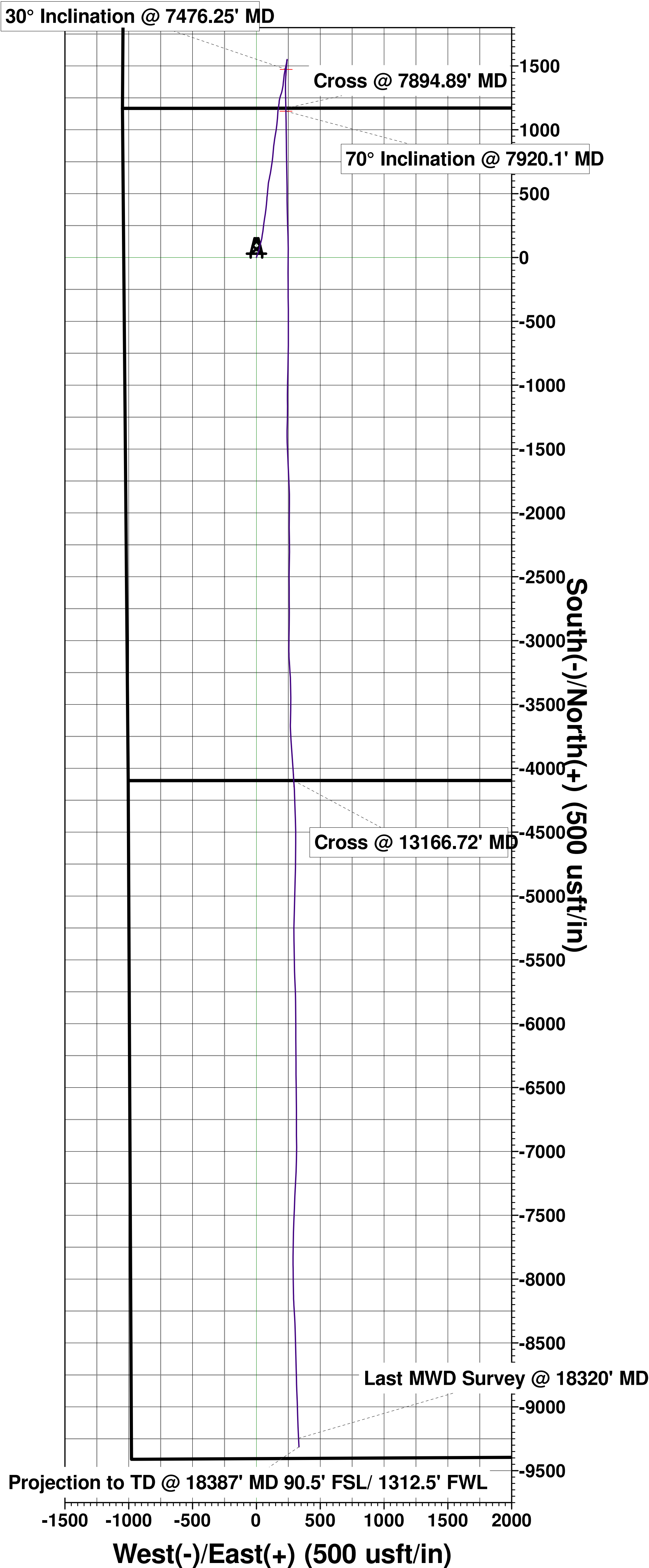
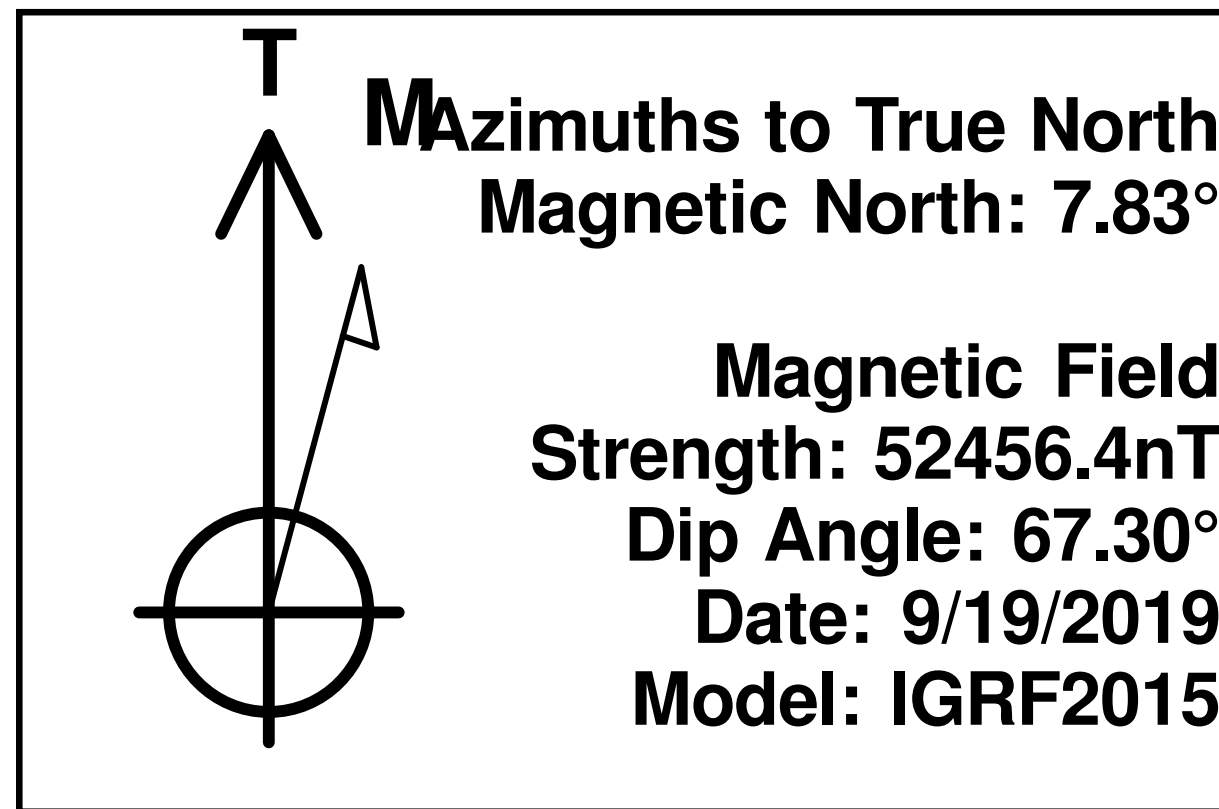
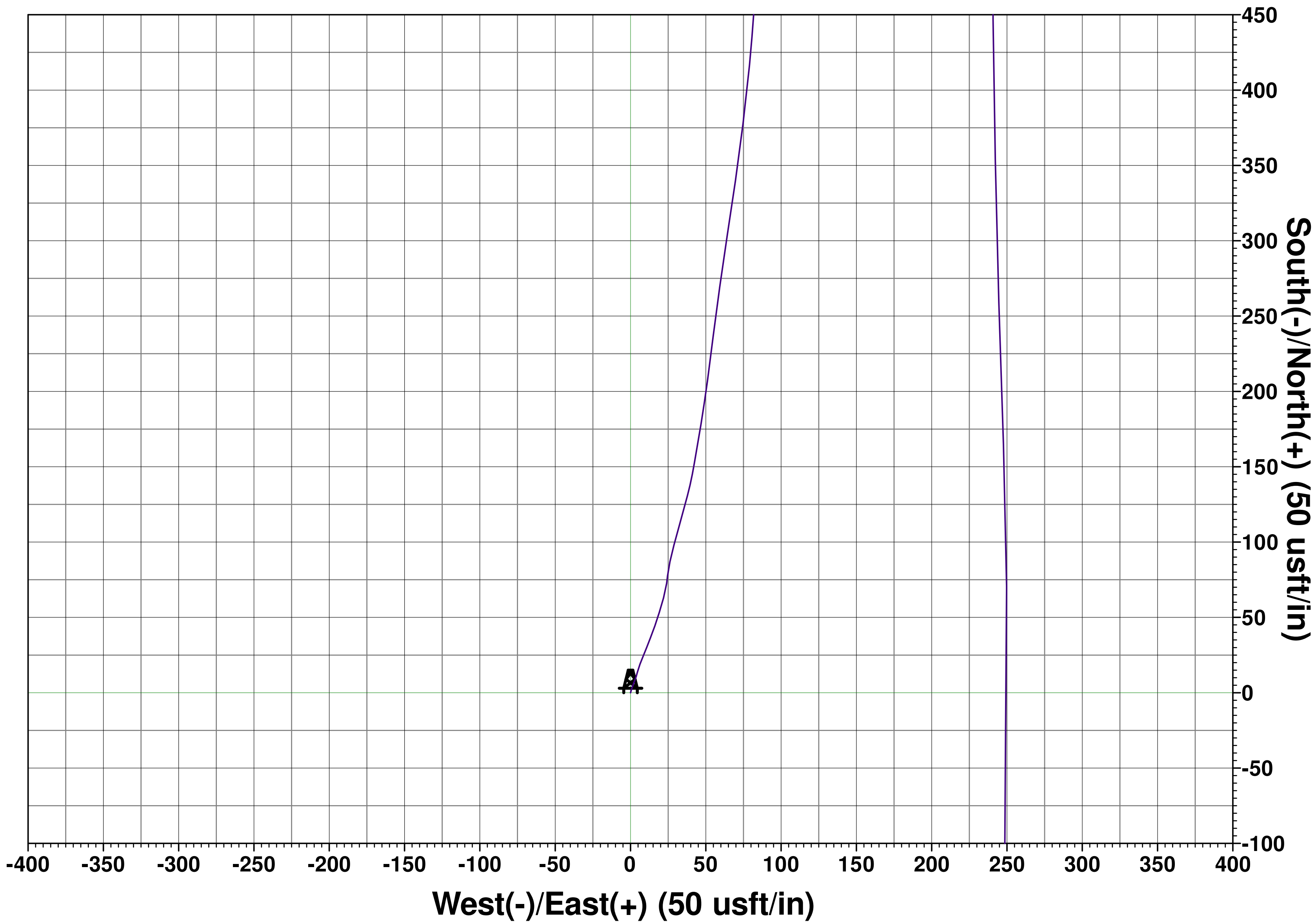
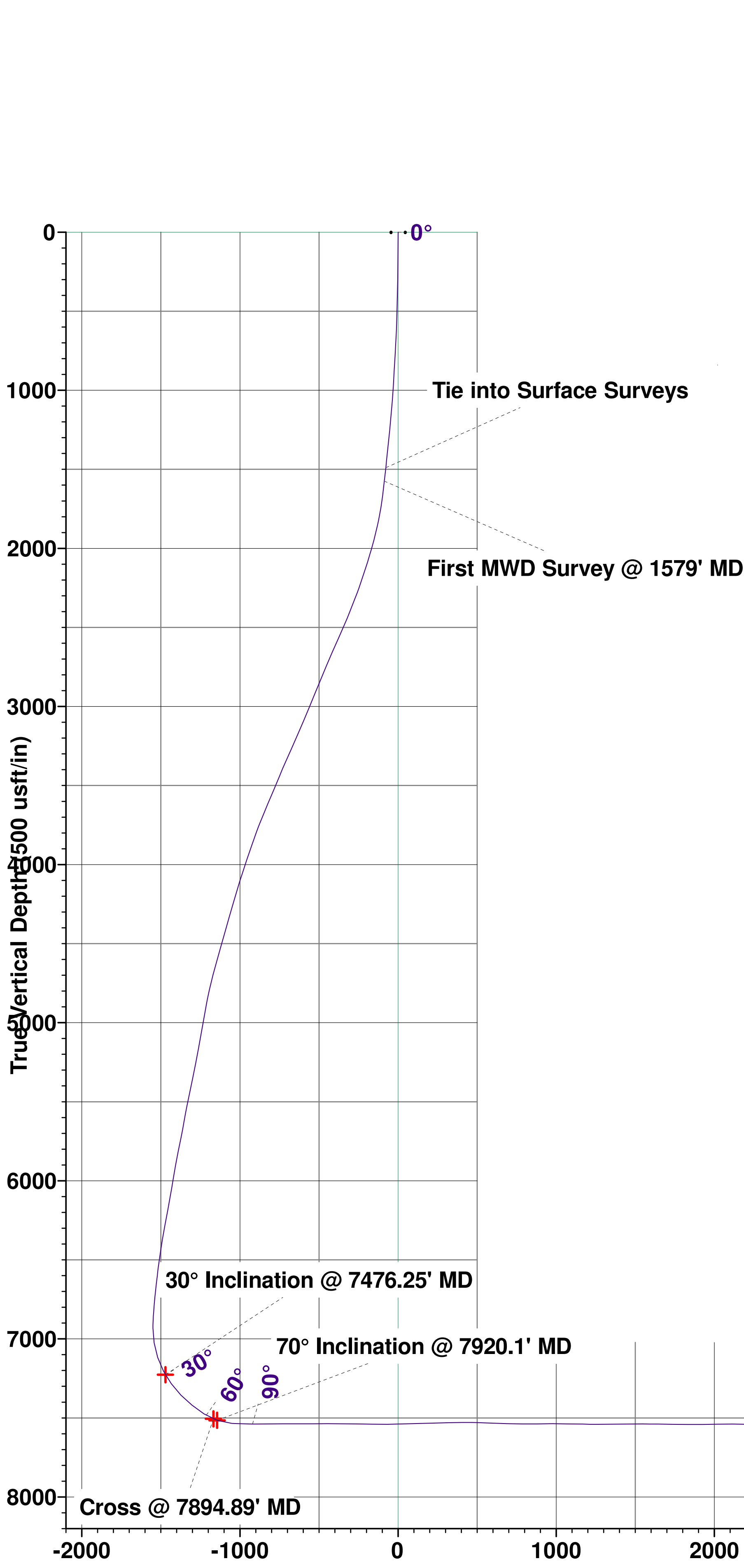

HighPoint Resources

Weld County, CO (NAD83)

Sec 34-T12N-R63W

Fox Creek 34-0263B

Wellbore #1

Design: Wellbore #1

Standard Survey Report

15 October, 2019

Survey Report

Company:	HighPoint Resources	Local Co-ordinate Reference:	Well Fox Creek 34-0263B
Project:	Weld County, CO (NAD83)	TVD Reference:	KB @ 5470.80usft (Savanna 802)
Site:	Sec 34-T12N-R63W	MD Reference:	KB @ 5470.80usft (Savanna 802)
Well:	Fox Creek 34-0263B	North Reference:	True
Wellbore:	Wellbore #1	Survey Calculation Method:	Minimum Curvature
Design:	Wellbore #1	Database:	EDM 5000.15 Single User Db

Project	Weld County, CO (NAD83)		
Map System:	US State Plane 1983	System Datum:	Mean Sea Level
Geo Datum:	North American Datum 1983		
Map Zone:	Colorado Northern Zone		

Site		Sec 34-T12N-R63W						
Site Position:		Northing:	1,599,151.60	usft	Latitude:	40.973125		
From:	Lat/Long	Easting:	3,295,830.61	usft	Longitude:	-104.428728		
Position Uncertainty:	0.00	usft	Slot Radius:	13-3/16	"	Grid Convergence:	0.69	°

Well		Fox Creek 34-0263B				
Well Position	+N/-S	0.00 usft	Northing:	1,597,996.24 usft	Latitude:	40.969919
	+E/-W	0.00 usft	Easting:	3,296,894.36 usft	Longitude:	-104.424927
Position Uncertainty		0.00 usft	Wellhead Elevation:	usft	Ground Level:	5,450.80 usft

Wellbore	Wellbore #1				
Magnetics	Model Name	Sample Date	Declination (°)	Dip Angle (°)	Field Strength (nT)
	IGRF2015	9/19/2019	7.83	67.30	52,456.36867002

Design	Wellbore #1				
Audit Notes:					
Version:	1.0	Phase:	ACTUAL	Tie On Depth:	0.00
Vertical Section:	Depth From (TVD) (usft)	+N/-S (usft)	+E/-W (usft)	Direction (°)	
	0.00	0.00	0.00	179.65	

Survey Program	Date	10/15/2019			
From (usft)	To (usft)	Survey (Wellbore)	Tool Name	Description	
304.00	1,493.00	Surface Surveys (Wellbore #1)	MWD	MWD - Standard	
1,579.00	18,387.00	Atlas MWD Surveys (Wellbore #1)	MWD	MWD - Standard	

Survey										
Measured Depth (usft)	Inclination (°)	Azimuth (°)	Vertical Depth (usft)	+N/-S (usft)	+E/-W (usft)	Vertical Section (usft)	Dogleg Rate (°/100usft)	Build Rate (°/100usft)	Turn Rate (°/100usft)	
0.00	0.00	0.00	0.00	0.00	0.00	0.00	0.00	0.00	0.00	
304.00	0.95	16.82	303.99	2.41	0.73	-2.41	0.31	0.31	0.00	
399.00	1.13	19.98	398.97	4.05	1.28	-4.04	0.20	0.19	3.33	
621.00	2.56	21.26	620.85	10.72	3.82	-10.70	0.64	0.64	0.58	
685.00	3.13	10.96	684.77	13.77	4.67	-13.74	1.19	0.89	-16.09	
781.00	3.32	23.25	780.62	18.90	6.27	-18.86	0.75	0.20	12.80	
876.00	3.47	21.48	875.45	24.10	8.41	-24.05	0.19	0.16	-1.86	
971.00	4.07	22.15	970.25	29.90	10.73	-29.83	0.63	0.63	0.71	
1,066.00	4.58	20.75	1,064.98	36.57	13.35	-36.49	0.55	0.54	-1.47	
1,161.00	5.55	19.63	1,159.60	44.44	16.23	-44.34	1.03	1.02	-1.18	

Survey Report

Company:	HighPoint Resources	Local Co-ordinate Reference:	Well Fox Creek 34-0263B
Project:	Weld County, CO (NAD83)	TVD Reference:	KB @ 5470.80usft (Savanna 802)
Site:	Sec 34-T12N-R63W	MD Reference:	KB @ 5470.80usft (Savanna 802)
Well:	Fox Creek 34-0263B	North Reference:	True
Wellbore:	Wellbore #1	Survey Calculation Method:	Minimum Curvature
Design:	Wellbore #1	Database:	EDM 5000.15 Single User Db

Survey									
Measured Depth (usft)	Inclination (°)	Azimuth (°)	Vertical Depth (usft)	+N/-S (usft)	+E/-W (usft)	Vertical Section (usft)	Dogleg Rate (°/100usft)	Build Rate (°/100usft)	Turn Rate (°/100usft)
1,255.00	5.89	16.91	1,253.14	53.34	19.16	-53.22	0.46	0.36	-2.89
1,351.00	6.10	15.45	1,348.61	62.97	21.96	-62.83	0.27	0.22	-1.52
1,446.00	5.96	8.35	1,443.09	72.71	24.02	-72.57	0.80	-0.15	-7.47
1,493.00	6.12	6.36	1,489.83	77.62	24.65	-77.47	0.56	0.34	-4.23
Tie into Surface Surveys									
1,579.00	6.54	12.31	1,575.30	86.96	26.20	-86.80	0.91	0.49	6.92
First MWD Survey @ 1579' MD									
1,674.00	7.24	14.80	1,669.62	98.03	28.88	-97.85	0.80	0.74	2.62
1,768.00	10.52	15.57	1,762.48	112.03	32.70	-111.83	3.49	3.49	0.82
1,863.00	12.92	14.86	1,855.49	130.65	37.75	-130.42	2.53	2.53	-0.75
1,959.00	14.83	9.79	1,948.69	153.13	42.59	-152.87	2.36	1.99	-5.28
2,053.00	16.88	9.44	2,039.11	178.45	46.88	-178.16	2.18	2.18	-0.37
2,149.00	18.07	7.62	2,130.67	206.96	51.14	-206.65	1.36	1.24	-1.90
2,244.00	19.04	7.04	2,220.74	236.94	54.99	-236.60	1.04	1.02	-0.61
2,339.00	21.28	7.91	2,309.91	269.40	59.26	-269.04	2.38	2.36	0.92
2,433.00	22.11	8.85	2,397.25	303.78	64.33	-303.38	0.96	0.88	1.00
2,527.00	23.61	8.09	2,483.87	339.90	69.70	-339.46	1.63	1.60	-0.81
2,622.00	24.20	7.03	2,570.72	378.06	74.76	-377.59	0.77	0.62	-1.12
2,717.00	23.91	5.57	2,657.47	416.54	79.02	-416.05	0.70	-0.31	-1.54
2,812.00	22.96	3.64	2,744.63	454.20	82.06	-453.69	1.29	-1.00	-2.03
2,906.00	22.50	6.29	2,831.33	490.37	85.20	-489.84	1.19	-0.49	2.82
3,001.00	22.37	4.69	2,919.14	526.46	88.67	-525.91	0.66	-0.14	-1.68
3,096.00	22.74	6.22	3,006.88	562.73	92.13	-562.16	0.73	0.39	1.61
3,191.00	23.12	10.37	3,094.38	599.33	97.48	-598.73	1.75	0.40	4.37
3,286.00	24.01	12.17	3,181.45	636.57	104.91	-635.92	1.20	0.94	1.89
3,381.00	24.60	9.79	3,268.04	674.95	112.35	-674.25	1.20	0.62	-2.51
3,475.00	24.22	8.22	3,353.63	713.32	118.43	-712.58	0.80	-0.40	-1.67
3,570.00	22.64	7.40	3,440.80	750.74	123.57	-749.97	1.70	-1.66	-0.86
3,665.00	22.60	5.94	3,528.49	787.03	127.82	-786.23	0.59	-0.04	-1.54
3,760.00	23.31	4.68	3,615.97	823.92	131.24	-823.10	0.91	0.75	-1.33
3,855.00	22.44	5.64	3,703.50	860.70	134.56	-859.86	1.00	-0.92	1.01
3,950.00	20.40	7.83	3,791.93	895.15	138.60	-894.28	2.31	-2.15	2.31
4,045.00	19.50	7.23	3,881.23	927.28	142.85	-926.39	0.97	-0.95	-0.63
4,139.00	18.75	10.38	3,970.04	957.71	147.54	-956.79	1.36	-0.80	3.35
4,234.00	18.27	10.12	4,060.13	987.38	152.91	-986.43	0.51	-0.51	-0.27
4,329.00	16.61	6.71	4,150.76	1,015.53	157.11	-1,014.55	2.05	-1.75	-3.59
4,423.00	16.30	6.11	4,240.91	1,041.99	160.09	-1,040.99	0.38	-0.33	-0.64
4,518.00	16.40	5.49	4,332.07	1,068.60	162.79	-1,067.58	0.21	0.11	-0.65
4,613.00	15.47	4.84	4,423.42	1,094.57	165.14	-1,093.54	1.00	-0.98	-0.68
4,708.00	15.75	4.31	4,514.91	1,120.05	167.18	-1,119.01	0.33	0.29	-0.56
4,804.00	15.66	5.61	4,607.33	1,145.94	169.43	-1,144.88	0.38	-0.09	1.35
4,898.00	15.13	9.01	4,697.96	1,170.68	172.59	-1,169.61	1.11	-0.56	3.62
4,993.00	12.88	7.50	4,790.13	1,193.43	175.91	-1,192.33	2.40	-2.37	-1.59

Survey Report

Company:	HighPoint Resources	Local Co-ordinate Reference:	Well Fox Creek 34-0263B
Project:	Weld County, CO (NAD83)	TVD Reference:	KB @ 5470.80usft (Savanna 802)
Site:	Sec 34-T12N-R63W	MD Reference:	KB @ 5470.80usft (Savanna 802)
Well:	Fox Creek 34-0263B	North Reference:	True
Wellbore:	Wellbore #1	Survey Calculation Method:	Minimum Curvature
Design:	Wellbore #1	Database:	EDM 5000.15 Single User Db

Survey									
Measured Depth (usft)	Inclination (°)	Azimuth (°)	Vertical Depth (usft)	+N/-S (usft)	+E/-W (usft)	Vertical Section (usft)	Dogleg Rate (°/100usft)	Build Rate (°/100usft)	Turn Rate (°/100usft)
5,088.00	10.69	5.54	4,883.12	1,212.70	178.14	-1,211.59	2.34	-2.31	-2.06
5,183.00	10.49	6.23	4,976.50	1,230.06	179.93	-1,228.94	0.25	-0.21	0.73
5,277.00	9.94	16.40	5,069.02	1,246.36	183.15	-1,245.21	2.00	-0.59	10.82
5,372.00	11.14	15.69	5,162.42	1,263.06	187.95	-1,261.89	1.27	1.26	-0.75
5,466.00	11.75	21.69	5,254.55	1,280.69	193.94	-1,279.48	1.42	0.65	6.38
5,560.00	12.12	12.77	5,346.53	1,299.21	199.66	-1,297.97	2.00	0.39	-9.49
5,654.00	11.71	11.62	5,438.50	1,318.18	203.77	-1,316.91	0.50	-0.44	-1.22
5,749.00	11.30	9.09	5,531.59	1,336.81	207.18	-1,335.52	0.68	-0.43	-2.66
5,845.00	10.19	6.27	5,625.91	1,354.54	209.59	-1,353.24	1.28	-1.16	-2.94
5,941.00	11.56	7.48	5,720.18	1,372.52	211.77	-1,371.20	1.45	1.43	1.26
6,036.00	11.20	6.39	5,813.31	1,391.13	214.04	-1,389.80	0.44	-0.38	-1.15
6,130.00	10.27	5.94	5,905.67	1,408.54	215.92	-1,407.19	0.99	-0.99	-0.48
6,224.00	9.43	3.49	5,998.28	1,424.56	217.26	-1,423.20	1.00	-0.89	-2.61
6,318.00	10.51	12.18	6,090.87	1,440.62	219.53	-1,439.26	1.97	1.15	9.24
6,413.00	10.91	13.69	6,184.21	1,457.83	223.49	-1,456.44	0.51	0.42	1.59
6,507.00	10.55	9.38	6,276.57	1,474.96	227.00	-1,473.55	0.94	-0.38	-4.59
6,602.00	9.46	10.35	6,370.12	1,491.22	229.82	-1,489.79	1.16	-1.15	1.02
6,696.00	8.65	10.45	6,462.95	1,505.77	232.49	-1,504.33	0.86	-0.86	0.11
6,790.00	7.47	12.26	6,556.02	1,518.70	235.07	-1,517.23	1.28	-1.26	1.93
6,884.00	6.38	10.81	6,649.33	1,529.80	237.34	-1,528.32	1.17	-1.16	-1.54
6,978.00	5.81	9.53	6,742.80	1,539.62	239.11	-1,538.13	0.62	-0.61	-1.36
7,073.00	4.31	6.59	6,837.43	1,547.91	240.32	-1,546.41	1.60	-1.58	-3.09
7,167.00	0.25	284.96	6,931.34	1,551.47	240.52	-1,549.98	4.55	-4.32	-86.84
7,261.00	9.60	183.70	7,024.90	1,543.69	239.82	-1,542.19	10.27	9.95	-107.72
7,356.00	17.78	185.15	7,117.13	1,521.30	238.00	-1,519.81	8.62	8.61	1.53
7,450.00	27.64	184.96	7,203.73	1,485.19	234.82	-1,483.73	10.49	10.49	-0.20
7,476.25	30.00	184.45	7,226.73	1,472.58	233.79	-1,471.13	9.03	8.98	-1.96
30° Inclination @ 7476.25' MD									
7,544.00	36.09	183.40	7,283.49	1,435.74	231.29	-1,434.30	9.03	8.99	-1.54
7,638.00	44.32	182.17	7,355.22	1,375.19	228.40	-1,373.76	8.80	8.76	-1.31
7,733.00	50.68	178.67	7,419.38	1,305.20	227.99	-1,303.79	7.22	6.69	-3.68
7,828.00	57.89	178.48	7,474.80	1,228.14	229.92	-1,226.72	7.59	7.59	-0.20
7,894.89	66.69	178.98	7,505.88	1,169.00	231.22	-1,167.57	13.16	13.15	0.74
Cross @ 7894.89' MD									
7,920.10	70.00	179.15	7,515.18	1,145.58	231.60	-1,144.14	13.16	13.15	0.67
70° Inclination @ 7920.1' MD									
7,922.00	70.25	179.16	7,515.83	1,143.79	231.63	-1,142.35	13.16	13.15	0.66
8,016.00	86.31	179.50	7,534.86	1,052.06	232.69	-1,050.61	17.09	17.09	0.36
8,034.00	87.27	179.02	7,535.87	1,034.09	232.92	-1,032.64	5.96	5.33	-2.67
8,149.00	90.06	179.24	7,538.55	919.14	234.67	-917.69	2.43	2.43	0.19
8,243.00	90.51	179.35	7,538.08	825.15	235.83	-823.69	0.49	0.48	0.12
8,338.00	90.31	178.65	7,537.40	730.17	237.48	-728.70	0.77	-0.21	-0.74
8,432.00	90.00	179.48	7,537.14	636.18	239.02	-634.71	0.94	-0.33	0.88
8,526.00	89.80	179.28	7,537.31	542.19	240.03	-540.71	0.30	-0.21	-0.21

Survey Report

Company:	HighPoint Resources	Local Co-ordinate Reference:	Well Fox Creek 34-0263B
Project:	Weld County, CO (NAD83)	TVD Reference:	KB @ 5470.80usft (Savanna 802)
Site:	Sec 34-T12N-R63W	MD Reference:	KB @ 5470.80usft (Savanna 802)
Well:	Fox Creek 34-0263B	North Reference:	True
Wellbore:	Wellbore #1	Survey Calculation Method:	Minimum Curvature
Design:	Wellbore #1	Database:	EDM 5000.15 Single User Db

Survey									
Measured Depth (usft)	Inclination (°)	Azimuth (°)	Vertical Depth (usft)	+N/-S (usft)	+E/-W (usft)	Vertical Section (usft)	Dogleg Rate (°/100usft)	Build Rate (°/100usft)	Turn Rate (°/100usft)
8,621.00	90.62	179.84	7,536.96	447.19	240.76	-445.71	1.05	0.86	0.59
8,715.00	89.09	178.32	7,537.20	353.21	242.27	-351.72	2.29	-1.63	-1.62
8,809.00	89.39	178.88	7,538.45	259.25	244.57	-257.75	0.68	0.32	0.60
8,904.00	88.78	177.40	7,539.96	164.31	247.65	-162.80	1.68	-0.64	-1.56
8,998.00	90.90	180.08	7,540.22	70.35	249.72	-68.82	3.64	2.26	2.85
9,093.00	91.56	180.72	7,538.19	-24.63	249.06	26.15	0.97	0.69	0.67
9,188.00	91.50	179.97	7,535.65	-119.59	248.48	121.11	0.79	-0.06	-0.79
9,283.00	92.09	179.75	7,532.67	-214.54	248.72	216.06	0.66	0.62	-0.23
9,378.00	90.85	179.38	7,530.24	-309.51	249.44	311.02	1.36	-1.31	-0.39
9,472.00	90.80	179.86	7,528.88	-403.49	250.06	405.01	0.51	-0.05	0.51
9,567.00	88.33	179.90	7,529.60	-498.48	250.26	500.00	2.60	-2.60	0.04
9,662.00	87.83	180.08	7,532.79	-593.43	250.28	594.95	0.56	-0.53	0.19
9,757.00	88.24	180.20	7,536.04	-688.37	250.04	689.89	0.45	0.43	0.13
9,852.00	89.29	180.97	7,538.09	-783.34	249.07	784.85	1.37	1.11	0.81
9,948.00	91.26	181.45	7,537.63	-879.32	247.05	880.81	2.11	2.05	0.50
10,043.00	89.90	181.22	7,536.67	-974.28	244.83	975.76	1.45	-1.43	-0.24
10,138.00	89.03	180.55	7,537.56	-1,069.27	243.37	1,070.73	1.16	-0.92	-0.71
10,234.00	88.68	178.84	7,539.47	-1,165.24	243.88	1,166.71	1.82	-0.36	-1.78
10,329.00	90.17	182.35	7,540.43	-1,260.22	242.89	1,261.68	4.01	1.57	3.69
10,424.00	90.52	180.21	7,539.86	-1,355.18	240.77	1,356.63	2.28	0.37	-2.25
10,519.00	90.54	178.35	7,538.98	-1,450.17	241.96	1,451.62	1.96	0.02	-1.96
10,614.00	90.07	177.46	7,538.47	-1,545.10	245.44	1,546.57	1.06	-0.49	-0.94
10,709.00	88.85	177.48	7,539.37	-1,640.00	249.63	1,641.50	1.28	-1.28	0.02
10,804.00	89.73	177.77	7,540.54	-1,734.91	253.57	1,736.43	0.98	0.93	0.31
10,899.00	89.09	177.32	7,541.52	-1,829.82	257.63	1,831.36	0.82	-0.67	-0.47
10,994.00	90.87	180.71	7,541.56	-1,924.79	259.27	1,926.34	4.03	1.87	3.57
11,089.00	91.16	181.34	7,539.87	-2,019.76	257.57	2,021.29	0.73	0.31	0.66
11,184.00	89.76	179.16	7,539.11	-2,114.75	257.15	2,116.28	2.73	-1.47	-2.29
11,279.00	88.47	179.04	7,540.58	-2,209.72	258.65	2,211.26	1.36	-1.36	-0.13
11,375.00	89.22	179.41	7,542.51	-2,305.69	259.94	2,307.24	0.87	0.78	0.39
11,469.00	90.55	182.41	7,542.70	-2,399.67	258.45	2,401.20	3.49	1.41	3.19
11,565.00	89.98	179.52	7,542.26	-2,495.64	256.83	2,497.16	3.07	-0.59	-3.01
11,660.00	90.36	180.09	7,541.98	-2,590.64	257.16	2,592.16	0.72	0.40	0.60
11,755.00	90.90	179.90	7,540.93	-2,685.63	257.17	2,687.16	0.60	0.57	-0.20
11,850.00	90.10	179.41	7,540.10	-2,780.63	257.74	2,782.15	0.99	-0.84	-0.52
11,945.00	90.55	181.25	7,539.56	-2,875.62	257.19	2,877.14	1.99	0.47	1.94
12,040.00	90.68	181.00	7,538.54	-2,970.60	255.33	2,972.10	0.30	0.14	-0.26
12,135.00	91.20	179.96	7,536.98	-3,065.58	254.53	3,067.08	1.22	0.55	-1.09
12,231.00	90.52	175.77	7,535.54	-3,161.48	258.11	3,163.00	4.42	-0.71	-4.36
12,326.00	90.35	176.52	7,534.82	-3,256.26	264.49	3,257.82	0.81	-0.18	0.79
12,421.00	90.10	179.09	7,534.45	-3,351.18	268.13	3,352.76	2.72	-0.26	2.71
12,517.00	89.97	179.22	7,534.39	-3,447.17	269.55	3,448.75	0.19	-0.14	0.14
12,612.00	89.78	181.36	7,534.60	-3,542.17	269.07	3,543.74	2.26	-0.20	2.25

Survey Report

Company:	HighPoint Resources	Local Co-ordinate Reference:	Well Fox Creek 34-0263B
Project:	Weld County, CO (NAD83)	TVD Reference:	KB @ 5470.80usft (Savanna 802)
Site:	Sec 34-T12N-R63W	MD Reference:	KB @ 5470.80usft (Savanna 802)
Well:	Fox Creek 34-0263B	North Reference:	True
Wellbore:	Wellbore #1	Survey Calculation Method:	Minimum Curvature
Design:	Wellbore #1	Database:	EDM 5000.15 Single User Db

Survey									
Measured Depth (usft)	Inclination (°)	Azimuth (°)	Vertical Depth (usft)	+N/-S (usft)	+E/-W (usft)	Vertical Section (usft)	Dogleg Rate (°/100usft)	Build Rate (°/100usft)	Turn Rate (°/100usft)
12,707.00	90.24	181.05	7,534.58	-3,637.14	267.07	3,638.71	0.58	0.48	-0.33
12,802.00	90.01	176.95	7,534.37	-3,732.11	268.73	3,733.68	4.32	-0.24	-4.32
12,898.00	90.21	175.60	7,534.19	-3,827.90	274.96	3,829.51	1.42	0.21	-1.41
12,993.00	90.23	176.12	7,533.82	-3,922.66	281.82	3,924.30	0.55	0.02	0.55
13,088.00	90.90	176.44	7,532.89	-4,017.45	287.98	4,019.13	0.78	0.71	0.34
13,166.72	89.43	176.19	7,532.66	-4,096.00	293.04	4,097.72	1.89	-1.86	-0.32
Cross @ 13166.72' MD									
13,183.00	89.13	176.14	7,532.86	-4,112.25	294.13	4,113.97	1.89	-1.86	-0.32
13,278.00	90.69	178.07	7,533.01	-4,207.12	298.93	4,208.87	2.61	1.64	2.03
13,373.00	90.63	177.87	7,531.92	-4,302.05	302.29	4,303.82	0.22	-0.06	-0.21
13,468.00	90.60	177.95	7,530.90	-4,396.98	305.76	4,398.77	0.09	-0.03	0.08
13,500.00	90.20	178.67	7,530.67	-4,428.97	306.70	4,430.76	2.57	-1.25	2.25
13,563.00	90.18	179.29	7,530.47	-4,491.96	307.82	4,493.75	0.98	-0.03	0.98
13,658.00	90.79	180.58	7,529.66	-4,586.95	307.93	4,588.75	1.50	0.64	1.36
13,753.00	90.52	179.97	7,528.58	-4,681.94	307.48	4,683.73	0.70	-0.28	-0.64
13,848.00	90.43	181.18	7,527.79	-4,776.93	306.52	4,778.72	1.28	-0.09	1.27
13,944.00	90.68	181.80	7,526.86	-4,872.90	304.03	4,874.66	0.70	0.26	0.65
14,039.00	89.53	181.41	7,526.68	-4,967.86	301.36	4,969.61	1.28	-1.21	-0.41
14,134.00	89.15	181.66	7,527.78	-5,062.82	298.82	5,064.55	0.48	-0.40	0.26
14,230.00	89.99	180.98	7,528.50	-5,158.79	296.61	5,160.50	1.13	0.88	-0.71
14,325.00	90.69	181.57	7,527.93	-5,253.76	294.50	5,255.46	0.96	0.74	0.62
14,420.00	89.13	178.36	7,528.08	-5,348.75	294.55	5,350.44	3.76	-1.64	-3.38
14,516.00	90.32	179.42	7,528.54	-5,444.72	296.41	5,446.43	1.66	1.24	1.10
14,612.00	90.39	178.79	7,527.95	-5,540.71	297.91	5,542.43	0.66	0.07	-0.66
14,707.00	89.47	177.58	7,528.07	-5,635.66	300.92	5,637.39	1.60	-0.97	-1.27
14,802.00	89.36	177.88	7,529.04	-5,730.58	304.68	5,732.33	0.34	-0.12	0.32
14,898.00	89.19	179.13	7,530.25	-5,826.54	307.19	5,828.30	1.31	-0.18	1.30
14,993.00	89.31	179.31	7,531.49	-5,921.52	308.48	5,923.29	0.23	0.13	0.19
15,088.00	90.27	180.20	7,531.84	-6,016.52	308.89	6,018.29	1.38	1.01	0.94
15,184.00	89.74	179.39	7,531.83	-6,112.51	309.23	6,114.29	1.01	-0.55	-0.84
15,279.00	89.84	179.96	7,532.18	-6,207.51	309.77	6,209.29	0.61	0.11	0.60
15,374.00	89.77	179.69	7,532.51	-6,302.51	310.06	6,304.29	0.29	-0.07	-0.28
15,469.00	89.23	179.41	7,533.33	-6,397.50	310.81	6,399.28	0.64	-0.57	-0.29
15,564.00	89.51	179.09	7,534.38	-6,492.49	312.05	6,494.27	0.45	0.29	-0.34
15,659.00	90.37	179.63	7,534.48	-6,587.48	313.11	6,589.27	1.07	0.91	0.57
15,753.00	91.20	179.78	7,533.19	-6,681.47	313.59	6,683.26	0.90	0.88	0.16
15,848.00	90.94	179.83	7,531.42	-6,776.45	313.92	6,778.25	0.28	-0.27	0.05
15,944.00	91.56	179.56	7,529.32	-6,872.43	314.43	6,874.22	0.70	0.65	-0.28
16,039.00	90.59	179.10	7,527.54	-6,967.41	315.54	6,969.20	1.13	-1.02	-0.48
16,134.00	90.33	182.27	7,526.78	-7,062.38	314.40	7,064.17	3.35	-0.27	3.34
16,229.00	89.39	181.83	7,527.01	-7,157.32	311.01	7,159.09	1.09	-0.99	-0.46
16,325.00	89.61	183.55	7,527.85	-7,253.21	306.50	7,254.94	1.81	0.23	1.79
16,420.00	90.32	182.60	7,527.91	-7,348.07	301.40	7,349.77	1.25	0.75	-1.00
16,515.00	89.21	181.33	7,528.30	-7,443.01	298.15	7,444.69	1.78	-1.17	-1.34

Survey Report

Company:	HighPoint Resources	Local Co-ordinate Reference:	Well Fox Creek 34-0263B
Project:	Weld County, CO (NAD83)	TVD Reference:	KB @ 5470.80usft (Savanna 802)
Site:	Sec 34-T12N-R63W	MD Reference:	KB @ 5470.80usft (Savanna 802)
Well:	Fox Creek 34-0263B	North Reference:	True
Wellbore:	Wellbore #1	Survey Calculation Method:	Minimum Curvature
Design:	Wellbore #1	Database:	EDM 5000.15 Single User Db

Survey										
Measured Depth (usft)	Inclination (°)	Azimuth (°)	Vertical Depth (usft)	+N/-S (usft)	+E/-W (usft)	Vertical Section (usft)	Dogleg Rate (°/100usft)	Build Rate (°/100usft)	Turn Rate (°/100usft)	
16,610.00	89.95	183.48	7,528.99	-7,537.92	294.16	7,539.57	2.39	0.78	2.26	
16,705.00	89.76	181.08	7,529.23	-7,632.83	290.38	7,634.47	2.53	-0.20	-2.53	
16,800.00	90.02	180.95	7,529.41	-7,727.82	288.70	7,729.44	0.31	0.27	-0.14	
16,895.00	88.93	180.52	7,530.28	-7,822.81	287.48	7,824.42	1.23	-1.15	-0.45	
16,990.00	90.44	179.12	7,530.81	-7,917.80	287.78	7,919.41	2.17	1.59	-1.47	
17,085.00	89.58	178.84	7,530.79	-8,012.78	289.47	8,014.40	0.95	-0.91	-0.29	
17,180.00	89.84	179.52	7,531.27	-8,107.77	290.83	8,109.40	0.77	0.27	0.72	
17,275.00	88.01	176.48	7,533.05	-8,202.68	294.14	8,204.32	3.73	-1.93	-3.20	
17,370.00	87.40	176.83	7,536.86	-8,297.44	299.68	8,299.12	0.74	-0.64	0.37	
17,466.00	87.99	178.39	7,540.72	-8,393.28	303.68	8,394.98	1.74	0.61	1.63	
17,561.00	88.78	178.52	7,543.40	-8,488.20	306.24	8,489.92	0.84	0.83	0.14	
17,657.00	90.58	178.64	7,543.93	-8,584.17	308.62	8,585.90	1.88	1.88	0.13	
17,752.00	90.72	178.30	7,542.86	-8,679.13	311.16	8,680.87	0.39	0.15	-0.36	
17,847.00	91.16	178.77	7,541.30	-8,774.09	313.59	8,775.84	0.68	0.46	0.49	
17,942.00	91.09	177.73	7,539.43	-8,869.02	316.49	8,870.79	1.10	-0.07	-1.09	
18,038.00	91.84	178.01	7,536.98	-8,964.92	320.05	8,966.71	0.83	0.78	0.29	
18,133.00	91.92	178.14	7,533.86	-9,059.82	323.24	9,061.62	0.16	0.08	0.14	
18,228.00	92.43	177.65	7,530.26	-9,154.69	326.73	9,156.51	0.74	0.54	-0.52	
18,320.00	93.15	177.37	7,525.78	-9,246.49	330.72	9,248.34	0.84	0.78	-0.30	
Last MWD Survey @ 18320' MD										
18,387.00	93.15	177.37	7,522.10	-9,313.32	333.79	9,315.18	0.00	0.00	0.00	
Projection to TD @ 18387' MD 90.5' FSL/ 1312.5' FWL										

Design Targets										
Target Name	Dip Angle (°)	Dip Dir. (°)	TVD (usft)	+N/-S (usft)	+E/-W (usft)	Northing (usft)	Easting (usft)	Latitude	Longitude	
30° Inclination @ 7476.2	0.00	0.00	7,226.73	1,472.58	233.78	1,599,471.54	3,297,110.27	40.973961	-104.424081	
- actual wellpath misses target center by 0.01usft at 7476.25usft MD (7226.73 TVD, 1472.58 N, 233.79 E)										
- Point										
Cross @ 7894.89' MD	0.00	0.00	7,505.88	1,169.00	231.22	1,599,167.96	3,297,111.39	40.973127	-104.424090	
- actual wellpath hits target center										
- Point										
70° Inclination @ 7920.1	0.00	0.00	7,515.18	1,145.58	231.60	1,599,144.54	3,297,112.06	40.973063	-104.424089	
- actual wellpath hits target center										
- Point										
Cross @ 13166.72' MD	0.00	0.00	7,532.66	-4,096.00	293.04	1,593,904.09	3,297,237.04	40.958677	-104.423866	
- actual wellpath hits target center										
- Point										

Survey Report

Company:	HighPoint Resources	Local Co-ordinate Reference:	Well Fox Creek 34-0263B
Project:	Weld County, CO (NAD83)	TVD Reference:	KB @ 5470.80usft (Savanna 802)
Site:	Sec 34-T12N-R63W	MD Reference:	KB @ 5470.80usft (Savanna 802)
Well:	Fox Creek 34-0263B	North Reference:	True
Wellbore:	Wellbore #1	Survey Calculation Method:	Minimum Curvature
Design:	Wellbore #1	Database:	EDM 5000.15 Single User Db

Design Annotations

Measured Depth (usft)	Vertical Depth (usft)	Local Coordinates		Comment
		+N/-S (usft)	+E/-W (usft)	
1,493.00	1,489.83	77.62	24.65	Tie into Surface Surveys
1,579.00	1,575.30	86.96	26.20	First MWD Survey @ 1579' MD
7,476.25	7,226.73	1,472.58	233.79	30° Inclination @ 7476.25' MD
7,894.89	7,505.88	1,169.00	231.22	Cross @ 7894.89' MD
7,920.10	7,515.18	1,145.58	231.60	70° Inclination @ 7920.1' MD
13,166.72	7,532.66	-4,096.00	293.04	Cross @ 13166.72' MD
18,320.00	7,525.78	-9,246.49	330.72	Last MWD Survey @ 18320' MD
18,387.00	7,522.10	-9,313.32	333.79	Projection to TD @ 18387' MD 90.5' FSL/ 1312.5' FWL

Checked By: _____ Approved By: _____ Date: _____