



FORM F-106



00247105

RECEIVED

JUL 18 1979

COLO. OIL & GAS CONS. COMM.

R. 52W

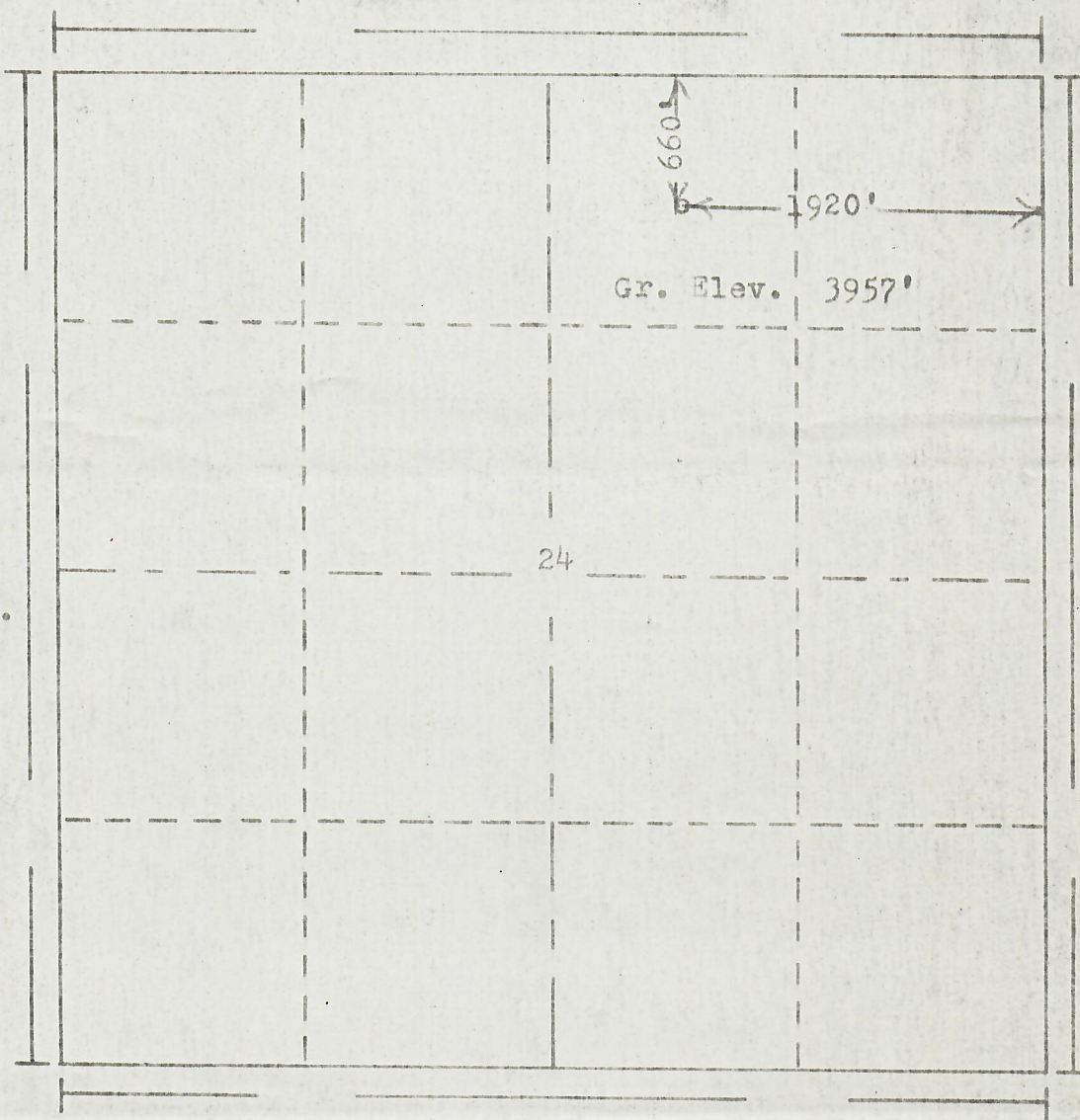

T. 8N

Scale... 1" = 1000'

Powers Elevation Company, Inc. of Denver, Colorado
has in accordance with a request from Mr. Brown
for Romac (Bob Roehrs)

determined the location of No. 24-1 Roehrs-State
to be 660' FN & 1920' EE Section 24 Township 8N
Range 52W of the 6th Principal Meridian
Logan County, Colorado

I hereby certify that this plat is an
accurate representation of a correct
survey showing the location of

Date: 7-3-79

Bob Roehrs
Licensed Land Surveyor No. 2853
State of Colorado