

**RECEIVED**  
DEC 16 1986

CHANDLER & ASSOCIATES INC.

CRAIG STATE #7-16

PROPOSED LOCATION

COLORADO OIL & GAS CONS. COMM.

TOPO.

MAP "A"

SCALE 1" = 4 MI.

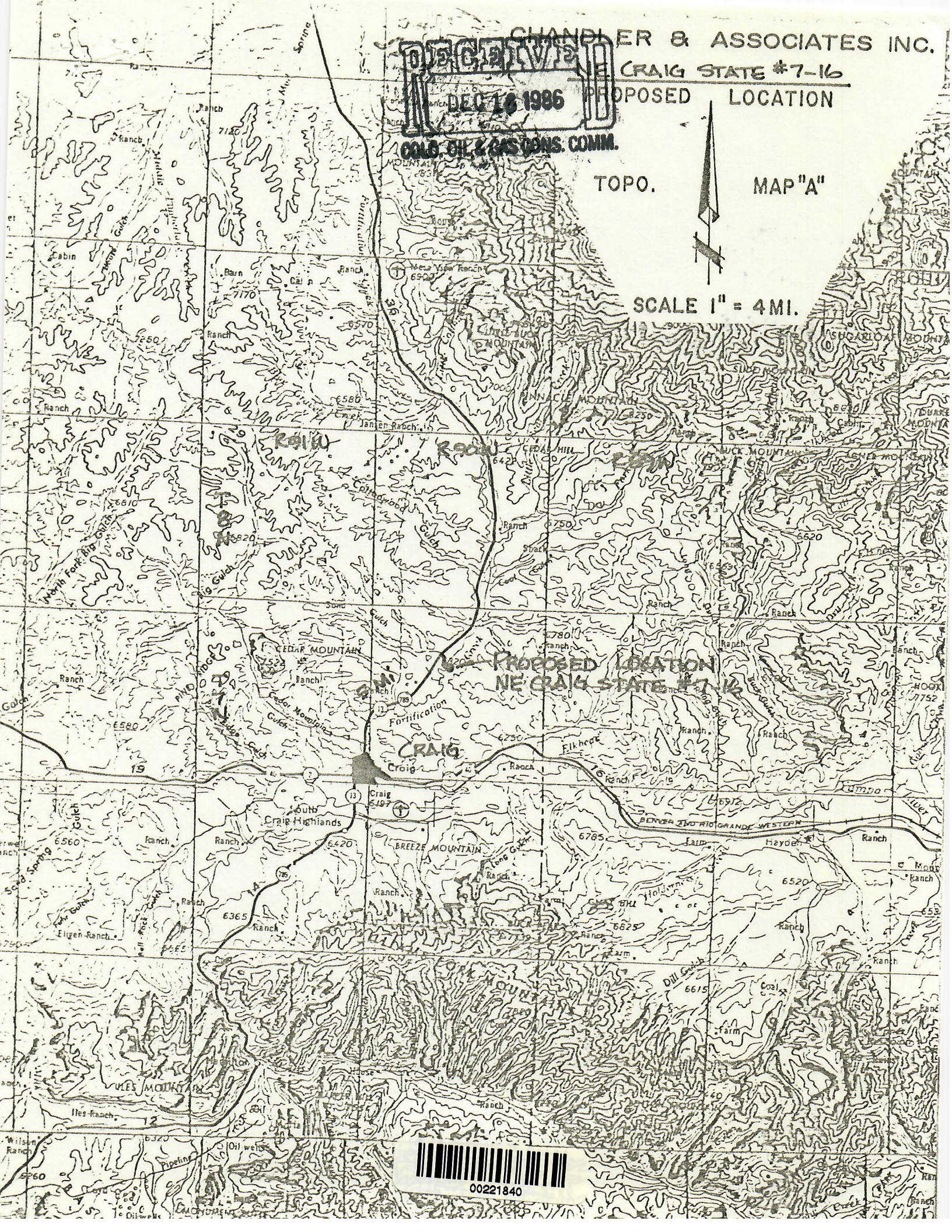



CHANDLER & ASSOCIATES INC.

NE CRAIG STATE #7-16

PROPOSED LOCATION

TOPO.

MAP "B"

RECEIVED  
DEC 16 1986

COLO. OIL & GAS CONS. COMM.

SCALE 1" = 2000'

ROAD CLASSIFICATION

Light duty road, all weather, improved surface      Unimproved road fair or dry weather

