

RECEIVED

SEP 12 1985

COLO. OIL & GAS CONS. COMM.

T 7 N, R 91 W, 6th P.M.

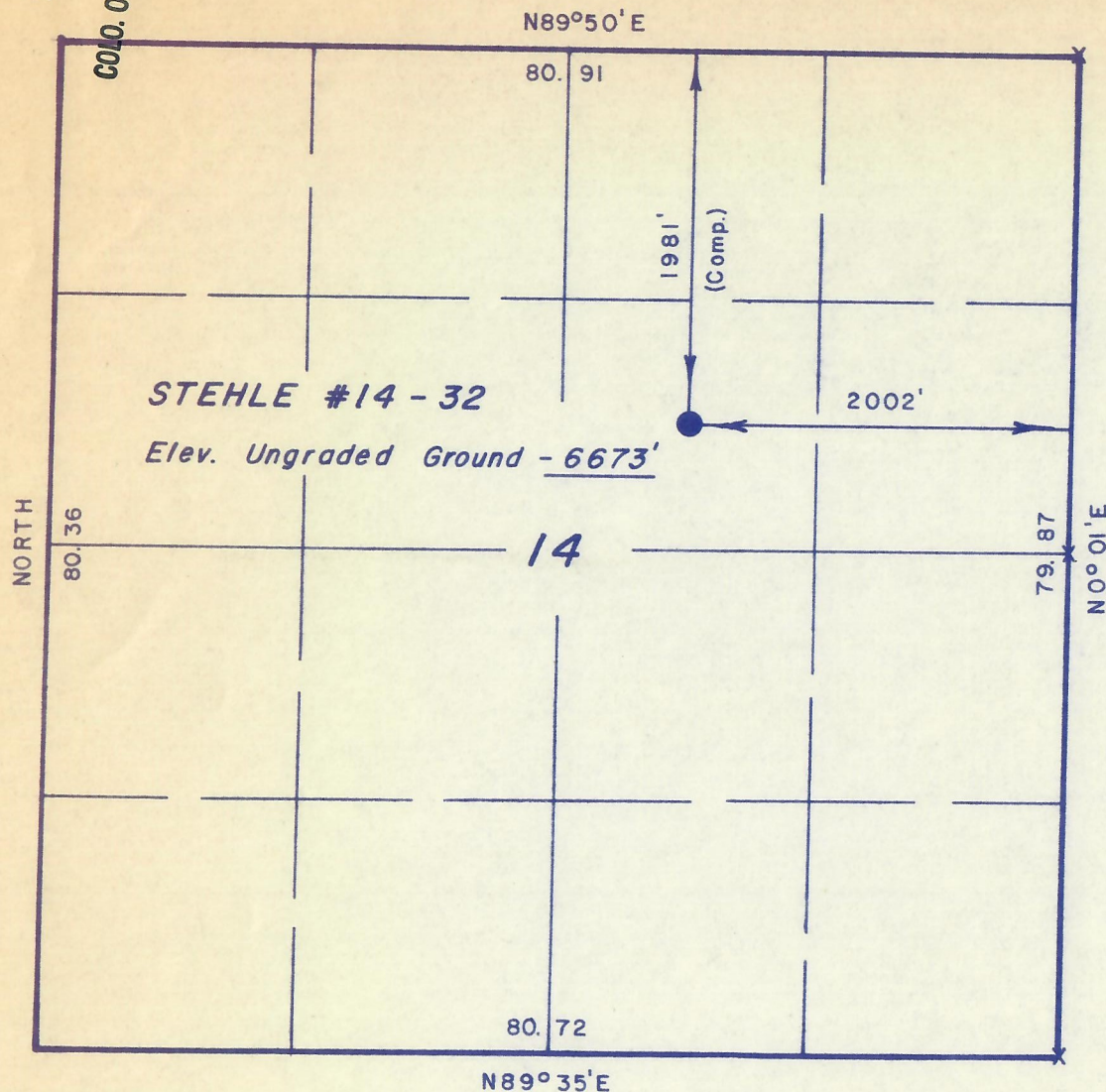

X = Section Corners Located

PROJECT

BWAB INCORPORATED

Well location, STEHLER #14-32,
located as shown in the SW 1/4
NE 1/4 Section 14, T7N, R91W, 6th P.M.
Moffat County, Colorado.



CERTIFICATE

THIS IS TO CERTIFY THAT THE ABOVE PLAT WAS PREPARED FROM
FIELD NOTES OF ACTUAL SURVEYS MADE BY ME OR UNDER MY
SUPERVISION AND THAT THE SAME ARE TRUE AND CORRECT TO THE
BEST OF MY KNOWLEDGE AND BELIEF.

Lawrence E. Kay
REGISTERED LAND SURVEYOR
REGISTRATION NO 9019
STATE OF COLORADO

UINTAH ENGINEERING & LAND SURVEYING
P.O. BOX Q - 85 SOUTH - 200 EAST
VERNAL, UTAH - 84078

SCALE	1" = 1000'	DATE	9/10/85
PARTY	L.D.T. S.S. H.M. S.B.	REFERENCES	GLO Plat
WEATHER	Fair	FILE	BWAB Incorporated