



EXHIBIT(s)
FOR
ORDER NO(s).

527 - 3

1. **Introduction**
 2. **Background**
 3. **Methodology**
 4. **Results**
 5. **Discussion**
 6. **Conclusion**
 7. **References**
 8. **Appendix**
 9. **Index**
 10. **Table of Contents**
 11. **Figure 1**
 12. **Figure 2**
 13. **Figure 3**
 14. **Figure 4**
 15. **Figure 5**
 16. **Figure 6**
 17. **Figure 7**
 18. **Figure 8**
 19. **Figure 9**
 20. **Figure 10**
 21. **Figure 11**
 22. **Figure 12**
 23. **Figure 13**
 24. **Figure 14**
 25. **Figure 15**
 26. **Figure 16**
 27. **Figure 17**
 28. **Figure 18**
 29. **Figure 19**
 30. **Figure 20**
 31. **Figure 21**
 32. **Figure 22**
 33. **Figure 23**
 34. **Figure 24**
 35. **Figure 25**
 36. **Figure 26**
 37. **Figure 27**
 38. **Figure 28**
 39. **Figure 29**
 40. **Figure 30**
 41. **Figure 31**
 42. **Figure 32**
 43. **Figure 33**
 44. **Figure 34**
 45. **Figure 35**
 46. **Figure 36**
 47. **Figure 37**
 48. **Figure 38**
 49. **Figure 39**
 50. **Figure 40**
 51. **Figure 41**
 52. **Figure 42**
 53. **Figure 43**
 54. **Figure 44**
 55. **Figure 45**
 56. **Figure 46**
 57. **Figure 47**
 58. **Figure 48**
 59. **Figure 49**
 60. **Figure 50**
 61. **Figure 51**
 62. **Figure 52**
 63. **Figure 53**
 64. **Figure 54**
 65. **Figure 55**
 66. **Figure 56**
 67. **Figure 57**
 68. **Figure 58**
 69. **Figure 59**
 70. **Figure 60**
 71. **Figure 61**
 72. **Figure 62**
 73. **Figure 63**
 74. **Figure 64**
 75. **Figure 65**
 76. **Figure 66**
 77. **Figure 67**
 78. **Figure 68**
 79. **Figure 69**
 80. **Figure 70**
 81. **Figure 71**
 82. **Figure 72**
 83. **Figure 73**
 84. **Figure 74**
 85. **Figure 75**
 86. **Figure 76**
 87. **Figure 77**
 88. **Figure 78**
 89. **Figure 79**
 90. **Figure 80**
 91. **Figure 81**
 92. **Figure 82**
 93. **Figure 83**
 94. **Figure 84**
 95. **Figure 85**
 96. **Figure 86**
 97. **Figure 87**
 98. **Figure 88**
 99. **Figure 89**
 100. **Figure 90**
 101. **Figure 91**
 102. **Figure 92**
 103. **Figure 93**
 104. **Figure 94**
 105. **Figure 95**
 106. **Figure 96**
 107. **Figure 97**
 108. **Figure 98**
 109. **Figure 99**
 110. **Figure 100**
 111. **Figure 101**
 112. **Figure 102**
 113. **Figure 103**
 114. **Figure 104**
 115. **Figure 105**
 116. **Figure 106**
 117. **Figure 107**
 118. **Figure 108**
 119. **Figure 109**
 120. **Figure 110**
 121. **Figure 111**
 122. **Figure 112**
 123. **Figure 113**
 124. **Figure 114**
 125. **Figure 115**
 126. **Figure 116**
 127. **Figure 117**
 128. **Figure 118**
 129. **Figure 119**
 130. **Figure 120**
 131. **Figure 121**
 132. **Figure 122**
 133. **Figure 123**
 134. **Figure 124**
 135. **Figure 125**
 136. **Figure 126**
 137. **Figure 127**
 138. **Figure 128**
 139. **Figure 129**
 140. **Figure 130**
 141. **Figure 131**
 142. **Figure 132**
 143. **Figure 133**
 144. **Figure 134**
 145. **Figure 135**
 146. **Figure 136**
 147. **Figure 137**
 148. **Figure 138**
 149. **Figure 139**
 150. **Figure 140**
 151. **Figure 141**
 152. **Figure 142**
 153. **Figure 143**
 154. **Figure 144**
 155. **Figure 145**
 156. **Figure 146**
 157. **Figure 147**
 158. **Figure 148**
 159. **Figure 149**
 160. **Figure 150**
 161. **Figure 151**
 162. **Figure 152**
 163. **Figure 153**
 164. **Figure 154**
 165. **Figure 155**
 166. **Figure 156**
 167. **Figure 157**
 168. **Figure 158**
 169. **Figure 159**
 170. **Figure 160**
 171. **Figure 161**
 172. **Figure 162**
 173. **Figure 163**
 174. **Figure 164**
 175. **Figure 165**
 176. **Figure 166**
 177. **Figure 167**
 178. **Figure 168**
 179. **Figure 169**
 180. **Figure 170**
 181. **Figure 171**
 182. **Figure 172**
 183. **Figure 173**
 184. **Figure 174**
 185. **Figure 175**
 186. **Figure 176**
 187. **Figure 177**
 188. **Figure 178**
 189. **Figure 179**
 190. **Figure 180**
 191. **Figure 181**
 192. **Figure 182**
 193. **Figure 183**
 194. **Figure 184**
 195. **Figure 185**
 196. **Figure 186**
 197. **Figure 187**
 198. **Figure 188**
 199. **Figure 189**
 200. **Figure 190**
 201. **Figure 191**
 202. **Figure 192**
 203. **Figure 193**
 204. **Figure 194**
 205. **Figure 195**
 206. **Figure 196**
 207. **Figure 197**
 208. **Figure 198**
 209. **Figure 199**
 210. **Figure 200**
 211. **Figure 201**
 212. **Figure 202**
 213. **Figure 203**
 214. **Figure 204**
 215. **Figure 205**
 216. **Figure 206**
 217. **Figure 207**
 218

STATE OF COLORADO

CITY AND COUNTY OF DENVER

)
) ss
)

RECEIVED

MAR 16 07

VERIFIED STATEMENT OF BILL R. MOOMEY

In support of the request for Director approval of the Verified Application of Whiting Petroleum Corporation in Cause No. 527, Docket No 0703-AW-07, pursuant to Rule 511 b, Bill R Moomey, Regional Landman of Whiting Petroleum Corporation, upon oath, deposes and states as follows

I am currently employed as a Regional Landman of Whiting Petroleum Corporation I have been and am presently responsible for and have knowledge of the land position related to the Application Lands

- a I have testified previously as an expert witness in petroleum land matters before the COGCC and before Hearing Officers of the COGCC Attached as Exhibit L-1 is a copy of my resume prepared by me Also attached is Exhibit L-2 which was prepared by me or under my direction and control I have reviewed the exhibit, and to the best of my knowledge and belief, the exhibit is correct and accurate as of the date of this Verified Statement
- b Under the Commission's Order 527-1 and Order No 527-2 in Cause 527, certain lands were approved by the Commission for one (1) well per 10 acres for the production of gas and associated hydrocarbons from the Williams Fork Formation and Iles Formation respectively The lands approved under those applications border the Application Lands and the evidence used to support those Applications (including pressure data evidence) is requested to be adopted for purposes of supporting Whiting's application in Docket 0703-AW-07
- c Exhibit L-2 indicates the location of the Application Lands and the lands that were approved under the Commission's Order No 572-2 in Cause 527 Whiting acquired the right to acquire a leasehold interest in the Application Lands after such order had already been entered Otherwise Whiting would have requested that the Application Lands be included under that order

By

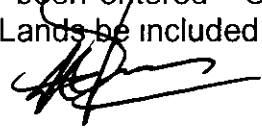
Bill R Moomey

Subscribed and sworn to before me this 16th day of March, 2007 by Bill R Moomey, Regional Landman of Whiting Petroleum Corporation

Witness my hand and official seal



My

commission

expires

11/9/09

Notary Public

EXHIBIT L-1

BILL R. MOOMEY

15983 Loyola Dr • Aurora, Colorado 80013 • (303) 390-4261 W • billm@whiting.com
(303) 690-7478 H

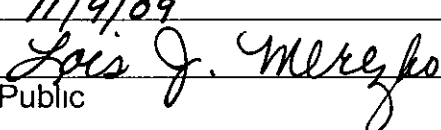
PROFESSIONAL EXPERIENCE

WHITING PETROLEUM CORP , DENVER CO

(April, 2005 - Present) Regional Landman, Central Rockies
Responsible for all land related activities for the States of Colorado, Wyoming, Utah, Western Montana and California Supervise one other landman

INDEPENDENT PETROLEUM LANDMAN, DENVER, CO

(October, 1986 -April, 2005)
Worked with various independent geologists and geophysics putting together geological prospects for drilling by third parties Did land consulting work with various companies as time permitted

CENTURY OIL & GAS CORPORATION, DENVER, CO,

(October, 1981 - January, 1986) Vice President, Land
Was responsible for all land activities for the company to include the lease records department Supervised one landman and three lease records personnel

MARATHON OIL COMPANY CASPER, WY

(April, 1974- October, 1981) Various Land Assignments
(Sept , 1980 - Oct , 1981) - Responsible for office in Denver, Colo to represent Marathon Oil Co to the industry in the Denver area
(Aug , 1979 - Sept , 1980) - Team Leader for the Green River Basin area Supervised Two geologists, one geophysics and one landman
(Apr , 1974 -Aug , 1979 - Senior Landman responsible for general land work for areas assigned to include oil and gas leasing, contract administration, etc

MARATHON OIL COMPANY, GRAND RAPIDS, MICH

(February, 1969 - April, 1974) Sales Representative, Retail Marketing Department Responsible for service stations, bulk plants and company jobbers for the western most part of the State of Michigan Office was out of my home in the Grand Rapids, Michigan Area with supervisor located in Lansing, Michigan

EDUCATION

1968 Central Michigan University - B S B A
1979 Marathon Oil Company Management Practices Program

ORGANIZATIONS

American Association of Professional Landmen
Denver Association of Petroleum Landmen
Wyoming Association of Professional Landmen
Landman's Association of North Dakota

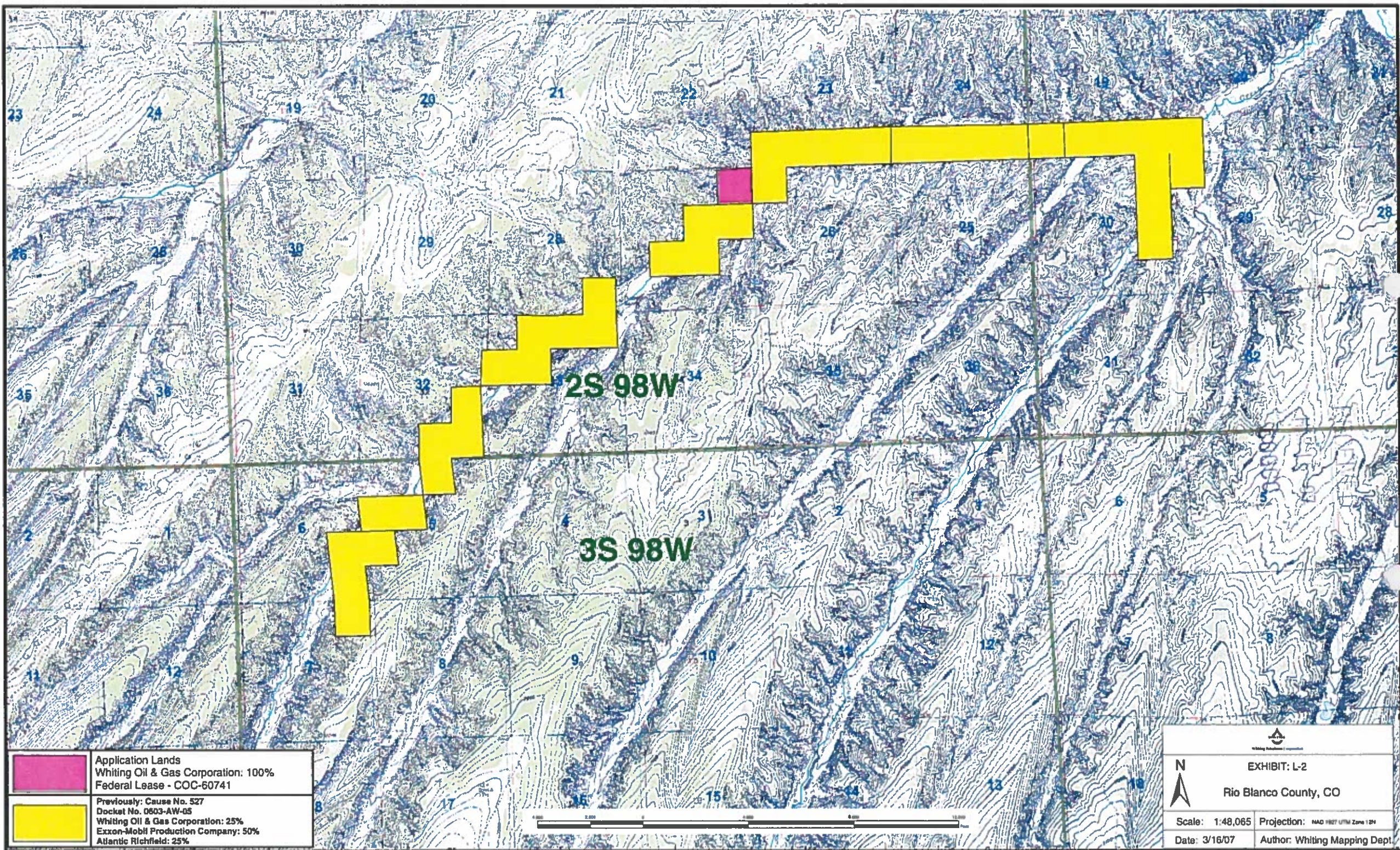

	Application Lands Whiting Oil & Gas Corporation: 100% Federal Lease - COC-60741
	Previously: Cause No. 527 Docket No. 0603-AW-05 Whiting Oil & Gas Corporation: 25% Exxon-Mobil Production Company: 50% Atlantic Richfield: 25%

 Whiting Petroleum Corporation	
EXHIBIT: L-2	
Rio Blanco County, CO	
Scale: 1:48,065	Projection: NAD 1983 UTM Zone 12N
Date: 3/16/07	Author: Whiting Mapping Dept.