

# LEGEND:

- = PROPOSED WELLHEAD.
- ◆ = TOP OF GAS INTERVAL.
- = TARGET BOTTOM HOLE.
- ▲ = SECTION CORNERS LOCATED. (NAD 83)

T4S, R96W, 6th P.M.

## LINE TABLE

LINE	DIRECTION	LENGTH
L1	S59°59'40"W	38.63'

## Basis of Bearing

S89°47'19"W - 2644.03' (Meas.)

N89°04'55"W - 2454.10' (Meas.)

1953 Brass Cap,  
1.0' High  
Lat: 39.709730°  
Long: 108.126464°

1953 Brass Cap,  
0.5' High, Pile of  
Stones  
Lat: 39.702535°  
Long: 108.126456°

1953 Brass Cap,  
1.0' High, Pile of  
Stones  
Lat: 39.702393°  
Long: 108.126456°

1978 Brass Cap,  
0.5' High  
Lat: 39.698938°  
Long: 108.126441°

1953 Brass Cap,  
0.6' High, Pile of  
Stones  
Lat: 39.695347°  
Long: 108.126444°

NW Cor. Sec. 24  
1953 Brass Cap,  
0.2' High, Pile of  
Stones, Steel Post  
Lat: 39.695158°  
Long: 108.126422°

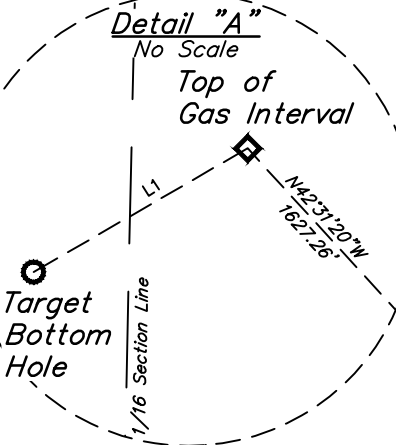

1971 Brass Cap,  
0.4' High  
Lat: 39.702539°  
Long: 108.145062°

See Detail "A"  
@ Right

ELU J14 FED 13A-14-496  
Elev. Ungraded Ground = 7912.5'

S89°52'45"W  
1319.36' (Meas.)

S89°49'31"W  
1320.71' (Meas.)

1978 Brass Cap,  
0.3' High, Pile of  
Stones  
Lat: 39.698937°  
Long: 108.135820°

1978 Brass Cap,  
0.5' High, Pile of  
Stones  
Lat: 39.698936°  
Long: 108.131133°

1953 Brass Cap,  
1.1' High, Small  
Pile of Stones  
Lat: 39.695337°  
Long: 108.131125°

GARFIELD CO.

## NOTE:

- Distances referenced on plat to section lines are perpendicular.

## CERTIFICATE

THIS IS TO CERTIFY THAT THE ABOVE PLAT WAS PREPARED FROM FIELD NOTES OF ACTUAL SURVEYS MADE BY ME OR UNDER MY SUPERVISION AND THAT THE LOCATION HAS BEEN STAKED ON THE GROUND AS SHOWN ON THE PLAT AND THAT THE SAME ARE TRUE AND CORRECT TO THE BEST OF MY KNOWLEDGE AND BELIEF.

REGISTERED LAND SURVEYOR  
REGISTRATION NO. 12004-19  
STATE OF COLORADO

PDOP = 1.4

REV: 3 12-04-19 M.D. (TGI AND BHL MOVE)

## BASIS OF BEARINGS

BEARINGS ARE BASED ON THE ASSUMPTION THAT THE NORTH LINE OF THE NORTHEAST 1/4 OF SECTION 14 BEARS S89°47'19"W. MONUMENTS DESCRIBED HEREON.

## BASIS OF ELEVATION

BENCH MARK (H79) LOCATED IN THE NE 1/4 OF SECTION 35, T4S, R96W, 6th P.M., TAKEN FROM THE BULL FORK QUADRANGLE, COLORADO, 7.5 MINUTE SERIES. (TOPOGRAPHIC MAP) PUBLISHED BY THE UNITED STATES DEPARTMENT OF THE INTERIOR, GEOLOGICAL SURVEY. SAID ELEVATION IS MARKED AS BEING 8535 FEET.

## UELS, LLC

Corporate Office \* 85 South 200 East  
Vernal, UT 84078 \* (435) 789-1017



SURVEYED BY	DENNIS PETTY, J.L.	12-20-18	SCALE
DRAWN BY	M.D.	02-15-19	1" = 1000'

## WELL LOCATION PLAT