

# KOLOA PAD HYDROLOGY MAP

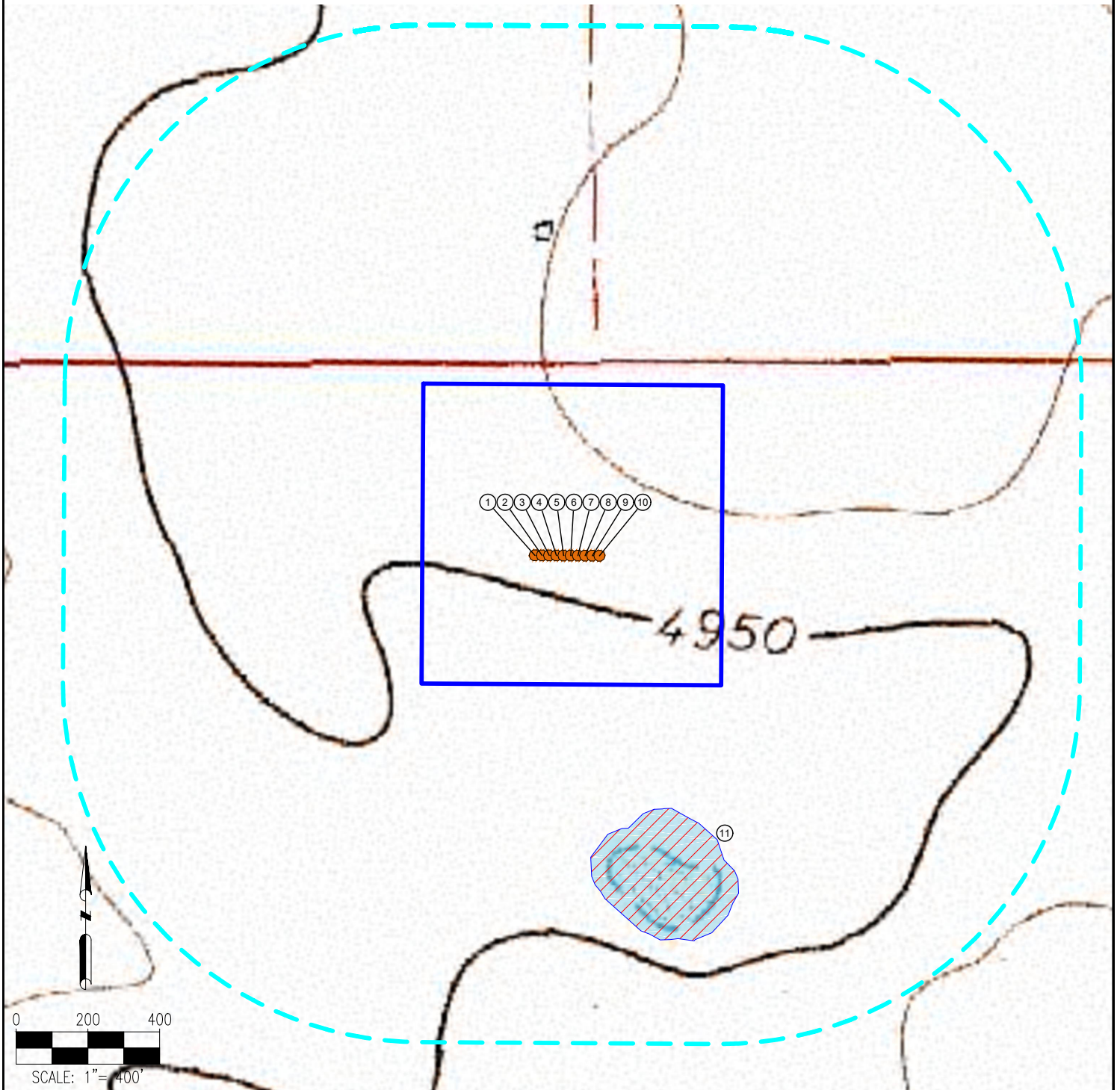

MEASUREMENTS ARE MADE FROM THE NEAREST EDGE OF THE DISTURBANCE AREA.

- |                    |   |
|--------------------|---|
| 1. KL-1            | 8. KOLOA 15-22-7HN                              |
| 2. KOLOA 15-22-1HC | 9. KOLOA 15-22-8HN                              |
| 3. KOLOA 15-22-2HN | 10. KL-2  |
| 4. KOLOA 15-22-3HN | 11. FRESHWATER EMERGENT WETLAND IS $\pm 344'$ S |
| 5. KOLOA 15-22-4HN |   |
| 6. KOLOA 15-22-5HN |   |
| 7. KOLOA 15-22-6HC |   |

NOTE:  
 \*The mapped Freshwater Emergent Wetland is a low-lying area per field verification.\*  
 \*This locatin is in the Upper Crow Creek designated ground water basin.\*

## LEGEND:

- = PROPOSED WELL
- = 1000' RADIUS
- = PROPOSED DISTURBANCE AREA
- = FRESHWATER EMERGENT WETLAND

DISCLAIMER:  
 THIS PLOT DOES NOT REPRESENT A MONUMENTED LAND SURVEY AND SHOULD NOT BE RELIED UPON TO DETERMINE BOUNDARY LINES, PROPERTY OWNERSHIP OR OTHER PROPERTY INTERESTS. PARCEL LINES, IF DEPICTED HAVE NOT BEEN FIELD VERIFIED AND MAY BE BASED UPON PUBLICLY AVAILABLE DATA THAT ALSO HAS NOT BEEN INDEPENDENTLY VERIFIED.

DATA SOURCE:  
 TOPO MAP: USGS  
 NHD: USGS  
 PUBLICLY AVAILABLE DATA SOURCES HAVE NOT BEEN INDEPENDENTLY VERIFIED BY ASCENT.



FIELD DATE: 08-06-19	
DRAWING DATE: 12-09-19	
BY: JAG	CHECKED: IJM

SITE NAME: KOLOA PAD
SURFACE LOCATION: NE 1/4 NW 1/4 SEC. 15, T8N, R61W, 6TH P.M. WELD COUNTY, COLORADO

PREPARED FOR:

