



FORM F-106



00238484

RECEIVED

JUN 18 1979

COLO. OIL & GAS CONS. COMM.

R. 53W

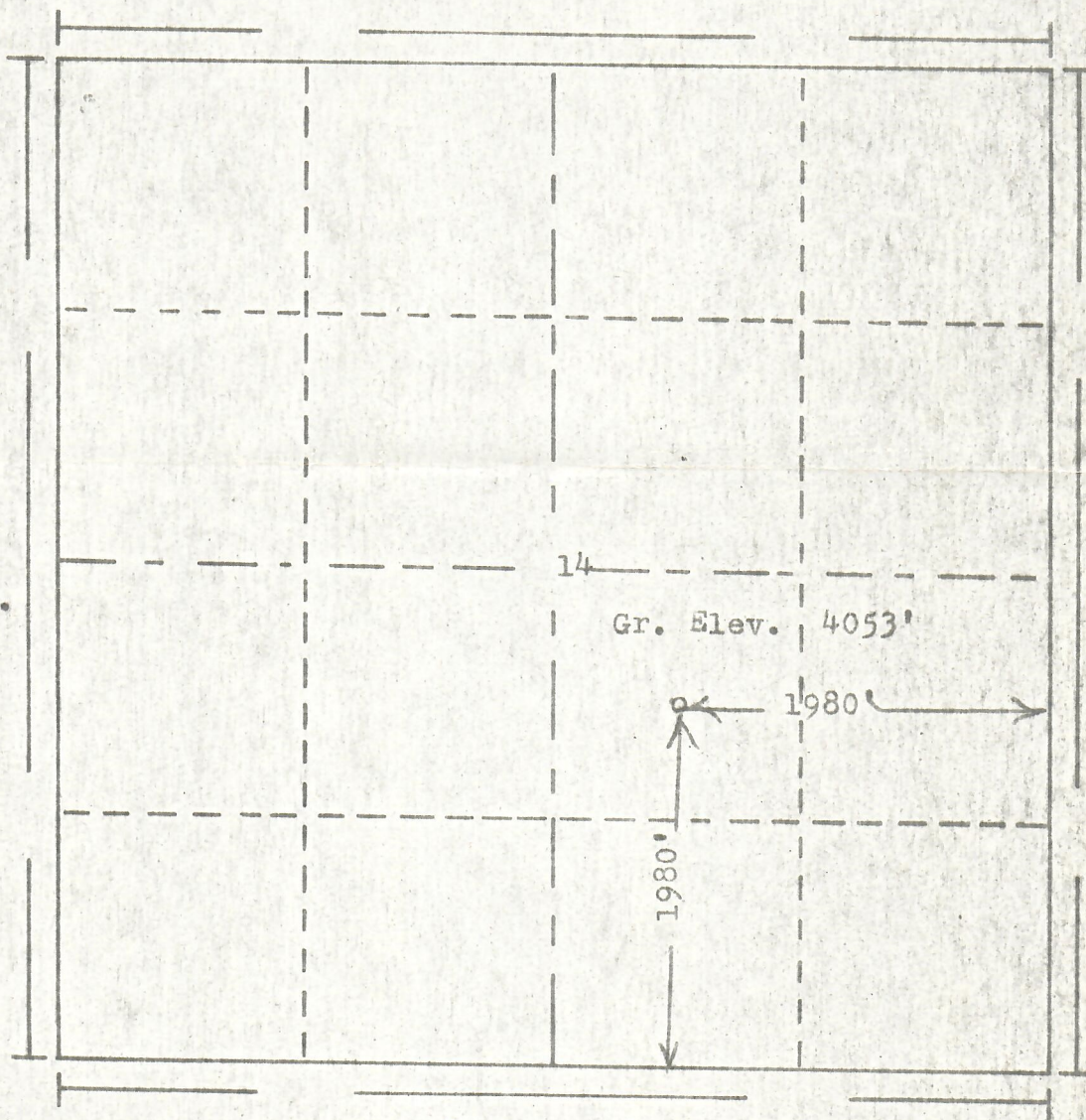

Scale... 1" = 1000'

Powers Elevation Company, Inc. of Denver, Colorado
has in accordance with a request from Mr. Arnum
for Tipperary Corp. & Exeter Drlg. & Exploration Co.
determined the location of No.1 Crosssant
to be CNW SE
Range 53W of the 6th Principal Meridian
Logan County, Colorado

I hereby certify that this plat is an
accurate representation of a correct
survey showing the location of

Date: 6-5-79

Ray J. Hollen
Licensed Land Surveyor No. 2853
State of Colorado