



00225909

05 123 14673

VERBAL REQUEST

NOTICE OF INTENT TO DRILL \_\_\_\_\_

NOTICE OF INTENT TO ABANDON ☒ Revised

OTHER \_\_\_\_\_

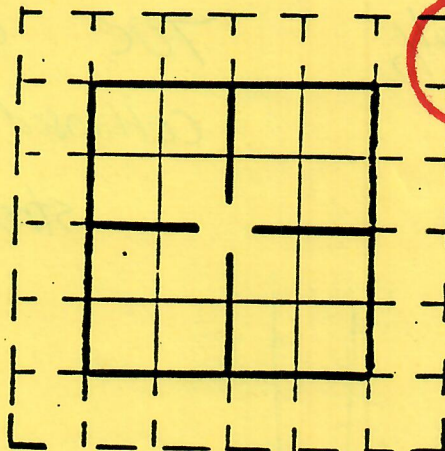
COMPANY Fina Oil & Chem. ADDRESS \_\_\_\_\_BY Jim Periman PHONE NO. \_\_\_\_\_ EXT. \_\_\_\_\_WELL NO. 11-7 LEASE ROTHCOUNTY Weld FIELD Caretaker DRLG UNIT \_\_\_\_\_LOCATION NE SW SEC 7 TWP 7N RNGE 59W MERIDIAN \_\_\_\_\_

\_\_\_\_\_ ft. from N or S Sec. Line, and \_\_\_\_\_ ft. from E or W Sec. Line

ESTIMATED DATE OF WORK 8/16/90 ESTIMATED TIME \_\_\_\_\_DETAILS OF PLAN OF WORK: T.D. 6800 FORMATION JsdSURFACE CASING 898 @ 315 Water sand 347-3904 1/2 to TDPorted, Collapsed csq. @ 6128, TOC @ 6178Top Niobrara @ 6100' - cant get tools past 6128Back off pipe Squeeze 50' sacks at csq partBack off pipe at min. 400', set cement plug  
from 400' up into surface. 5 sack sfc plug, cut & weld.

BONDING STATUS: PLUGGING \_\_\_\_\_ SURFACE \_\_\_\_\_ OTHER \_\_\_\_\_

Is surface owner also mineral owner? \_\_\_\_\_

ACREAGE LEASED SURROUNDING DRILLSITE \_\_\_\_\_

APPROVED BY: J. Periman DATE 8/16/90

4 1/2

TOC 6178

collapsed csq, parted 6128 - circulating  
stretch 880'

