

OIL AND GAS CONSERVATION COMMISSION
OF THE STATE OF COLORADO

00241497

CEIVED

OCT 25 1972

APPLICATION FOR PERMIT TO DRILL, DEEPEN, OR PLUG BACK

1a. TYPE OF WORK

DRILL ☒DEEPEN ☐PLUG BACK ☐

b. TYPE OF WELL

OIL
WELL ☒GAS
WELL ☐

OTHER

SINGLE
ZONE ☒MULTIPLE
ZONE ☐

2. NAME OF OPERATOR

Cardinal Petroleum Company

3. ADDRESS OF OPERATOR

Box 1077, Billings, Montana

4. LOCATION OF WELL (Report location clearly and in accordance with any State requirements.)

At surface

SE SW Sec. 1-9N-54W (1980' FWL & 660' FSL)

At proposed prod. zone

same

C. S. S. W.

14. DISTANCE IN MILES AND DIRECTION FROM NEAREST TOWN OR POST OFFICE

10 miles northwest of Sterling, Colo

15. DISTANCE FROM PROPOSED
LOCATION TO NEAREST
PROPERTY OR LEASE LINE, FT.
(Also to nearest drlg. line, if any)

1980'

16. NO. OF ACRES IN LEASE *

1280 gross

17. NO. OF ACRES ASSIGNED
TO THIS WELL

40

18. DISTANCE FROM PROPOSED LOCATION
TO NEAREST WELL, DRILLING, COMPLETED,
OR APPLIED FOR, ON THIS LEASE, FT.

1320'

19. PROPOSED DEPTH

5200'

20. ROTARY OR CABLE TOOLS

rotary

21. ELEVATIONS (Show whether DF, RT, GR, etc.)

4230' Gr.

22. APPROX. DATE WORK WILL START

October 28, 1972

PROPOSED CASING AND CEMENTING PROGRAM

SIZE OF HOLE	SIZE OF CASING	WEIGHT PER FOOT	SETTING DEPTH	QUANTITY OF CEMENT
12 1/4"	8-5/8"	24#	125'	100 sx
7-7/8"	5-1/2"	14 or 15.5#	TD	100 sx

* DESCRIBE LEASE

Various in Sec. 1 & 12-9N-54W
" Sec. 31-10N-53W
" Sec. 6-7 -9N-53W

Cardinal Petroleum Company proposes to drill a "J" sand test to 5200' + or -. Will run IES & porosity log. No cores planned. Will possibly run 2 drill stem tests. All potentially productive zones from surface to T.D. will be evaluated. If commercial production encountered, well will be completed in accordance with good oil and/or gas field practices & State Regulations. If dry, will plug & abandon in accordance with State Regulations.

SURVEY PLAT TO BE FORWARDED.

DVR	50.000
FJP	
NHM	
JAM	
JUD	10/25/72

IN ABOVE SPACE DESCRIBE PROPOSED PROGRAM: If proposal is to deepen or plug back, give data on present productive zone and proposed new productive zone. If proposal is to drill or deepen directionally, give pertinent data on subsurface locations and measured and true vertical depths. Give blowout preventer program, if any.

24.

SIGNED

T. A. Voorhees

TITLE

Executive Vice President

DATE

October 23, 1972

(This space for Federal or State office use)

PERMIT NO.

72 887

APPROVAL DATE

DIRECTOR

APPROVED BY

CONDITIONS OF APPROVAL, IF ANY:

TITLE

O & G CONS. COMM.

DATE

OCT 25 1972

A.P.I. NUMBER

05 075 8362

See Instructions On Reverse Side



FORM F-106

RECEIVED

OCT 25 1972

COLO. OIL & GAS COMS. COMM.

R. 54W

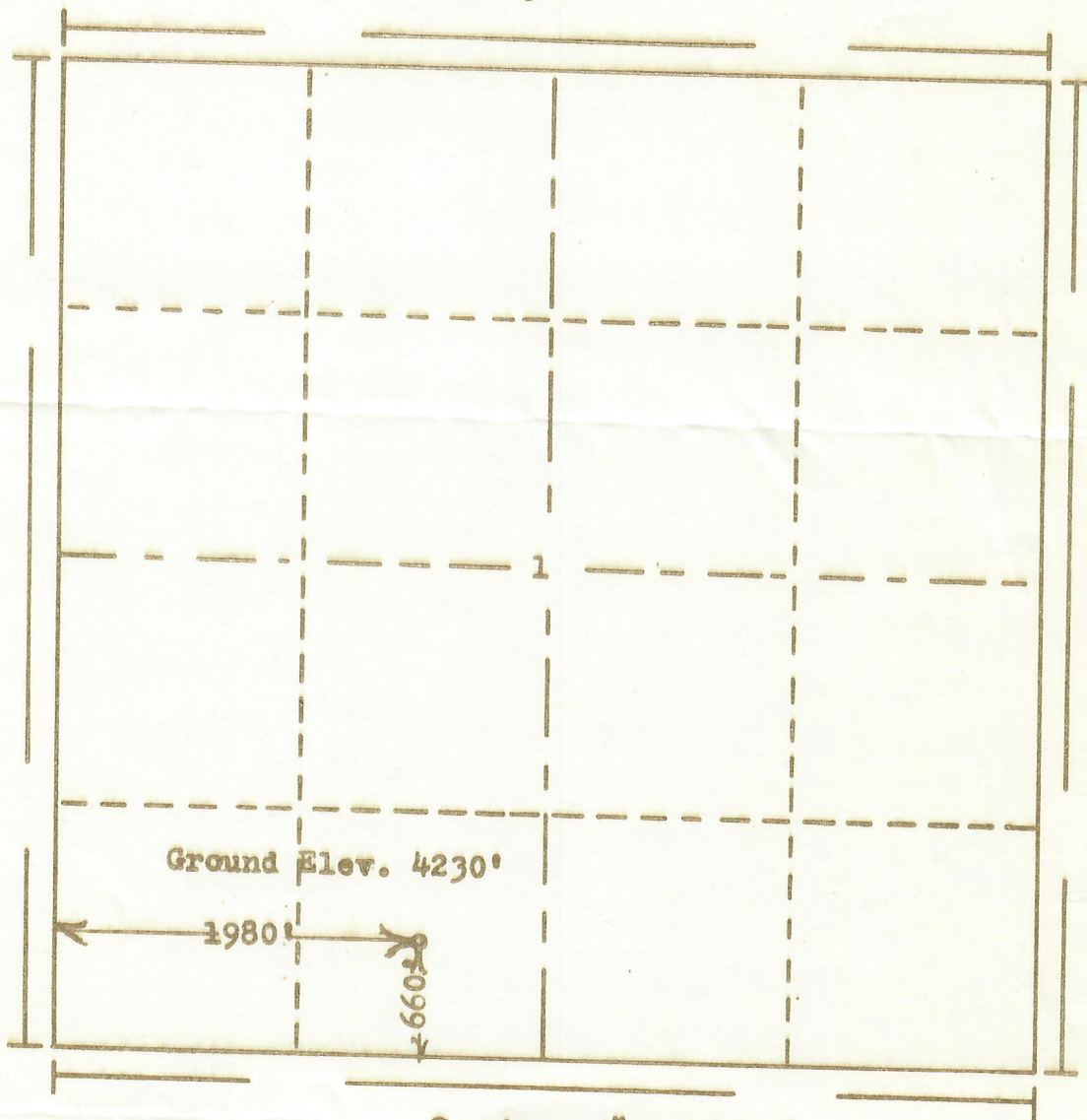

T. 9N

Scale... 1" = 1000'

Powers Elevation Company, Inc. of Denver, Colorado
has in accordance with a request from Mr. Swenson
for Cardinal Petroleum Co.

determined the location of No. 1 McRoberts et al
to be CSE SW Section 1 Township 9N
Range 54W of the 6th Principal Meridian
Logan County, Colorado

I hereby certify that this plat is an
accurate representation of a correct
survey showing the location of

Date: 10-20-72

Ree J. Hansen
Licensed Land Surveyor No. 2853
State of Colorado