



Lat40°, Inc. 6250 W. 10th Street, Unit 2, Greeley, CO 970-515-5294

HYDROLOGY MAP

GRAYS FEDERAL 5N65W27 1-10 PAD

SECTION: 27
TOWNSHIP: 5N
RANGE: 65W
6TH. P.M.
WELD COUNTY, CO

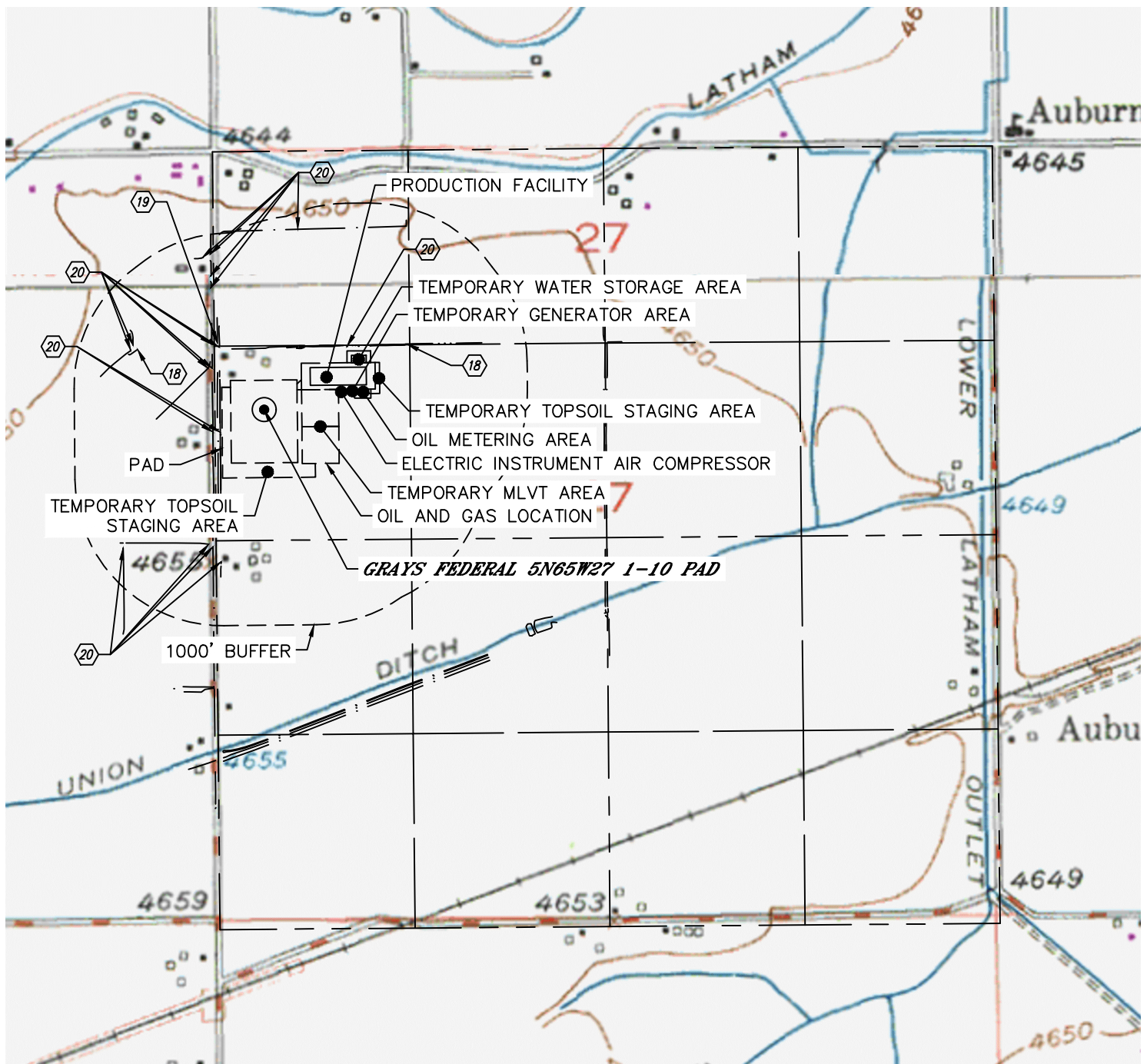

DISTANCES MEASURED FROM THE EDGE OF THE OIL AND GAS LOCATION.

- 18 LOW AREA 252' NE, 625' NW
- 19 BORROW DITCH 269' NW
- 20 DITCH 13' & 63' W, 31' & 828' N, 143', 156', 239', 277', 642', 665', 665', 722', 828', 853' & 867' NW, 459', 470', 567' & 823' SW

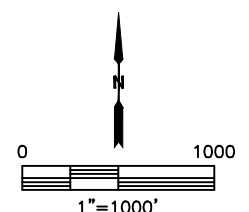

NEAREST DOWN GRADIENT SURFACE WATER: DITCH 13' W

DATE: 9/25/2019
PROJECT#: 2018091