



Mr. David Tewkesbury
Environmental Specialist
Crestone Peak Resources Operating LLC
10188 E. Interstate 25 Frontage Road
Firestone, CO 80504

October 1, 2019

**RE: Colorado Oil & Gas Conservation Commission (COGCC)
Vegetation Assessment Report (Final Reclamation Completion Notice)
Williams 18-16 (330432)
Crestone Peak Resources Operating LLC (Operator: 10633)**

Dear Mr. Tewkesbury:

Apex Companies, LLC (Apex) is presenting this letter to Crestone Peak Resources Operating LLC (Crestone) documenting the results of a vegetation assessment that demonstrates successful completion of final reclamation efforts, per COGCC Rule 1004, on the above-referenced location. Attached is a topographic location map and a site map with additional location information.

Site visits, project correspondence and documentation, and the completed vegetation assessment confirmed that the location has been final reclaimed and returned by the landowner to cropland and agricultural use, with no evidence of unrestored subsidence over two growing seasons. Based on the results of the survey, final reclamation, as defined by COGCC Rule 1004.a and 1003.e (1), has been achieved. Photographs required by COGCC Rule 1003.e (3) are attached, along with the site map that illustrates the photo points.

On June 13, 2019, the site was visited and four photographs documenting crop establishment throughout the location were taken, along with one photograph illustrating planted crops.

Apex appreciates the opportunity to provide environmental consulting services on this project. Should you have any questions or require additional information, please do not hesitate to contact me.

Sincerely,
Apex Companies, LLC

Adam Roll
Environmental Scientist
970-589-6111
adam.roll@apexcos.com

Attachments:

1. Topographic Location Map
2. Vegetation Survey Site Map
3. Vegetation Survey Photos



Topographic Location Map

Crestone Peak Resources Operating LLC
Williams 18-16 (330432)

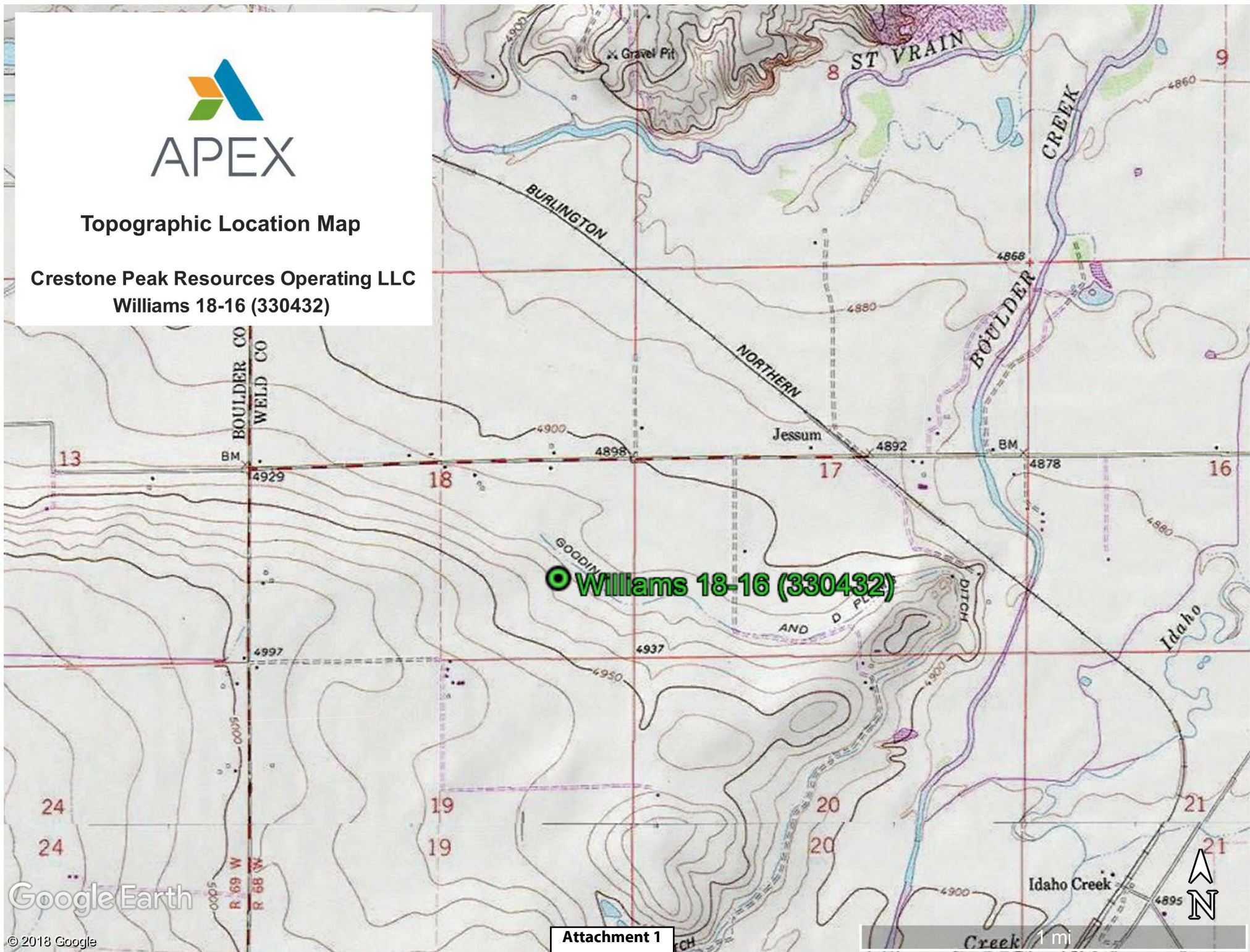

Google Earth

© 2013 Google

Attachment 1



Vegetation Survey Site Map

Crestone Peak Resources Operating LLC

**Williams 18-16
(330432)**

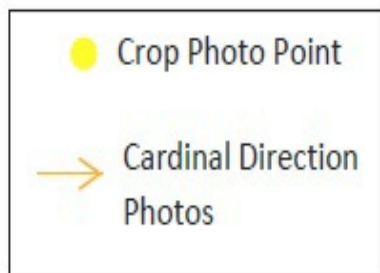

Legal Description: SESE, Sec. 18, T2N-R68W

Lat/Long: 40.13416/-105.04021

County: Weld

Land Use: Crop Land

Inspector: Adam Roll

Assessment Date: 6/13/2019

Aerial Imagery Date: 5/31/2018

**Please reference coordinate disclaimer on
the photo log pages.*



Vegetation Assessment Photo Log

Date Completed - 06/13/2019

Client - Crestone Peak Resources Operating LLC

Location Name (ID) - Williams 18-16 (330432)



Photo Point A: North of Disturbance - Facing South



Photo Point B: South of Disturbance - Facing North



Photo Point C: West of Disturbance - Facing East

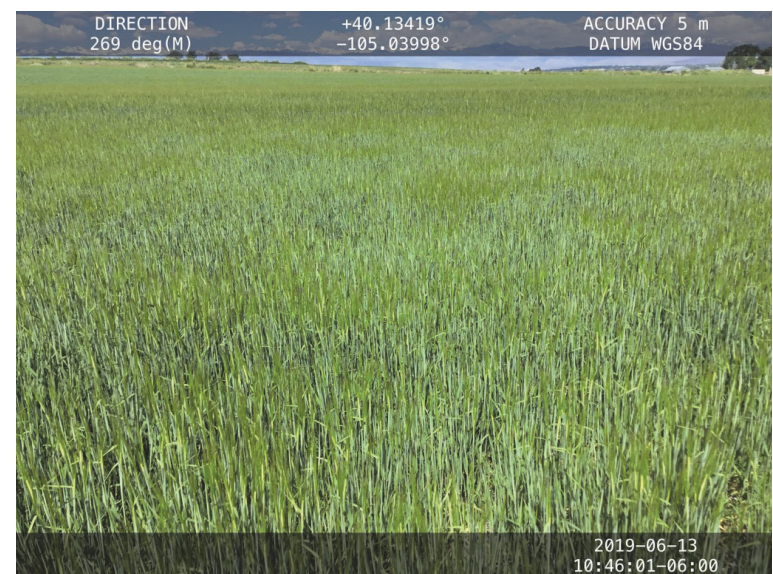

Photo Point D: East of Disturbance - Facing West

*Geographic coordinates provided in the borders of all attached photos are based on points identified by the mobile phone or tablet which collected the photo. Coordinate accuracy in this format is typically no greater than 5 meters, while the points illustrated in the site diagram associated with this submittal were collected with a high accuracy GPS unit with sub-meter accuracy. Discrepancies between the site diagram and photo coordinates will exist.

Vegetation Assessment Photo Log

Date Completed - 06/13/2019

Client - Crestone Peak Resources Operating LLC

Location Name (ID) - Williams 18-16 (330432)



Photo Point E: Crop Vegetation Photo Point - Facing Southeast