

THIS DRAWING AND THE DESIGN IT COVERS ARE CONFIDENTIAL AND REMAIN THE PROPERTY OF KAHUNA DESIGN, LLC AND SHALL NOT BE DISCLOSED TO OTHERS OR REPRODUCED IN ANY MANNER OR USED FOR ANY PURPOSE WHATSOEVER EXCEPT BY WRITTEN PERMISSION BY THE OWNER.

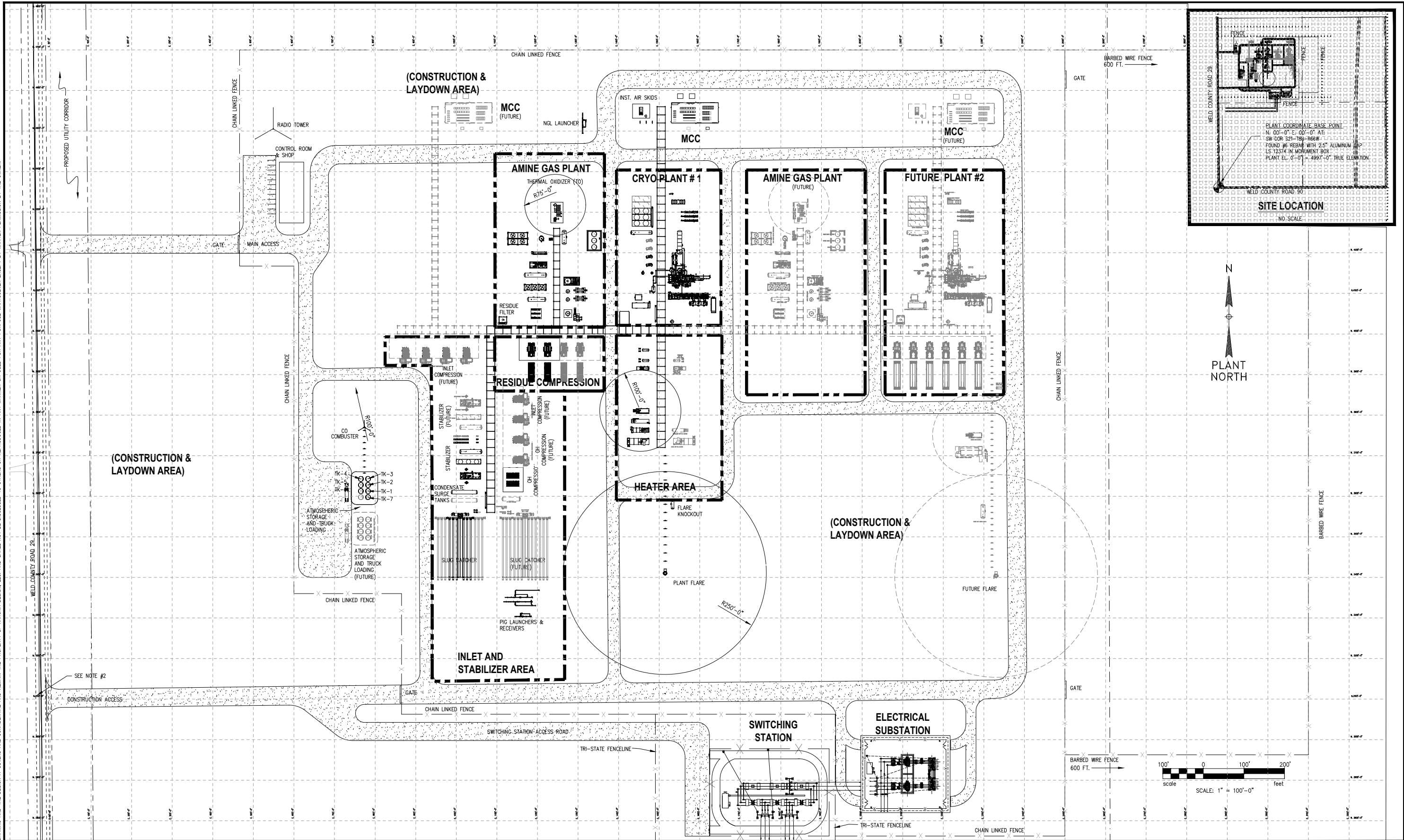

NOTES:

1. THIS PLOT PLAN HAS BEEN CONCEPTUALLY DEVELOPED UTILIZING PRELIMINARY VENDOR AND SITE INFORMATION, AND IS SUBJECT TO CHANGE WHEN FINAL INFORMATION IS RECEIVED.
2. PLANT COORDINATE BASE POINT 00'-0" E. 00'-0" AT: SW COR S21-T8N-R66W FOUND #6 REBAR WITH 2.5" ALUMINUM CAP LS 12374 IN MONUMENT BOX
3. PLANT COORDINATE EL. 0'-0" = 4997'-0" TRUE ELEVATION

REFERENCE DRAWINGS	
DWG. NO.	TITLE

REVISIONS	
NO.	DESCRIPTION
1	MOVED FUTURE AMINE & UPDATED EQUIPMENT
2	REPLACED CRYO EQUIPMENT
3	REVISED STORAGE TANKS & COMBUSTOR
4	UPDATED SUBSTATION
5	MOVED TRI-STATE SWITCH & SUBSTATION 50'
6	RELOCATED TRUCK LOADING & PIG REC.
BY	DATE
CHK.	DATE
APPR.	DATE



**RIMROCK**  
ENERGY PARTNERS  
PIERCE GAS PROCESSING PLANT



**KAHUNA VENTURES LLC**  
WESTMINSTER, CO 80021  
303-451-7374  
BY: KAHUNA DESIGN LLC.

PLOT PLAN			
PRELIMINARY LAYOUT SKETCH			
PERMITTING			
DRAWN BY: MB		CHECKED: JW	APPROVED: —
CREATION DATE: 01/22/18		CHECK DATE: 01/25/18	APPR. DATE: 01/25/18
Proj. No.: 4083.0516.00		DWG. No.: PGP-PP-2001	SHEET No. OF —
SCALE: 1" = 100'-0"			
		