



00241360

CERTIFICATE OF SURVEY
for
Guida et al
Logan County, Colorado

RECEIVED
JUL 16 1970
COLO. OIL & GAS CONS. COMM.

T9N R53W 6PM

2 P.M.

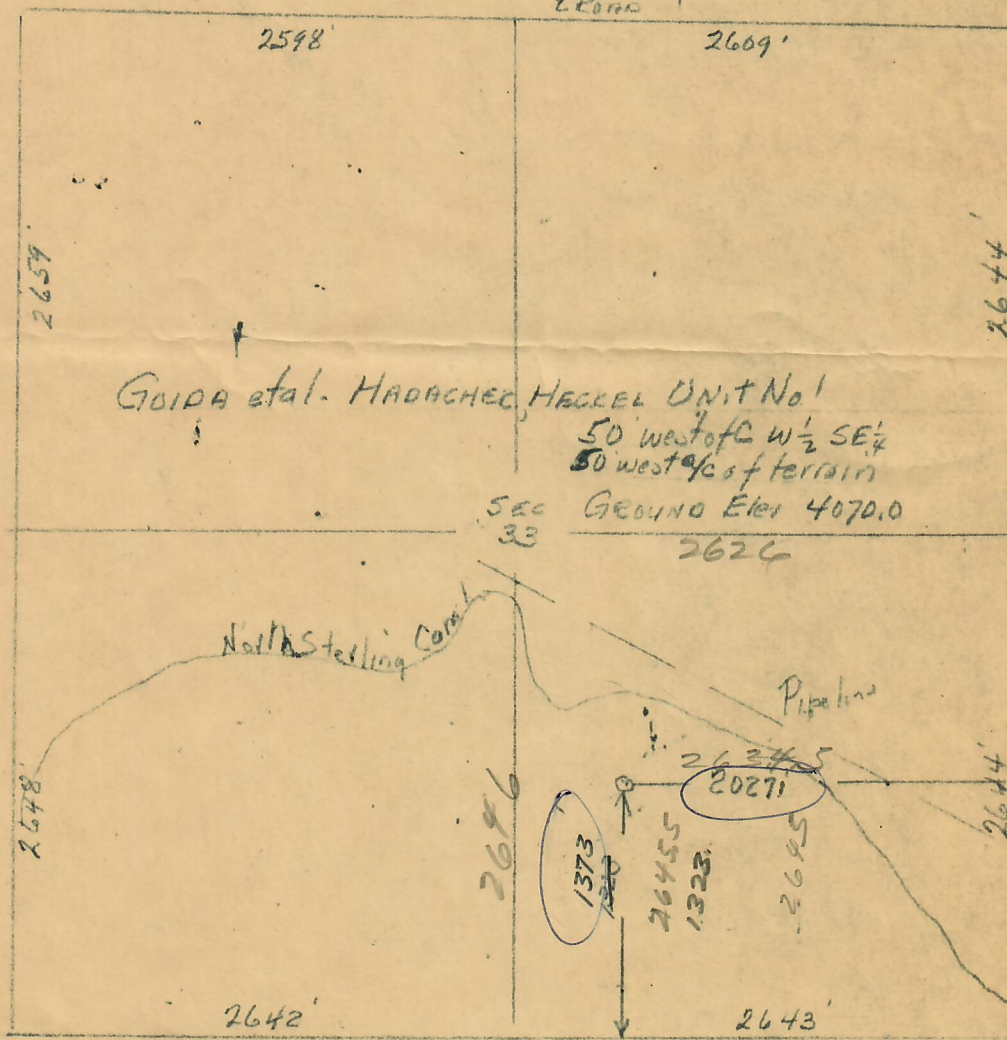

BEST IMAGE
AVAILABLE

SCALE 1"=1000'

I hereby certify that the above plat is an accurate representation of a correct survey showing the location of Guida et al-Hadackek, Heckel Unit No.1 Oilwell 50 feet west (account of terrain) of C W 1/2 SE 1/4 Sec.33 T9N R53W 6PM. The elevation of the ground at the stake is 4070.0 feet above sea level from U.S.G.S. Bench Mark.

Fort Morgan, Colorado
July 14, 1970

Registered Professional Engineer
State of Colorado

| | | |
|------|---------|------|
| 2609 | 2626 | 1317 |
| 17 | 8.5 | 658 |
| 2626 | 2634.5 | 50 |
| 17 | | 2025 |
| 2643 | 1317.25 | |
| | 658 | |

2634
2027
607

43
26
17
6 1/2

2643
2609
94
17
09
26