

RCC



00264774

WELL SITE INSPECTION

OPERATOR Kennedy + Mitchell

PERMIT NO 841917

WELL NAME Venohr Cedar Creek

DATE Jan 24 1985

RIG Eget

COUNTY Logan

LEGAL NESE 3 T9 R 54W

SURFACE CASING ☒ SIZE 8 5/8 DEPTH _____ DATE _____

CEMENT VOLUME _____ RETURNS _____ WOC _____

PROBABLE FOX HILLS DEPTH _____

MUD PITS Pits Empty - not filled

DISPOSAL _____

PRODUCTION STRING ☒ SIZE 5 1/2 DEPTH _____

STAGED _____ CBL CHECKED _____

SQUEEZE _____ FRAC JOB _____

BATTERY _____ SIGN _____

SITE INSPECTION AFTER DRILLING _____

To be cleaned up for completion

DIRECTIONS _____

ACTION None

ENGINEER Dr Bucknell

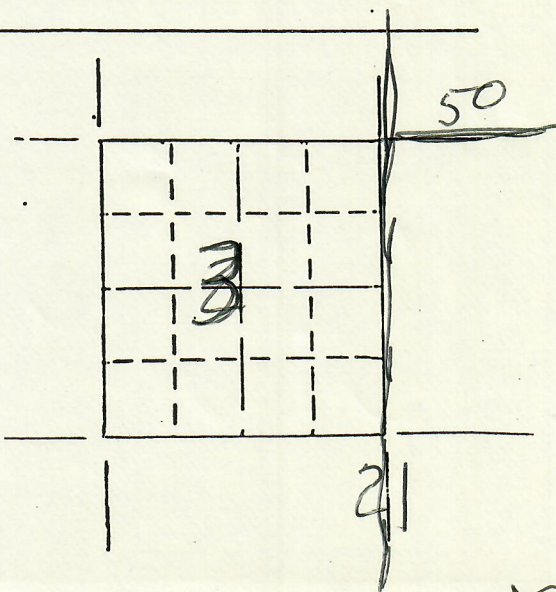

XX

DEPARTMENT OF NATURAL RESOURCES
OIL AND GAS CONSERVATION COMMISSION
OF THE STATE OF COLORADORECEIVED
DEC 31 1984
COLO. OIL & GAS CONS. COMM.APPLICATION
FOR PERMIT TO DRILL, DEEPEN, OR REENTER AND OPERATE

1a. TYPE OF WORK

DRILL ☒DEEPEN ☐REENTER ☐

b. TYPE OF WELL

OIL
WELL ☒GAS
WELL ☐OTHER ☐SINGLE
ZONE ☒MULTIPLE
ZONE ☐

2. NAME OF OPERATOR

Kennedy & Mitchell, Inc.

303-988-4620

3. ADDRESS OF OPERATOR

P.O. Box 27D

Denver, CO 80227

4. LOCATION OF WELL (Report location clearly and in accordance with any State requirements.)

At surface

2069' FSL and 660' FEL of Sec. 3

At proposed prod. zone

Same

14. DISTANCE IN MILES AND DIRECTION FROM NEAREST TOWN OR POST OFFICE

11 miles East of Padroni

15. DISTANCE FROM PROPOSED LOCATION TO NEAREST PROPERTY
OR LEASE LINE, FT.
(Also to nearest drlg. line, if any)

600

16. NO. OF ACRES IN LEASE*

320

17. NO. OF ACRES AND/OR DRILLING UNIT ASSIGNED
TO THIS WELL

40

18. DISTANCE FROM PROPOSED LOCATION
TO NEAREST WELL, DRILLING, COMPLETED,
OR APPLIED FOR, ON THIS LEASE, FT.

None

19. PROPOSED DEPTH

5225'

20. ROTARY OR CABLE TOOLS

Rotary

21. ELEVATIONS (Show whether DF, RT, GR, etc.)

4261' GR

22. APPROX. DATE WORK WILL START

January 15, 1985

23.

PROPOSED CASING AND CEMENTING PROGRAM

SIZE OF HOLE	SIZE OF CASING	WEIGHT PER FOOT	SETTING DEPTH	QUANTITY OF CEMENT
12 1/4"	8-5/8"	24#	120'	90 sks
7-7/8"	5 1/2"	14#	5225'	200 sks

Surface owner is a party to Leasing Agreement.

* DESCRIBE LEASE

T9N-R54W: Sec. 3 - S/2

Drilling Program:

- A. Drill to 120' +. Set 8-5/8" casing and cement to surface.
- B. Install and Test BOPE.
- C. Drill 7-7/8" hole. Maximum anticipated mud weight is 10 ppg.
- D. Run DST's as necessary. Run DIL/SFL and FDC/CNL logs. Principal objectives are the "D" and "J" sands.
- E. Run and cement 5 1/2" casing if well appears productive.

IN ABOVE SPACE DESCRIBE PROPOSED PROGRAM: If proposal is to deepen or reenter and operate, give data on present productive zone and proposed new productive zone. If proposal is to drill or deepen directionally, give pertinent data on subsurface locations and measured and true vertical depths. Give blowout preventer program, if any.

In accepting this permit the applicant agrees to fully abide by the requirements and rules of this Commission governing this permitted operation including his responsibility to prevent pollution of state waters during drilling, treating, testing, and producing operations and by the casing, cementing and plugging requirements particularly designed for the protection of state waters and the prevention of intermingling of the contents of all the various zones encountered in this permitted operation.

24.

SIGNED

Richard L. R.E. Fromm,

TITLE

Petroleum Engineer

DATE

December 28, 1984

(This space for Federal or State Office use)

PERMIT NO.

841917

APPROVAL DATE

DEC 31 1984

APPROVED BY

William Smith

TITLE

DIRECTOR

DATE

CONDITIONS OF APPROVAL, IF ANY:

O & G Cons. Comm.

A.P.I. NUMBER

05 075 9083

See Instructions On Reverse Side