



FORM F-106



00216236

RECEIVED

DEC 6 1976

R. 50W

COLD. OIL & GAS CONS. COMM.

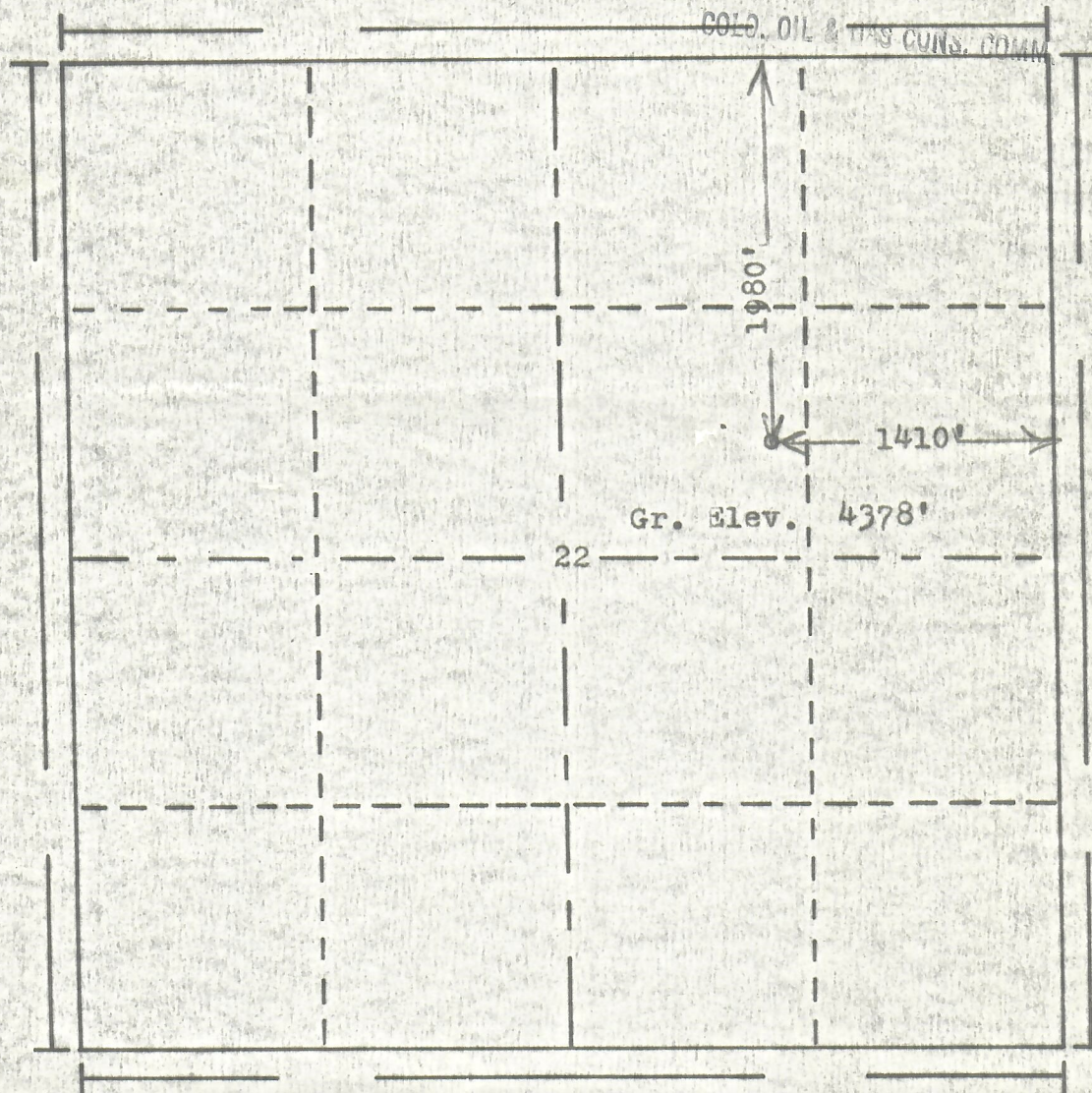
T.
8
N

Scale... 1" = 1000'

Powers Elevation Company, Inc. of Denver, Colorado
has in accordance with a request from Mr. Storm
for Stream Inc.

determined the location of No. 1 SCHMIDT-STATE
to be 1980'FN & 1410'FE Section 22 Township 8N
Range 50W of the 6th principal Meridian
Logan County, Colorado

I hereby certify that this plat is an
accurate representation of a correct
survey showing the location of

Date: 11-16-76

Brian J. Hagan
Licensed Land Surveyor No. 2853
State of Colorado