

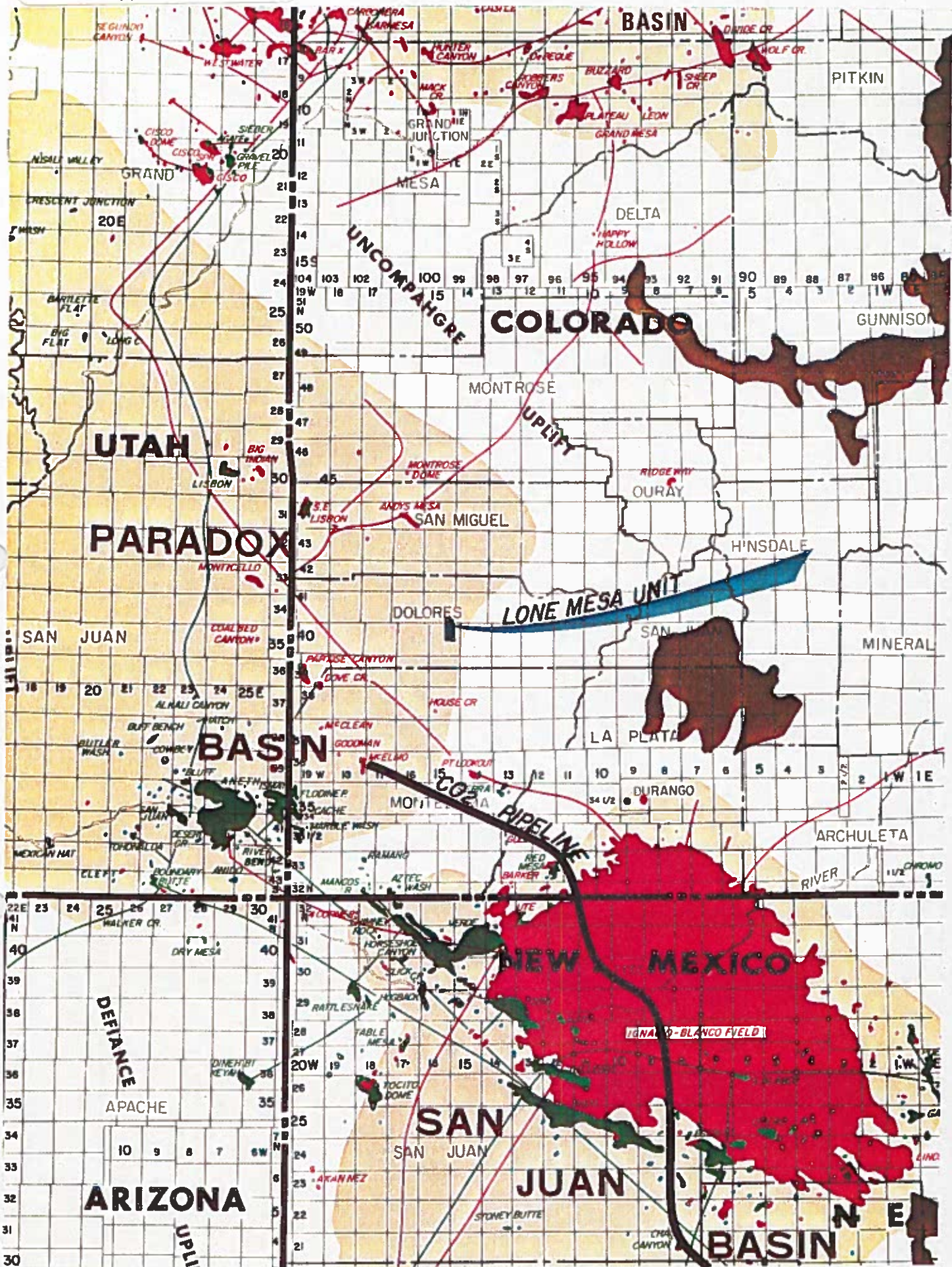

99999999

395-1



IMPEL ENERGY CORP.

Denver, Colorado

EXHIBIT "1"

LONE MESA UNIT

LEGEND

CO2 Pipeline

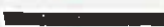

LONE MESA UNIT area

00748617

1/83

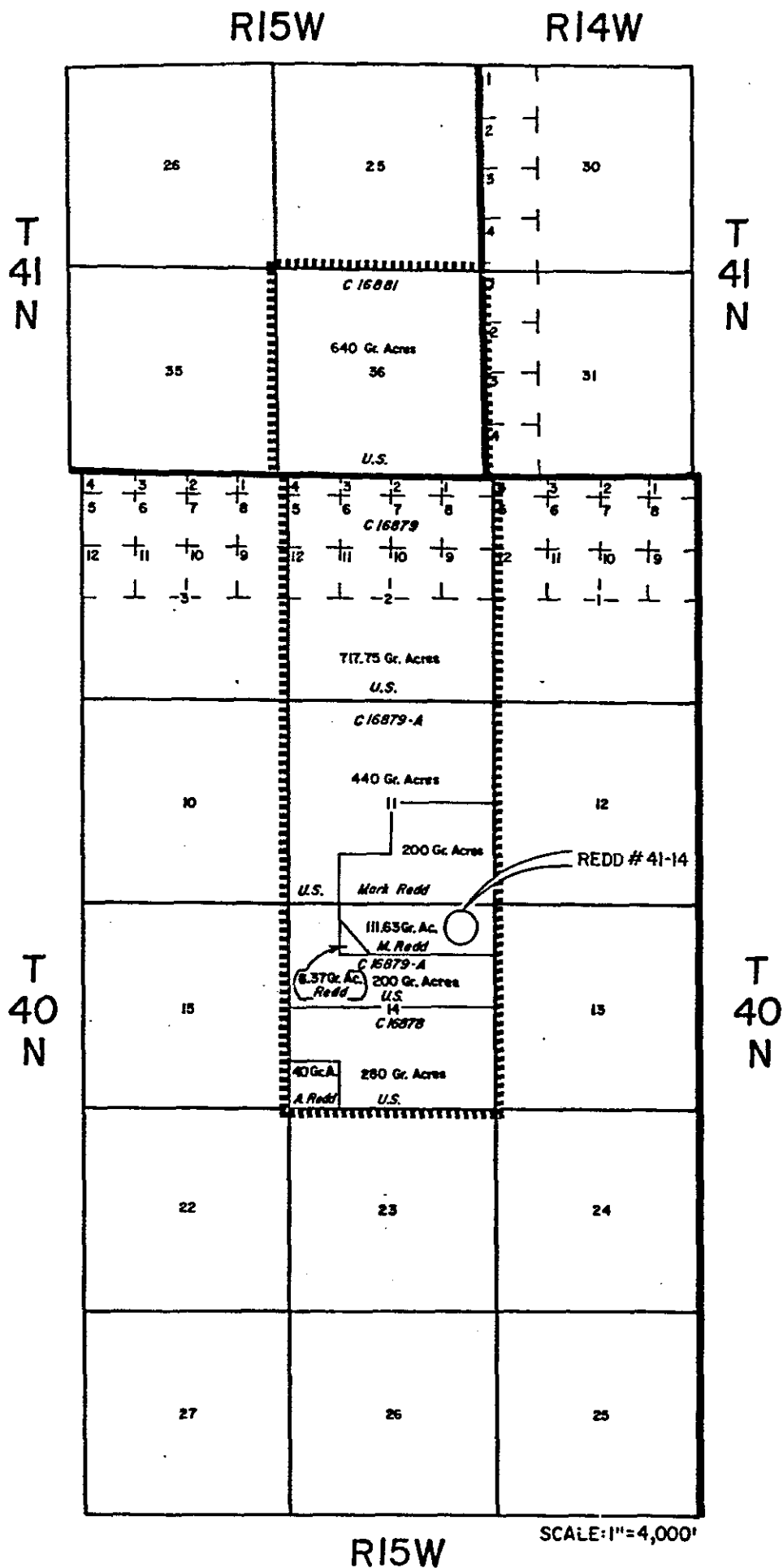

IMPEL ENERGY CORP.

LONE MESA UNIT

HOUSE CREEK PROSPECT

DOLORES COUNTY

COLORADO

REDD NO. 41-14
DOLORES COUNTY, COLORADO
PERTINENT DATA SHEET

COMPANY:	Impel Energy Corporation		
WELL NAME:	Redd No. 41-14		
FIELD:	Lone Mesa Unit		
LOCATION:	448' FNL and 646' FEL Section 14-T40N-R15W Dolores County, Colorado		
SPUD DATE:	08-22-81		
TOTAL DEPTH:	8,700' (10-06-81)		
PBTD:	8,596'		
INTERVALS TESTED (CO ₂):	8,510'-8,420' KB (8 MMcfpd)	Ouray	
	8,305'-8,280' KB (11 MMcfpd)	Leadville	
PRODUCTIVE ZONES:	8,510'-8,460'	Ouray	
	8,305'-8,280'	Leadville	
PROPOSED SPACING UNIT:	Sec. 36-T41N-R15W	640.00 acres	
	Sec. 2-T40N-R15W	717.75 acres	
	Sec. 11-T40N-R15W	640.00 acres	
	Sec. 14-T40N-R15W	640.00 acres	
	Total Unit	2,637.75 acres	
ESTIMATED RECOVERABLE RESERVES:	(4.54 BCF/Section)	18.7 BCF	
AVERAGE PERMEABILITY:	95 md		
AVERAGE POROSITY:	5%		
AVERAGE WATER SATURATION:	40%		
ESTIMATED DRY HOLE COST:	\$1,300,000		
ESTIMATED PRODUCER COST:	\$1,600,000		
ESTIMATED SALES PRICE FOR CO ₂ :	80¢/Mcf		
ESTIMATED ADDITIONAL CAPITAL INVESTMENT:	\$3,600,000		
ESTIMATED OPERATING COSTS:	\$50,000/month		
BOTTOMHOLE TEMPERATURE:	188° F.		
BOTTOMHOLE PRESSURE:	3,900 psi. (Calculated)		
CAOFP:	30 MMcfpd		

IMPEL ENERGY CORPORATION
REDD ET AL #41-14
DOLORES CO., COLORADO
PROPOSED CONDITIONS

EXHIBIT NO. 5

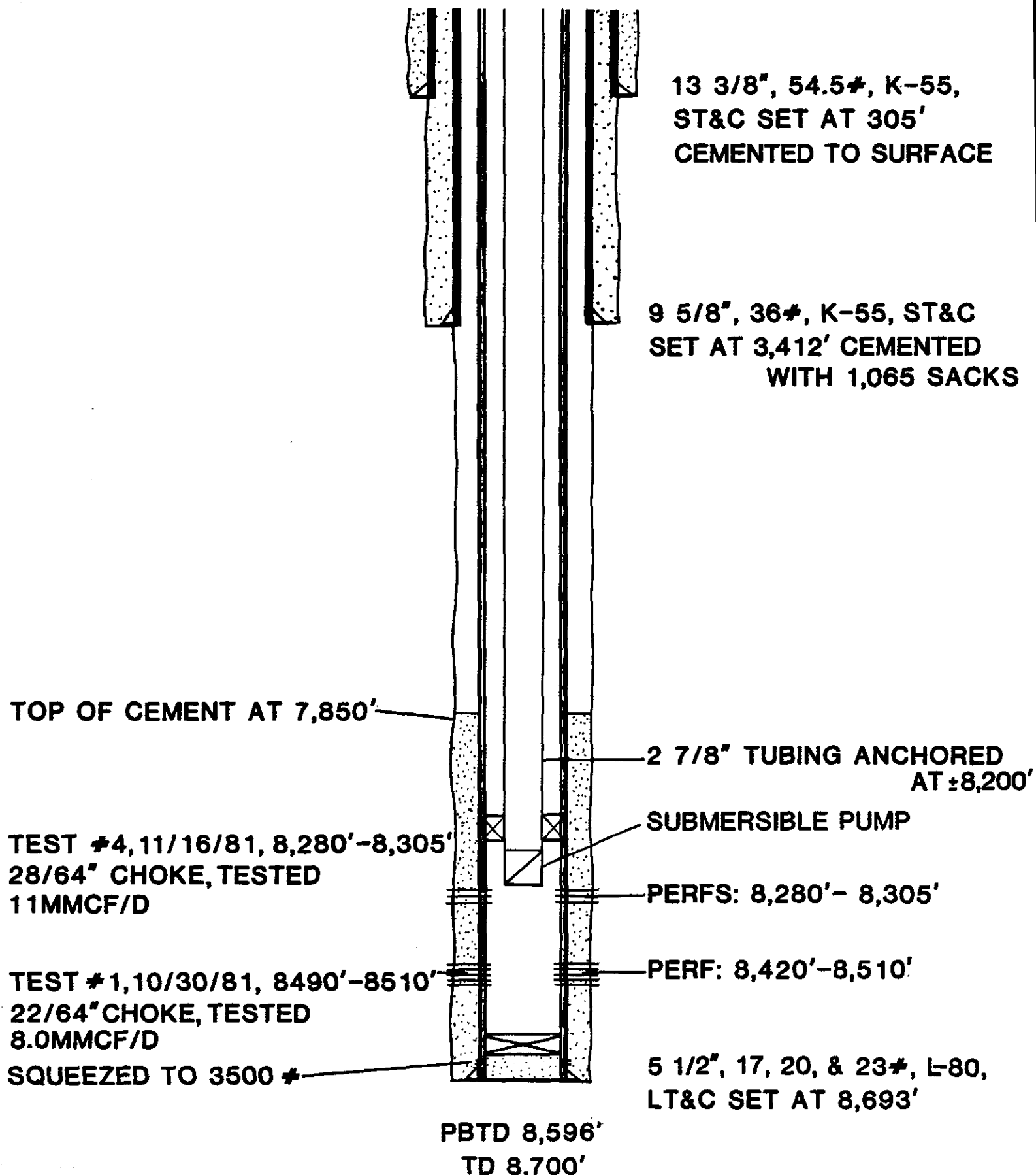

Page 1 of File 3806-G-1052

Company IMPEL ENERGY CORPORATION Formation OURAY - LEADVILLE
 Well IMPEL 41-14 NO. 1 County DOLORES
 Field WILDCAT State COLORADO

Chromatographic Gas Analysis

COMPONENT	MOL PER CENT	G. P. M.	DENSITY @ 60° F. GRAMS PER CUBIC CENTIMETER	° API @ 60° F.	MOLECULAR WEIGHT
Carbon Dioxide	98.97				
Nitrogen	.56				
Methane	.33				
Ethane					
Propane	.13	.036			
iso-Butane	.01	.003			
n-Butane					
iso-Pentane					
n-Pentane					
Hexanes					
Heptanes plus					
	<u>100.00</u>	<u>.039</u>			

Calculated gas gravity (air=1.000) = 1.513

Calculated gross heating value = 7 BTU
per cubic foot of gas at 14.65 psia

Choke 45/64 downstream from sample point

SAMPLE DETAILS

Type Gas
 Client Sample No. Cylinder No. 4HDY300
 Date Sampled 10-31-81 Temperature 60 °F
 Sampling Pressure 560 psig Sampled By