



FORM F-106

BEST IMAGE
AVAILABLE

00575061

AUG 18 1980

R. 48W

COLO. OIL & GAS CONS. COMM.

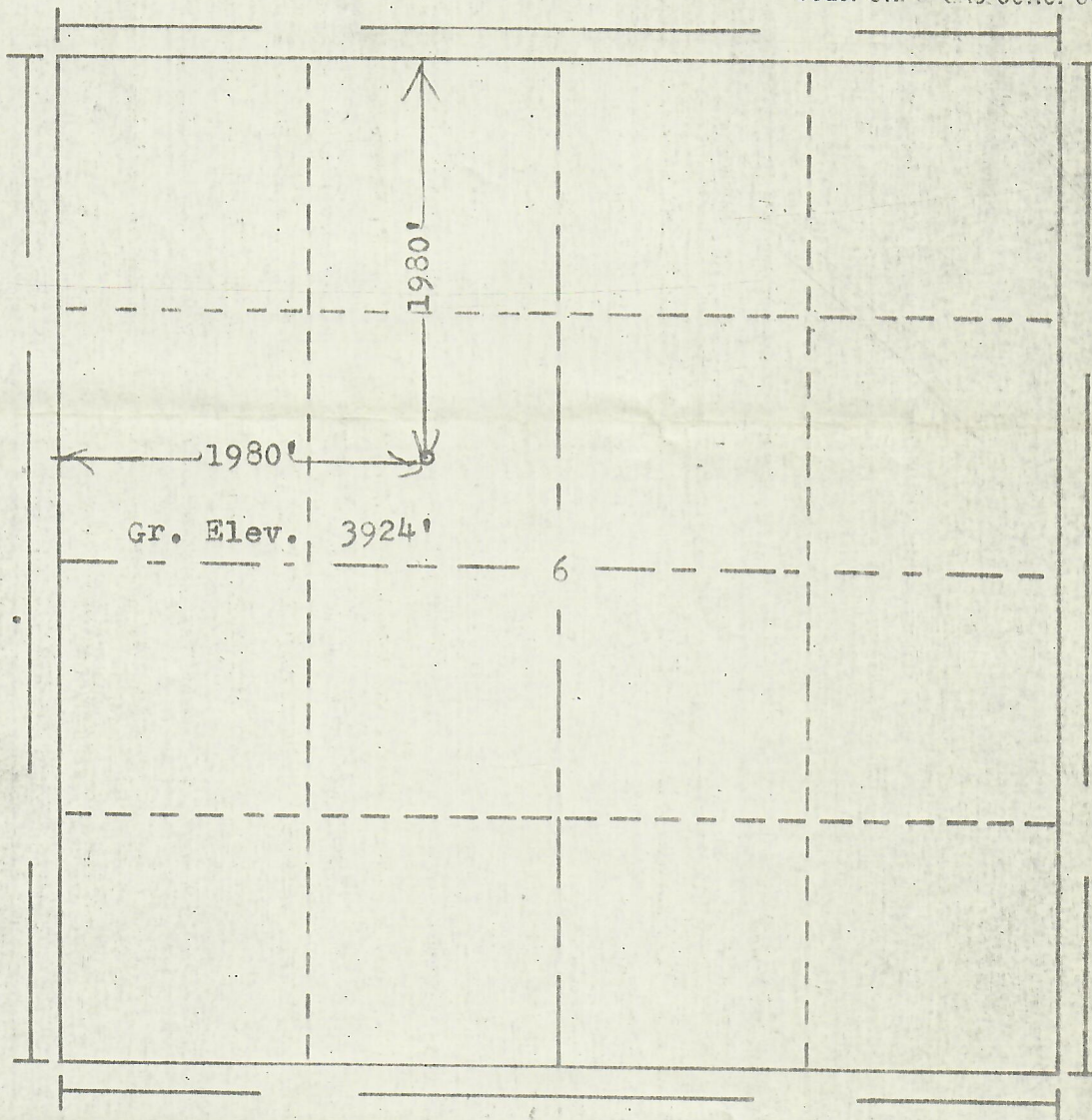

Scale... 1" = 1000'

Powers Elevation of Denver, Colorado
has in accordance with a request from Mr. Brown
for Rincon Operating Co.
determined the location of No. 1-6 Armstrong
to be CSE NW Section 6 Township 24S
Range 48W of the 6th Principal Meridian
Bent County, Colorado

I hereby certify that this plat is an
accurate representation of a correct
survey showing the location of

Date: 8-5-80

Boyd J. Hallman
Licensed Land Surveyor No. 2853
State of Colorado