

AMENDED PAGE

EXHIBIT "A"

Location and Elevation Plat

R. 54 W



02433765

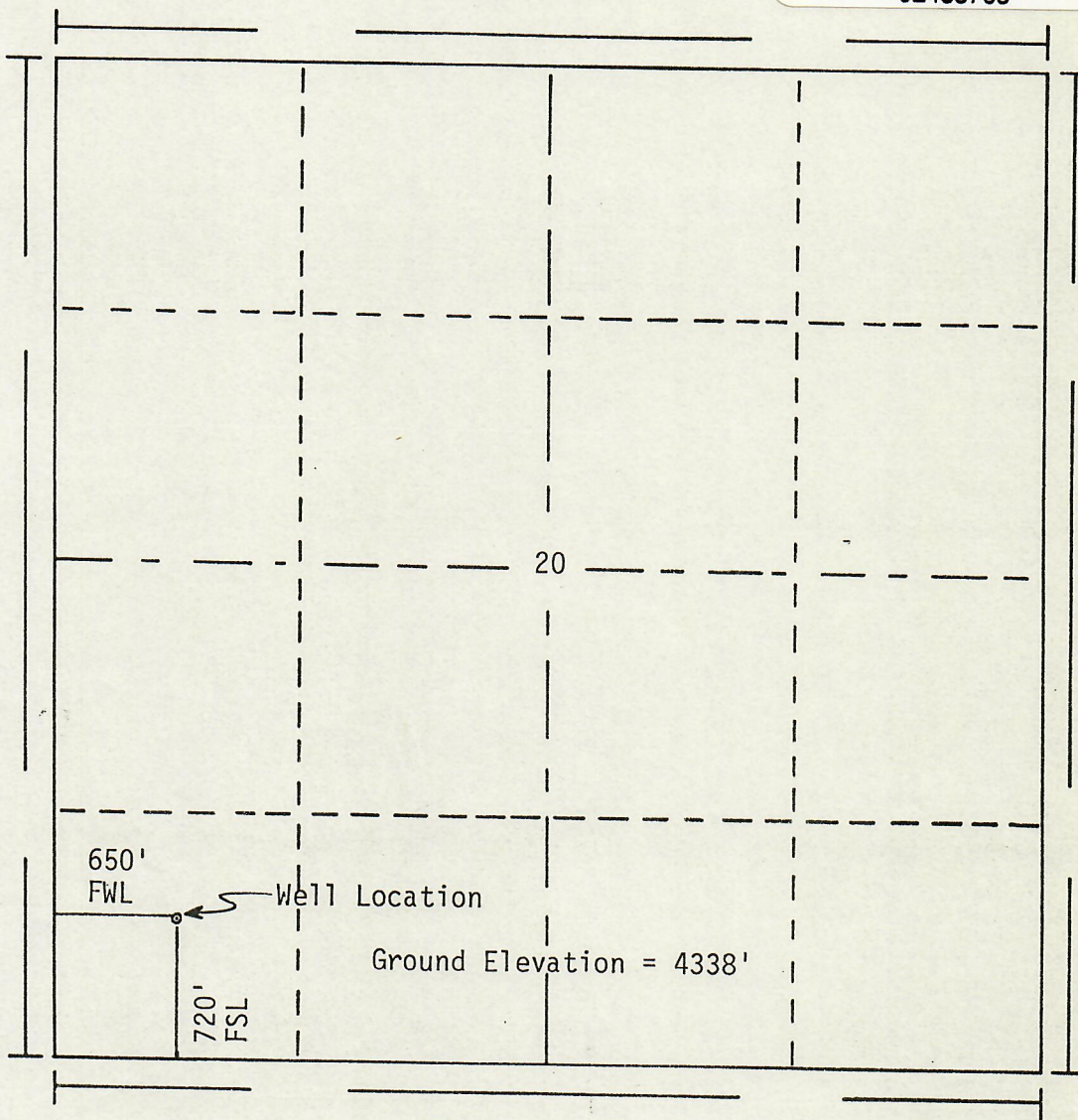

T.  
24  
S

Scale... 1" = 1000'

**Powers Elevation of Denver, Colorado**  
has in accordance with a request from H. C. Petersen  
for himself, H. C. Petersen  
determined the location of #1 Federal  
to be 720' FSL & 650' FWL Section 20 Township 24S  
Range 54W of the 6th Principal Meridian  
Otero County, Colorado

I hereby certify that this plat is an accurate representation of a correct survey showing the location of #1 Federal.

Date: 3-17-82

T. Nelson  
Licensed Land Surveyor No. 2188  
State of Colorado