



PROJECT DETAILS: Weld County, CO NAD 83

Geodetic System: US State Plane 1983  
Datum: North American Datum 1983  
Ellipsoid: GRS 1980  
Zone: Colorado Northern Zone  
System Datum: Mean Sea Level  
Local North: True

Project: Weld County, CO NAD 83  
Site: Fox Creek 25 SW Pad  
Well: Fox Creek 12-63-36-1-2N  
Wellbore: OH  
Design: Plan 1



Azimuths to True North  
Magnetic North: 8.28°

Magnetic Field  
Strength: 52808.0snT  
Dip Angle: 67.28°  
Date: 10/17/2018  
Model: HDGM



Plan: Plan 1 (Fox Creek 12-63-36-1-2N/OH)

Created By: Seth Burstad

### SECTION DETAILS

MD	Inc	Azi	TVD	+N/-S	+E/-W	Dleg	TFace	VSect
0.00	0.00	0.000	0.00	0.00	0.00	0.00	0.00	0.00
500.00	0.00	0.000	500.00	0.00	0.00	0.00	0.00	0.00
750.00	5.00	88.510	749.68	0.28	10.90	2.00	88.51	-0.27
1703.95	5.00	88.510	1700.00	2.45	94.01	0.00	0.00	-2.32
2703.88	25.00	88.510	2660.97	9.14	351.40	2.00	0.00	-8.66
3532.32	25.00	88.510	3411.80	18.24	701.38	0.00	0.00	-17.28
5198.90	0.00	0.000	5026.00	27.55	1059.10	1.50	180.00	-26.09
7045.94	0.00	0.000	6873.04	27.55	1059.10	0.00	0.00	-26.09
7945.94	90.00	179.921	7446.00	-545.41	1059.89	10.00	179.92	546.87
18352.42	90.00	179.921	7446.00	-10951.88	1074.15	0.00	0.00	10953.35

### WELL DETAILS: Fox Creek 12-63-36-1-2N

GL 5412' & KB 20' @ 5432.00ft 5412.00  
+N/-S +E/-W Northing Easting Latitude Longitude  
0.00 0.00 1599787.83 3307573.14 40° 58' 28.106 N 104° 23' 10.252 W

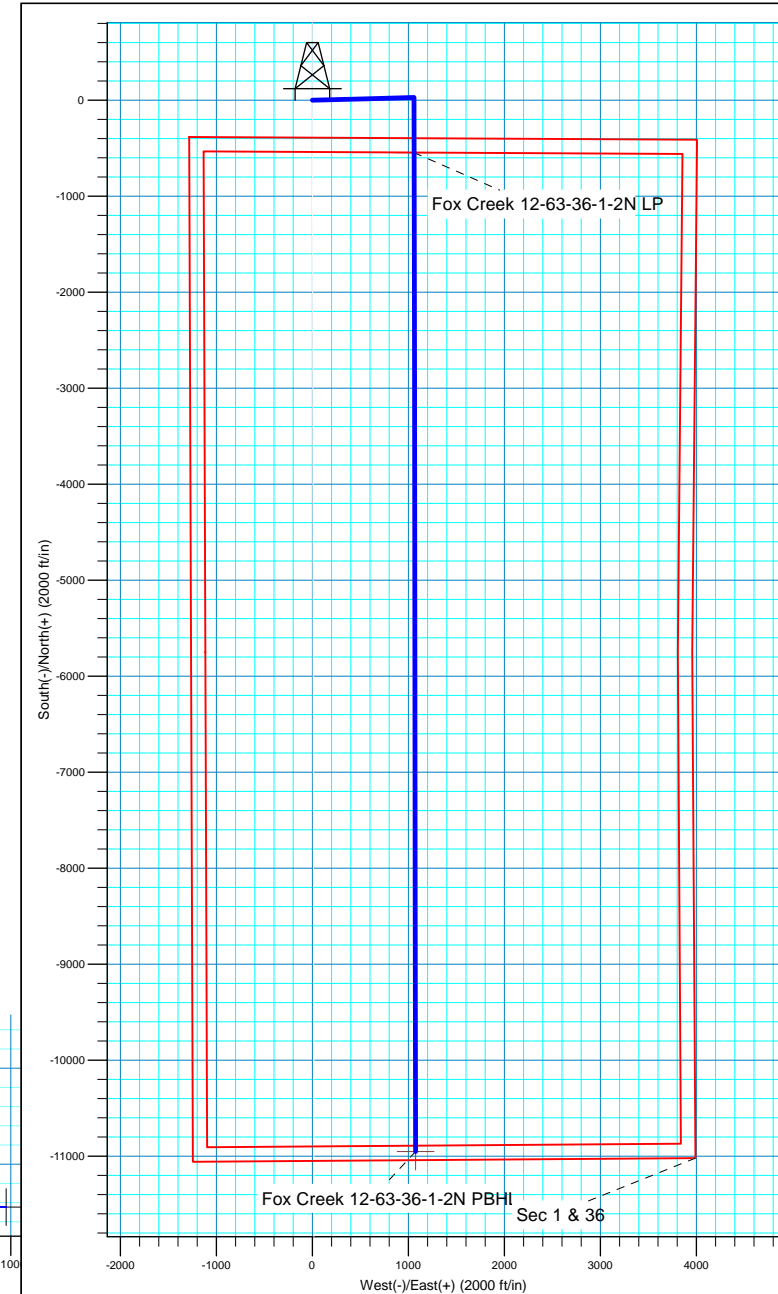
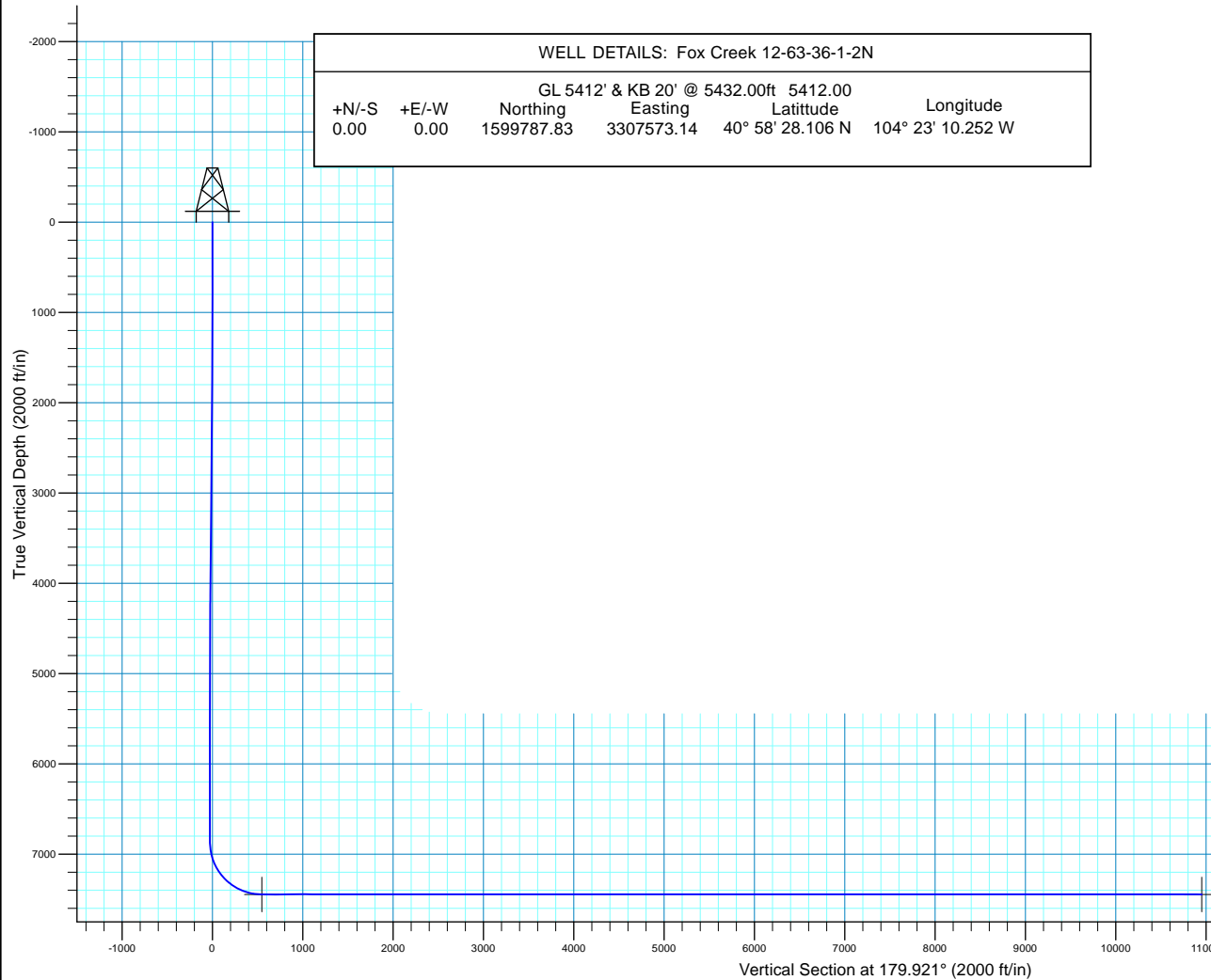



# HighPoint Resources

Weld County, CO NAD 83

Fox Creek 25 SW Pad

Fox Creek 12-63-36-1-2N

OH

Plan: Plan 1

## Standard Planning Report

17 October, 2018



<b>Database:</b>	Casper District	<b>Local Co-ordinate Reference:</b>	Well Fox Creek 12-63-36-1-2N
<b>Company:</b>	HighPoint Resources	<b>TVD Reference:</b>	GL 5412' & KB 20' @ 5432.00ft
<b>Project:</b>	Weld County, CO NAD 83	<b>MD Reference:</b>	GL 5412' & KB 20' @ 5432.00ft
<b>Site:</b>	Fox Creek 25 SW Pad	<b>North Reference:</b>	True
<b>Well:</b>	Fox Creek 12-63-36-1-2N	<b>Survey Calculation Method:</b>	Minimum Curvature
<b>Wellbore:</b>	OH		
<b>Design:</b>	Plan 1		

<b>Project</b>	Weld County, CO NAD 83		
<b>Map System:</b>	US State Plane 1983	<b>System Datum:</b>	Mean Sea Level
<b>Geo Datum:</b>	North American Datum 1983		
<b>Map Zone:</b>	Colorado Northern Zone		

Site		Fox Creek 25 SW Pad, Site Center : Fox Creek 25-6104B			
Site Position:		Northing:	1,599,789.47 usft	Latitude:	40° 58' 28.092 N
From:	Lat/Long	Easting:	3,307,818.08 usft	Longitude:	104° 23' 7.058 W
Position Uncertainty:	0.00 ft	Slot Radius:	13.200 in	Grid Convergence:	0.72 °

Well	Fox Creek 12-63-36-1-2N, 390' FSL 1281' FWL Sec 25 T12N R63W					
Well Position	+N/-S	1.44 ft	Northing:	1,599,787.83 usft	Latitude:	40° 58' 28.106 N
	+E/-W	-244.95 ft	Easting:	3,307,573.14 usft	Longitude:	104° 23' 10.252 W
Position Uncertainty		0.00 ft	Wellhead Elevation:	0.00 ft	Ground Level:	5,412.00 ft

<b>Wellbore</b>	OH				
<b>Magnetics</b>	<b>Model Name</b>	<b>Sample Date</b>	<b>Declination (°)</b>	<b>Dip Angle (°)</b>	<b>Field Strength (nT)</b>
	HDGM	10/17/2018	8.28	67.28	52,808

<b>Design</b>	Plan 1			
<b>Audit Notes:</b>				
<b>Version:</b>	<b>Phase:</b>	PLAN	<b>Tie On Depth:</b>	0.00
<b>Vertical Section:</b>	<b>Depth From (TVD) (ft)</b>	<b>+N/-S (ft)</b>	<b>+E/-W (ft)</b>	<b>Direction (°)</b>
	0.00	0.00	0.00	179.921

<b>Plan Sections</b>										
Measured Depth (ft)	Inclination (°)	Azimuth (°)	Vertical Depth (ft)	+N/-S (ft)	+E/-W (ft)	Dogleg Rate (°/100ft)	Build Rate (°/100ft)	Turn Rate (°/100ft)	TFO (°)	Target
0.00	0.00	0.000	0.00	0.00	0.00	0.00	0.00	0.00	0.00	
500.00	0.00	0.000	500.00	0.00	0.00	0.00	0.00	0.00	0.00	
750.00	5.00	88.510	749.68	0.28	10.90	2.00	2.00	0.00	88.51	
1,703.95	5.00	88.510	1,700.00	2.45	94.01	0.00	0.00	0.00	0.00	
2,703.88	25.00	88.510	2,660.97	9.14	351.40	2.00	2.00	0.00	0.00	
3,532.32	25.00	88.510	3,411.80	18.24	701.38	0.00	0.00	0.00	0.00	
5,198.90	0.00	0.000	5,026.00	27.55	1,059.10	1.50	-1.50	0.00	180.00	
7,045.94	0.00	0.000	6,873.04	27.55	1,059.10	0.00	0.00	0.00	0.00	
7,945.94	90.00	179.921	7,446.00	-545.41	1,059.89	10.00	10.00	19.99	179.92	
18,352.42	90.00	179.921	7,446.00	-10,951.88	1,074.15	0.00	0.00	0.00	0.00	Fox Creek 12-63-36-1

<b>Database:</b>	Casper District	<b>Local Co-ordinate Reference:</b>	Well Fox Creek 12-63-36-1-2N
<b>Company:</b>	HighPoint Resources	<b>TVD Reference:</b>	GL 5412' & KB 20' @ 5432.00ft
<b>Project:</b>	Weld County, CO NAD 83	<b>MD Reference:</b>	GL 5412' & KB 20' @ 5432.00ft
<b>Site:</b>	Fox Creek 25 SW Pad	<b>North Reference:</b>	True
<b>Well:</b>	Fox Creek 12-63-36-1-2N	<b>Survey Calculation Method:</b>	Minimum Curvature
<b>Wellbore:</b>	OH		
<b>Design:</b>	Plan 1		

Planned Survey									
Measured Depth (ft)	Inclination (°)	Azimuth (°)	Vertical Depth (ft)	+N/-S (ft)	+E/-W (ft)	Vertical Section (ft)	Dogleg Rate (°/100ft)	Build Rate (°/100ft)	Turn Rate (°/100ft)
0.00	0.00	0.000	0.00	0.00	0.00	0.00	0.00	0.00	0.00
100.00	0.00	0.000	100.00	0.00	0.00	0.00	0.00	0.00	0.00
200.00	0.00	0.000	200.00	0.00	0.00	0.00	0.00	0.00	0.00
300.00	0.00	0.000	300.00	0.00	0.00	0.00	0.00	0.00	0.00
400.00	0.00	0.000	400.00	0.00	0.00	0.00	0.00	0.00	0.00
500.00	0.00	0.000	500.00	0.00	0.00	0.00	0.00	0.00	0.00
Start Build 2.00									
600.00	2.00	88.510	599.98	0.05	1.74	-0.04	2.00	2.00	0.00
700.00	4.00	88.510	699.84	0.18	6.98	-0.17	2.00	2.00	0.00
750.00	5.00	88.510	749.68	0.28	10.90	-0.27	2.00	2.00	0.00
Start 953.95 hold at 750.00 MD									
800.00	5.00	88.510	799.49	0.40	15.25	-0.38	0.00	0.00	0.00
900.00	5.00	88.510	899.11	0.62	23.97	-0.59	0.00	0.00	0.00
1,000.00	5.00	88.510	998.73	0.85	32.68	-0.80	0.00	0.00	0.00
1,100.00	5.00	88.510	1,098.35	1.08	41.39	-1.02	0.00	0.00	0.00
1,200.00	5.00	88.510	1,197.97	1.30	50.10	-1.23	0.00	0.00	0.00
1,300.00	5.00	88.510	1,297.59	1.53	58.82	-1.45	0.00	0.00	0.00
1,400.00	5.00	88.510	1,397.21	1.76	67.53	-1.66	0.00	0.00	0.00
1,500.00	5.00	88.510	1,496.83	1.98	76.24	-1.88	0.00	0.00	0.00
1,600.00	5.00	88.510	1,596.45	2.21	84.96	-2.09	0.00	0.00	0.00
1,700.00	5.00	88.510	1,696.07	2.44	93.67	-2.31	0.00	0.00	0.00
1,703.95	5.00	88.510	1,700.00	2.45	94.01	-2.32	0.00	0.00	0.00
Start DLS 2.00 TFO 0.00									
1,800.00	6.92	88.510	1,795.53	2.70	103.98	-2.56	2.00	2.00	0.00
1,900.00	8.92	88.510	1,894.57	3.06	117.76	-2.90	2.00	2.00	0.00
2,000.00	10.92	88.510	1,993.07	3.51	134.98	-3.32	2.00	2.00	0.00
2,100.00	12.92	88.510	2,090.91	4.05	155.63	-3.83	2.00	2.00	0.00
2,200.00	14.92	88.510	2,187.97	4.67	179.68	-4.43	2.00	2.00	0.00
2,300.00	16.92	88.510	2,284.12	5.39	207.10	-5.10	2.00	2.00	0.00
2,400.00	18.92	88.510	2,379.27	6.19	237.86	-5.86	2.00	2.00	0.00
2,500.00	20.92	88.510	2,473.28	7.07	271.92	-6.70	2.00	2.00	0.00
2,600.00	22.92	88.510	2,566.04	8.04	309.23	-7.62	2.00	2.00	0.00
2,700.00	24.92	88.510	2,657.45	9.10	349.77	-8.62	2.00	2.00	0.00
2,703.88	25.00	88.510	2,660.97	9.14	351.40	-8.66	2.00	2.00	0.00
Start 828.44 hold at 2703.88 MD									
2,800.00	25.00	88.510	2,748.08	10.20	392.01	-9.66	0.00	0.00	0.00
2,900.00	25.00	88.510	2,838.72	11.30	434.25	-10.70	0.00	0.00	0.00
3,000.00	25.00	88.510	2,929.35	12.39	476.50	-11.74	0.00	0.00	0.00
3,100.00	25.00	88.510	3,019.98	13.49	518.75	-12.78	0.00	0.00	0.00
3,200.00	25.00	88.510	3,110.61	14.59	560.99	-13.82	0.00	0.00	0.00
3,300.00	25.00	88.510	3,201.24	15.69	603.24	-14.86	0.00	0.00	0.00
3,400.00	25.00	88.510	3,291.87	16.79	645.48	-15.90	0.00	0.00	0.00
3,500.00	25.00	88.510	3,382.51	17.89	687.73	-16.94	0.00	0.00	0.00
3,532.32	25.00	88.510	3,411.80	18.24	701.38	-17.28	0.00	0.00	0.00
Start Drop -1.50									
3,600.00	23.98	88.510	3,473.39	18.97	729.43	-17.97	1.50	-1.50	0.00
3,700.00	22.48	88.510	3,565.28	20.00	768.86	-18.94	1.50	-1.50	0.00
3,800.00	20.98	88.510	3,658.16	20.96	805.88	-19.85	1.50	-1.50	0.00
3,900.00	19.48	88.510	3,751.99	21.86	840.45	-20.70	1.50	-1.50	0.00
4,000.00	17.98	88.510	3,846.69	22.70	872.55	-21.49	1.50	-1.50	0.00
4,100.00	16.48	88.510	3,942.20	23.47	902.17	-22.22	1.50	-1.50	0.00
4,200.00	14.98	88.510	4,038.45	24.17	929.28	-22.89	1.50	-1.50	0.00
4,300.00	13.48	88.510	4,135.38	24.81	953.85	-23.50	1.50	-1.50	0.00
4,400.00	11.98	88.510	4,232.91	25.39	975.89	-24.04	1.50	-1.50	0.00

<b>Database:</b>	Casper District	<b>Local Co-ordinate Reference:</b>	Well Fox Creek 12-63-36-1-2N
<b>Company:</b>	HighPoint Resources	<b>TVD Reference:</b>	GL 5412' & KB 20' @ 5432.00ft
<b>Project:</b>	Weld County, CO NAD 83	<b>MD Reference:</b>	GL 5412' & KB 20' @ 5432.00ft
<b>Site:</b>	Fox Creek 25 SW Pad	<b>North Reference:</b>	True
<b>Well:</b>	Fox Creek 12-63-36-1-2N	<b>Survey Calculation Method:</b>	Minimum Curvature
<b>Wellbore:</b>	OH		
<b>Design:</b>	Plan 1		

Planned Survey									
Measured Depth (ft)	Inclination (°)	Azimuth (°)	Vertical Depth (ft)	+N/-S (ft)	+E/-W (ft)	Vertical Section (ft)	Dogleg Rate (°/100ft)	Build Rate (°/100ft)	Turn Rate (°/100ft)
4,500.00	10.48	88.510	4,331.00	25.89	995.36	-24.52	1.50	-1.50	0.00
4,600.00	8.98	88.510	4,429.55	26.33	1,012.26	-24.94	1.50	-1.50	0.00
4,700.00	7.48	88.510	4,528.52	26.70	1,026.58	-25.29	1.50	-1.50	0.00
4,800.00	5.98	88.510	4,627.83	27.01	1,038.30	-25.58	1.50	-1.50	0.00
4,900.00	4.48	88.510	4,727.41	27.25	1,047.42	-25.80	1.50	-1.50	0.00
5,000.00	2.98	88.510	4,827.19	27.42	1,053.92	-25.96	1.50	-1.50	0.00
5,100.00	1.48	88.510	4,927.11	27.52	1,057.82	-26.06	1.50	-1.50	0.00
5,198.90	0.00	0.000	5,026.00	27.55	1,059.10	-26.09	1.50	-1.50	0.00
Start 1847.04 hold at 5198.90 MD									
5,200.00	0.00	0.000	5,027.10	27.55	1,059.10	-26.09	0.00	0.00	0.00
5,300.00	0.00	0.000	5,127.10	27.55	1,059.10	-26.09	0.00	0.00	0.00
5,400.00	0.00	0.000	5,227.10	27.55	1,059.10	-26.09	0.00	0.00	0.00
5,500.00	0.00	0.000	5,327.10	27.55	1,059.10	-26.09	0.00	0.00	0.00
5,600.00	0.00	0.000	5,427.10	27.55	1,059.10	-26.09	0.00	0.00	0.00
5,700.00	0.00	0.000	5,527.10	27.55	1,059.10	-26.09	0.00	0.00	0.00
5,800.00	0.00	0.000	5,627.10	27.55	1,059.10	-26.09	0.00	0.00	0.00
5,900.00	0.00	0.000	5,727.10	27.55	1,059.10	-26.09	0.00	0.00	0.00
6,000.00	0.00	0.000	5,827.10	27.55	1,059.10	-26.09	0.00	0.00	0.00
6,100.00	0.00	0.000	5,927.10	27.55	1,059.10	-26.09	0.00	0.00	0.00
6,200.00	0.00	0.000	6,027.10	27.55	1,059.10	-26.09	0.00	0.00	0.00
6,300.00	0.00	0.000	6,127.10	27.55	1,059.10	-26.09	0.00	0.00	0.00
6,400.00	0.00	0.000	6,227.10	27.55	1,059.10	-26.09	0.00	0.00	0.00
6,500.00	0.00	0.000	6,327.10	27.55	1,059.10	-26.09	0.00	0.00	0.00
6,600.00	0.00	0.000	6,427.10	27.55	1,059.10	-26.09	0.00	0.00	0.00
6,700.00	0.00	0.000	6,527.10	27.55	1,059.10	-26.09	0.00	0.00	0.00
6,800.00	0.00	0.000	6,627.10	27.55	1,059.10	-26.09	0.00	0.00	0.00
6,900.00	0.00	0.000	6,727.10	27.55	1,059.10	-26.09	0.00	0.00	0.00
7,000.00	0.00	0.000	6,827.10	27.55	1,059.10	-26.09	0.00	0.00	0.00
7,045.94	0.00	0.000	6,873.04	27.55	1,059.10	-26.09	0.00	0.00	0.00
Start DLS 10.00 TFO 179.92									
7,100.00	5.41	179.921	6,927.02	25.00	1,059.10	-23.54	10.00	10.00	0.00
7,200.00	15.41	179.921	7,025.25	6.96	1,059.13	-5.50	10.00	10.00	0.00
7,300.00	25.41	179.921	7,118.86	-27.86	1,059.18	29.32	10.00	10.00	0.00
7,400.00	35.41	179.921	7,204.99	-78.41	1,059.25	79.87	10.00	10.00	0.00
7,500.00	45.41	179.921	7,281.05	-143.15	1,059.33	144.61	10.00	10.00	0.00
7,600.00	55.41	179.921	7,344.70	-220.11	1,059.44	221.57	10.00	10.00	0.00
7,700.00	65.41	179.921	7,394.02	-306.95	1,059.56	308.41	10.00	10.00	0.00
7,800.00	75.41	179.921	7,427.51	-401.04	1,059.69	402.50	10.00	10.00	0.00
7,900.00	85.41	179.921	7,444.16	-499.52	1,059.82	500.98	10.00	10.00	0.00
7,945.94	90.00	179.921	7,446.00	-545.41	1,059.89	546.87	10.00	10.00	0.00
Start 10406.49 hold at 7945.94 MD									
8,000.00	90.00	179.921	7,446.00	-599.47	1,059.96	600.93	0.00	0.00	0.00
8,100.00	90.00	179.921	7,446.00	-699.47	1,060.10	700.93	0.00	0.00	0.00
8,200.00	90.00	179.921	7,446.00	-799.47	1,060.23	800.93	0.00	0.00	0.00
8,300.00	90.00	179.921	7,446.00	-899.47	1,060.37	900.93	0.00	0.00	0.00
8,400.00	90.00	179.921	7,446.00	-999.47	1,060.51	1,000.93	0.00	0.00	0.00
8,500.00	90.00	179.921	7,446.00	-1,099.47	1,060.65	1,100.93	0.00	0.00	0.00
8,600.00	90.00	179.921	7,446.00	-1,199.47	1,060.78	1,200.93	0.00	0.00	0.00
8,700.00	90.00	179.921	7,446.00	-1,299.47	1,060.92	1,300.93	0.00	0.00	0.00
8,800.00	90.00	179.921	7,446.00	-1,399.47	1,061.06	1,400.93	0.00	0.00	0.00
8,900.00	90.00	179.921	7,446.00	-1,499.47	1,061.19	1,500.93	0.00	0.00	0.00
9,000.00	90.00	179.921	7,446.00	-1,599.47	1,061.33	1,600.93	0.00	0.00	0.00
9,100.00	90.00	179.921	7,446.00	-1,699.47	1,061.47	1,700.93	0.00	0.00	0.00

<b>Database:</b>	Casper District	<b>Local Co-ordinate Reference:</b>	Well Fox Creek 12-63-36-1-2N
<b>Company:</b>	HighPoint Resources	<b>TVD Reference:</b>	GL 5412' & KB 20' @ 5432.00ft
<b>Project:</b>	Weld County, CO NAD 83	<b>MD Reference:</b>	GL 5412' & KB 20' @ 5432.00ft
<b>Site:</b>	Fox Creek 25 SW Pad	<b>North Reference:</b>	True
<b>Well:</b>	Fox Creek 12-63-36-1-2N	<b>Survey Calculation Method:</b>	Minimum Curvature
<b>Wellbore:</b>	OH		
<b>Design:</b>	Plan 1		

Planned Survey									
Measured Depth (ft)	Inclination (°)	Azimuth (°)	Vertical Depth (ft)	+N/-S (ft)	+E/-W (ft)	Vertical Section (ft)	Dogleg Rate (°/100ft)	Build Rate (°/100ft)	Turn Rate (°/100ft)
9,200.00	90.00	179.921	7,446.00	-1,799.47	1,061.61	1,800.93	0.00	0.00	0.00
9,300.00	90.00	179.921	7,446.00	-1,899.47	1,061.74	1,900.93	0.00	0.00	0.00
9,400.00	90.00	179.921	7,446.00	-1,999.47	1,061.88	2,000.93	0.00	0.00	0.00
9,500.00	90.00	179.921	7,446.00	-2,099.47	1,062.02	2,100.93	0.00	0.00	0.00
9,600.00	90.00	179.921	7,446.00	-2,199.47	1,062.15	2,200.93	0.00	0.00	0.00
9,700.00	90.00	179.921	7,446.00	-2,299.47	1,062.29	2,300.93	0.00	0.00	0.00
9,800.00	90.00	179.921	7,446.00	-2,399.47	1,062.43	2,400.93	0.00	0.00	0.00
9,900.00	90.00	179.921	7,446.00	-2,499.47	1,062.56	2,500.93	0.00	0.00	0.00
10,000.00	90.00	179.921	7,446.00	-2,599.47	1,062.70	2,600.93	0.00	0.00	0.00
10,100.00	90.00	179.921	7,446.00	-2,699.47	1,062.84	2,700.93	0.00	0.00	0.00
10,200.00	90.00	179.921	7,446.00	-2,799.47	1,062.98	2,800.93	0.00	0.00	0.00
10,300.00	90.00	179.921	7,446.00	-2,899.47	1,063.11	2,900.93	0.00	0.00	0.00
10,400.00	90.00	179.921	7,446.00	-2,999.47	1,063.25	3,000.93	0.00	0.00	0.00
10,500.00	90.00	179.921	7,446.00	-3,099.47	1,063.39	3,100.93	0.00	0.00	0.00
10,600.00	90.00	179.921	7,446.00	-3,199.47	1,063.52	3,200.93	0.00	0.00	0.00
10,700.00	90.00	179.921	7,446.00	-3,299.47	1,063.66	3,300.93	0.00	0.00	0.00
10,800.00	90.00	179.921	7,446.00	-3,399.47	1,063.80	3,400.93	0.00	0.00	0.00
10,900.00	90.00	179.921	7,446.00	-3,499.47	1,063.94	3,500.93	0.00	0.00	0.00
11,000.00	90.00	179.921	7,446.00	-3,599.47	1,064.07	3,600.93	0.00	0.00	0.00
11,100.00	90.00	179.921	7,446.00	-3,699.47	1,064.21	3,700.93	0.00	0.00	0.00
11,200.00	90.00	179.921	7,446.00	-3,799.47	1,064.35	3,800.93	0.00	0.00	0.00
11,300.00	90.00	179.921	7,446.00	-3,899.47	1,064.48	3,900.93	0.00	0.00	0.00
11,400.00	90.00	179.921	7,446.00	-3,999.47	1,064.62	4,000.93	0.00	0.00	0.00
11,500.00	90.00	179.921	7,446.00	-4,099.47	1,064.76	4,100.93	0.00	0.00	0.00
11,600.00	90.00	179.921	7,446.00	-4,199.47	1,064.90	4,200.93	0.00	0.00	0.00
11,700.00	90.00	179.921	7,446.00	-4,299.47	1,065.03	4,300.93	0.00	0.00	0.00
11,800.00	90.00	179.921	7,446.00	-4,399.47	1,065.17	4,400.93	0.00	0.00	0.00
11,900.00	90.00	179.921	7,446.00	-4,499.47	1,065.31	4,500.93	0.00	0.00	0.00
12,000.00	90.00	179.921	7,446.00	-4,599.47	1,065.44	4,600.93	0.00	0.00	0.00
12,100.00	90.00	179.921	7,446.00	-4,699.47	1,065.58	4,700.93	0.00	0.00	0.00
12,200.00	90.00	179.921	7,446.00	-4,799.47	1,065.72	4,800.93	0.00	0.00	0.00
12,300.00	90.00	179.921	7,446.00	-4,899.47	1,065.86	4,900.93	0.00	0.00	0.00
12,400.00	90.00	179.921	7,446.00	-4,999.47	1,065.99	5,000.93	0.00	0.00	0.00
12,500.00	90.00	179.921	7,446.00	-5,099.47	1,066.13	5,100.93	0.00	0.00	0.00
12,600.00	90.00	179.921	7,446.00	-5,199.47	1,066.27	5,200.93	0.00	0.00	0.00
12,700.00	90.00	179.921	7,446.00	-5,299.47	1,066.40	5,300.93	0.00	0.00	0.00
12,800.00	90.00	179.921	7,446.00	-5,399.47	1,066.54	5,400.93	0.00	0.00	0.00
12,900.00	90.00	179.921	7,446.00	-5,499.47	1,066.68	5,500.93	0.00	0.00	0.00
13,000.00	90.00	179.921	7,446.00	-5,599.47	1,066.82	5,600.93	0.00	0.00	0.00
13,100.00	90.00	179.921	7,446.00	-5,699.47	1,066.95	5,700.93	0.00	0.00	0.00
13,200.00	90.00	179.921	7,446.00	-5,799.47	1,067.09	5,800.93	0.00	0.00	0.00
13,300.00	90.00	179.921	7,446.00	-5,899.47	1,067.23	5,900.93	0.00	0.00	0.00
13,400.00	90.00	179.921	7,446.00	-5,999.47	1,067.36	6,000.93	0.00	0.00	0.00
13,500.00	90.00	179.921	7,446.00	-6,099.46	1,067.50	6,100.93	0.00	0.00	0.00
13,600.00	90.00	179.921	7,446.00	-6,199.46	1,067.64	6,200.93	0.00	0.00	0.00
13,700.00	90.00	179.921	7,446.00	-6,299.46	1,067.78	6,300.93	0.00	0.00	0.00
13,800.00	90.00	179.921	7,446.00	-6,399.46	1,067.91	6,400.93	0.00	0.00	0.00
13,900.00	90.00	179.921	7,446.00	-6,499.46	1,068.05	6,500.93	0.00	0.00	0.00
14,000.00	90.00	179.921	7,446.00	-6,599.46	1,068.19	6,600.93	0.00	0.00	0.00
14,100.00	90.00	179.921	7,446.00	-6,699.46	1,068.32	6,700.93	0.00	0.00	0.00
14,200.00	90.00	179.921	7,446.00	-6,799.46	1,068.46	6,800.93	0.00	0.00	0.00
14,300.00	90.00	179.921	7,446.00	-6,899.46	1,068.60	6,900.93	0.00	0.00	0.00
14,400.00	90.00	179.921	7,446.00	-6,999.46	1,068.73	7,000.93	0.00	0.00	0.00
14,500.00	90.00	179.921	7,446.00	-7,099.46	1,068.87	7,100.93	0.00	0.00	0.00

<b>Database:</b>	Casper District	<b>Local Co-ordinate Reference:</b>	Well Fox Creek 12-63-36-1-2N
<b>Company:</b>	HighPoint Resources	<b>TVD Reference:</b>	GL 5412' & KB 20' @ 5432.00ft
<b>Project:</b>	Weld County, CO NAD 83	<b>MD Reference:</b>	GL 5412' & KB 20' @ 5432.00ft
<b>Site:</b>	Fox Creek 25 SW Pad	<b>North Reference:</b>	True
<b>Well:</b>	Fox Creek 12-63-36-1-2N	<b>Survey Calculation Method:</b>	Minimum Curvature
<b>Wellbore:</b>	OH		
<b>Design:</b>	Plan 1		

Planned Survey										
Measured Depth (ft)	Inclination (°)	Azimuth (°)	Vertical Depth (ft)	+N/-S (ft)	+E/-W (ft)	Vertical Section (ft)	Dogleg Rate (°/100ft)	Build Rate (°/100ft)	Turn Rate (°/100ft)	
14,600.00	90.00	179.921	7,446.00	-7,199.46	1,069.01	7,200.93	0.00	0.00	0.00	
14,700.00	90.00	179.921	7,446.00	-7,299.46	1,069.15	7,300.93	0.00	0.00	0.00	
14,800.00	90.00	179.921	7,446.00	-7,399.46	1,069.28	7,400.93	0.00	0.00	0.00	
14,900.00	90.00	179.921	7,446.00	-7,499.46	1,069.42	7,500.93	0.00	0.00	0.00	
15,000.00	90.00	179.921	7,446.00	-7,599.46	1,069.56	7,600.93	0.00	0.00	0.00	
15,100.00	90.00	179.921	7,446.00	-7,699.46	1,069.69	7,700.93	0.00	0.00	0.00	
15,200.00	90.00	179.921	7,446.00	-7,799.46	1,069.83	7,800.93	0.00	0.00	0.00	
15,300.00	90.00	179.921	7,446.00	-7,899.46	1,069.97	7,900.93	0.00	0.00	0.00	
15,400.00	90.00	179.921	7,446.00	-7,999.46	1,070.11	8,000.93	0.00	0.00	0.00	
15,500.00	90.00	179.921	7,446.00	-8,099.46	1,070.24	8,100.93	0.00	0.00	0.00	
15,600.00	90.00	179.921	7,446.00	-8,199.46	1,070.38	8,200.93	0.00	0.00	0.00	
15,700.00	90.00	179.921	7,446.00	-8,299.46	1,070.52	8,300.93	0.00	0.00	0.00	
15,800.00	90.00	179.921	7,446.00	-8,399.46	1,070.65	8,400.93	0.00	0.00	0.00	
15,900.00	90.00	179.921	7,446.00	-8,499.46	1,070.79	8,500.93	0.00	0.00	0.00	
16,000.00	90.00	179.921	7,446.00	-8,599.46	1,070.93	8,600.93	0.00	0.00	0.00	
16,100.00	90.00	179.921	7,446.00	-8,699.46	1,071.07	8,700.93	0.00	0.00	0.00	
16,200.00	90.00	179.921	7,446.00	-8,799.46	1,071.20	8,800.93	0.00	0.00	0.00	
16,300.00	90.00	179.921	7,446.00	-8,899.46	1,071.34	8,900.93	0.00	0.00	0.00	
16,400.00	90.00	179.921	7,446.00	-8,999.46	1,071.48	9,000.93	0.00	0.00	0.00	
16,500.00	90.00	179.921	7,446.00	-9,099.46	1,071.61	9,100.93	0.00	0.00	0.00	
16,600.00	90.00	179.921	7,446.00	-9,199.46	1,071.75	9,200.93	0.00	0.00	0.00	
16,700.00	90.00	179.921	7,446.00	-9,299.46	1,071.89	9,300.93	0.00	0.00	0.00	
16,800.00	90.00	179.921	7,446.00	-9,399.46	1,072.03	9,400.93	0.00	0.00	0.00	
16,900.00	90.00	179.921	7,446.00	-9,499.46	1,072.16	9,500.93	0.00	0.00	0.00	
17,000.00	90.00	179.921	7,446.00	-9,599.46	1,072.30	9,600.93	0.00	0.00	0.00	
17,100.00	90.00	179.921	7,446.00	-9,699.46	1,072.44	9,700.93	0.00	0.00	0.00	
17,200.00	90.00	179.921	7,446.00	-9,799.46	1,072.57	9,800.93	0.00	0.00	0.00	
17,300.00	90.00	179.921	7,446.00	-9,899.46	1,072.71	9,900.93	0.00	0.00	0.00	
17,400.00	90.00	179.921	7,446.00	-9,999.46	1,072.85	10,000.93	0.00	0.00	0.00	
17,500.00	90.00	179.921	7,446.00	-10,099.46	1,072.99	10,100.93	0.00	0.00	0.00	
17,600.00	90.00	179.921	7,446.00	-10,199.46	1,073.12	10,200.93	0.00	0.00	0.00	
17,700.00	90.00	179.921	7,446.00	-10,299.46	1,073.26	10,300.93	0.00	0.00	0.00	
17,800.00	90.00	179.921	7,446.00	-10,399.46	1,073.40	10,400.93	0.00	0.00	0.00	
17,900.00	90.00	179.921	7,446.00	-10,499.46	1,073.53	10,500.93	0.00	0.00	0.00	
18,000.00	90.00	179.921	7,446.00	-10,599.46	1,073.67	10,600.93	0.00	0.00	0.00	
18,100.00	90.00	179.921	7,446.00	-10,699.46	1,073.81	10,700.93	0.00	0.00	0.00	
18,200.00	90.00	179.921	7,446.00	-10,799.46	1,073.94	10,800.93	0.00	0.00	0.00	
18,300.00	90.00	179.921	7,446.00	-10,899.46	1,074.08	10,900.93	0.00	0.00	0.00	
18,352.42	90.00	179.921	7,446.00	-10,951.88	1,074.15	10,953.35	0.00	0.00	0.00	
TD at 18352.42										

<b>Database:</b>	Casper District	<b>Local Co-ordinate Reference:</b>	Well Fox Creek 12-63-36-1-2N
<b>Company:</b>	HighPoint Resources	<b>TVD Reference:</b>	GL 5412' & KB 20' @ 5432.00ft
<b>Project:</b>	Weld County, CO NAD 83	<b>MD Reference:</b>	GL 5412' & KB 20' @ 5432.00ft
<b>Site:</b>	Fox Creek 25 SW Pad	<b>North Reference:</b>	True
<b>Well:</b>	Fox Creek 12-63-36-1-2N	<b>Survey Calculation Method:</b>	Minimum Curvature
<b>Wellbore:</b>	OH		
<b>Design:</b>	Plan 1		

Design Targets									
Target Name	Dip Angle	Dip Dir.	TVD	+N/-S	+E/-W	Northing	Easting	Latitude	Longitude
- hit/miss target	(°)	(°)	(ft)	(ft)	(ft)	(usft)	(usft)		
- Shape									
Fox Creek 12-63-36-1-2	0.00	0.000	7,446.00	-545.41	1,059.89	1,599,255.78	3,308,639.79	40° 58' 22.717 N	104° 22' 56.435 W
- plan hits target center									
- Point									
Fox Creek 12-63-36-1-2	0.00	0.000	7,446.00	-10,951.88	1,074.15	1,588,850.32	3,308,784.77	40° 56' 39.898 N	104° 22' 56.255 W
- plan hits target center									
- Point									

Plan Annotations				
Measured Depth	Vertical Depth	Local Coordinates		Comment
(ft)	(ft)	+N/-S (ft)	+E/-W (ft)	
500.00	500.00	0.00	0.00	Start Build 2.00
750.00	749.68	0.28	10.90	Start 953.95 hold at 750.00 MD
1,703.95	1,700.00	2.45	94.01	Start DLS 2.00 TFO 0.00
2,703.88	2,660.97	9.14	351.40	Start 828.44 hold at 2703.88 MD
3,532.32	3,411.80	18.24	701.38	Start Drop -1.50
5,198.90	5,026.00	27.55	1,059.10	Start 1847.04 hold at 5198.90 MD
7,045.94	6,873.04	27.55	1,059.10	Start DLS 10.00 TFO 179.92
7,945.94	7,446.00	-545.41	1,059.89	Start 10406.49 hold at 7945.94 MD
18,352.42	7,446.00	-10,951.88	1,074.15	TD at 18352.42