

## Well Details: PA 34-23

+N/-S	+E/-W	Northing	Easting	Latitude	Longitude	Slot
0.00	0.00	1616441.40	2304731.10	39.500206	-107.9641840	PA 34-23 (A3)

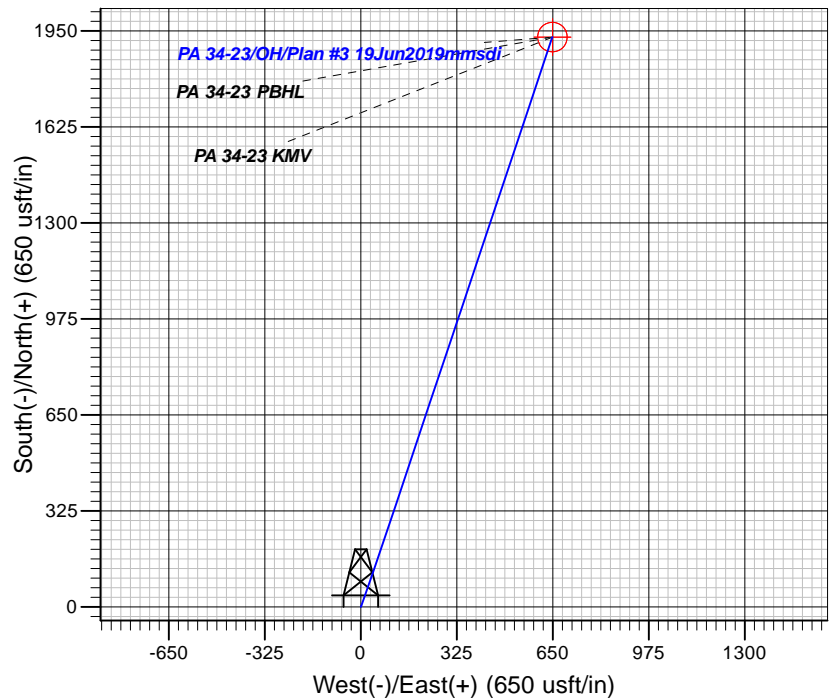
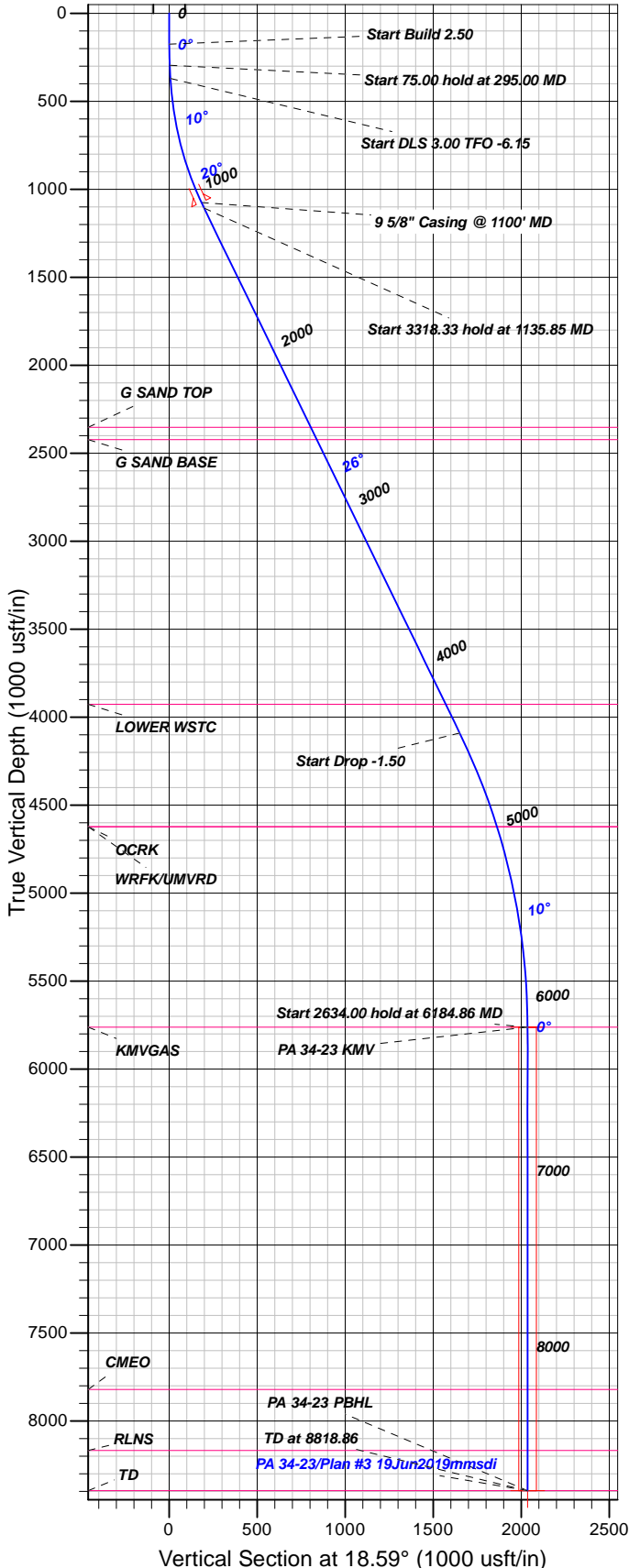

### FORMATION TOP DETAILS

TVDPATH	MDPATH	FORMATION
2353.00	2522.32	G SAND TOP
2423.00	2600.18	G SAND BASE
3927.00	4272.96	LOWER WSTC
4623.00	5028.27	QCRK
4623.00	5028.27	WRFK/UMVRD
5762.00	6184.86	KMGAS
7821.00	8243.86	CMEQ
8168.00	8590.86	RLNS
8395.99	8818.85	TD

Plan: Plan #3 19Jun2019mmsdi

11:53, June 25 2019  
Created By: Mel Mireles

PROJECT DETAILS: Garfield County, CO NAD83

Geodetic System: US State Plane 1983  
Datum: North American Datum 1983  
Ellipsoid: GRS 1980  
Zone: Colorado Central Zone

System Datum: Mean Sea Level

### CASING DETAILS

TVD	MD	Name	Size
1074.05	1100.00	5/8" Casing @ 1100' MD	9.62

### SECTION DETAILS

Sec	MD	Inc	Azi	TVD	+N/-S	+E/-W	Dleg	TFace	Vsect	Target
1	0.00	0.00	0.00	0.00	0.00	0.00	0.00	0.00	0.00	
2	175.00	0.00	0.00	175.00	0.00	0.00	0.00	0.00	0.00	
3	295.00	3.00	24.00	294.95	2.87	1.28	2.50	24.00	3.13	
4	370.00	3.00	24.00	369.84	6.46	2.87	0.00	0.00	7.03	
5	1135.85	25.96	18.51	1106.43	186.13	65.09	3.00	-6.15	197.17	
6	4454.18	25.96	18.51	4089.93	1563.54	526.34	0.00	0.00	1649.75	
7	6184.86	0.00	0.00	5762.00	1929.00	648.72	1.50	180.00	2035.16	PA 34-23 KMV
8	8818.86	0.00	0.00	8396.00	1929.00	648.72	0.00	0.00	2035.16	PA 34-23 PBHL

### DESIGN TARGET DETAILS

Name	TVD	+N/-S	+E/-W	Northing	Easting	Latitude	Longitude	Shape
PA 34-23 KMV	5762.00	1929.00	648.72	1618352.10	2305431.90	39.5053166	-107.9618849	Circle (Radius: 50.00)
- plan hits target center								
PA 34-23 PBHL	8396.00	1929.00	648.72	1618352.10	2305431.90	39.5053166	-107.9618849	Point
- plan hits target center								



# **TEP Rocky Mountain LLC**

**Garfield County, CO NAD83**

**PA 31-26 Pad**

**PA 34-23 - Slot PA 34-23 (A3)**

**OH**

**Plan: Plan #3 19Jun2019mmsdi**

## **Standard Planning Report**

**25 June, 2019**



<b>Database:</b>	Grand Junction District	<b>Local Co-ordinate Reference:</b>	Well PA 34-23 - Slot PA 34-23 (A3)
<b>Company:</b>	TEP Rocky Mountain LLC	<b>TVD Reference:</b>	GL 5486' & RKB 24' @ 5510.00usft
<b>Project:</b>	Garfield County, CO NAD83	<b>MD Reference:</b>	GL 5486' & RKB 24' @ 5510.00usft
<b>Site:</b>	PA 31-26 Pad	<b>North Reference:</b>	True
<b>Well:</b>	PA 34-23	<b>Survey Calculation Method:</b>	Minimum Curvature
<b>Wellbore:</b>	OH		
<b>Design:</b>	Plan #3 19Jun2019mmsdi		

<b>Project</b>	Garfield County, CO NAD83		
<b>Map System:</b>	US State Plane 1983	<b>System Datum:</b>	Mean Sea Level
<b>Geo Datum:</b>	North American Datum 1983		
<b>Map Zone:</b>	Colorado Central Zone		

<b>Site</b>	PA 31-26 Pad			
<b>Site Position:</b>		<b>Northing:</b>	1,616,455.80 usft	<b>Latitude:</b> 39.5000599
<b>From:</b> Map		<b>Easting:</b>	2,304,726.80 usft	<b>Longitude:</b> -107.9642007
<b>Position Uncertainty:</b>	0.00 usft	<b>Slot Radius:</b>	13.20 in	<b>Grid Convergence:</b> -1.55 °

<b>Well</b>	PA 34-23 - Slot PA 34-23 (A3)			
<b>Well Position</b>	<b>+N/-S</b>	-14.28 usft	<b>Northing:</b>	1,616,441.40 usft
	<b>+E/-W</b>	4.69 usft	<b>Easting:</b>	2,304,731.10 usft
<b>Position Uncertainty</b>	0.00 usft		<b>Wellhead Elevation:</b>	0.00 usft
			<b>Ground Level:</b>	5,486.00 usft

<b>Wellbore</b>	OH				
<b>Magnetics</b>	<b>Model Name</b>	<b>Sample Date</b>	<b>Declination (°)</b>	<b>Dip Angle (°)</b>	<b>Field Strength (nT)</b>
	HDGM	2/26/2018	9.40	65.77	51,650

<b>Design</b>	Plan #3 19Jun2019mmsdi			
<b>Audit Notes:</b>				
<b>Version:</b>	<b>Phase:</b>	PLAN	<b>Tie On Depth:</b>	0.00
<b>Vertical Section:</b>	<b>Depth From (TVD) (usft)</b>	<b>+N/-S (usft)</b>	<b>+E/-W (usft)</b>	<b>Direction (°)</b>
	0.00	0.00	0.00	18.59

<b>Plan Sections</b>										
Measured Depth (usft)	Inclination (°)	Azimuth (°)	Vertical Depth (usft)	+N/-S (usft)	+E/-W (usft)	Dogleg Rate (°/100usft)	Build Rate (°/100usft)	Turn Rate (°/100usft)	TFO (°)	Target
0.00	0.00	0.00	0.00	0.00	0.00	0.00	0.00	0.00	0.00	
175.00	0.00	0.00	175.00	0.00	0.00	0.00	0.00	0.00	0.00	
295.00	3.00	24.00	294.95	2.87	1.28	2.50	2.50	0.00	24.00	
370.00	3.00	24.00	369.84	6.46	2.87	0.00	0.00	0.00	0.00	
1,135.85	25.96	18.51	1,106.43	186.13	65.09	3.00	3.00	-0.72	-6.15	
4,454.18	25.96	18.51	4,089.93	1,563.54	526.34	0.00	0.00	0.00	0.00	
6,184.86	0.00	0.00	5,762.00	1,929.00	648.72	1.50	-1.50	0.00	180.00	PA 34-23 KMV
8,818.86	0.00	0.00	8,396.00	1,929.00	648.72	0.00	0.00	0.00	0.00	PA 34-23 PBHL

<b>Database:</b>	Grand Junction District	<b>Local Co-ordinate Reference:</b>	Well PA 34-23 - Slot PA 34-23 (A3)
<b>Company:</b>	TEP Rocky Mountain LLC	<b>TVD Reference:</b>	GL 5486' & RKB 24' @ 5510.00usft
<b>Project:</b>	Garfield County, CO NAD83	<b>MD Reference:</b>	GL 5486' & RKB 24' @ 5510.00usft
<b>Site:</b>	PA 31-26 Pad	<b>North Reference:</b>	True
<b>Well:</b>	PA 34-23	<b>Survey Calculation Method:</b>	Minimum Curvature
<b>Wellbore:</b>	OH		
<b>Design:</b>	Plan #3 19Jun2019mmsdi		

Planned Survey									
Measured Depth (usft)	Inclination (°)	Azimuth (°)	Vertical Depth (usft)	+N/-S (usft)	+E/-W (usft)	Vertical Section (usft)	Dogleg Rate (°/100usft)	Build Rate (°/100usft)	Turn Rate (°/100usft)
0.00	0.00	0.00	0.00	0.00	0.00	0.00	0.00	0.00	0.00
100.00	0.00	0.00	100.00	0.00	0.00	0.00	0.00	0.00	0.00
175.00	0.00	0.00	175.00	0.00	0.00	0.00	0.00	0.00	0.00
<b>Start Build 2.50</b>									
200.00	0.63	24.00	200.00	0.12	0.06	0.14	2.50	2.50	0.00
295.00	3.00	24.00	294.95	2.87	1.28	3.13	2.50	2.50	0.00
<b>Start 75.00 hold at 295.00 MD</b>									
300.00	3.00	24.00	299.94	3.11	1.38	3.39	0.00	0.00	0.00
370.00	3.00	24.00	369.84	6.46	2.87	7.03	0.00	0.00	0.00
<b>Start DLS 3.00 TFO -6.15</b>									
400.00	3.90	22.58	399.79	8.11	3.58	8.83	3.00	2.99	-4.73
500.00	6.89	20.52	499.33	16.87	6.99	18.22	3.00	2.99	-2.06
600.00	9.89	19.70	598.25	30.57	11.99	32.80	3.00	3.00	-0.82
700.00	12.89	19.26	696.27	49.19	18.56	52.54	3.00	3.00	-0.44
800.00	15.89	18.98	793.13	72.66	26.70	77.38	3.00	3.00	-0.28
900.00	18.89	18.79	888.55	100.93	36.36	107.26	3.00	3.00	-0.19
1,000.00	21.88	18.65	982.27	133.92	47.54	142.09	3.00	3.00	-0.14
1,100.00	24.88	18.55	1,074.05	171.53	60.20	181.77	3.00	3.00	-0.11
<b>9 5/8" Casing @ 1100' MD</b>									
1,135.85	25.96	18.51	1,106.43	186.13	65.09	197.17	3.00	3.00	-0.09
<b>Start 3318.33 hold at 1135.85 MD</b>									
1,200.00	25.96	18.51	1,164.10	212.75	74.00	225.25	0.00	0.00	0.00
1,300.00	25.96	18.51	1,254.01	254.26	87.90	269.02	0.00	0.00	0.00
1,400.00	25.96	18.51	1,343.92	295.77	101.80	312.79	0.00	0.00	0.00
1,500.00	25.96	18.51	1,433.83	337.28	115.70	356.57	0.00	0.00	0.00
1,600.00	25.96	18.51	1,523.74	378.79	129.61	400.34	0.00	0.00	0.00
1,700.00	25.96	18.51	1,613.65	420.30	143.51	444.12	0.00	0.00	0.00
1,800.00	25.96	18.51	1,703.56	461.81	157.41	487.89	0.00	0.00	0.00
1,900.00	25.96	18.51	1,793.47	503.32	171.31	531.67	0.00	0.00	0.00
2,000.00	25.96	18.51	1,883.38	544.83	185.21	575.44	0.00	0.00	0.00
2,100.00	25.96	18.51	1,973.29	586.34	199.11	619.22	0.00	0.00	0.00
2,200.00	25.96	18.51	2,063.20	627.85	213.01	662.99	0.00	0.00	0.00
2,300.00	25.96	18.51	2,153.11	669.35	226.91	706.77	0.00	0.00	0.00
2,400.00	25.96	18.51	2,243.02	710.86	240.81	750.54	0.00	0.00	0.00
2,500.00	25.96	18.51	2,332.93	752.37	254.71	794.32	0.00	0.00	0.00
2,522.32	25.96	18.51	2,353.00	761.64	257.81	804.09	0.00	0.00	0.00
<b>G SAND TOP</b>									
2,600.00	25.96	18.51	2,422.84	793.88	268.61	838.09	0.00	0.00	0.00
2,600.18	25.96	18.51	2,423.00	793.95	268.63	838.17	0.00	0.00	0.00
<b>G SAND BASE</b>									
2,700.00	25.96	18.51	2,512.75	835.39	282.51	881.86	0.00	0.00	0.00
2,800.00	25.96	18.51	2,602.66	876.90	296.41	925.64	0.00	0.00	0.00
2,900.00	25.96	18.51	2,692.57	918.41	310.31	969.41	0.00	0.00	0.00
3,000.00	25.96	18.51	2,782.48	959.92	324.21	1,013.19	0.00	0.00	0.00
3,100.00	25.96	18.51	2,872.39	1,001.43	338.11	1,056.96	0.00	0.00	0.00
3,200.00	25.96	18.51	2,962.30	1,042.94	352.01	1,100.74	0.00	0.00	0.00
3,300.00	25.96	18.51	3,052.21	1,084.45	365.91	1,144.51	0.00	0.00	0.00
3,400.00	25.96	18.51	3,142.12	1,125.95	379.81	1,188.29	0.00	0.00	0.00
3,500.00	25.96	18.51	3,232.03	1,167.46	393.71	1,232.06	0.00	0.00	0.00
3,600.00	25.96	18.51	3,321.94	1,208.97	407.61	1,275.84	0.00	0.00	0.00
3,700.00	25.96	18.51	3,411.85	1,250.48	421.51	1,319.61	0.00	0.00	0.00
3,800.00	25.96	18.51	3,501.76	1,291.99	435.41	1,363.39	0.00	0.00	0.00
3,900.00	25.96	18.51	3,591.67	1,333.50	449.31	1,407.16	0.00	0.00	0.00

<b>Database:</b>	Grand Junction District	<b>Local Co-ordinate Reference:</b>	Well PA 34-23 - Slot PA 34-23 (A3)
<b>Company:</b>	TEP Rocky Mountain LLC	<b>TVD Reference:</b>	GL 5486' & RKB 24' @ 5510.00usft
<b>Project:</b>	Garfield County, CO NAD83	<b>MD Reference:</b>	GL 5486' & RKB 24' @ 5510.00usft
<b>Site:</b>	PA 31-26 Pad	<b>North Reference:</b>	True
<b>Well:</b>	PA 34-23	<b>Survey Calculation Method:</b>	Minimum Curvature
<b>Wellbore:</b>	OH		
<b>Design:</b>	Plan #3 19Jun2019mmsdi		

Planned Survey									
Measured Depth (usft)	Inclination (°)	Azimuth (°)	Vertical Depth (usft)	+N/-S (usft)	+E/-W (usft)	Vertical Section (usft)	Dogleg Rate (°/100usft)	Build Rate (°/100usft)	Turn Rate (°/100usft)
4,000.00	25.96	18.51	3,681.58	1,375.01	463.21	1,450.93	0.00	0.00	0.00
4,100.00	25.96	18.51	3,771.49	1,416.52	477.11	1,494.71	0.00	0.00	0.00
4,200.00	25.96	18.51	3,861.40	1,458.03	491.01	1,538.48	0.00	0.00	0.00
4,272.96	25.96	18.51	3,927.00	1,488.31	501.15	1,570.42	0.00	0.00	0.00
LOWER WSTC									
4,300.00	25.96	18.51	3,951.31	1,499.54	504.91	1,582.26	0.00	0.00	0.00
4,400.00	25.96	18.51	4,041.22	1,541.05	518.81	1,626.03	0.00	0.00	0.00
4,454.18	25.96	18.51	4,089.93	1,563.54	526.34	1,649.75	0.00	0.00	0.00
Start Drop -1.50									
4,500.00	25.27	18.51	4,131.25	1,582.32	532.63	1,669.56	1.50	-1.50	0.00
4,600.00	23.77	18.51	4,222.23	1,621.68	545.81	1,711.06	1.50	-1.50	0.00
4,700.00	22.27	18.51	4,314.26	1,658.76	558.23	1,750.17	1.50	-1.50	0.00
4,800.00	20.77	18.51	4,407.28	1,693.55	569.88	1,786.86	1.50	-1.50	0.00
4,900.00	19.27	18.51	4,501.24	1,726.02	580.75	1,821.10	1.50	-1.50	0.00
5,000.00	17.77	18.51	4,596.05	1,756.14	590.83	1,852.86	1.50	-1.50	0.00
5,028.27	17.35	18.51	4,623.00	1,764.23	593.54	1,861.39	1.50	-1.50	0.00
OCRK - WRFK/UMVRD									
5,100.00	16.27	18.51	4,691.67	1,783.90	600.13	1,882.14	1.50	-1.50	0.00
5,200.00	14.77	18.51	4,788.02	1,809.27	608.63	1,908.90	1.50	-1.50	0.00
5,300.00	13.27	18.51	4,885.03	1,832.25	616.32	1,933.13	1.50	-1.50	0.00
5,400.00	11.77	18.51	4,982.65	1,852.81	623.21	1,954.81	1.50	-1.50	0.00
5,500.00	10.27	18.51	5,080.81	1,870.94	629.28	1,973.93	1.50	-1.50	0.00
5,600.00	8.77	18.51	5,179.42	1,886.63	634.53	1,990.48	1.50	-1.50	0.00
5,700.00	7.27	18.51	5,278.44	1,899.86	638.96	2,004.43	1.50	-1.50	0.00
5,800.00	5.77	18.51	5,377.79	1,910.63	642.57	2,015.79	1.50	-1.50	0.00
5,900.00	4.27	18.51	5,477.41	1,918.94	645.35	2,024.55	1.50	-1.50	0.00
6,000.00	2.77	18.51	5,577.21	1,924.76	647.30	2,030.69	1.50	-1.50	0.00
6,100.00	1.27	18.51	5,677.15	1,928.11	648.42	2,034.22	1.50	-1.50	0.00
6,184.86	0.00	0.00	5,762.00	1,929.00	648.72	2,035.16	1.50	-1.50	0.00
Start 2634.00 hold at 6184.86 MD - KMGAS - PA 34-23 KMW									
6,200.00	0.00	0.00	5,777.14	1,929.00	648.72	2,035.16	0.00	0.00	0.00
6,300.00	0.00	0.00	5,877.14	1,929.00	648.72	2,035.16	0.00	0.00	0.00
6,400.00	0.00	0.00	5,977.14	1,929.00	648.72	2,035.16	0.00	0.00	0.00
6,500.00	0.00	0.00	6,077.14	1,929.00	648.72	2,035.16	0.00	0.00	0.00
6,600.00	0.00	0.00	6,177.14	1,929.00	648.72	2,035.16	0.00	0.00	0.00
6,700.00	0.00	0.00	6,277.14	1,929.00	648.72	2,035.16	0.00	0.00	0.00
6,800.00	0.00	0.00	6,377.14	1,929.00	648.72	2,035.16	0.00	0.00	0.00
6,900.00	0.00	0.00	6,477.14	1,929.00	648.72	2,035.16	0.00	0.00	0.00
7,000.00	0.00	0.00	6,577.14	1,929.00	648.72	2,035.16	0.00	0.00	0.00
7,100.00	0.00	0.00	6,677.14	1,929.00	648.72	2,035.16	0.00	0.00	0.00
7,200.00	0.00	0.00	6,777.14	1,929.00	648.72	2,035.16	0.00	0.00	0.00
7,300.00	0.00	0.00	6,877.14	1,929.00	648.72	2,035.16	0.00	0.00	0.00
7,400.00	0.00	0.00	6,977.14	1,929.00	648.72	2,035.16	0.00	0.00	0.00
7,500.00	0.00	0.00	7,077.14	1,929.00	648.72	2,035.16	0.00	0.00	0.00
7,600.00	0.00	0.00	7,177.14	1,929.00	648.72	2,035.16	0.00	0.00	0.00
7,700.00	0.00	0.00	7,277.14	1,929.00	648.72	2,035.16	0.00	0.00	0.00
7,800.00	0.00	0.00	7,377.14	1,929.00	648.72	2,035.16	0.00	0.00	0.00
7,900.00	0.00	0.00	7,477.14	1,929.00	648.72	2,035.16	0.00	0.00	0.00
8,000.00	0.00	0.00	7,577.14	1,929.00	648.72	2,035.16	0.00	0.00	0.00
8,100.00	0.00	0.00	7,677.14	1,929.00	648.72	2,035.16	0.00	0.00	0.00
8,200.00	0.00	0.00	7,777.14	1,929.00	648.72	2,035.16	0.00	0.00	0.00
8,243.86	0.00	0.00	7,821.00	1,929.00	648.72	2,035.16	0.00	0.00	0.00
CME0									
8,300.00	0.00	0.00	7,877.14	1,929.00	648.72	2,035.16	0.00	0.00	0.00

<b>Database:</b>	Grand Junction District	<b>Local Co-ordinate Reference:</b>	Well PA 34-23 - Slot PA 34-23 (A3)
<b>Company:</b>	TEP Rocky Mountain LLC	<b>TVD Reference:</b>	GL 5486' & RKB 24' @ 5510.00usft
<b>Project:</b>	Garfield County, CO NAD83	<b>MD Reference:</b>	GL 5486' & RKB 24' @ 5510.00usft
<b>Site:</b>	PA 31-26 Pad	<b>North Reference:</b>	True
<b>Well:</b>	PA 34-23	<b>Survey Calculation Method:</b>	Minimum Curvature
<b>Wellbore:</b>	OH		
<b>Design:</b>	Plan #3 19Jun2019mmsdi		

Planned Survey									
Measured Depth (usft)	Inclination (°)	Azimuth (°)	Vertical Depth (usft)	+N/-S (usft)	+E/-W (usft)	Vertical Section (usft)	Dogleg Rate (°/100usft)	Build Rate (°/100usft)	Turn Rate (°/100usft)
8,400.00	0.00	0.00	7,977.14	1,929.00	648.72	2,035.16	0.00	0.00	0.00
8,500.00	0.00	0.00	8,077.14	1,929.00	648.72	2,035.16	0.00	0.00	0.00
8,590.86	0.00	0.00	8,168.00	1,929.00	648.72	2,035.16	0.00	0.00	0.00
<b>RLNS</b>									
8,600.00	0.00	0.00	8,177.14	1,929.00	648.72	2,035.16	0.00	0.00	0.00
8,700.00	0.00	0.00	8,277.14	1,929.00	648.72	2,035.16	0.00	0.00	0.00
8,800.00	0.00	0.00	8,377.14	1,929.00	648.72	2,035.16	0.00	0.00	0.00
8,818.85	0.00	0.00	8,395.99	1,929.00	648.72	2,035.16	0.00	0.00	0.00
<b>TD</b>									
8,818.86	0.00	0.00	8,396.00	1,929.00	648.72	2,035.16	0.00	0.00	0.00
<b>TD at 8818.86 - PA 34-23 PBHL</b>									

Design Targets									
Target Name	Dip Angle (°)	Dip Dir. (°)	TVD (usft)	+N/-S (usft)	+E/-W (usft)	Northing (usft)	Easting (usft)	Latitude	Longitude
PA 34-23 KMV	0.00	0.00	5,762.00	1,929.00	648.72	1,618,352.10	2,305,431.90	39.5053166	-107.9618850
- hit/miss target									
- plan hits target center									
- Circle (radius 50.00)									
PA 34-23 PBHL	0.00	0.00	8,396.00	1,929.00	648.72	1,618,352.10	2,305,431.90	39.5053166	-107.9618850
- plan hits target center									
- Point									

Casing Points					
Measured Depth (usft)	Vertical Depth (usft)	Name	Casing Diameter (in)	Hole Diameter (in)	
1,100.00	1,074.05	9 5/8" Casing @ 1100' MD	9.62	13.50	

Formations					
Measured Depth (usft)	Vertical Depth (usft)	Name	Lithology	Dip (°)	Dip Direction (°)
2,522.32	2,353.00	G SAND TOP		0.00	0.00
2,600.18	2,423.00	G SAND BASE		0.00	0.00
4,272.96	3,927.00	LOWER WSTC		0.00	0.00
5,028.27	4,623.00	OCRK		0.00	0.00
5,028.27	4,623.00	WRFK/UMVRD		0.00	0.00
6,184.86	5,762.00	KMVGAS		0.00	0.00
8,243.86	7,821.00	CMEO		0.00	0.00
8,590.86	8,168.00	RLNS		0.00	0.00
8,818.85	8,395.99	TD		0.00	0.00

<b>Database:</b>	Grand Junction District	<b>Local Co-ordinate Reference:</b>	Well PA 34-23 - Slot PA 34-23 (A3)
<b>Company:</b>	TEP Rocky Mountain LLC	<b>TVD Reference:</b>	GL 5486' & RKB 24' @ 5510.00usft
<b>Project:</b>	Garfield County, CO NAD83	<b>MD Reference:</b>	GL 5486' & RKB 24' @ 5510.00usft
<b>Site:</b>	PA 31-26 Pad	<b>North Reference:</b>	True
<b>Well:</b>	PA 34-23	<b>Survey Calculation Method:</b>	Minimum Curvature
<b>Wellbore:</b>	OH		
<b>Design:</b>	Plan #3 19Jun2019mmsdi		

Plan Annotations				
Measured Depth (usft)	Vertical Depth (usft)	Local Coordinates		Comment
		+N/-S (usft)	+E/-W (usft)	
175.00	175.00	0.00	0.00	Start Build 2.50
295.00	294.95	2.87	1.28	Start 75.00 hold at 295.00 MD
370.00	369.84	6.46	2.87	Start DLS 3.00 TFO -6.15
1,135.85	1,106.43	186.13	65.09	Start 3318.33 hold at 1135.85 MD
4,454.18	4,089.93	1,563.54	526.34	Start Drop -1.50
6,184.86	5,762.00	1,929.00	648.72	Start 2634.00 hold at 6184.86 MD
8,818.86	8,396.00	1,929.00	648.72	TD at 8818.86