



RECEIVED

JAN - 5 1967

R. 68W

COLO. OIL & GAS CONS. COMM.

JAN 8 1967

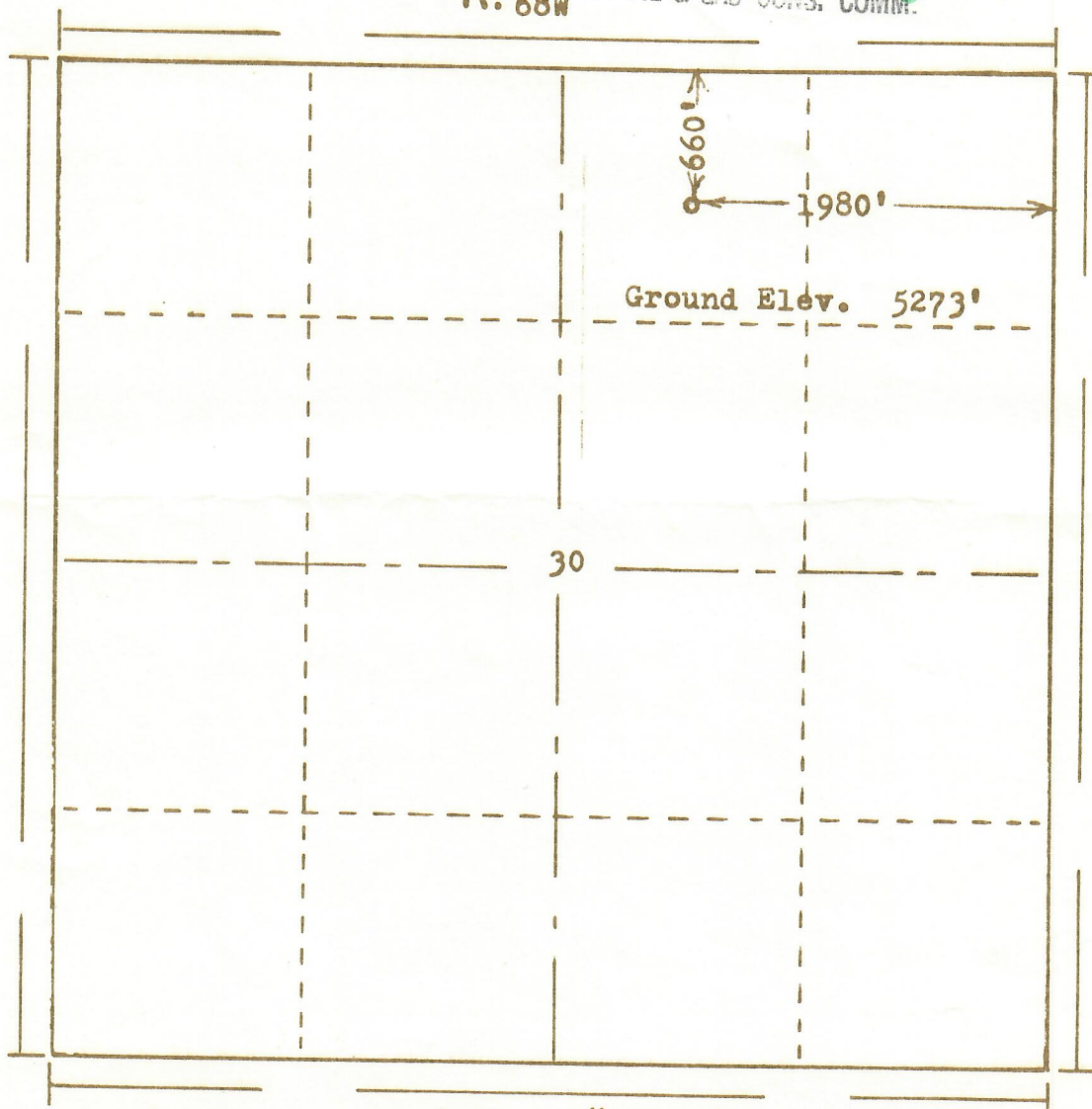

T.
9
N

Scale ... 1" = 1000'

Powers Surveyors, Inc. of Denver, Colorado
has in accordance with a request from Florence Johnston
for Stuarco Oil Co., Inc. determined the
Location of No. 1 Bremer
to be CNW NE Section 30 Township 9N
Range 68W of the 6th Principal Meridian
Larimer County, Colorado

I hereby certify that this plat is an
accurate representation of a correct
survey showing the location of

Date: 12-27-66

B. J. Holloway
Licensed Land Surveyor No. 2853
State of Colorado