

Location:	COLORADO	Slot:	SLOT#02 SALT RANCH FEE 506-1035H (357'FNL & 607'FEL, SEC. 10)
Field:	WELD COUNTY (NAD 83/TN)	Well:	SALT RANCH FEE 506-1035H
Facility:	SEC.10-T11N-R64W	Wellbore:	SALT RANCH FEE 506-1035H PWB
Plot reference wellpath is SALT RANCH FEE 506-1035H (REV-D.0) PWP		Grid System: NAD83 / Lambert Colorado SP, Northern Zone (501), US feet	
True vertical depths are referenced to RIG (22KB) (RKB)		* = Wellpath was transformed from a different geodetic datum	
Measured depths are referenced to RIG (22KB) (RKB)		North Reference: True north	
RIG (22KB) (RKB) to Mean Sea Level: 5456 feet		Scale: True distance	
Mean Sea Level to Mud line (At Slot: SLOT#02 SALT RANCH FEE 506-1035H (357'FNL & 607'FEL, SEC.10)): 0 feet		Depths are in feet	
Coordinates are in feet referenced to Slot		Created by: adamkatt on 2019-05-08	
		Database: Denver	

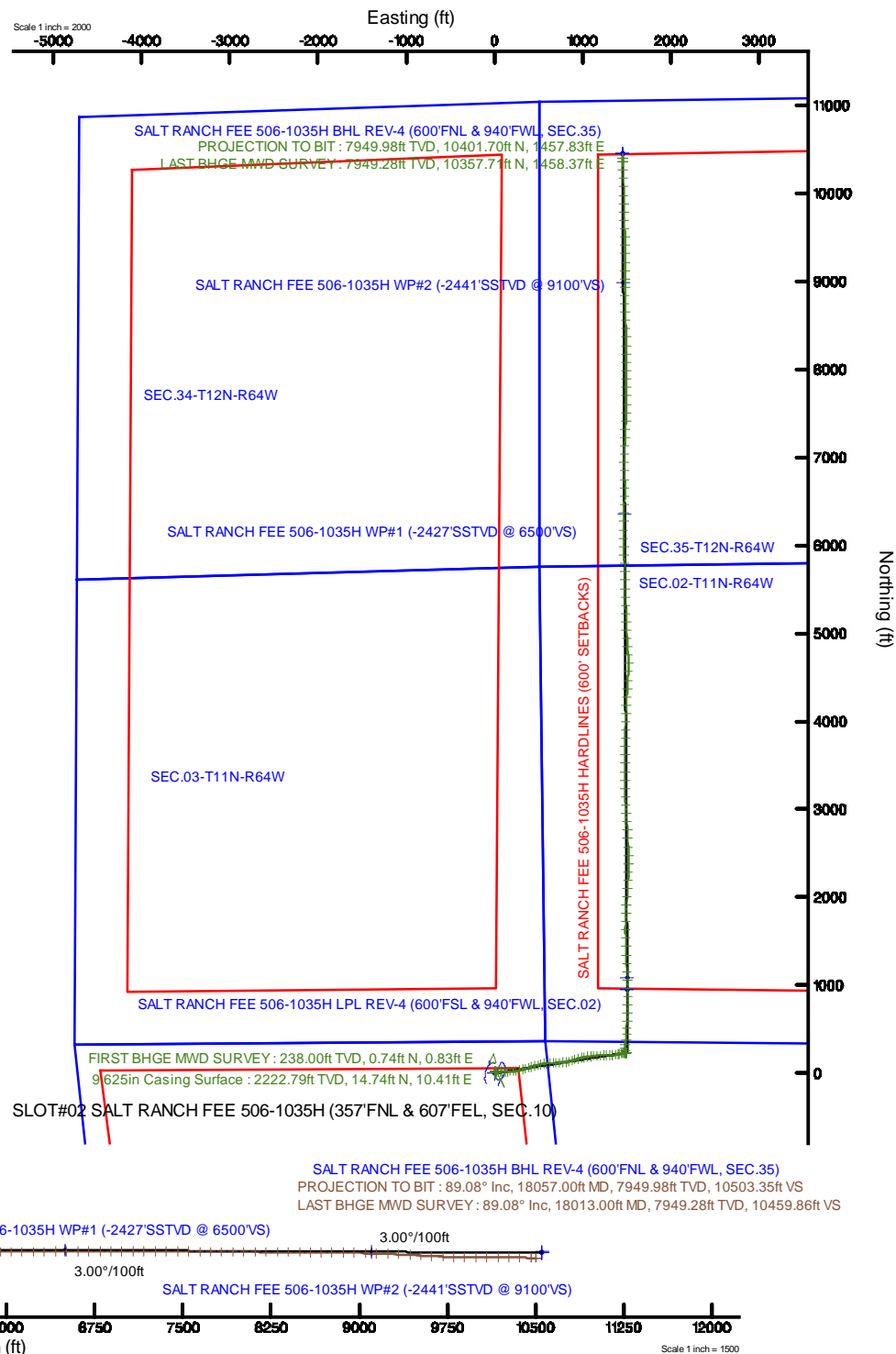

# Actual Wellpath Report

SALT RANCH FEE 506-1035H AWP

Page 1 of 9

REFERENCE WELLPATH IDENTIFICATION			
Operator	CCRP OPERATING INC.	Slot	SLOT#02 SALT RANCH FEE 506-1035H (357'FNL & 607'FEL, SEC.10)
Area	COLORADO	Well	SALT RANCH FEE 506-1035H
Field	WELD COUNTY (NAD 83/TN)	Wellbore	SALT RANCH FEE 506-1035H AWP
Facility	SEC.10-T11N-R64W		

REPORT SETUP INFORMATION			
Projection System	NAD83 / Lambert Colorado SP, Northern Zone (501), US feet	Software System	WellArchitect® 5.0
North Reference	True	User	Adamkat
Scale	1.000030	Report Generated	5/8/2019 at 1:51:57 PM
Convergence at slot	0.63° East	Database/Source file	Denver/SALT_RANCH_FEE_506-1035H_AWP.xml

WELLPATH LOCATION						
	Local coordinates		Grid coordinates		Geographic coordinates	
	North[ft]	East[ft]	Easting[US ft]	Northing[US ft]	Latitude	Longitude
Slot Location	0.00	0.00	3269150.08	1587572.09	40°56'31.888"N	104°31'32.869"W
Facility Reference Pt			3269150.08	1587572.09	40°56'31.888"N	104°31'32.869"W
Field Reference Pt			3242001.26	1607883.12	40°59'55.356"N	104°37'23.988"W

WELLPATH DATUM			
Calculation method	Minimum curvature	RIG (22'KB) (RKB) to Facility Vertical Datum	5456.00ft
Horizontal Reference Pt	Slot	RIG (22'KB) (RKB) to Mean Sea Level	5456.00ft
Vertical Reference Pt	RIG (22'KB) (RKB)	RIG (22'KB) (RKB) to Mud Line at Slot (SLOT#02 SALT RANCH FEE 506-1035H (357'FNL & 607'FEL, SEC.10))	5456.00ft
MD Reference Pt	RIG (22'KB) (RKB)	Section Origin	N 0.00, E 0.00 ft
Field Vertical Reference	Mean Sea Level	Section Azimuth	7.92°

# Actual Wellpath Report

SALT RANCH FEE 506-1035H AWP

Page 2 of 9

## REFERENCE WELLPATH IDENTIFICATION

Operator	CCRP OPERATING INC.	Slot	SLOT#02 SALT RANCH FEE 506-1035H (357'FNL & 607'FEL, SEC.10)
Area	COLORADO	Well	SALT RANCH FEE 506-1035H
Field	WELD COUNTY (NAD 83/TN)	Wellbore	SALT RANCH FEE 506-1035H AWP
Facility	SEC.10-T11N-R64W		

## WELLPATH DATA (178 stations) † = interpolated/extrapolated station

MD [ft]	Inclination [°]	Azimuth [°]	TVD [ft]	Vert Sect [ft]	North [ft]	East [ft]	Grid East [US ft]	Grid North [US ft]	Latitude	Longitude	DLS [°/100ft]	Comments
0.00†	0.000	48.330	0.00	0.00	0.00	0.00	3269150.08	1587572.09	40°56'31.888"N	104°31'32.869"W	0.00	
22.00	0.000	48.330	22.00	0.00	0.00	0.00	3269150.08	1587572.09	40°56'31.888"N	104°31'32.869"W	0.00	
238.00	0.590	48.330	238.00	0.85	0.74	0.83	3269150.90	1587572.84	40°56'31.895"N	104°31'32.858"W	0.27	FIRST BHGE MWD SURVEY
521.00	0.360	54.910	520.99	2.56	2.22	2.65	3269152.70	1587574.34	40°56'31.910"N	104°31'32.835"W	0.08	
805.00	0.590	26.890	804.98	4.55	4.04	4.04	3269154.07	1587576.17	40°56'31.928"N	104°31'32.816"W	0.11	
1092.00	0.430	17.980	1091.97	7.01	6.38	5.04	3269155.05	1587578.52	40°56'31.951"N	104°31'32.803"W	0.06	
1379.00	0.730	0.473	1378.95	9.89	9.23	5.39	3269155.36	1587581.38	40°56'31.979"N	104°31'32.799"W	0.12	
1665.00	0.440	323.150	1664.94	12.47	11.93	4.74	3269154.69	1587584.07	40°56'32.006"N	104°31'32.807"W	0.16	
1952.00	0.460	313.040	1951.93	13.92	13.60	3.24	3269153.17	1587585.72	40°56'32.022"N	104°31'32.827"W	0.03	
2047.00	1.100	89.480	2046.92	14.27	13.87	3.87	3269153.80	1587586.00	40°56'32.025"N	104°31'32.819"W	1.55	
2143.00	2.560	81.160	2142.87	15.02	14.21	6.91	3269156.83	1587586.37	40°56'32.028"N	104°31'32.779"W	1.54	
2264.00	2.480	81.600	2263.75	16.54	15.00	12.17	3269162.09	1587587.23	40°56'32.036"N	104°31'32.710"W	0.07	
2359.00	3.540	85.150	2358.62	17.76	15.55	17.13	3269167.04	1587587.83	40°56'32.042"N	104°31'32.646"W	1.13	
2454.00	5.610	83.220	2453.31	19.59	16.35	24.66	3269174.56	1587588.71	40°56'32.050"N	104°31'32.548"W	2.18	
2643.00	9.270	89.030	2640.69	24.29	17.70	49.07	3269198.95	1587590.33	40°56'32.063"N	104°31'32.230"W	1.97	
2738.00	11.000	89.090	2734.21	26.87	17.97	65.78	3269215.66	1587590.78	40°56'32.066"N	104°31'32.012"W	1.82	
2831.00	12.450	89.160	2825.26	29.75	18.26	84.68	3269234.55	1587591.28	40°56'32.068"N	104°31'31.766"W	1.56	
2926.00	13.810	88.070	2917.78	33.25	18.79	106.25	3269256.12	1587592.05	40°56'32.074"N	104°31'31.485"W	1.46	
3020.00	15.150	88.640	3008.79	37.16	19.46	129.74	3269279.60	1587592.97	40°56'32.080"N	104°31'31.178"W	1.43	
3115.00	16.670	87.400	3100.15	41.65	20.37	155.77	3269305.61	1587594.17	40°56'32.089"N	104°31'30.839"W	1.64	
3209.00	18.480	87.420	3189.76	46.82	21.66	184.12	3269333.95	1587595.77	40°56'32.102"N	104°31'30.470"W	1.93	
3302.00	20.990	87.870	3277.29	52.42	22.94	215.49	3269365.31	1587597.39	40°56'32.115"N	104°31'30.061"W	2.70	
3397.00	22.290	81.550	3365.60	60.47	26.22	250.32	3269400.11	1587601.06	40°56'32.147"N	104°31'29.607"W	2.81	
3492.00	22.360	75.810	3453.49	72.35	33.30	285.67	3269435.37	1587608.52	40°56'32.217"N	104°31'29.147"W	2.30	
3586.00	22.190	75.690	3540.48	85.80	42.07	320.20	3269469.81	1587617.67	40°56'32.304"N	104°31'28.697"W	0.19	
3680.00	22.200	74.510	3627.51	99.57	51.20	354.52	3269504.02	1587627.18	40°56'32.394"N	104°31'28.249"W	0.47	
3774.00	22.120	73.240	3714.57	114.02	61.04	388.58	3269537.97	1587637.40	40°56'32.491"N	104°31'27.806"W	0.52	
3868.00	22.320	73.220	3801.59	128.86	71.30	422.61	3269571.89	1587648.03	40°56'32.592"N	104°31'27.362"W	0.21	
3963.00	22.080	74.250	3889.55	143.57	81.35	457.07	3269606.24	1587658.46	40°56'32.692"N	104°31'26.913"W	0.48	
4058.00	22.220	75.580	3977.54	157.57	90.67	491.65	3269640.72	1587668.16	40°56'32.784"N	104°31'26.463"W	0.55	
4152.00	22.300	75.970	4064.53	170.99	99.42	526.17	3269675.13	1587677.29	40°56'32.870"N	104°31'26.013"W	0.18	
4248.00	21.630	78.400	4153.57	183.71	107.40	561.17	3269710.05	1587685.65	40°56'32.949"N	104°31'25.557"W	1.18	
4343.00	21.400	83.630	4241.95	193.84	112.84	595.55	3269744.37	1587691.47	40°56'33.003"N	104°31'25.109"W	2.03	
4439.00	22.340	87.630	4331.05	201.43	115.54	631.19	3269779.98	1587694.56	40°56'33.030"N	104°31'24.644"W	1.83	
4534.00	21.900	88.940	4419.06	207.42	116.61	666.94	3269815.72	1587696.03	40°56'33.040"N	104°31'24.178"W	0.70	
4629.00	22.560	89.460	4507.00	212.87	117.11	702.88	3269851.65	1587696.92	40°56'33.045"N	104°31'23.710"W	0.72	
4725.00	22.450	87.260	4595.69	218.97	118.16	739.60	3269888.36	1587698.37	40°56'33.055"N	104°31'23.232"W	0.88	
4820.00	22.520	83.810	4683.47	226.76	120.99	775.81	3269924.53	1587701.60	40°56'33.083"N	104°31'22.760"W	1.39	
4915.00	22.520	80.940	4771.23	236.51	125.82	811.86	3269960.53	1587706.82	40°56'33.131"N	104°31'22.290"W	1.16	
5011.00	22.470	75.260	4859.93	248.95	133.38	847.76	3269996.35	1587714.78	40°56'33.206"N	104°31'21.822"W	2.26	
5106.00	22.470	72.060	4947.72	263.86	143.59	882.59	3270031.07	1587725.38	40°56'33.307"N	104°31'21.368"W	1.29	
5202.00	22.250	72.040	5036.51	279.80	154.85	917.34	3270065.68	1587737.01	40°56'33.418"N	104°31'20.916"W	0.23	
5296.00	22.340	74.980	5123.48	294.53	164.97	951.52	3270099.76	1587747.50	40°56'33.518"N	104°31'20.470"W	1.19	
5392.00	22.410	77.150	5212.26	308.13	173.76	986.98	3270135.12	1587756.69	40°56'33.605"N	104°31'20.008"W	0.86	
5486.00	22.240	79.480	5299.21	320.12	181.00	1021.94	3270170.00	1587764.31	40°56'33.676"N	104°31'19.552"W	0.96	

# Actual Wellpath Report

SALT RANCH FEE 506-1035H AWP  
Page 3 of 9

## REFERENCE WELLPATH IDENTIFICATION

Operator	CCRP OPERATING INC.	Slot	SLOT#02 SALT RANCH FEE 506-1035H (357'FNL & 607'FEL, SEC.10)
Area	COLORADO	Well	SALT RANCH FEE 506-1035H
Field	WELD COUNTY (NAD 83/TN)	Wellbore	SALT RANCH FEE 506-1035H AWB
Facility	SEC.10-T11N-R64W		

## WELLPATH DATA (178 stations)

MD [ft]	Inclination [°]	Azimuth [°]	TVD [ft]	Vert Sect [ft]	North [ft]	East [ft]	Grid East [US ft]	Grid North [US ft]	Latitude	Longitude	DLS [°/100ft]	Comments
5580.00	22.340	81.480	5386.19	330.80	186.89	1057.10	3270205.09	1587770.59	40°56'33.734"N	104°31'19.094"W	0.81	
5675.00	22.350	83.490	5474.06	340.41	191.62	1092.90	3270240.84	1587775.71	40°56'33.781"N	104°31'18.628"W	0.80	
5770.00	22.270	85.390	5561.95	348.82	195.11	1128.79	3270276.69	1587779.59	40°56'33.816"N	104°31'18.160"W	0.76	
5865.00	22.520	86.520	5649.78	356.32	197.66	1164.90	3270312.76	1587782.54	40°56'33.841"N	104°31'17.690"W	0.52	
5959.00	22.350	87.760	5736.67	363.04	199.45	1200.72	3270348.57	1587784.73	40°56'33.858"N	104°31'17.223"W	0.53	
6055.00	22.260	88.470	5825.48	369.24	200.65	1237.14	3270384.97	1587786.33	40°56'33.870"N	104°31'16.748"W	0.30	
6150.00	21.710	87.720	5913.58	375.31	201.83	1272.68	3270420.50	1587787.90	40°56'33.882"N	104°31'16.285"W	0.65	
6243.00	21.790	88.180	5999.96	381.28	203.06	1307.12	3270454.93	1587789.51	40°56'33.894"N	104°31'15.836"W	0.20	
6337.00	20.210	86.420	6087.71	387.47	204.63	1340.77	3270488.55	1587791.44	40°56'33.910"N	104°31'15.398"W	1.81	
6432.00	16.670	77.920	6177.83	395.40	208.51	1370.48	3270518.23	1587795.65	40°56'33.948"N	104°31'15.011"W	4.67	
6526.00	17.070	79.240	6267.79	404.43	213.91	1397.22	3270544.90	1587801.34	40°56'34.001"N	104°31'14.662"W	0.59	
6620.00	15.360	81.200	6358.05	412.44	218.39	1423.08	3270570.71	1587806.10	40°56'34.045"N	104°31'14.325"W	1.91	
6714.00	11.590	76.910	6449.45	419.41	222.43	1444.59	3270592.18	1587810.39	40°56'34.085"N	104°31'14.045"W	4.15	
6809.00	7.520	69.900	6543.11	425.75	226.73	1459.73	3270607.27	1587814.85	40°56'34.128"N	104°31'13.848"W	4.45	
6904.00	5.030	68.180	6637.53	430.74	230.42	1469.43	3270616.93	1587818.64	40°56'34.164"N	104°31'13.721"W	2.63	
6998.00	5.170	85.670	6731.17	433.68	232.27	1477.48	3270624.96	1587820.58	40°56'34.183"N	104°31'13.616"W	1.65	
7093.00	5.230	98.880	6825.78	434.52	231.92	1486.03	3270633.51	1587820.33	40°56'34.179"N	104°31'13.505"W	1.26	
7188.00	3.020	115.600	6920.53	433.69	230.17	1492.57	3270640.07	1587818.65	40°56'34.162"N	104°31'13.420"W	2.62	
7283.00	0.110	79.630	7015.49	432.95	229.11	1494.91	3270642.43	1587817.61	40°56'34.151"N	104°31'13.389"W	3.09	
7378.00	0.030	239.090	7110.49	432.97	229.11	1494.98	3270642.49	1587817.62	40°56'34.151"N	104°31'13.388"W	0.15	
7472.00	1.970	250.720	7204.47	432.21	228.57	1493.44	3270640.95	1587817.06	40°56'34.146"N	104°31'13.409"W	2.06	
7568.00	10.280	341.890	7299.94	439.17	236.18	1489.20	3270636.64	1587824.63	40°56'34.221"N	104°31'13.464"W	10.94	
7663.00	15.070	346.020	7392.60	458.26	256.24	1483.58	3270630.80	1587844.62	40°56'34.419"N	104°31'13.537"W	5.13	
7757.00	22.970	353.780	7481.41	487.44	286.38	1478.63	3270625.52	1587874.71	40°56'34.717"N	104°31'13.601"W	8.81	
7853.00	29.420	13.680	7567.67	529.18	328.04	1482.19	3270628.62	1587916.40	40°56'35.129"N	104°31'13.555"W	11.27	
7948.00	37.090	12.860	7647.05	581.02	378.71	1494.10	3270639.97	1587967.20	40°56'35.629"N	104°31'13.400"W	8.09	
8044.00	45.090	0.000	7719.48	643.74	441.14	1500.57	3270645.75	1588029.70	40°56'36.246"N	104°31'13.316"W	12.09	
8140.00	55.570	2.290	7780.68	717.02	514.90	1502.15	3270646.53	1588103.48	40°56'36.975"N	104°31'13.295"W	11.07	
8234.00	64.700	3.460	7827.44	798.14	596.23	1506.28	3270649.75	1588184.85	40°56'37.779"N	104°31'13.241"W	9.77	
8329.00	73.940	2.430	7860.95	886.58	684.89	1510.81	3270653.32	1588273.56	40°56'38.655"N	104°31'13.182"W	9.78	
8423.00	79.230	1.200	7882.75	977.46	776.25	1513.70	3270655.20	1588364.94	40°56'39.557"N	104°31'13.144"W	5.77	
8518.00	86.300	359.130	7894.71	1070.78	870.43	1513.95	3270654.42	1588459.12	40°56'40.488"N	104°31'13.141"W	7.75	
8614.00	90.310	358.880	7897.55	1165.56	966.35	1512.29	3270651.70	1588555.02	40°56'41.436"N	104°31'13.162"W	4.19	
8709.00	90.250	358.050	7897.09	1259.26	1061.31	1509.74	3270648.11	1588649.96	40°56'42.374"N	104°31'13.195"W	0.88	
8804.00	90.180	357.590	7896.73	1352.79	1156.25	1506.13	3270643.46	1588744.84	40°56'43.312"N	104°31'13.242"W	0.49	
8898.00	90.120	357.810	7896.48	1445.30	1250.17	1502.36	3270638.65	1588838.72	40°56'44.240"N	104°31'13.292"W	0.24	
8992.00	90.120	356.990	7896.29	1537.71	1344.07	1498.09	3270633.36	1588932.58	40°56'45.168"N	104°31'13.347"W	0.87	
9087.00	90.120	357.170	7896.09	1631.02	1438.95	1493.25	3270627.47	1589027.40	40°56'46.105"N	104°31'13.410"W	0.19	
9182.00	90.250	359.360	7895.78	1724.67	1533.90	1490.38	3270623.56	1589122.31	40°56'47.044"N	104°31'13.447"W	2.31	
9277.00	90.220	0.000	7895.39	1818.68	1628.90	1489.85	3270621.98	1589217.30	40°56'47.982"N	104°31'13.454"W	0.67	
9371.00	90.180	0.750	7895.06	1911.87	1722.89	1490.46	3270621.56	1589311.30	40°56'48.911"N	104°31'13.446"W	0.80	
9464.00	90.090	2.590	7894.84	2004.31	1815.85	1493.17	3270623.25	1589404.28	40°56'49.829"N	104°31'13.411"W	1.98	
9557.00	90.250	4.190	7894.57	2097.02	1908.68	1498.67	3270627.73	1589497.17	40°56'50.747"N	104°31'13.339"W	1.73	
9652.00	90.220	3.690	7894.18	2191.79	2003.46	1505.20	3270633.22	1589592.02	40°56'51.683"N	104°31'13.254"W	0.53	
9747.00	90.250	3.430	7893.79	2286.51	2098.27	1511.10	3270638.07	1589686.89	40°56'52.620"N	104°31'13.177"W	0.28	

# Actual Wellpath Report

SALT RANCH FEE 506-1035H AWP

Page 4 of 9

## REFERENCE WELLPATH IDENTIFICATION

Operator	CCRP OPERATING INC.	Slot	SLOT#02 SALT RANCH FEE 506-1035H (357'FNL & 607'FEL, SEC.10)
Area	COLORADO	Well	SALT RANCH FEE 506-1035H
Field	WELD COUNTY (NAD 83/TN)	Wellbore	SALT RANCH FEE 506-1035H AWB
Facility	SEC.10-T11N-R64W		

## WELLPATH DATA (178 stations)

MD [ft]	Inclination [°]	Azimuth [°]	TVD [ft]	Vert Sect [ft]	North [ft]	East [ft]	Grid East [US ft]	Grid North [US ft]	Latitude	Longitude	DLS [°/100ft]	Comments
9840.00	90.280	2.560	7893.36	2379.17	2191.14	1515.96	3270641.91	1589779.82	40°56'53.538"N	104°31'13.114"W	0.94	
9934.00	90.180	1.110	7892.98	2472.63	2285.09	1518.97	3270643.89	1589873.79	40°56'54.466"N	104°31'13.074"W	1.55	
10030.00	90.250	0.280	7892.62	2567.87	2381.08	1520.13	3270644.00	1589969.80	40°56'55.414"N	104°31'13.059"W	0.87	
10126.00	90.180	359.200	7892.26	2662.89	2477.08	1519.70	3270642.51	1590065.78	40°56'56.363"N	104°31'13.065"W	1.13	
10221.00	90.220	357.980	7891.93	2756.63	2572.05	1517.36	3270639.13	1590160.72	40°56'57.301"N	104°31'13.095"W	1.28	
10317.00	90.090	356.680	7891.67	2850.99	2667.94	1512.89	3270633.60	1590256.57	40°56'58.249"N	104°31'13.153"W	1.36	
10412.00	90.090	356.500	7891.52	2944.14	2762.77	1507.24	3270626.91	1590351.33	40°56'59.186"N	104°31'13.227"W	0.19	
10507.00	90.150	356.720	7891.32	3037.29	2857.61	1501.62	3270620.25	1590446.10	40°57'00.123"N	104°31'13.300"W	0.24	
10603.00	89.880	357.020	7891.30	3131.51	2953.46	1496.38	3270613.96	1590541.90	40°57'01.070"N	104°31'13.368"W	0.42	
10698.00	89.940	357.480	7891.45	3224.87	3048.35	1491.82	3270608.36	1590636.73	40°57'02.007"N	104°31'13.427"W	0.49	
10792.00	89.910	357.730	7891.57	3317.35	3142.27	1487.89	3270603.40	1590730.61	40°57'02.935"N	104°31'13.479"W	0.27	
10886.00	89.970	358.330	7891.67	3409.95	3236.22	1484.66	3270599.13	1590824.51	40°57'03.864"N	104°31'13.521"W	0.64	
10982.00	89.880	359.240	7891.79	3504.73	3332.19	1482.62	3270596.04	1590920.46	40°57'04.812"N	104°31'13.547"W	0.95	
11076.00	89.940	0.210	7891.94	3597.77	3426.19	1482.17	3270594.56	1591014.45	40°57'05.741"N	104°31'13.553"W	1.03	
11171.00	90.000	0.930	7891.99	3691.99	3521.19	1483.12	3270594.46	1591109.45	40°57'06.679"N	104°31'13.540"W	0.76	
11266.00	89.940	0.930	7892.04	3786.28	3616.17	1484.66	3270594.96	1591204.46	40°57'07.618"N	104°31'13.520"W	0.06	
11362.00	89.970	0.860	7892.11	3881.56	3712.16	1486.16	3270595.41	1591300.46	40°57'08.566"N	104°31'13.501"W	0.08	
11457.00	89.910	0.750	7892.21	3975.83	3807.15	1487.49	3270595.70	1591395.46	40°57'09.505"N	104°31'13.483"W	0.13	
11552.00	89.940	1.050	7892.34	4070.12	3902.14	1488.99	3270596.15	1591490.46	40°57'10.443"N	104°31'13.464"W	0.32	
11648.00	89.940	1.480	7892.44	4165.47	3998.12	1491.11	3270597.21	1591586.46	40°57'11.392"N	104°31'13.436"W	0.45	
11743.00	89.910	1.660	7892.56	4259.89	4093.08	1493.71	3270598.77	1591681.45	40°57'12.330"N	104°31'13.402"W	0.19	
11837.00	89.970	2.360	7892.66	4353.39	4187.02	1497.01	3270601.03	1591775.42	40°57'13.258"N	104°31'13.359"W	0.75	
11929.00	89.970	3.400	7892.71	4445.03	4278.90	1501.63	3270604.65	1591867.35	40°57'14.166"N	104°31'13.299"W	1.13	
12022.00	89.880	3.810	7892.83	4537.76	4371.72	1507.48	3270609.47	1591960.23	40°57'15.083"N	104°31'13.222"W	0.45	
12117.00	90.030	3.890	7892.91	4632.52	4466.51	1513.85	3270614.81	1592055.08	40°57'16.020"N	104°31'13.139"W	0.18	
12212.00	89.970	2.050	7892.91	4727.17	4561.37	1518.78	3270618.69	1592150.00	40°57'16.957"N	104°31'13.075"W	1.94	
12307.00	89.970	359.530	7892.96	4821.42	4656.36	1520.09	3270618.96	1592244.99	40°57'17.896"N	104°31'13.058"W	2.65	
12401.00	88.980	356.540	7893.82	4914.01	4750.29	1516.86	3270614.70	1592338.89	40°57'18.824"N	104°31'13.100"W	3.35	
12497.00	88.920	356.090	7895.58	5008.03	4846.07	1510.69	3270607.48	1592434.60	40°57'19.770"N	104°31'13.180"W	0.47	
12592.00	88.920	356.750	7897.37	5101.11	4940.87	1504.76	3270600.51	1592529.33	40°57'20.707"N	104°31'13.257"W	0.69	
12686.00	88.890	356.980	7899.16	5193.35	5034.71	1499.62	3270594.34	1592623.11	40°57'21.634"N	104°31'13.324"W	0.25	
12780.00	90.120	358.200	7899.98	5285.81	5128.62	1495.67	3270589.36	1592716.97	40°57'22.562"N	104°31'13.376"W	1.84	
12875.00	90.090	358.160	7899.80	5379.44	5223.57	1492.65	3270585.30	1592811.89	40°57'23.500"N	104°31'13.415"W	0.05	
12971.00	90.250	358.610	7899.52	5474.12	5319.53	1489.95	3270581.54	1592907.82	40°57'24.448"N	104°31'13.450"W	0.50	
13064.00	90.180	358.740	7899.17	5565.91	5412.51	1487.80	3270578.36	1593000.77	40°57'25.367"N	104°31'13.478"W	0.16	
13159.00	90.120	358.570	7898.92	5659.67	5507.48	1485.57	3270575.09	1593095.71	40°57'26.305"N	104°31'13.507"W	0.19	
13255.00	90.220	359.490	7898.63	5754.51	5603.47	1483.94	3270572.41	1593191.68	40°57'27.254"N	104°31'13.528"W	0.96	
13351.00	90.180	358.150	7898.30	5849.30	5699.44	1481.97	3270569.38	1593287.63	40°57'28.202"N	104°31'13.554"W	1.40	
13447.00	90.120	357.110	7898.05	5943.75	5795.36	1478.00	3270564.36	1593383.50	40°57'29.150"N	104°31'13.605"W	1.09	
13542.00	90.250	357.140	7897.74	6037.07	5890.24	1473.23	3270558.55	1593478.32	40°57'30.087"N	104°31'13.667"W	0.14	
13638.00	90.220	356.780	7897.35	6131.32	5986.10	1468.14	3270552.41	1593574.13	40°57'31.034"N	104°31'13.734"W	0.38	
13732.00	90.310	358.860	7896.91	6223.86	6080.03	1464.56	3270547.80	1593668.01	40°57'31.962"N	104°31'13.780"W	2.21	
13827.00	90.090	1.760	7896.58	6318.01	6175.02	1465.08	3270547.27	1593763.00	40°57'32.901"N	104°31'13.773"W	3.06	
13923.00	90.180	2.250	7896.35	6413.50	6270.96	1468.44	3270549.57	1593858.97	40°57'33.849"N	104°31'13.730"W	0.52	
14019.00	90.150	2.550	7896.08	6509.05	6366.87	1472.46	3270552.54	1593954.93	40°57'34.797"N	104°31'13.677"W	0.31	

# Actual Wellpath Report

SALT RANCH FEE 506-1035H AWP

Page 5 of 9

## REFERENCE WELLPATH IDENTIFICATION

Operator	CCRP OPERATING INC.	Slot	SLOT#02 SALT RANCH FEE 506-1035H (357'FNL & 607'FEL, SEC.10)
Area	COLORADO	Well	SALT RANCH FEE 506-1035H
Field	WELD COUNTY (NAD 83/TN)	Wellbore	SALT RANCH FEE 506-1035H AWP
Facility	SEC.10-T11N-R64W		

## WELLPATH DATA (178 stations)

MD [ft]	Inclination [°]	Azimuth [°]	TVD [ft]	Vert Sect [ft]	North [ft]	East [ft]	Grid East [US ft]	Grid North [US ft]	Latitude	Longitude	DLS [°/100ft]	Comments
14115.00	90.280	1.250	7895.72	6604.52	6462.82	1475.64	3270554.67	1594050.91	40°57'35.745"N	104°31'13.636"W	1.36	
14210.00	90.250	0.660	7895.28	6698.82	6557.80	1477.22	3270555.21	1594145.91	40°57'36.683"N	104°31'13.615"W	0.62	
14305.00	90.180	359.910	7894.92	6792.97	6652.80	1477.70	3270554.64	1594240.91	40°57'37.622"N	104°31'13.609"W	0.79	
14401.00	90.280	358.550	7894.54	6887.87	6748.79	1476.41	3270552.29	1594336.88	40°57'38.570"N	104°31'13.625"W	1.42	
14496.00	89.910	358.970	7894.38	6981.65	6843.77	1474.35	3270549.19	1594431.83	40°57'39.509"N	104°31'13.652"W	0.59	
14591.00	89.910	0.090	7894.53	7075.63	6938.76	1473.57	3270547.37	1594526.81	40°57'40.447"N	104°31'13.662"W	1.18	
14687.00	89.970	1.160	7894.63	7170.86	7034.75	1474.62	3270547.36	1594622.81	40°57'41.396"N	104°31'13.648"W	1.12	
14782.00	89.880	1.170	7894.75	7265.20	7129.73	1476.55	3270548.25	1594717.81	40°57'42.334"N	104°31'13.623"W	0.10	
14876.00	89.850	2.910	7894.98	7358.70	7223.67	1479.90	3270550.56	1594811.78	40°57'43.262"N	104°31'13.580"W	1.85	
14972.00	89.750	4.410	7895.31	7454.43	7319.47	1486.02	3270555.64	1594907.65	40°57'44.209"N	104°31'13.500"W	1.57	
15067.00	89.570	4.250	7895.87	7549.24	7414.20	1493.20	3270561.77	1595002.45	40°57'45.145"N	104°31'13.406"W	0.25	
15161.00	89.720	2.920	7896.46	7642.97	7508.01	1499.07	3270566.62	1595096.32	40°57'46.072"N	104°31'13.329"W	1.42	
15256.00	89.750	0.770	7896.90	7737.43	7602.95	1502.13	3270568.63	1595191.30	40°57'47.010"N	104°31'13.289"W	2.26	
15351.00	89.780	353.760	7897.29	7830.73	7697.79	1497.60	3270563.06	1595286.08	40°57'47.947"N	104°31'13.348"W	7.38	
15447.00	89.750	1.190	7897.68	7925.07	7793.63	1493.38	3270557.78	1595381.87	40°57'48.894"N	104°31'13.403"W	7.74	
15542.00	89.720	1.910	7898.12	8019.48	7888.59	1495.95	3270559.31	1595476.86	40°57'49.832"N	104°31'13.370"W	0.76	
15637.00	89.820	0.340	7898.50	8113.81	7983.57	1497.81	3270560.13	1595571.85	40°57'50.770"N	104°31'13.345"W	1.66	
15733.00	89.750	0.150	7898.86	8208.95	8079.57	1498.22	3270559.49	1595667.85	40°57'51.719"N	104°31'13.340"W	0.21	
15828.00	89.690	359.320	7899.33	8302.98	8174.56	1497.78	3270558.00	1595762.84	40°57'52.658"N	104°31'13.346"W	0.88	
15924.00	89.660	359.260	7899.87	8397.89	8270.55	1496.59	3270555.76	1595858.81	40°57'53.606"N	104°31'13.361"W	0.07	
16019.00	89.690	358.060	7900.41	8491.65	8365.52	1494.37	3270552.49	1595953.76	40°57'54.544"N	104°31'13.390"W	1.26	
16114.00	89.850	358.500	7900.79	8585.31	8460.48	1491.52	3270548.60	1596048.68	40°57'55.483"N	104°31'13.427"W	0.49	
16208.00	89.780	356.860	7901.09	8677.80	8554.40	1487.71	3270543.76	1596142.55	40°57'56.411"N	104°31'13.477"W	1.75	
16301.00	89.420	356.720	7901.74	8769.05	8647.25	1482.51	3270537.53	1596235.35	40°57'57.328"N	104°31'13.544"W	0.42	
16395.00	88.680	359.220	7903.30	8861.62	8741.17	1479.18	3270533.17	1596329.23	40°57'58.256"N	104°31'13.588"W	2.77	
16490.00	88.120	0.620	7905.95	8955.65	8836.13	1479.04	3270532.00	1596424.18	40°57'59.194"N	104°31'13.589"W	1.59	
16586.00	88.120	2.010	7909.10	9050.96	8932.05	1481.25	3270533.15	1596520.12	40°58'00.142"N	104°31'13.561"W	1.45	
16682.00	88.090	1.880	7912.28	9146.39	9027.94	1484.50	3270535.35	1596616.05	40°58'01.090"N	104°31'13.518"W	0.14	
16776.00	88.090	0.940	7915.41	9239.73	9121.86	1486.81	3270536.63	1596709.99	40°58'02.018"N	104°31'13.488"W	1.00	
16872.00	87.170	359.540	7919.38	9334.78	9217.78	1487.22	3270535.98	1596805.90	40°58'02.965"N	104°31'13.483"W	1.74	
16968.00	87.080	359.060	7924.20	9429.58	9313.65	1486.05	3270533.75	1596901.76	40°58'03.913"N	104°31'13.498"W	0.51	
17062.00	87.080	358.140	7928.99	9522.21	9407.50	1483.75	3270530.43	1596995.58	40°58'04.840"N	104°31'13.528"W	0.98	
17157.00	87.110	357.600	7933.80	9615.64	9502.31	1480.23	3270525.86	1597090.35	40°58'05.777"N	104°31'13.573"W	0.57	
17253.00	87.050	357.300	7938.69	9709.91	9598.09	1475.96	3270520.54	1597186.08	40°58'06.723"N	104°31'13.629"W	0.32	
17346.00	88.680	357.150	7942.15	9801.23	9690.91	1471.46	3270515.02	1597278.85	40°58'07.640"N	104°31'13.688"W	1.76	
17442.00	90.090	358.590	7943.19	9895.75	9786.84	1467.89	3270510.40	1597374.73	40°58'08.588"N	104°31'13.734"W	2.10	
17538.00	90.150	359.570	7942.98	9990.61	9882.82	1466.35	3270507.81	1597470.70	40°58'09.536"N	104°31'13.754"W	1.02	
17633.00	89.140	359.160	7943.57	10084.54	9977.81	1465.30	3270505.71	1597565.67	40°58'10.475"N	104°31'13.768"W	1.15	
17728.00	89.200	358.710	7944.95	10178.37	10072.79	1463.53	3270502.90	1597660.63	40°58'11.413"N	104°31'13.791"W	0.48	
17823.00	89.140	358.930	7946.33	10272.16	10167.76	1461.58	3270499.90	1597755.57	40°58'12.352"N	104°31'13.816"W	0.24	
17918.00	89.110	358.950	7947.78	10365.99	10262.73	1459.82	3270497.10	1597850.52	40°58'13.290"N	104°31'13.839"W	0.04	
18013.00	89.080	359.300	7949.28	10459.86	10357.71	1458.37	3270494.61	1597945.48	40°58'14.228"N	104°31'13.858"W	0.37	LAST BHGE MWD SURVEY
18057.00	89.080	359.300	7949.98	10503.35	10401.70	1457.83	3270493.59	1597989.46	40°58'14.663"N	104°31'13.865"W	0.00	PROJECTION TO BIT

# Actual Wellpath Report

SALT RANCH FEE 506-1035H AWP

Page 6 of 9

REFERENCE WELLPATH IDENTIFICATION			
Operator	CCRP OPERATING INC.	Slot	SLOT#02 SALT RANCH FEE 506-1035H (357'FNL & 607'FEL, SEC.10)
Area	COLORADO	Well	SALT RANCH FEE 506-1035H
Field	WELD COUNTY (NAD 83/TN)	Wellbore	SALT RANCH FEE 506-1035H AWB
Facility	SEC.10-T11N-R64W		

HOLE & CASING SECTIONS - Ref Wellbore: SALT RANCH FEE 506-1035H AWB      Ref Wellpath: SALT RANCH FEE 506-1035H AWP									
String/Diameter	Start MD [ft]	End MD [ft]	Interval [ft]	Start TVD [ft]	End TVD [ft]	Start N/S [ft]	Start E/W [ft]	End N/S [ft]	End E/W [ft]
13.5in Open Hole	100.00	2222.00	2122.00	100.00	2221.79	0.10	0.11	14.73	10.37
9.625in Casing Surface	22.00	2223.00	2201.00	22.00	2222.79	0.00	0.00	14.74	10.41
8.5in Open Hole	2232.00	18057.00	15825.00	2231.78	7949.98	14.80	10.80	10401.70	1457.83



# Actual Wellpath Report

SALT RANCH FEE 506-1035H AWP  
Page 7 of 9

## REFERENCE WELLPATH IDENTIFICATION

Operator	CCRP OPERATING INC.	Slot	SLOT#02 SALT RANCH FEE 506-1035H (357'FNL & 607'FEL, SEC.10)
Area	COLORADO	Well	SALT RANCH FEE 506-1035H
Field	WELD COUNTY (NAD 83/TN)	Wellbore	SALT RANCH FEE 506-1035H AWB
Facility	SEC.10-T11N-R64W		

## TARGETS

Name	TVD [ft]	North [ft]	East [ft]	Grid East [US ft]	Grid North [US ft]	Latitude	Longitude	Shape
SEC.02-T11N-R64W	0.00	0.00	0.00	3269150.08	1587572.09	40°56'31.888"N	104°31'32.869"W	polygon
SEC.03-T11N-R64W	0.00	0.00	0.00	3269150.08	1587572.09	40°56'31.888"N	104°31'32.869"W	polygon
SEC.10-T11N-R64W	0.00	0.00	0.00	3269150.08	1587572.09	40°56'31.888"N	104°31'32.869"W	polygon
SEC.15-T11N-R64W	0.00	0.00	0.00	3269150.08	1587572.09	40°56'31.888"N	104°31'32.869"W	polygon
SEC.34-T12N-R64W	0.00	0.00	0.00	3269150.08	1587572.09	40°56'31.888"N	104°31'32.869"W	polygon
SEC.35-T12N-R64W	0.00	0.00	0.00	3269150.08	1587572.09	40°56'31.888"N	104°31'32.869"W	polygon
SALT RANCH FEE 506-1035H BHL REV-2 (600'FNL & 640'FWL, SEC.35)	7881.00	10452.80	1454.50	3270489.70	1598040.52	40°58'15.168"N	104°31'13.908"W	point
SALT RANCH FEE 506-1035H LPL REV-2 (600'FSL & 940'FWL, SEC.02)	7881.00	954.04	1507.55	3270647.10	1588542.66	40°56'41.314"N	104°31'13.224"W	point
SALT RANCH FEE 506-1035H WP#1 (-2427'SSTVD @ 6500'VS)	7883.00	6357.25	1477.38	3270557.57	1593945.36	40°57'34.701"N	104°31'13.613"W	point
SALT RANCH FEE 506-1035H LPL REV-3 (600'FSL & 940'FWL, SEC.02)	7891.00	954.04	1507.55	3270647.10	1588542.66	40°56'41.314"N	104°31'13.224"W	point
SALT RANCH FEE 506-1035H WP#2 (-2441'SSTVD @ 9100'VS)	7897.00	8984.20	1462.71	3270514.04	1596572.07	40°58'00.657"N	104°31'13.802"W	point
SALT RANCH FEE 506-1035H BHL REV-3 (600'FNL & 940'FWL, SEC.35)	7898.00	10452.80	1454.50	3270489.70	1598040.52	40°58'15.168"N	104°31'13.908"W	point
SALT RANCH FEE 506-1035H LPL REV-4 (600'FSL & 940'FWL, SEC.02)	7898.00	954.04	1507.55	3270647.10	1588542.66	40°56'41.314"N	104°31'13.224"W	point
SALT RANCH FEE 506-1035H BHL REV-4 (600'FNL & 940'FWL, SEC.35)	7904.74	10452.80	1454.50	3270489.70	1598040.52	40°58'15.168"N	104°31'13.908"W	point
SALT RANCH FEE 201-1015H HARDLINES (300' SETBACKS)	7905.00	0.00	0.00	3269150.08	1587572.09	40°56'31.888"N	104°31'32.869"W	polygon
SALT RANCH FEE 502-1034H HARDLINES (600' SETBACKS)	7905.00	0.00	0.00	3269150.08	1587572.09	40°56'31.888"N	104°31'32.869"W	polygon
SALT RANCH FEE 506-1035H BHL REV-1 (600'FNL & 640'FWL, SEC.35)	7905.00	10452.80	1454.50	3270489.70	1598040.52	40°58'15.168"N	104°31'13.908"W	point
SALT RANCH FEE 506-1035H HARDLINES (600' SETBACKS)	7905.00	0.00	0.00	3269150.08	1587572.09	40°56'31.888"N	104°31'32.869"W	polygon
SALT RANCH FEE 506-1035H LPL REV-1 (735'FSL & 940'FWL, SEC.02)	7905.00	1089.04	1507.55	3270645.62	1588677.65	40°56'42.648"N	104°31'13.224"W	point



# Actual Wellpath Report

SALT RANCH FEE 506-1035H AWP  
Page 8 of 9

REFERENCE WELLPATH IDENTIFICATION			
Operator	CCRP OPERATING INC.	Slot	SLOT#02 SALT RANCH FEE 506-1035H (357'FNL & 607'FEL, SEC.10)
Area	COLORADO	Well	SALT RANCH FEE 506-1035H
Field	WELD COUNTY (NAD 83/TN)	Wellbore	SALT RANCH FEE 506-1035H AWB
Facility	SEC.10-T11N-R64W		

WELLPATH COMPOSITION - Ref Wellbore: SALT RANCH FEE 506-1035H AWB      Ref Wellpath: SALT RANCH FEE 506-1035H AWP				
Start MD [ft]	End MD [ft]	Positional Uncertainty Model	Log Name/Comment	Wellbore
22.00	2143.00	BHI NaviTrak (Rotating+Axial Corr)	BHGE NAVITRAK (ROTATING + AXIAL CORR) <22 - 2143>	SALT RANCH FEE 506-1035H AWB
2143.00	18013.00	BHI AutoTrak Curve (Axial Corr, Short spacing)	AUTOTRAK CURVE 8 1/2" MONOBORE (AXIAL CORR, SHORT) <2143 - 18013>	SALT RANCH FEE 506-1035H AWB
18013.00	18057.00	Blind Drilling (std)	Projection to bit	SALT RANCH FEE 506-1035H AWB

# Actual Wellpath Report

SALT RANCH FEE 506-1035H AWP  
Page 9 of 9

REFERENCE WELLPATH IDENTIFICATION			
Operator	CCRP OPERATING INC.	Slot	SLOT#02 SALT RANCH FEE 506-1035H (357'FNL & 607'FEL, SEC.10)
Area	COLORADO	Well	SALT RANCH FEE 506-1035H
Field	WELD COUNTY (NAD 83/TN)	Wellbore	SALT RANCH FEE 506-1035H AWB
Facility	SEC.10-T11N-R64W		

WELLPATH COMMENTS				
MD [ft]	Inclination [°]	Azimuth [°]	TVD [ft]	Comment
238.00	0.590	48.330	238.00	FIRST BHGE MWD SURVEY
18013.00	89.080	359.300	7949.28	LAST BHGE MWD SURVEY
18057.00	89.080	359.300	7949.98	PROJECTION TO BIT