

# Well Location Plat

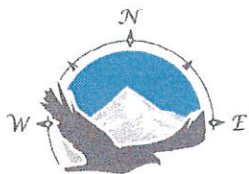

## FRANE SURVEYING INC.

Physical Address: 34834 Annie Cir.  
Mail to: Box 2372, Elizabeth, CO 80107  
Ph. 303-243-0037  
www.franesurveying.com

Job # 19-059-ALC-1748 #1-33

Frane Surveying, in accordance with a request from **McCoy Petroleum Corporation** has determined the location of **ALC 1748 #1-33** to be **1980 Feet FSL**, and **660 Feet FEL**, (90° off Section lines) of Section **33**, Township **17s**, Range **48w** of the 6th Principal Meridian, **Kiowa County, Colorado**.

Date: Staked on 04/18/19 drawn on 04/24/19.

**Re:** Staked by Elijah Frane  
**Drawn:** Drawn by Elijah Frane

**Basis of Elevation Spot:** Processed OPUS Solution.

**Notes:** See location drawing for improvements within 500' of proposed well pad / head.  
The ground elevation at staked location = 4259.38' gr.  
This drawing does not represent a monumented survey or Land Survey Plat.

**Basis of Bearing:** Bearings were determined based on the East line of Section 33 to bear S02°11'24"E with all other bearings contained herein relative thereto.

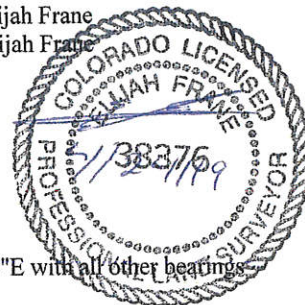

## WELL LOCATION MAP

