

FRAZEE #2-6

Doc # 689900683

Photos for Item #1, 2, 6, 7



Berm improved

125236

Fences tightened
125241

FRAZEE #2-6
052519

Fencing
tightened &
straightened
#125241

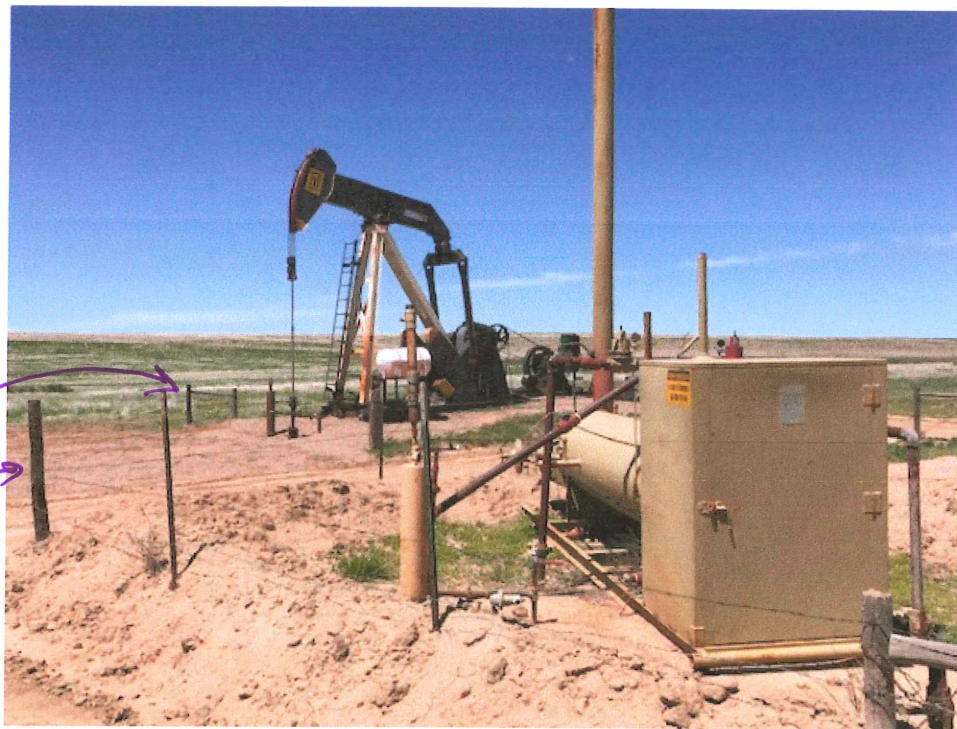

Berms improved
#125236

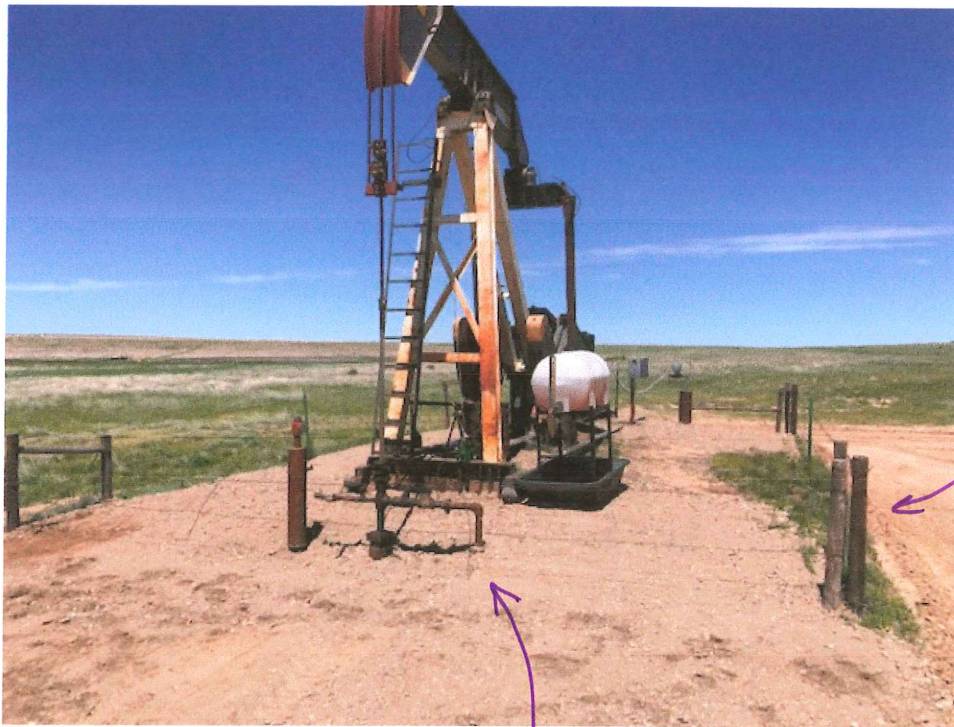

Fences tightened
& straightened
125241

oil stained dirt removed
and stored on-site pending
analysis and commercial disposal
125237



fences tightened
and straightened
↙ #125241

* oil stained
dirt removed &
stored on site
pending analysis
and commercial
disposal

125237



5

oil stained dirt
removed
#125237



all oil stained
dirt removed
pending analysis
and commercial
disposal
#125237

Fences straightened + tightened
#12524



Fences tightened
125241

Berms improved
#125236



Storage of oil stained dirt pending
analysis and disposal at a commercial
facility

#125237

Fences tightened & straightened
125241



oil stained soil stored pending analysis
and disposal at a commercial facility

#125237

12



CA # 125242

GRAZEE 2-6 / HASWELL
Drip Blowdown
052519



CA #125242

Drip Rehab

STAINED SOIL
Removed &
stored on site



125 237

FRAZEE #2-6/
HASWELL Compressor Bldg
05-2519



STAINED SOIL
Removed & stored
on site.
Road base added
to flatten floor
of shed.

#125237