

1999 AC
LS 16413

R. 93 W.

1999 AC
LS 16413

S81°02'37"E
1207.32'

S81°03'07"E
1207.81'

1999 AC
LS 16413

S81°02'31"E 2414.86'
(1207.43')

1921
GLO BC

HAYWARD
0993-25-14E

UNGRADED ELEVATION:
8008.0'

BASIS OF ELEVATION: GPS STATIC
OBSERVATION ON DRG CONTROL POINT
CP 16-9-93.
ELEVATION: 7245.29'

N00°48'11"E 5283.45'

25

BHL/TOG
LATITUDE (NAD 83)

NORTH 39.239406 DEG.

LONGITUDE (NAD 83)

WEST 107.714976 DEG.

NORTHING (NAD 83)

1519736

EASTING (NAD 83)

2372716

1999 AC
LS 16413

N80°37'48"W 4828.54'
(1207.14')

2564'

(1331.23')

(1331.23')

(1327.69')

(1327.69')

(1327.69')

1921 GLO
BC/WC

LEGEND

- ◆ WELL LOCATION
- APPROX. BHL
- L DENOTES 90° TIE
- FOUND MONUMENT

NOTES

1. GPS OPERATOR T. SHERRILL OBSERVED A PDOP OF 1.6.
2. ALL GPS OBSERVATIONS ARE IN COMPLIANCE WITH COGCC RULE No.215.
3. EXISTING IMPROVEMENTS WITHIN 500' OF LOCATION. SEE LOC. DRAWING.
4. SURROUNDING SURFACE USE IS NATIVE BRUSH, NON CROP RANGELAND.

SURVEYOR'S STATEMENT

I, DAVID E. HENDERHAN, AN EMPLOYEE AND AGENT ON BEHALF OF D.R. GRIFFIN & ASSOCIATES, INC. STATE THE PLAT HEREON IS A CORRECT REPRESENTATION OF A SURVEY MADE UNDER MY SUPERVISION ON THE 1st DAY OF MARCH, 2018 OF THE SHOWN HAYWARD 0993-25-14E AND THAT THE LOCATION HAS BEEN STAKED ON THE GROUND.

Notice: In accordance with Colorado State Law, any legal action based upon any defect in this survey plat must commence within three (3) years after first discovery of such defect. In no event, may any action based upon any defect in this survey plat be commenced more than ten (10) years from the date of certification shown hereon.

HAYWARD 0993-25-09

BASIS OF BEARING/DATUM

SPCS COLORADO CENTRAL NAD 27
BASED ON STATIC GPS OBSERVATIONS
ON DRG CONTROL POINT CP 16-9-93
HAVING A POSITION OF:
NAD83(2011)
LAT 39° 16' 16.64" NORTH
LONG 107° 46' 11.24" WEST
NAVD88 ELEVATION: 7245.29'

THE EAST LINE OF THE NE¼ OF SECTION
25, MONUMENTED BY BLM BC'S AND
BEARING S 00°52'09" W.

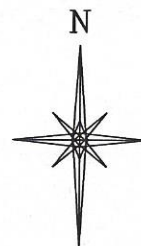

GRID NORTH
SCALE 1" = 1000'
500' 0 1000'

T. 9 S.

SHL

LATITUDE (NAD 83)

NORTH 39.244810 DEG.

LONGITUDE (NAD 83)

WEST 107.715841 DEG.

NORTHING (NAD 83)

1521709.57

EASTING (NAD 83)

2372519.23

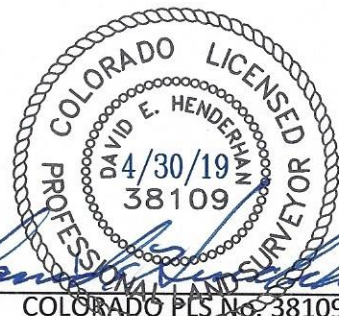

COLORADO PLS No. 38109



DRG RIFFIN & ASSOCIATES, INC.

(307) 362-5028

1414 ELK ST., ROCK SPRINGS, WY 82901

DRAWN: 3/8/2018 - TCM

SCALE: 1" = 1000'

REVISED: 4/30/2019 - TCM

DRG JOB No. 21279

REVISED BHLS

A4-25-14E

PLAT OF DRILLING LOCATION IN
SENE, SECTION 25, FOR
LARAMIE ENERGY, LLC

2564' F/NL, & 878' F/EL, SECTION 25,
T. 9 S., R. 93 W., 6TH P.M.,
MESA COUNTY, COLORADO