

1999 AC  
LS 16413

**R. 93 W.**

1999 AC  
LS 16413

S81°02'37"E  
1207.32'

S81°03'07"E  
1207.81'

1999 AC  
LS 16413

S81°02'31"E 2414.86'  
(1207.43') (1207.43')

1921  
GLO BC

**HAYWARD**  
**0993-25-06E**  
**UNGRADED ELEVATION:**  
**8007.3'**

BASIS OF ELEVATION: GPS STATIC  
OBSERVATION ON DRG CONTROL POINT  
CP 16-9-93.  
ELEVATION: 7245.29'

N00°48'11"E 5283.45'

**25**

**BHL/TOG**  
**LATITUDE (NAD 83)**  
NORTH 39.246610 DEG.  
**LONGITUDE (NAD 83)**  
WEST 107.715164 DEG.  
**NORTHING (NAD 83)**  
1522360  
**EASTING (NAD 83)**  
2372727

1999 AC  
LS 16413

N80°37'48"W 4828.54'

1921 GLO  
BC/WC

S00°52'09"W 2662.47'  
(1331.23')  
680'  
2557'  
1889'  
(1331.23')  
864'

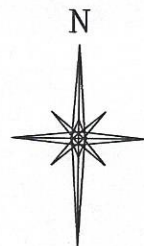

GRID NORTH  
SCALE 1" = 1000'  
500' 0 1000'

**T. 9 S.**

**SHL**  
**LATITUDE (NAD 83)**  
NORTH 39.244824 DEG.  
**LONGITUDE (NAD 83)**  
WEST 107.715795 DEG.  
**NORTHING (NAD 83)**  
1521714.33  
**EASTING (NAD 83)**  
2372532.55

#### NOTES

1. GPS OPERATOR T. SHERRILL OBSERVED A PDOP OF 1.8.
2. ALL GPS OBSERVATIONS ARE IN COMPLIANCE WITH COGCC RULE No.215.
3. EXISTING IMPROVEMENTS WITHIN 500' OF LOCATION. SEE LOC. DRAWING.
4. SURROUNDING SURFACE USE IS NATIVE BRUSH, NON CROP RANGELAND.

#### LEGEND

- ◆ WELL LOCATION
- APPROX. BHL
- L DENOTES 90° TIE
- FOUND MONUMENT

#### SURVEYOR'S STATEMENT

I, DAVID E. HENDERHAN, AN EMPLOYEE AND AGENT ON BEHALF OF D.R. GRIFFIN & ASSOCIATES, INC. STATE THE PLAT HEREON IS A CORRECT REPRESENTATION OF A SURVEY MADE UNDER MY SUPERVISION ON THE 1st DAY OF MARCH, 2018 OF THE SHOWN HAYWARD 0993-25-06E AND THAT THE LOCATION HAS BEEN STAKED ON THE GROUND.

Notice: In accordance with Colorado State Law, any legal action based upon any defect in this survey plat must commence within three (3) years after first discovery of such defect. In no event, may any action based upon any defect in this survey plat be commenced more than ten (10) years from the date of certification shown hereon.

**HAYWARD 0993-25-09**

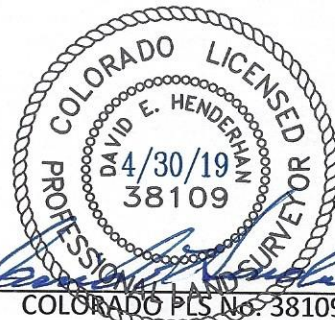

THE EAST LINE OF THE NE¼ OF SECTION 25, MONUMENTED BY BLM BC'S AND BEARING S 00°52'09" W.



**DAVID E. GRIFFIN & ASSOCIATES, INC.**

(307) 362-5028

1414 ELK ST., ROCK SPRINGS, WY 82901

DRAWN: 3/8/2018 - TCM

SCALE: 1" = 1000'

REVISED: 4/30/2019 - TCM

DRG JOB No. 21279

REVISED BHLS

B3-25-06E

**PLAT OF DRILLING LOCATION IN**  
**SENE, SECTION 25, FOR**  
**LARAMIE ENERGY, LLC**

**2557' F/NL, & 864' F/EL, SECTION 25,**  
**T. 9 S., R. 93 W., 6TH P.M.,**  
**MESA COUNTY, COLORADO**