

A PART OF THE NORTHEAST QUARTER OF SECTION 14,
TOWNSHIP 5 NORTH, RANGE 65 WEST OF THE 6TH P.M.,
COUNTY OF WELD, STATE OF COLORADO

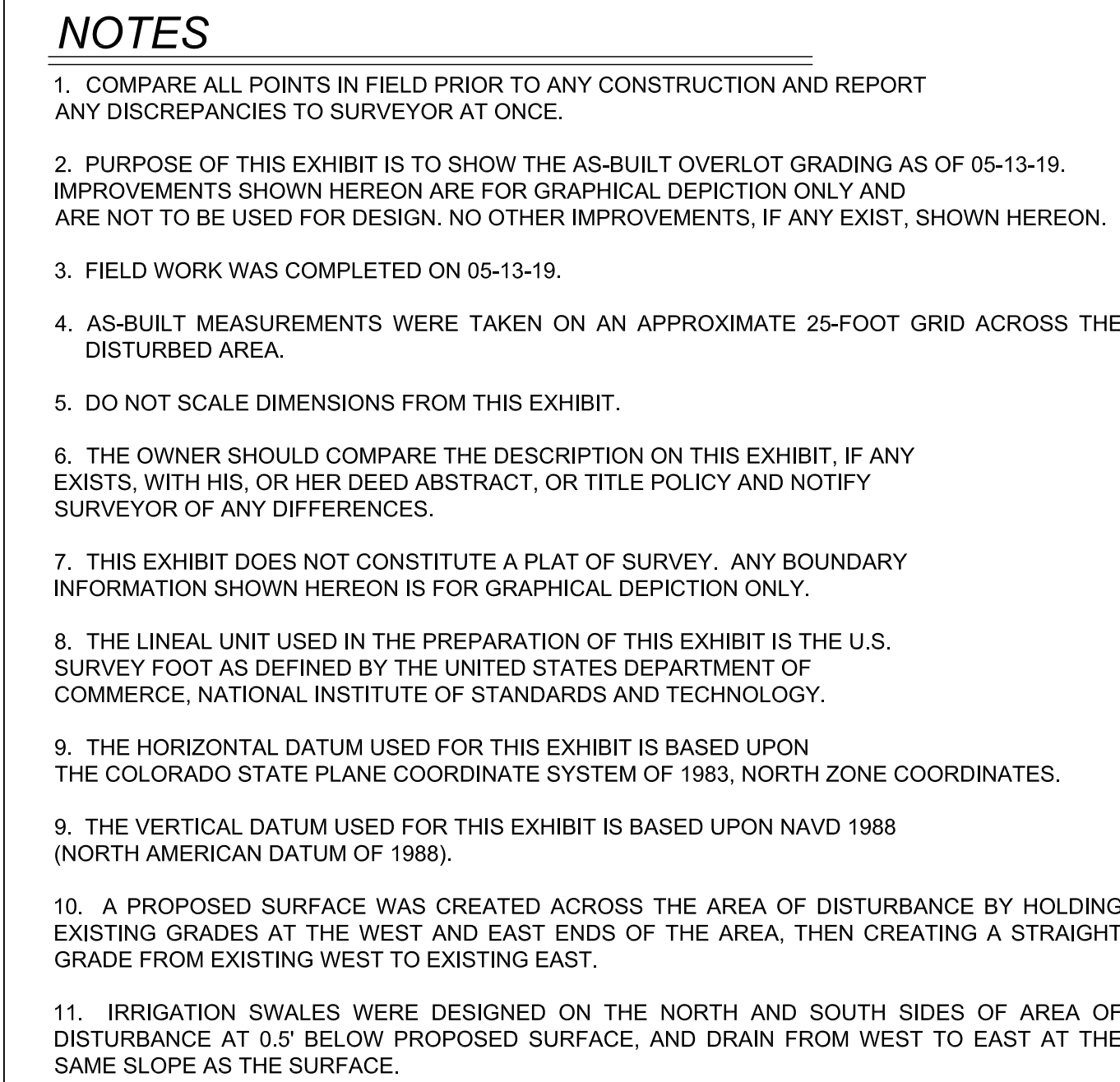

_____ PROPOSED FINAL GRADE MAJOR (1.0' INTERVAL) CONTOUR
 _____ PROPOSED FINAL GRADE MINOR (0.1' INTERVAL) CONTOUR
 - - - - - EXISTING MAJOR (1.0' INTERVAL) CONTOUR
 - - - - - EXISTING MINOR (0.1' INTERVAL) CONTOUR
 x x x x x AS-BUILT GRADE AT OR ABOVE DESIGN SURFACE
 x x x x x AS-BUILT GRADE BELOW DESIGN SURFACE

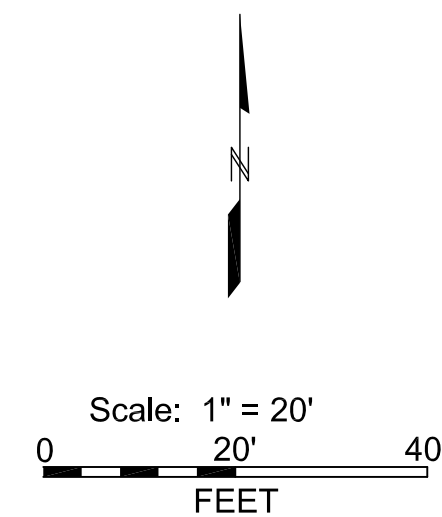

LW Survey Co.
12345 W. Alameda Pkwy,
Suite 205
Lakewood, CO 80228
303-515-3346
b.moser@lwsurvey.com

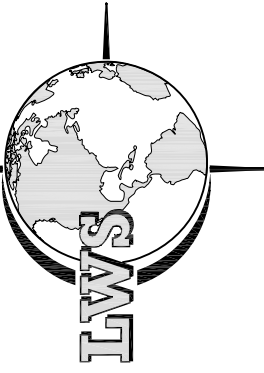

| | | | | | | |
|-----------------------|------------|----------------|-----|-----|----------|----------------------|
| FILE NAME: | 52919 | DRAWN BY: | N/A | NO. | DATE | DESCRIPTION |
| PROJECT: | 52919 | CHECKED BY: | JDG | 7 | 05/14/19 | SURFACE VERIFICATION |
| NOBLE RECLAMATION/DWG | | | | | | |
| DATE: | 05/02/2019 | | GMK | | | |
| SCALE: | 1"=20' | PROJ. MANAGER: | GMK | | | |

HEMLOCK NOBLE RECLAMATION

TOPOGRAPHIC AS-BUILT EXHIBIT

DRAWING NO.