



02420201

# Colorado Oil and Gas Conservation Commission

Docket No. 1307-RM-01

Encana Oil and Gas (USA), Inc.'s

Sensitive Wildlife Habitat/Restricted Surface  
Occupancy Concerns



BEATTY & WOZNIAK, P.C.  
ENERGY IN THE LAW

# 2008 Bighorn Sheep RSO/SWH (9S96W)

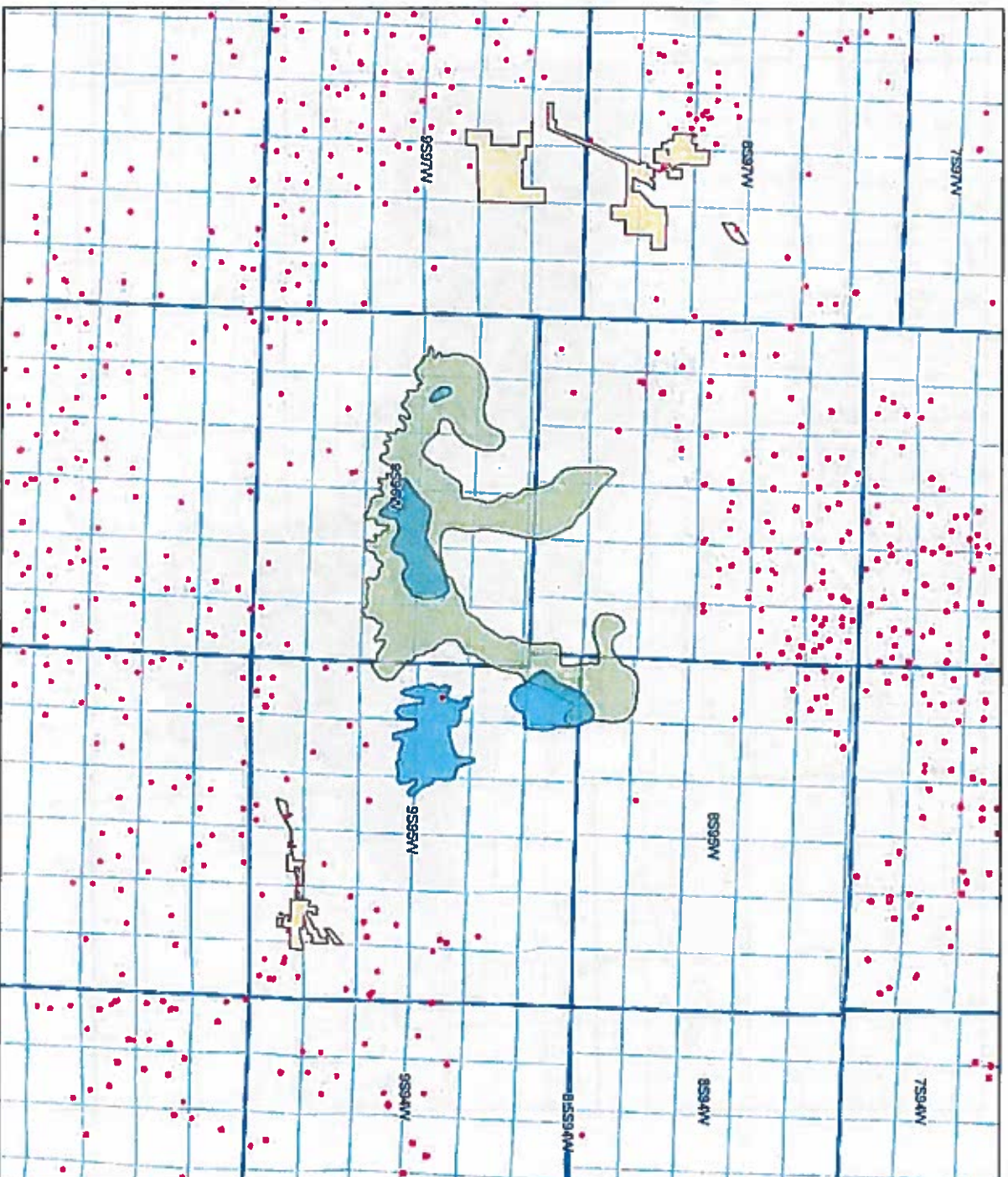



# 2008 Bighorn Sheep RSO/SWH with Federal NSO (9S96W)

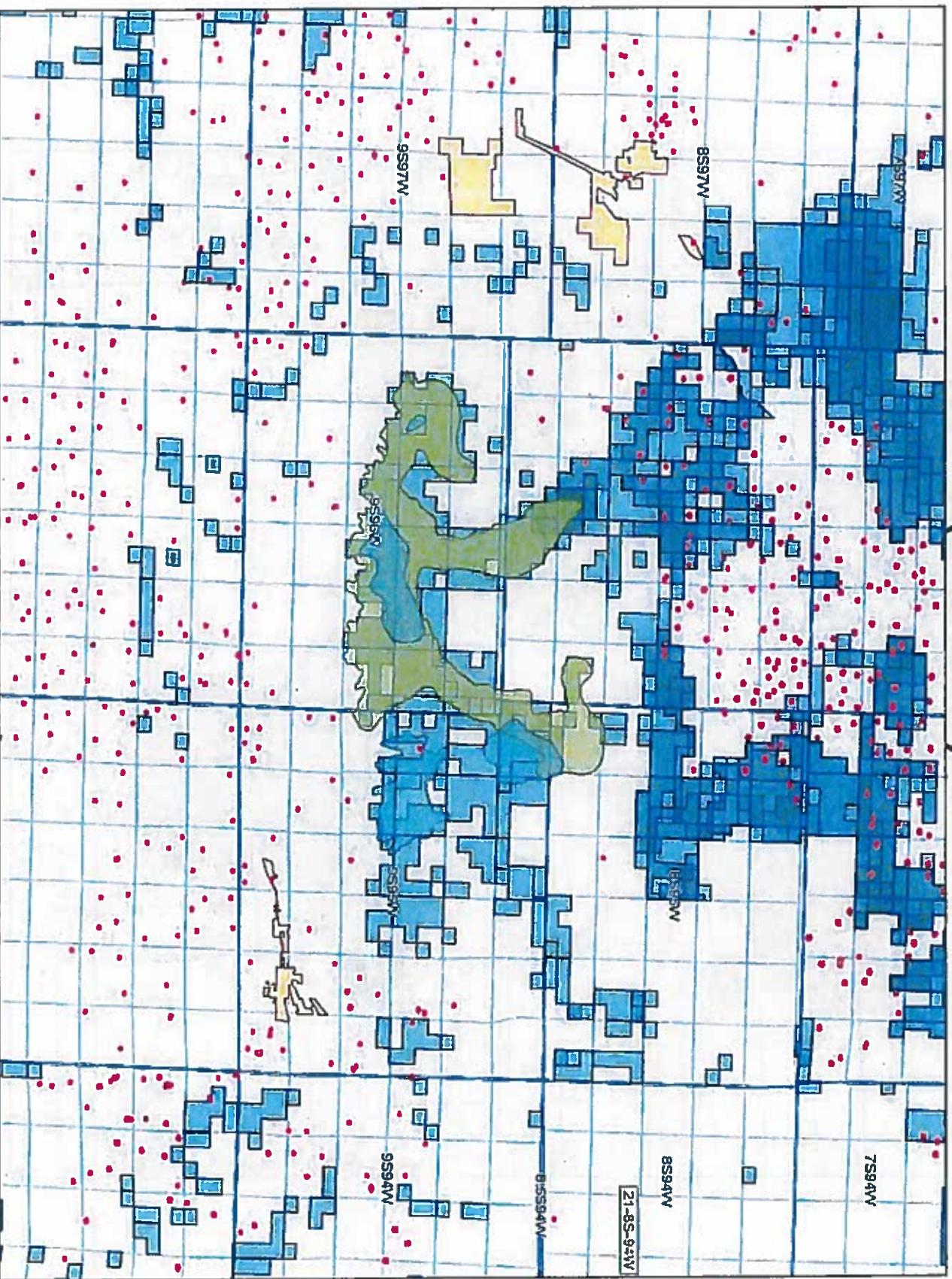



# 2008 Bighorn Sheep RSO/SWH with Federal Surface (9S96W)

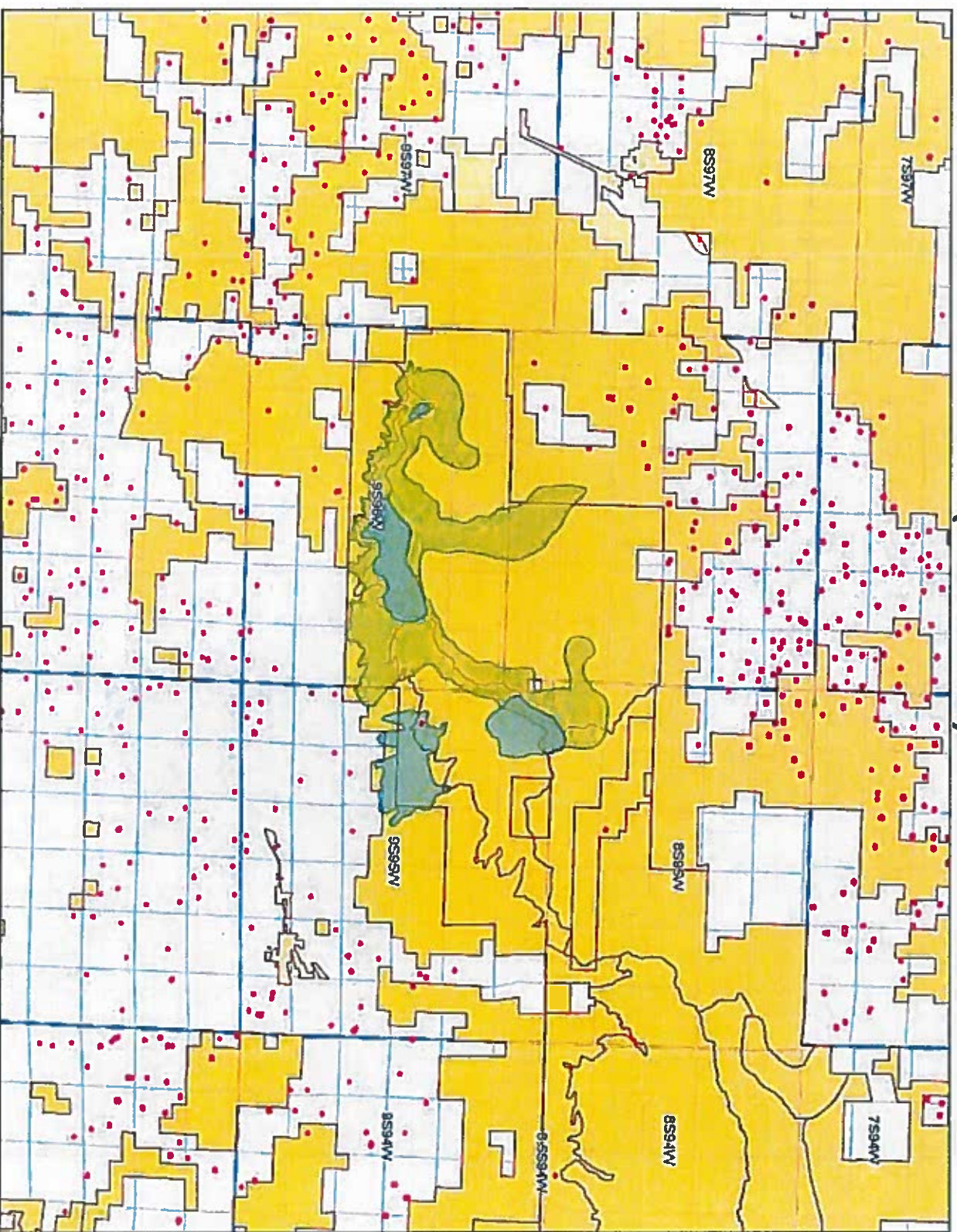

# Initial Requests

- ▶ Encana's initial requests were that the COGCC and CPW provide specific information regarding how the maps were generated as they relate to the habitat and winter range of bighorn sheep.
- ▶ Encana also requested that the COGCC and CPW determine the mitigating or aggravating factors that caused such a significant change in the habitat area as shown on the maps.





# Continuing Concerns

- Encana acknowledges and thanks CPW for its comments.
- The proposed wildlife map for bighorn sheep increases the expanse of the habitat on non-NSO acreage by over 15,000 acres over three of Encana's federal units.
- This increase has the potential to impact the economics and operational efficiency in this area that was previously not impacted by these possible wildlife limitations.
- Expansion significantly impacts Encana's operations in the Piceance Basin.



