

# PIT STATUS EVALUATION FORM

Facility ID: 115188

Pit Name: SABO 31-19 1

☐ Duplicate Record(s) Pit #

115189, 115190



## Legend

- Database Pit Location
- Producing Well
- Shut In Well
- Temp Aban Well
- Abandoned Well
- Dry & Aban Well
- Injection Well
- Other Well Status



1:6,000  
0 250 500 750 Feet

Image Source:  
USDA National Agricultural Imagery  
Program (NAIP), 2006

S.S. PAPADOPOULOS & ASSOCIATES, INC.

## COGCC Database Information

Status: NR Owner: ANADARKO E&P COMPANY LP  
T: 6S R: 62W Sec: 19 QQ: NWNE 6th Meridian  
Latitude: 39.518667 Longitude: -104.373602 NAD83

County: Elbert, CO  
County Code: 039

## Pit Status Evaluation

☐ Active

☐ Form 15: Pit Permit NA Assoc. Well Seq No(s) \_\_\_\_\_  
☐ Other documentation \_\_\_\_\_  
☐ Aerial photo verification \_\_\_\_\_

☒ Closed

☐ Form 27: Remediation Workplan \_\_\_\_\_  
☐ Form 4: Sundry Notice \_\_\_\_\_  
☐ Rule 903a.(2)B  
☒ Evidence pit(s) existed, no closure docs & well not PR, AC or SI  
Well API Seq #(s) 06210 PA (9-26-1998)  
☒ Other documentation WSIF # 429518 (11-23-1988)

☐ Abandoned

☐ Possible un-reclaimed pit(s) or adverse conditions, no closure docs

☐ Site Visit  
☐ No Site Visit  
☐ Add'l Review

☐ Unknown

Notes: LIF (1987) 30'x30' pit. Common Use for SABO #1, #2, #3  
WSIF (1988) pits backfilled & site clean.



# PIT STATUS EVALUATION FORM

Facility ID: 115189

Pit Name: SABO 33-19 2

☐ Duplicate Record(s) Pit #

115188, 115190



## Legend

- Database Pit Location
- Producing Well
- Shut In Well
- ⚡ Temp Aban Well
- ⚡ Abandoned Well
- ⚡ Dry & Aban Well
- ♦ Injection Well
- Other Well Status



1:6,000

0 250 500 750 Feet

Image Source:  
USDA National Agricultural Imagery  
Program (NAIP), 2006

 S.S. PAPADOPOULOS & ASSOCIATES, INC.

## COGCC Database Information

Status: NR Owner: ANADARKO E&P COMPANY LP  
T: 6S R: 62W Sec: 19 QQ: NWSE 6th Meridian  
Latitude: 39.511357 Longitude: -104.373772 NAD83

County: Elbert, CO  
County Code: 039

## Pit Status Evaluation

- ☐ **Active**
- ☐ Form 15: Pit Permit \_\_\_\_\_ Assoc. Well Seq No(s) \_\_\_\_\_
- ☐ Other documentation \_\_\_\_\_
- ☐ Aerial photo verification \_\_\_\_\_
- ☐ **Closed**
- ☐ Form 27: Remediation Workplan \_\_\_\_\_
- ☐ Form 4: Sundry Notice \_\_\_\_\_
- ☐ Rule 903a.(2)B \_\_\_\_\_
- ☒ Evidence pit(s) existed, no closure docs & well not PR, AC or SI
- Well API Seq #(s) 06220 PA
- ☒ Other documentation LIF# 690690 (7-8-1985)
- ☐ **Abandoned**
- ☐ Possible un-reclaimed pit(s) or adverse conditions, no closure docs
- ☐ Site Visit
- ☐ No Site Visit
- ☐ Add'l Review
- ☐ **Unknown**

Notes: Pit Status & documentation under Pit ID # 115188.  
Common Use for SABO #1, #2, #3.



# PIT STATUS EVALUATION FORM

Facility ID: 115190

Pit Name: SABO 11-19 3

☐ Duplicate Record(s) Pit #

115188, 115189

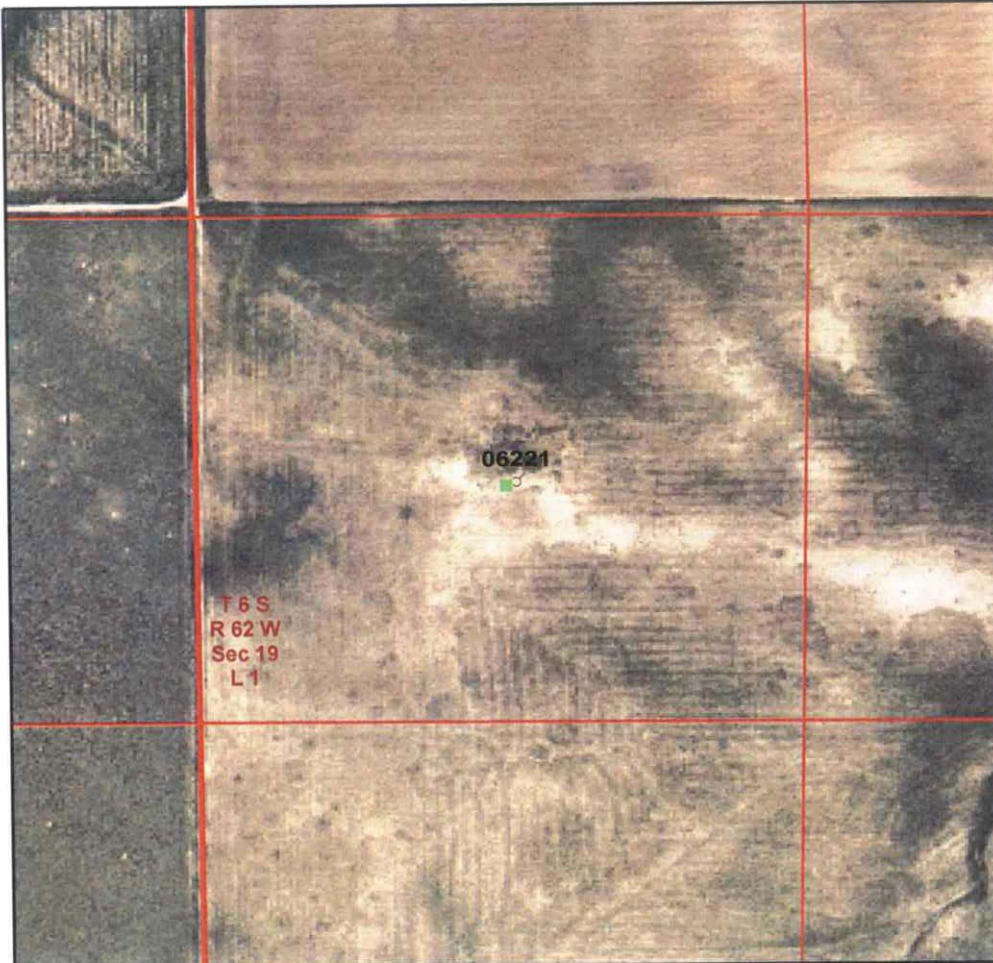

## Legend

- ☒ Database Pit Location
- ☐ Producing Well
- ☐ Shut In Well
- ☐ Temp Aban Well
- ☐ Abandoned Well
- ☐ Dry & Aban Well
- ☐ Injection Well
- ☐ Other Well Status



1:6,000

0 250 500 750 Feet

Image Source:  
USDA National Agricultural Imagery  
Program (NAIP), 2006

 S.S. PAPADOPOULOS & ASSOCIATES, INC.

## COGCC Database Information

Status: NR Owner: ANADARKO E&P COMPANY LP  
T: 6S R: 62W Sec: 19 QQ: NWNW 6th Meridian  
Latitude: 39.518547 Longitude: -104.382802 NAD83

County: Elbert, CO  
County Code: 039

## Pit Status Evaluation

- ☐ **Active**
- ☐ Form 15: Pit Permit \_\_\_\_\_ Assoc. Well Seq No(s) \_\_\_\_\_
  - ☐ Other documentation \_\_\_\_\_
  - ☐ Aerial photo verification \_\_\_\_\_
- ☐ **Closed**
- X No Pit  
On Site
- ☐ Form 27: Remediation Workplan \_\_\_\_\_
  - ☐ Form 4: Sundry Notice \_\_\_\_\_
  - ☐ Rule 903a.(2)B
  - ☒ Evidence pit(s) existed, no closure docs & well not PR, AC or SI
  - Well API Seq #(s) 06221 PA
  - ☐ Other documentation \_\_\_\_\_
- ☐ **Abandoned** ☐ Possible un-reclaimed pit(s) or adverse conditions, no closure docs
- ☐ **Unknown**
- ☐ Site Visit  
☐ No Site Visit  
☐ Add'l Review

Notes: Pit status & documentation under Pit ID # 115188.  
Common use for Sabo #1, #2, #3.