

# PIT STATUS EVALUATION FORM

Facility ID: 115119

Pit Name: MCCOY 12-5X

☐ Duplicate Record(s) Pit #

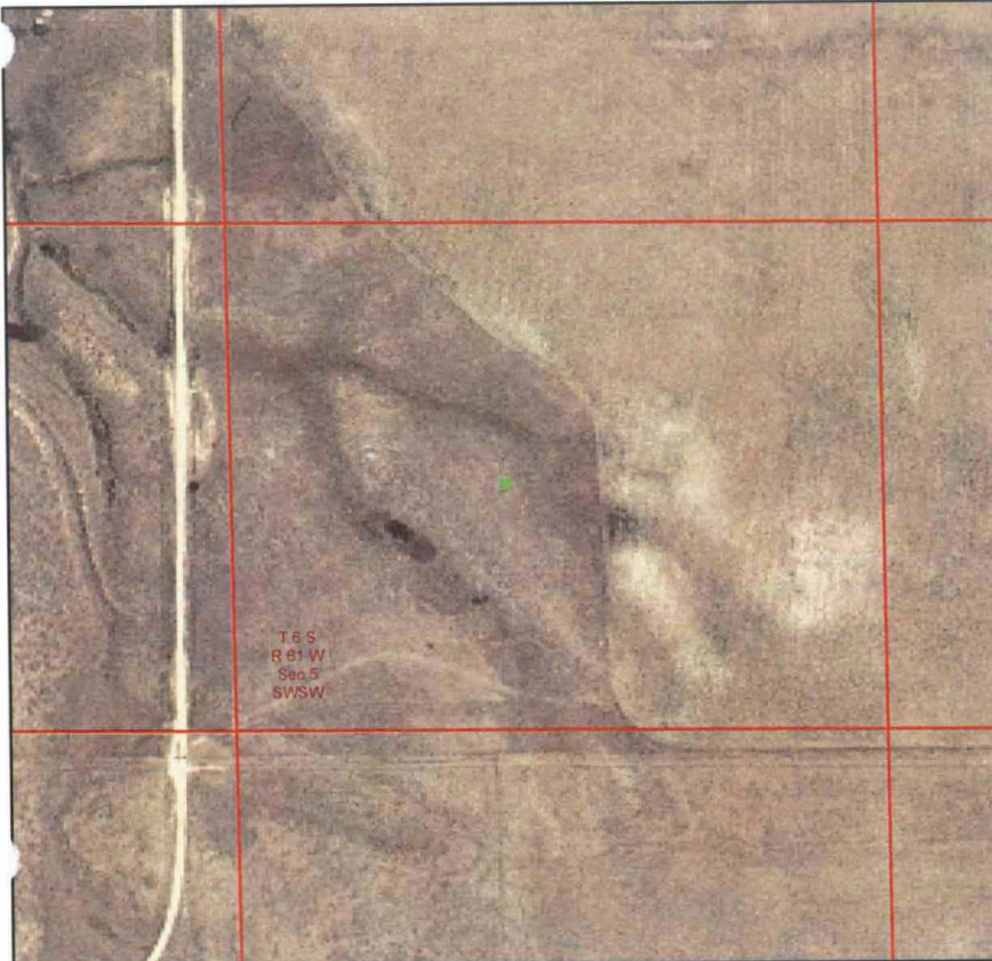

## Legend

- ☒ Database Pit Location
- ☒ Producing Well
- ☒ Shut In Well
- ☒ Temp Aban Well
- ☒ Abandoned Well
- ☒ Dry & Aban Well
- ☒ Injection Well
- ☒ Other Well Status



1:6,000  
0 250 500 750 Feet

Image Source:  
USDA National Agricultural Imagery  
Program (NAIP), 2006

S.S. PAPADOPOULOS & ASSOCIATES, INC.

## COGCC Database Information

Status: NR Owner: LATHAM EXPL CO INC  
T: 6S R: 61W Sec: 5 QQ: SWSW 6th Meridian  
Latitude: 39.551078 Longitude: -104.251688 NAD83

SWNW

WRONG

LOCATION

County: Elbert, CO  
County Code: 039

## Pit Status Evaluation

- ☐ Active ☐ Form 15: Pit Permit N/A Assoc. Well Seq No(s) \_\_\_\_\_  
☐ Other documentation \_\_\_\_\_  
☐ Aerial photo verification \_\_\_\_\_
- ☒ Closed ☐ Form 27: Remediation Workplan \_\_\_\_\_  
☐ Form 4: Sundry Notice \_\_\_\_\_  
☐ Rule 903a.(2)B \_\_\_\_\_  
☒ Evidence pit(s) existed, no closure docs & well not PR, AC or SI  
Well API Seq #(s) PA# (1-26-1993)  
☒ Other documentation WSIF #432303 (2-3-1992)
- ☐ Abandoned ☐ Possible un-reclaimed pit(s) or adverse conditions, no closure docs ☐ Site Visit  
☐ No Site Visit  
☐ Add'l Review
- ☐ Unknown

Notes: No Form 15. Location of Well/pit is in SWNW of Sec 5. Multi-well use  
McCoy-Amoco 12-5, 12-5X and 22-5. LF (1987).  
WSIF #2 Pits backfilled & site clean