

PIT STATUS EVALUATION FORM

Facility ID: 115118

Pit Name: MCCOY 22-5

☒ Duplicate Record(s) Pit #

115047

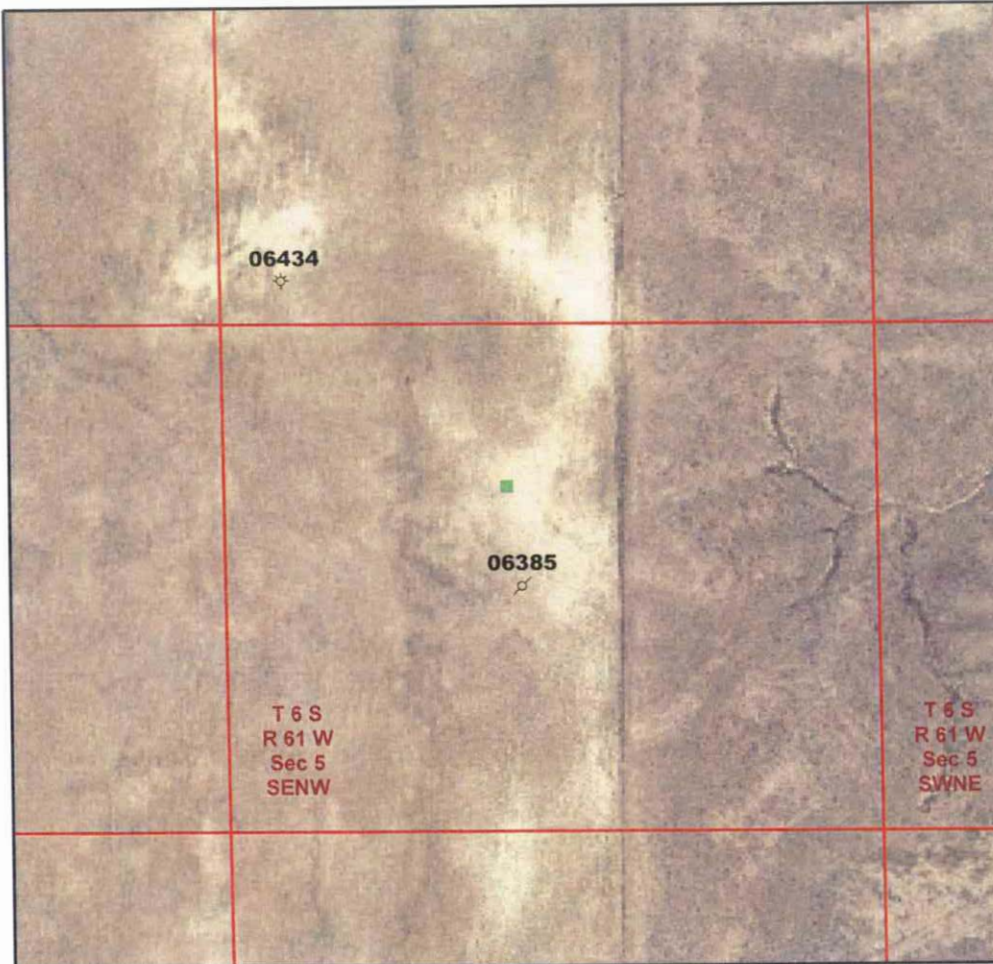

Legend

- Database Pit Location
- Producing Well
- ⊕ Shut In Well
- ⊕ Temp Aban Well
- ⊕ Abandoned Well
- ⊕ Dry & Aban Well
- ⊕ Injection Well
- Other Well Status



1:6,000
0 250 500 750 Feet

Image Source:
USDA National Agricultural Imagery
Program (NAIP), 2006

S.S. PAPADOPULOS & ASSOCIATES, INC.

COGCC Database Information

Status: NR Owner: LATHAM EXPL CO INC
T: 6S R: 61W Sec: 5 QQ: SENW 6th Meridian
Latitude: 39.559017 Longitude: -104.247028 NAD83

County: Elbert, CO
County Code: 039

Pit Status Evaluation

- ☐ Active ☐ Form 15: Pit Permit NA Assoc. Well Seq No(s) _____
☐ Other documentation _____
☐ Aerial photo verification _____
- ☐ Closed ☐ Form 27: Remediation Workplan _____
☐ Form 4: Sundry Notice _____
☐ Rule 903a.(2)B _____
☐ Evidence pit(s) existed, no closure docs & well not PR, AC or SI
Well API Seq #(s) PA# 06385 (1-26-1993)
☐ Other documentation WSIF#432237 (2-3-1992)
- ☐ Abandoned ☐ Possible un-reclaimed pit(s) or adverse conditions, no closure docs ☐ Site Visit
☐ No Site Visit
☐ Add'l Review
- ☐ Unknown

Notes:

Pit Status & documentation under Pit ID # 115047.
WSIF (1992) pits backfilled & site clean
DUPLICATE RECORD