

PIT STATUS EVALUATION FORM

Facility ID: 115097

Pit Name: WHITEHEAD 13-17

☐ Duplicate Record(s) Pit #

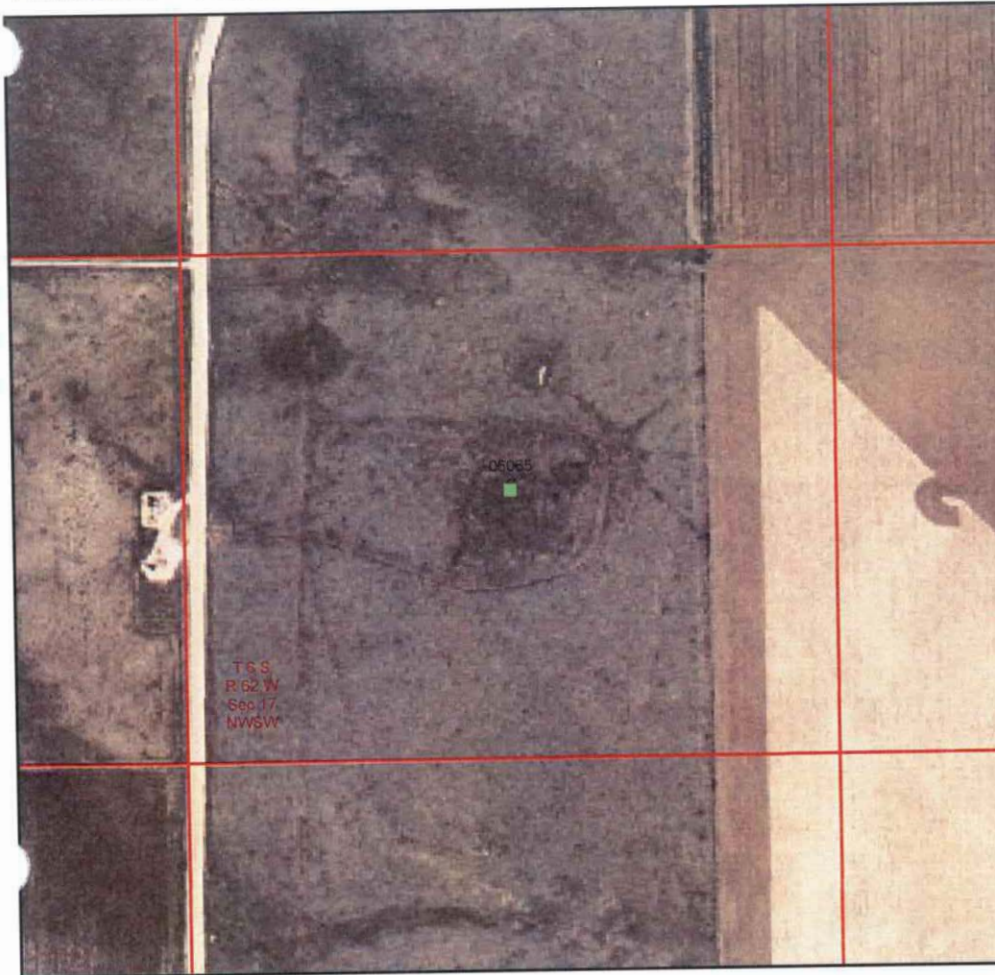

Legend

- ☒ Database Pit Location
- ☐ Producing Well
- ☐ Shut In Well
- ☐ Temp Aban Well
- ☐ Abandoned Well
- ☐ Dry & Aban Well
- ☐ Injection Well
- ☐ Other Well Status



1:6,000
0 250 500 750 Feet

Image Source:
USDA National Agricultural Imagery
Program (NAIP), 2006

S.S. PAPADOPULOS & ASSOCIATES, INC.

COGCC Database Information

Status: NR Owner: CHAMPLIN PETROLEUM COMPANY
T: 6S R: 62W Sec: 17 QQ: NWSW 6th Meridian
Latitude: 39.525977 Longitude: -104.364292 NAD83

County: Elbert, CO
County Code: 039

Pit Status Evaluation

- ☐ Active ☐ Form 15: Pit Permit (1971) existing Assoc. Well Seq No(s) _____
☐ Other documentation _____
☐ Aerial photo verification _____
- ☒ Closed ☐ Form 27: Remediation Workplan _____
☐ Form 4: Sundry Notice _____
☐ Rule 903a.(2)B _____
☒ Evidence pit(s) existed, no closure docs & well not PR, AC or SI
Well API Seq #(s) PA #06065 (3-9-1985)
☒ Other documentation LIF #427744
- ☐ Abandoned ☐ Possible un-reclaimed pit(s) or adverse conditions, no closure docs ☐ Site Visit
☐ Unknown ☐ No Site Visit
☐ Add'l Review

Notes: Map# 690657. 100' x 100' emergency use pt. LIF (8-8-1986) "Pit 1:
Rehab - did find 20' length steel cable (minor) "8" Pit 2: no sign of
T-B site"