

Cropland

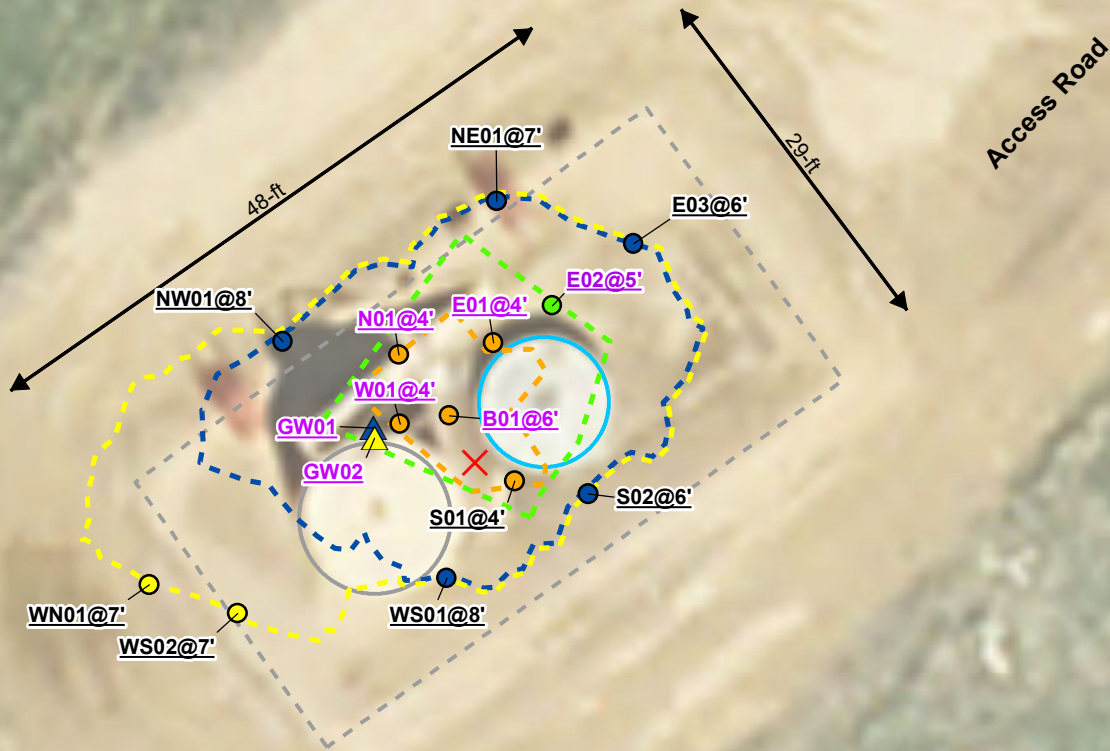

Non-cropland

Spatial data collected for this project was acquired using a GPS with submeter accuracy. Illustration discrepancies may be present in this diagram due to the inherent limitations of data accuracy for both project data and the underlying aerial imagery. For consistency in data representation and adherence to spatial data correction results, illustrated data is not corrected to fit with the aerial imagery or other collected data points.

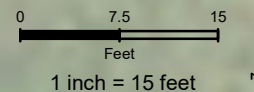

Figure 2
Troudt 44-7
Facility Layout & Sample Locations

Legend

- ✗ Approximate Release Location
- Soil Sample (10/11/2017)
- Soil Sample (10/12/2017)
- Soil Sample (10/13/2017)
- ▲ Groundwater Sample (10/13/2017)
- Soil Sample (10/16/2017)
- ▲ Groundwater Sample (10/16/2017)
- Former Crude Oil Tank
- Former Produced Water Tank
- Former Secondary Containment
- Excavation Extent (10/11/2017)
- Excavation Extent (10/12/2017)
- Excavation Extent (10/13/2017)
- Excavation Extent (10/16/2017)

Sample Label in Purple indicates lab exceedances.

Site Characteristics

Legal Location: SESE, Sec 7, T1N R67W
County: Weld
Land Use: Non-cropland
Topography: 1-3% Slopes
Run-Off Risk: Low
Soil Type: Colombo clay loam

REVISED	BY	COMMENT
3/11/2019	BJB	Figure 2

Apex Companies, LLC
 beau.bergstrom@apexco.com
 M:\Projects\Anadarko\DJ_Basin\Remediation\Troudt_44-7\Projects\Troudt_44-7_Fig2.dwg 20171019.mxd